

FOOD SERVICE EQUIPMENT SCHEDULE									
NO.	DESCRIPTION	QTY.	UNIT	REMARKS	NO.	DESCRIPTION	QTY.	UNIT	REMARKS
1	STOVE	1	EA		11	REF.	1	EA	
2	GRILL	1	EA		12	DISHWASHER	1	EA	
3	SINK	1	EA		13	STOVE	1	EA	
4	STOVE	1	EA		14	REF.	1	EA	
5	GRILL	1	EA		15	DISHWASHER	1	EA	
6	SINK	1	EA		16	STOVE	1	EA	
7	STOVE	1	EA		17	REF.	1	EA	
8	GRILL	1	EA		18	DISHWASHER	1	EA	
9	SINK	1	EA		19	STOVE	1	EA	
10	STOVE	1	EA		20	REF.	1	EA	

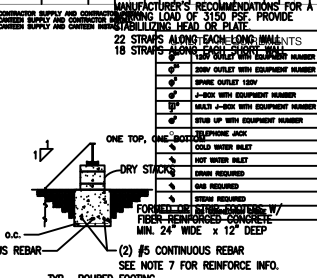

- #4 TIES AT 48" o.c.
(1) #4 CONTINUOUS REBAR
(2) #5 CONTINUOUS REBAR
SEE NOTE 7 FOR REINFORCE INFO.
TYP. POURED FOOTING
- NOTES:
1) PIERS ARE 8'-0" o.c. TYPICAL, OR AS SHOWN ON APPROVED PRINTS.
2) SOIL BEARING CAPACITY IS ASSUMED TO BE 2500 PSF.
3) DEPTH OF FOOTER IS 12", OR TO BELOW FROST LINE, IF IN EXCESS OF 12".
4) REBAR SHOWN IS MINIMUM DIAMETER, LARGER REBAR MAY BE USED.
5) FOOTER DIMENSIONS GIVEN ARE MINIMUMS, AND MAY BE EXCEEDED.
6) CONCRETE IS TO HAVE A MINIMUM STRENGTH OF 3000 PSI AT 28 DAYS.
7) INSTALL #4 REBARS @ 6" O.C.E.W. TOP & BOTTOM W/ #3 STIRRUPS @ 48" O.C..
8) BLOCK SPACING MAY VARY DUE TO AXLE HANGERS OR OTHER STRUCTURAL OBSTRUCTIONS.
9) ALL FOOTING SUBGRADES SHALL BE VERIFIED FOR SUITABLE BEARING CAPACITY.
10) ADD BLOCKS AT SIDES OF DOORS FOR DOOR ALIGNMENT.
11) ADD BLOCKS AT PERIMETER AS SHOWN FOR SUPPORT.
12) PIERS ARE FOOTING "A" - 24" DIA. UNLESS NOTED OTHERWISE.
13) SOIL CAPACITY MUST BE VERIFIED.
14) TREATED WOOD SHIMS & WEDGES MAY BE USED FOR ADJUSTMENT.
15) 30 GA GALVANIZED STRAPPING WILL BE USED TO ANCHOR THE BUILDING TO THE "J" HOOK" ANCHORS.

LAZNEY & ASSOCIATES
CONSULTING ENGINEERS
3000 N. 7th STREET
WEST PALM BEACH, FL 33411
PHONE: 314-387-2710

COMARK
BUILDING SYSTEMS, INC.

3000 COMARK BUILDING SYSTEMS, INC.
100 N. WILLOW AVE.
CHICAGO, ILLINOIS 60610

DATE: 10/15/06
SCALE: 3/32" = 1'-0"
PLOT SCALE: 1:1
DRAWN BY: RL
CHECKED BY:

VA BLOXI ADMIN
BLOXI, MS
BLOCKING & TIE-DOWN LAYOUT
FILE: 120168BLOXI
SERIAL #: XXXX

SHEET No.
S-1