

RIGHT SIDE ELEVATION

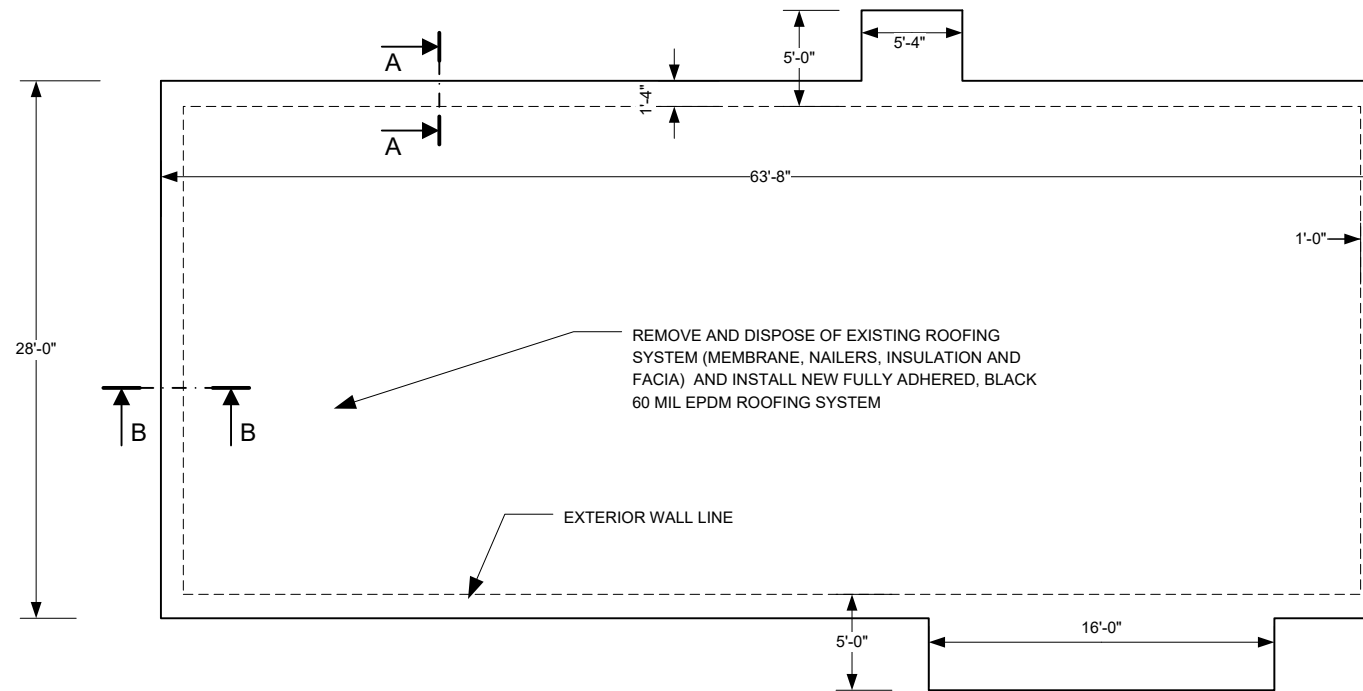

ROOF PLAN

- NOTES:
1. CONTRACTOR SHALL REMOVE AND DISPOSE OF THE EXISTING ROOFING SYSTM AND FACIA. ALL DEBRIS SHALL BE REMOVED FROM THE SITE ON A DAILY BASIS.
 2. THE CONTRACTOR SHALL ENSURE THAT THE FACILITY REMAINS PROTECTED FROM THE WEATHER AT ALL TIMES. MEMBRANE REMOVAL SHALL BE LIMITED TO THE AMOUNT OF NEW ROOFING SYSTEM THAT COULD BE INSTALLED EACH DAY. TARPS SHALL ALSO BE INSTALLED AND SECURED AT THE END OF EACH WORK DAY.
 3. CONTRACTOR IS RESPONSIBLE FOR VERIFYING ALL DIMENSIONS.
 4. THE EXISTING ROOFING MEMBRANE, INSULATION AND CAULKING WERE TESTED FOR ASBESTOS BY THE FAA AND ALL TEST RESULTS WERE FOUND TO BE NEGATIVE.

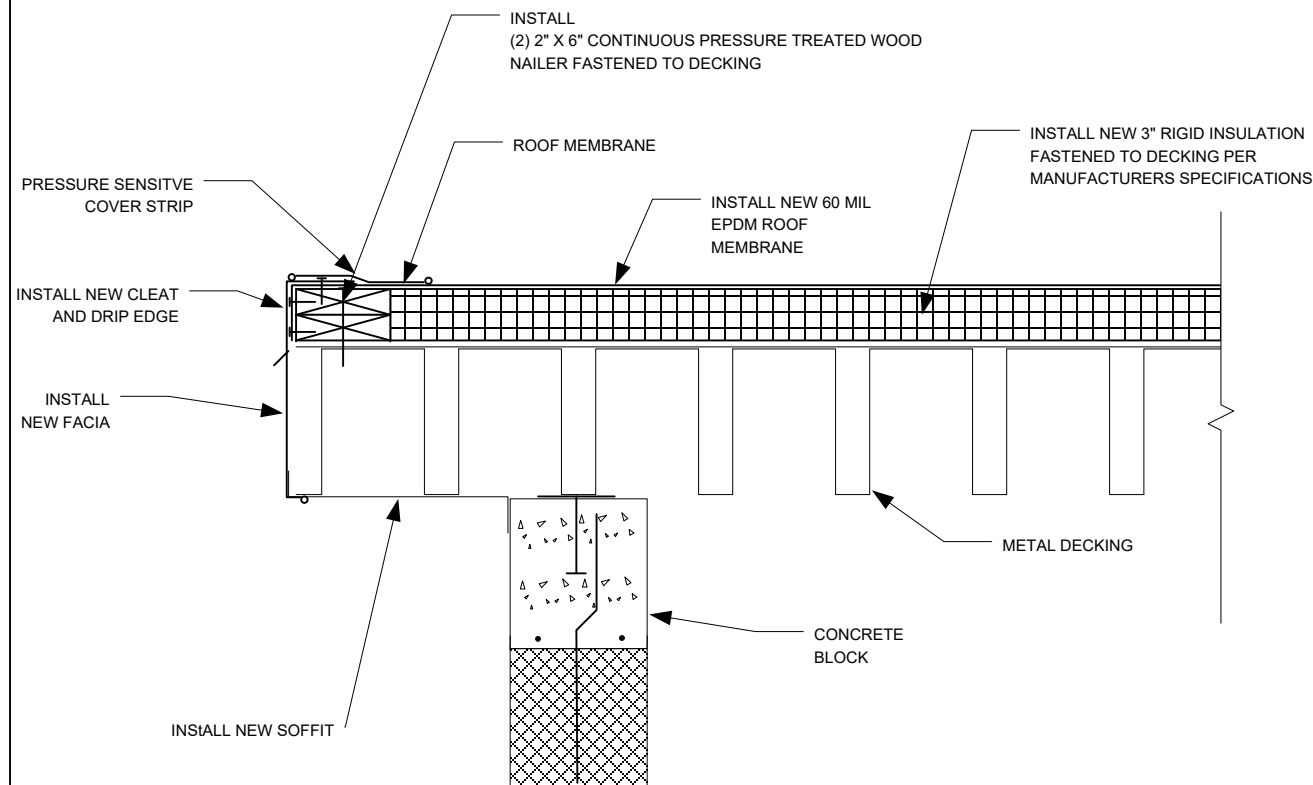

B
A1
END WALL
NTS

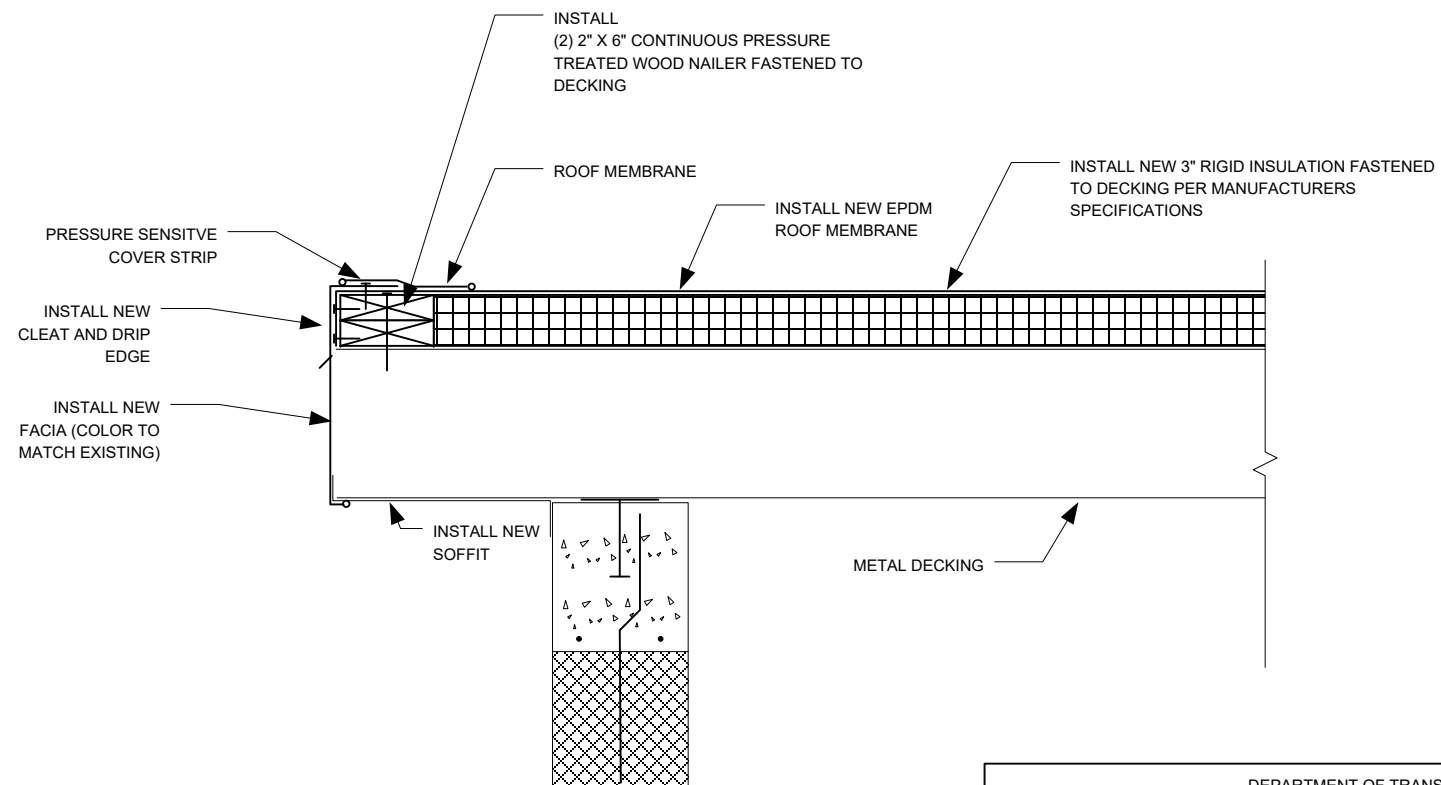

A
A1
LONGITUDINAL WALL
NTS

| | | | |
|---|----------------------------|-------|------|
| DEPARTMENT OF TRANSPORTATION FEDERAL AVIATION ADMINISTRATION EASTERN SERVICE AREA – NEW YORK TECHNICAL SUPPORT CENTER | | | |
| ASR REPLACEMENT OF THE ASR BUILDING ROOF ROOF PLAN | | | |
| WHITE PLAINS | WESTCHESTER COUNTY AIRPORT | NY | |
| SUBMITTED BY: | DWG NO SKETCH #1 | | REV |
| APPROVED BY: | DATE 04/19/2023 | SHEET | A001 |