

DRAWING NOTES

1. REFER TO SHEET 00.AS.003 FOR DEVICE MOUNTING HEIGHTS AND DESIGN CRITERIA.
2. REFER TO SHEET 00.AS.003 FOR BUILDING ENCLOSURE NOTES AND DESIGN CRITERIA.
3. REFER TO LEVEL 1 PLAN SHEET FOR EXTERIOR WALL DIMENSIONS AND DETAIL REFERENCES UNLESS SPECIFICALLY SHOWN ON THIS SHEET.
4. REFER TO XX.AS.800 SERIES FOR DOOR SCHEDULE AND DOOR DETAILS.
5. REFER TO XX.AS.710 FOR PARTITION DETAILS AND NOTES.
6. REFER TO GLS-100 WITH INTEGRAL HORIZONTAL BLINDS. REFER TO SPECS FOR FURTHER INFO.

GENERAL NOTES

1. FOR ROOF PENETRATION DETAILS REFER TO DETAILS 1 THROUGH 4 ON XX.AS.562.
2. FOR BUILDING MAINTENANCE & FALL PROTECTION SYSTEM DETAILS REFER TO DETAILS 5 THROUGH 7 ON XX.AS.562.
3. FOR LIGHTNING PROTECTION ROD DETAIL, REFER TO DETAIL 8 ON XX.AS.562.
4. FOR CONCOURSE STANDING SEAM LAYOUT REFER TO PARTIAL ROOF PLAN 3 ON XX.AS.104-B.
5. FOR PVC ROOFING SYSTEM PROVIDE 6" MINIMUM TAPERED INSULATION WITH 2% MINIMUM SLOPE TO DRAIN.
6. ALL SOUTH ELEVATION SUPER-HIB WALL OPENING HEIGHT TO BE 11'-10" (SILL HEIGHT 4' 6" FROM PENTHOUSE LEVEL), UNLESS NOTED OTHERWISE.
7. FOR LOUVER SIZES REFER TO PLANS AND ELEVATIONS. TOP HEIGHT OF LOUVERS TO ALIGN AT 17' 0" ABOVE PENTHOUSE LEVEL, UNLESS NOTED OTHERWISE.

ROOFING SYSTEM LEGEND

CODE	DESCRIPTION
(RS01)	RUBBERIZED ASPHALT GREEN ROOF SYSTEM
(RS01-A)	RUBBERIZED ASPHALT GREEN ROOF SYSTEM
(RS02)	RUBBERIZED ASPHALT PAVER ROOF SYSTEM
(RS03)	RUBBERIZED ASPHALT PAVER ROOF AT PV PANELS
(RS11)	SIMULATED-METAL PVC ROOFING
(RS21)	PVC ROOFING SYSTEM NON-INSULATED
(RS22)	PVC ROOFING SYSTEM INSULATED ON CONCRETE
(RS23)	PVC ROOFING SYSTEM INSULATED ON METAL DECK
(ROH01)	ROOF HATCH
(BMS)	BUILDING MAINTENANCE RAIL SYSTEM
(CLS)	CONTINUOUS LIFE LINE
(LSP)	CONTINUOUS LIFELINE SUPPORT PEDESTALS
(BCT)	BOSUN CHAIR / SAFETY TIEBACKS
(DB)	DAVIT BASE
(DLP)	PERMANENTLY FIXED ROTATING DAVITS
(DVR)	DUAL VERTICAL RAILS FOR ROLLING SOCKET
	EXTENT OF SNOW MELT SYSTEM, REFER TO 11/XX.AS.562 FOR DET

CONSULTANTS:

Professional Seal

ARCHITECT/ENGINEERS:

Key Plan

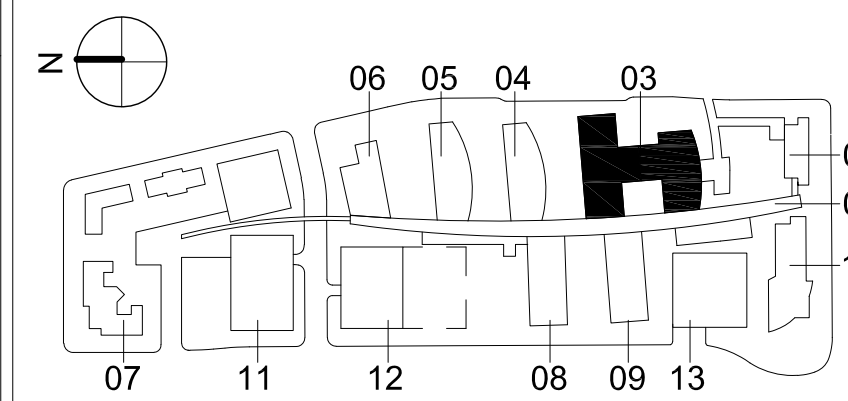

Drawing Title
DIAGNOSTIC AND TREATMENT
PENTHOUSE LEVEL PLAN - AREA B

Approved: Project Director

Project Title
REPLACEMENT MEDICAL CENTER
FACILITY, EASTERN COLORADO
HEALTH CARE SYSTEM

Location
AURORA, COLORADO

Date
08/31/2012

Checked

Drawn

Project Number
554-501

Building Number

Drawing Number

03.AS.104-B

OFFICE OF
CONSTRUCTION
AND FACILITIES
MANAGEMENT

REPLACE EXISTING
TEMPORARY WOOD UPPER
ROOF ACCESS STEPS/RAILS
WITH PERMANENT METAL
STEPS/RAILS

REFERENCE DRAWING
XX.AS.411

1 PENTHOUSE LEVEL PLAN - AREA B
1/8" = 1'-0"

2 PENTHOUSE LEVEL PLAN - WEST STAIR
1/8" = 1'-0"

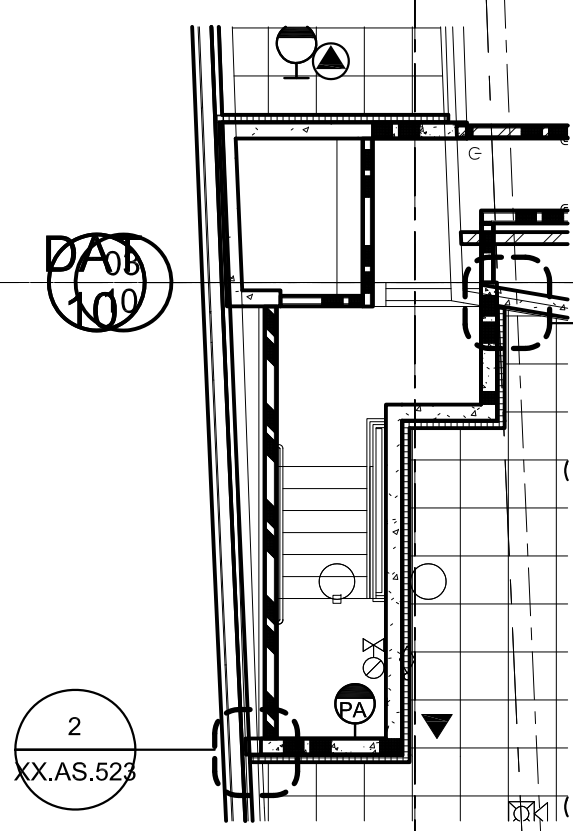

DAT A

