

**STATEMENT OF WORK**  
**FOR**  
**INSTALLATION OF THE COMBI OVEN AT CRESSMAN**  
**DINING FACILITY (BLDG 3220)**

**GOODFELLOW AFB, TEXAS**  
**19 Apr 2023**

## **STATEMENT OF WORK FOR THE INSTALLATION OF THE COMBI OVEN**

**1. DESCRIPTION OF SERVICES.** The contractor shall provide all management, labor, tools, equipment, transportation, and materials necessary to disconnect and remove existing convothrm oven to back dock and fabricate and install a new Combi Oven at the Cressman Dining Facility, building 3220. See attached pictures in Appendix A for location of current combi oven.

**1.1. Description:** Combi Oven IAW the attached Salient Characteristics.

**2. Scope of work.** The general scope of work and installation of the Combi oven and optional RO system as required can be summarized as follows:

**2.1.** Unloading, uncrating, and disposing of the packing trash on site

**2.2.** Disconnect and remove current oven and bring to loading dock for removal by government. Use double-doors and dock lift located in the back dock to bring the unit outside.

**2.3.** Receive new oven on-site, uncrate, assemble, and set in place using existing utilities.

**2.4.** All work-related trash to be disposed of in customer supplied trash dumpsters and cardboard bins on base.

### **3. Conditions of Installation:**

#### **3.1. Responsibilities of Contractor**

Contractor shall be responsible for procuring, supplying, transporting, and providing all labor, materials, tools, and equipment, etc. required for completion of the work in all respects and as per the scope of the work.

#### **3.2. Working Hours**

To minimize food production delays/working hours for the equipment installation, contact the customer to schedule the best time to remove/install oven. This is to ensure there will be no delay in the facility/staff getting the food prepared and no delays for the food contractor, trash removal or vendors delivering food.

#### **3.3. Safety**

Contractor will not leave the work site in an unsafe condition or any other condition that might cause injury to personnel, damage to existing work, or equipment. Contractor will use all safety equipment, e.g., gloves, safety-toe boots, and goggles, as required on site to avoid an accident. Any equipment or work considered dangerous shall be immediately discontinued.

**3.4. Protection of Warranty.** The contractor must not do work that will void the manufacturer's warranty for the oven and all its components. The contractor shall follow the warranty outlined in the contract.

**3.5 Final Inspections**

Final inspection will be coordinated by the customer to ensure all involved parties from 17 CES, Wing Safety are available to inspect the work after completion. The system needs to run properly without errors, leaks and verify all work was performed in accordance with most current regulations.

## APPENDIX A

### CRESSMAN (Building 3220) MAP

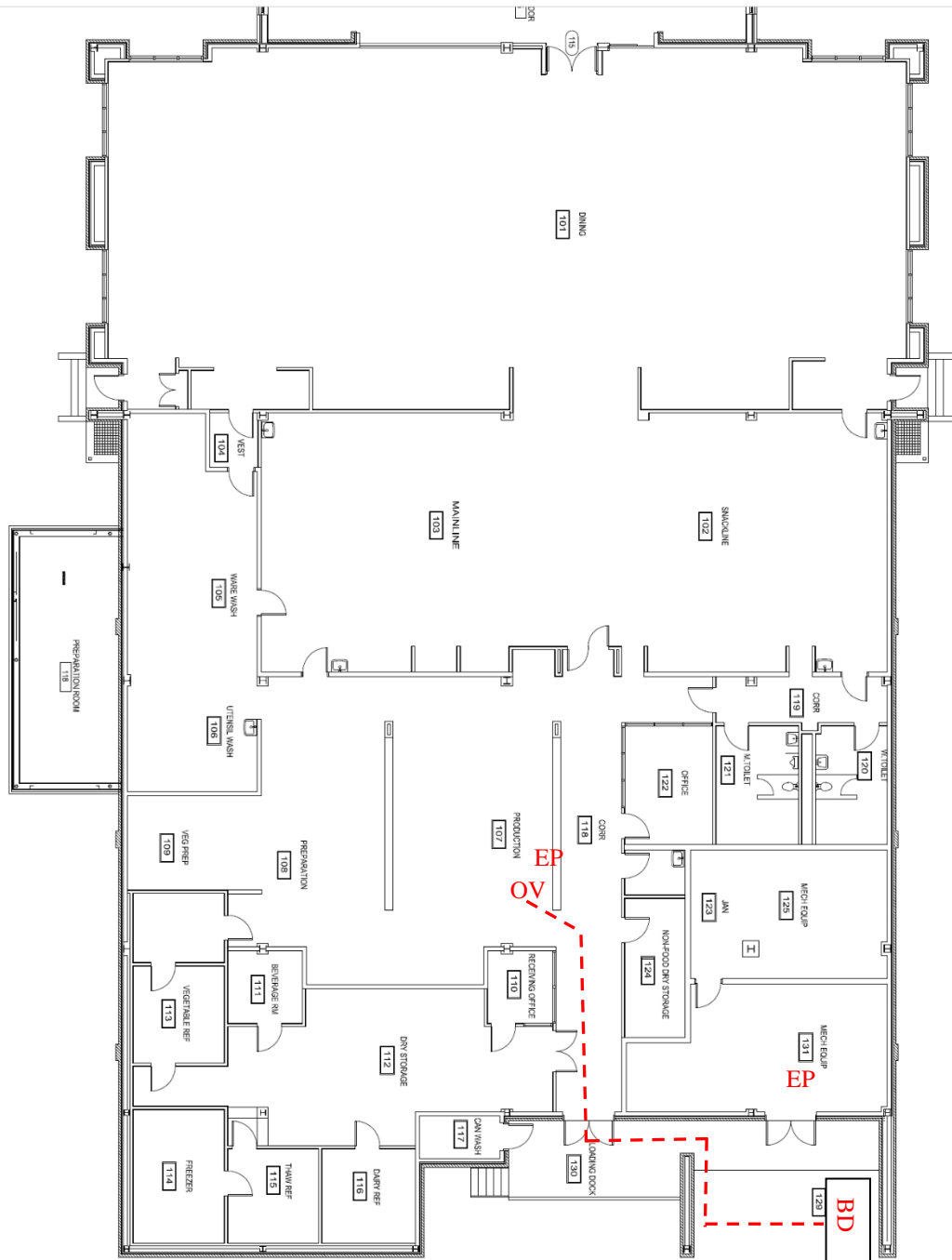

**EP** = Location of electrical panel for Oven

**OV** = Location of Oven

**BD** = Location to bring old dishwasher after disconnecting from utilities

**- -** = Route to remove old oven to back dock location. Use docklift to bring old oven down to ground level.