

one eighth inch = one foot
0 4 8 16
one quarter inch = one foot
0 4 8
three eighths inch = one foot
0 4 8
one half inch = one foot
0 4 8
three quarters inch = one foot
0 2 4
one inch = one foot
0 6 12
one and one half inches = one foot
0 6 12
three inches = one foot
0 6 12

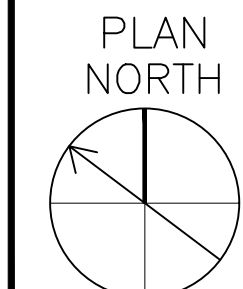

Revisions	Date

CONSULTANTS:

ARCHITECT/ENGINEERS:

Drawing Title
PHASE 2 LAYDOWN AREA
Approved Project Director

Project Title
FORT HARRISON, MONTANA
Location
Date
Checked
AD.
Drawn
TP.

Project Number
Building Number
Drawing Number

Office of Construction and Facilities Management

Department of Veterans Affairs