

KEY NOTES

- 1 AIRFIELD CONCRETE PAVEMENT (SEE SECTION A1 ON CP-501)
- 2 AIRFIELD ASPHALT PAVEMENT (SEE SECTION A1 ON CP-501)
- 3 TAXIWAY CENTERLINE BASELINE 'A'
- 4 CONCRETE JOINTS (SEE CP-101 TO CP-104)
- 5 DOUBLE BOX FRAME ROLLER GATE
- 6 GATE OPERATOR
- 7 ROLLER GATE FOOTING WITH RAILS
- 8 GRADE CROSSING ACTIVE CONTROL DEVICE
- 9 TWO 20' SWING MOTORIZED GATES
- 10 AIRFIELD PERIMETER FENCE FE-7 WITH DOUBLE CABLE BARRIER (SEE SHEET CS-502, CS-503, & C-504)
- 11 MD SHA ST'D. 645.01 CONCRETE MEDIAN TYPE A-1
- 12 SOUTH PERIMETER ROAD BASELINE 'B'
- 13 FLASHING BEACON
- 14 BIO-SWALE
- 15 HCP ACCESS ROAD BASELINE 'C'
- 16 HCP ACCESS ROAD BASELINE 'D'
- 17 UNDERGROUND DETENTION SYSTEM (SEE SHEET CU-504)
- 18 BIO-SWALE EARTH BERM
- 19 42-FOOT SWING GATE (SEE SHEET CS-502)
- 20 CONNECT TO EXISTING AIRFIELD SECURITY FENCE
- 21 GATE CONTROLLER (REFER TO ELECTRICAL SHEET E-102)
- 22 AIRFIELD LIGHT (REFER TO ELECTRICAL SHEET E-102)
- 23 ELECTRICAL PANEL (REFER TO ELECTRICAL SHEET E-103)
- 24 ELECTRICAL TRANSFORMER (REFER TO ELECTRICAL SHEET E-103)
- 25 ROADWAY LIGHT (REFER TO ELECTRICAL SHEET E-103)
- 26 NORTH TAXIWAY GATE BASELINE 'G'
- 27 SOUTH TAXIWAY GATE BASELINE 'H'
- 28 GUARDRAIL (REFER TO SHEET CS-505)

LEGEND

- AIRFIELD CONCRETE PAVEMENT (SEE SECTION A1 ON CP-501)
- AIRFIELD ASPHALT PAVEMENT (SEE SECTION A1 ON CP-501)
- ASPHALT ROAD PAVEMENT (SEE SECTIONS CS-301)
- BIO-SWALE FILTER MEDIA

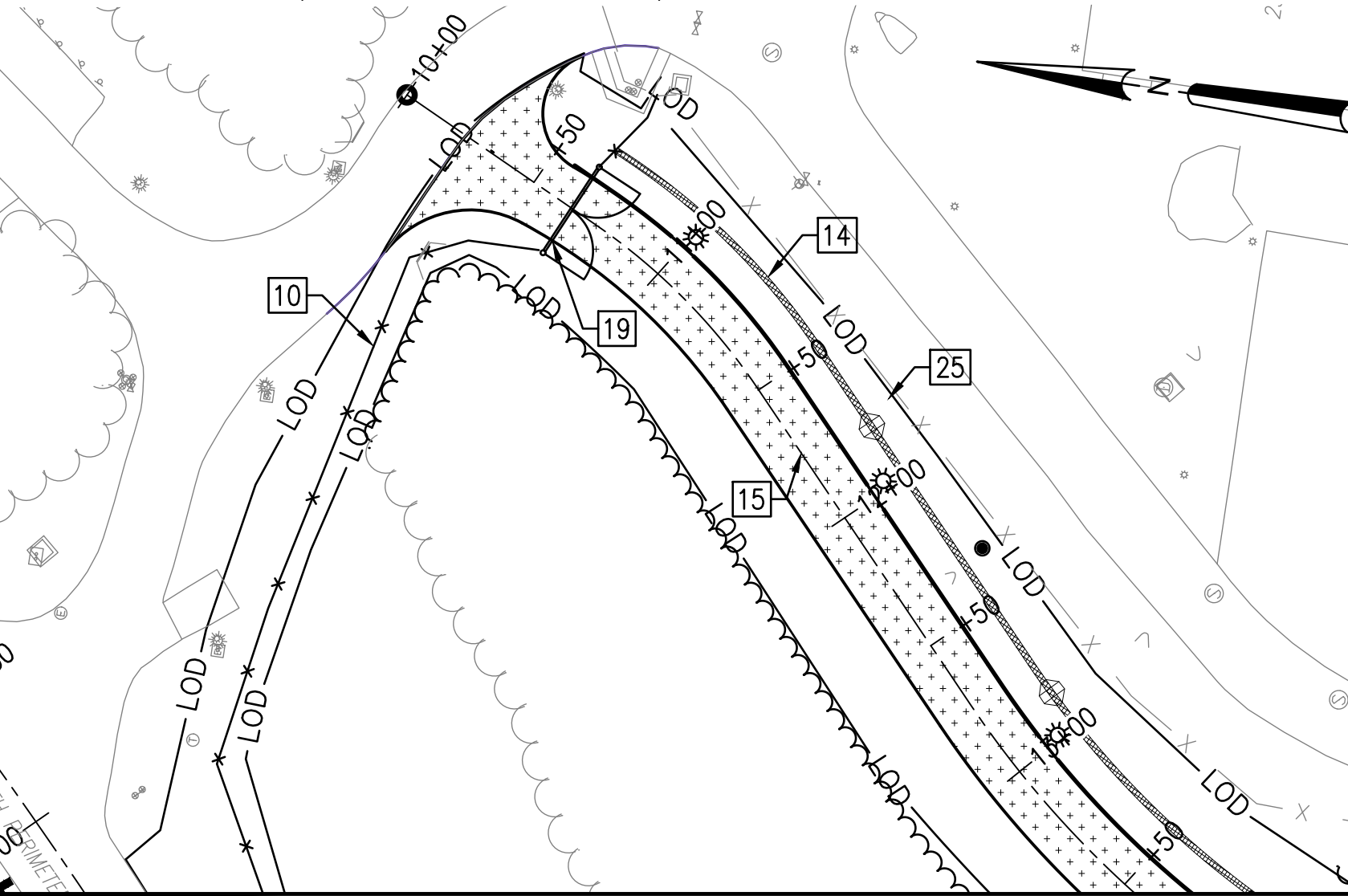

GENERAL NOTES:

- 1. REFER TO SHEET GI-003 FOR LEGEND AND GENERAL NOTES.
- 2. REFER TO SHEETS CS-201 TO CS-204 FOR TAXIWAY AND SOUTH PERIMETER ROAD PROFILES.
- 3. REFER TO SHEET CS-205 FOR TAXIWAY GATE PROFILES.
- 4. REFER TO SHEET CS-301 FOR SITE TYPICAL SECTIONS
- 5. REFER TO SHEETS CS-501 TO CS-502 FOR SITE DETAILS

1	AMENDMENT 0001	24/01/2023	09/26/2022	DATE	APPR
0	ISSUE FOR CONSTRUCTION			SYM DESCRIPTION	

JOINT VENTURE

APPROVED

FOR COMMANDER NAVFAC

ACTIVITY

SATISFACTORY TO DATE

DES

PRW

CHK

PM/DM

BRANCH MANAGER

CHIEF ENGINEER

FIRE PROTECTION

DEPARTMENT OF THE NAVY

NAVAL FACILITIES ENGINEERING COMMAND

NAVAL FACILITIES ENGINEERING COMMAND ~ WASHINGTON

WASHINGTON NAVY YARD

CAMP SPRINGS, MD

P-3002 RELOCATE HAZARDOUS CARGO

PAD AND EOD PROFICIENCY RANGE

SITE LAYOUT PLAN

SCALE: AS NOTED

PROJECT NO.: 1396650

CONSTR. CONTR. NO. N40080-22-R-8580

NAVFAC DRAWING NO. 13140325

SHEET 55 OF 229

CS-102

DRAWING REVISION: 08 APRIL 2017