

FCC TYPICALS - 6' X 6' Single

STAFF CUBE - EFFICIENCY

MONOLITHIC PANEL SYSTEM

CLIN

0001AA

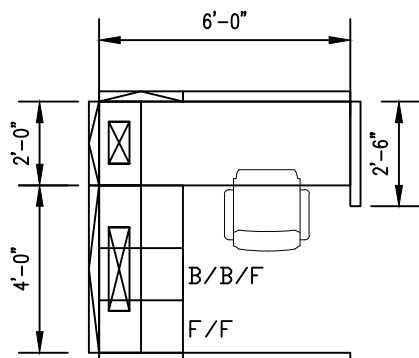

Cubicle Area: 36 Sq Ft

STANDARD COMPONENTS PER CUBICLE:

L-shaped worksurface configuration

Standing height privacy (62" - 70" High Panels)

Powered panels as shown →

(3) Duplex Receptacles (6 plug in points)

(1) Voice & Data Quad port

Power Pole

Mid-grade recycled fabric, metal connectors

All Connectors, finish trim, hardware and support

Worksurfaces as shown - laminate with vinyl edge

Storage:

(1) B/B/F (2 Small drawers + 1 Large drawer),
with locks, pencil tray and rails

(1) F/F (2 Large drawers), with locks and rails

Overheads 6 lineal feet as shown →

full length tackboards and task light under each

Includes lockable metal flipper doors for each

Seating not included

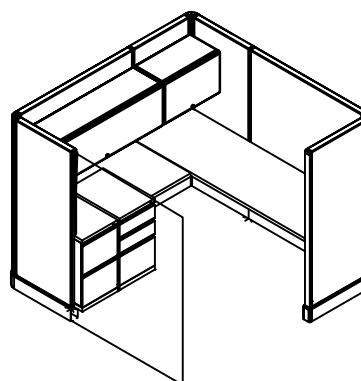

STANDARD MODIFICATIONS:

- 1M Panel height variation - Admin height (36" - 42"), removes overhead storage
- 2M Panel height variation - Seated Height Privacy (45" - 57"),
removes overhead storage
- 5M Worksurface - change straight 24 x 72" top to wave top (see Example B)
- 10M Worksurface - add corner worksurface (see Example C)
- 11M Change B/B/F to mobile B/F with cushion
- 13M Panel power - Power ALL Panels
- 14M* Add Ergonomic Keyboard tray with Mouse attachment
- 17M* Add 48" Panel Mounted Toolbar with (2) organizational accessories
- 18M* Add CPU Holder
- 19M* Add Monitor Arm
- 20M Add 6' of Transaction Counter top (42" high panels only)
- 21M* Task Light - Change to LED under cabinet task light
- 26M Add wood veneer worksurfaces in lieu of laminate

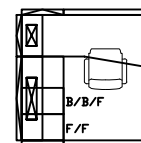

B L-shape
w/ wave top

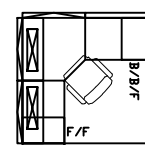

C Corner Worksurface

FCC TYPICALS - 6' X 6' - Double STAFF CUBE - EFFICIENCY MONOLITHIC PANEL SYSTEM

CLIN

0001AB

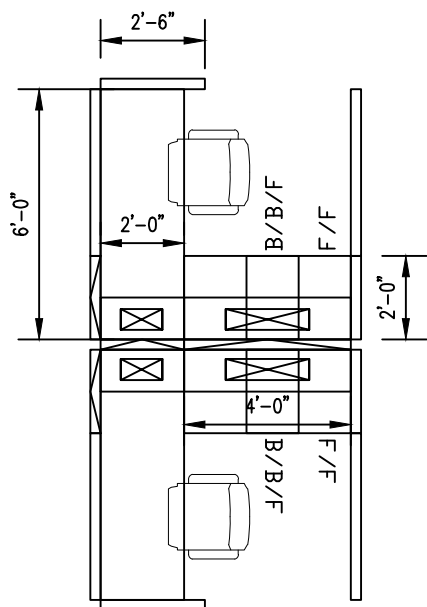

AB

Approx Area: 72 Sq Ft

STANDARD COMPONENTS PER CUBICLE:

L-shaped worksurface configuration

Standing height privacy (62" - 70" High Panels)

Powered panels as shown →

(3) Duplex Receptacles (6 plug in points) per cubicle

(1) Voice & Data Quad port per cubicle

(1) Power Pole per 2-pod

Mid-grade recycled fabric, metal connectors

All Connectors, finish trim, hardware and support

Worksurfaces as shown - laminate with vinyl edge

Storage:

(1) B/B/F (2 Small drawers + 1 Large drawer),
with locks, pencil tray and rails

(1) F/F (2 Large drawers), with locks and rails

Overheads 6 lineal feet as shown →

full length tackboards and task light under each

Includes lockable metal flipper doors for each

Seating not included

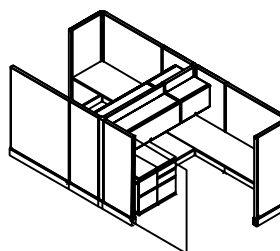

STANDARD MODIFICATIONS:

- 1M Panel height variation - Admin height (36" - 42"), removes overhead storage
- 2M Panel height variation - Seated Height Privacy (45" - 57"), removes overhead storage
- 5M Worksurface - change 24 x 72" straight top to wave top (see Example B)
- 10M Worksurface - add corner worksurface (see Example C)
- 11M Change B/B/F to mobile B/F with cushion
- 13M Panel power - Power ALL Panels
- 14M* Add Ergonomic Keyboard tray with Mouse attachment
- 17M* Add 48" Panel Mounted Toolbar with (2) organizational accessories
- 18M* Add CPU Holder
- 19M* Add Monitor Arm
- 20M Add 6' of Transaction Counter top (42" high panels only)
- 21M* Task Light - Change to LED under cabinet task light
- 26M Add wood veneer worksurfaces in lieu of laminate

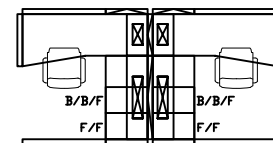

B L-shape
w/ wave top

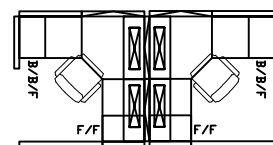

C Corner Worksurface

FCC TYPICALS - 6' X 6' - Quad

STAFF CUBE - EFFICIENCY

MONOLITHIC PANEL SYSTEM

CLIN

0001AC

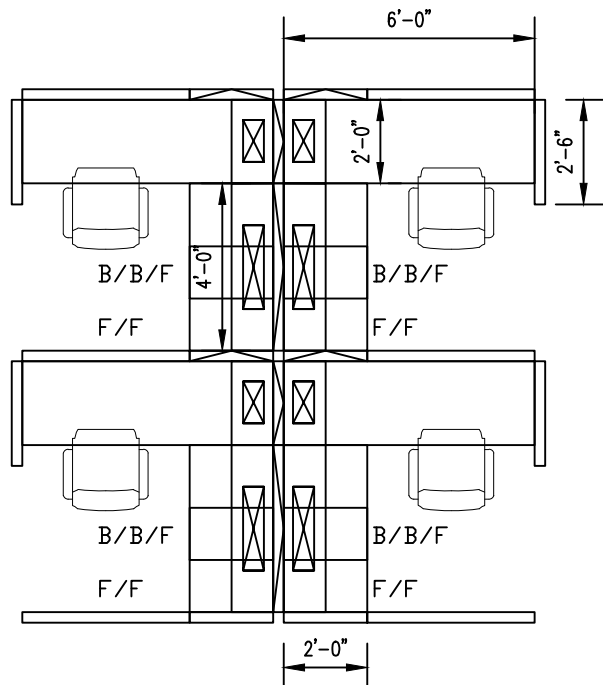

Approx Area: 144 Sq Ft

STANDARD COMPONENTS PER CUBICLE:

L-shaped worksurface configuration

Standing height privacy (62" - 70" High Panels)

Powered panels as shown →

(3) Duplex Receptacles (6 plug in points) per cubicle

(1) Voice & Data Quad port

Power Pole

Mid-grade recycled fabric, metal connectors

All Connectors, finish trim, hardware and support

Worksurfaces as shown - laminate with vinyl edge

Storage:

(1) B/B/F (2 Small drawers + 1 Large drawer),
with locks, pencil tray and rails

(1) F/F (2 Large drawers), with locks and rails

Overheads 6 lineal feet as shown →

full length tackboards and task light under each

Includes lockable metal flipper doors for each

Seating not included

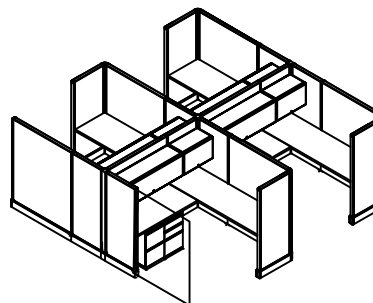

STANDARD MODIFICATIONS:

- 1M Panel height variation - Admin height (36" - 42"), removes overhead storage
- 2M Panel height variation - Seated Height Privacy (45" - 57"), removes overhead storage
- 5M Worksurface - change 24 x 72" straight top to wave top (see Example B)
- 10M Worksurface - add corner worksurface (see Example C)
- 11M Change B/B/F to mobile B/F with cushion
- 13M Panel power - Power ALL Panels
- 14M* Add Ergonomic Keyboard tray with Mouse attachment
- 17M* Add 48" Panel Mounted Toolbar with (2) organizational accessories
- 18M* Add CPU Holder
- 19M* Add Monitor Arm
- 20M Add 6" of Transaction Counter top (42" high panels only)
- 21M* Task Light - Change to LED under cabinet task light
- 26M Add wood veneer worksurfaces in lieu of laminate

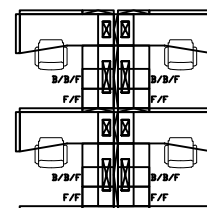

(B) L-shape w/ wave top

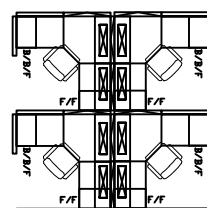

(C) Corner Worksurface

FCC TYPICALS - 6' X 8' - Single

STAFF CUBE - SMALL

MONOLITHIC PANEL SYSTEM

CLIN

0001AD

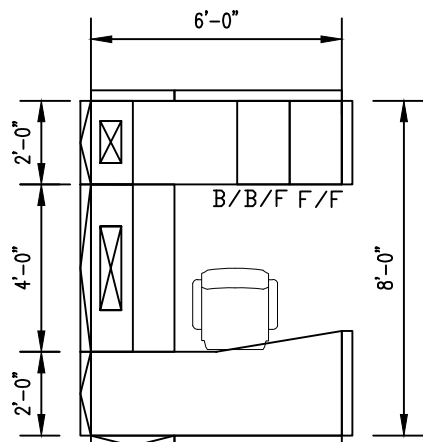

Cubicle Area: 48 Sq Ft

STANDARD COMPONENTS PER CUBICLE:

U-shaped worksurface with Wave top
 Standing height privacy (62" - 70" High Panels)
 Powered panels as shown →
 (3) Duplex Receptacles (6 plug in points)
 (1) Voice & Data Quad port per cubicle
 Power Pole
 Mid-grade recycled fabric, metal connectors
 All Connectors, finish trim, hardware and support
 Worksurfaces as shown - laminate with vinyl edge
 Storage:
 (1) B/B/F (2 Small drawers + 1 Large drawer)
 with locks, pencil tray and rails
 (1) F/F (2 Large drawers), with locks and rails
 Overheads - 6 lineal feet as shown →
 full length tackboards and task lights under each
 Includes lockable metal flipper doors for each
 Seating not included

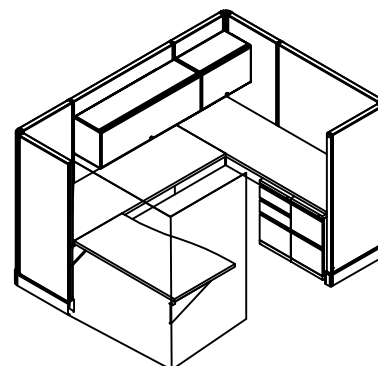

STANDARD MODIFICATIONS:

- 1M Panel height variation - Admin height (36" - 42"), removes overhead storage
- 2M Panel height variation - Seated Height Privacy (45" - 57"), removes overhead storage
- 5M Worksurface - change Wave top to 24 x 72" straight top (see Example C)
- 6M Change 24" x 72" worksurface to 30" Deep rectangular worksurface
- 9M6x8 Worksurface - change from U-shape to L-shape configuration (see Example B)
- 11M Storage - Change B/B/F to Mobile B/F pedestal with cushion
- 13M Panel power - Power ALL Panels
- 14M* Add Ergonomic Keyboard tray with Mouse attachment
- 15M Add Center Drawer
- 17M* Add 48" Panel Mounted Toolbar with (2) organizational accessories
- 18M* Add CPU Holder
- 19M* Add Monitor Arm
- 20M Add 6' of Transaction Counter top (42" high panels only)
- 21M* Task Light - Change to LED under cabinet task light
- 24M Add Sliding Door (64" high panels only)
- 26M Add wood veneer worksurfaces in lieu of laminate

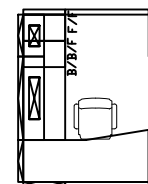

B L-shape w/ wave top

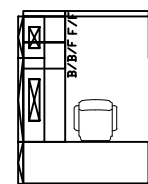

C L-shape Rectangular

FCC TYPICALS - 6' X 8' - Double

STAFF CUBE - SMALL

MONOLITHIC PANEL SYSTEM

CLIN

0001AE

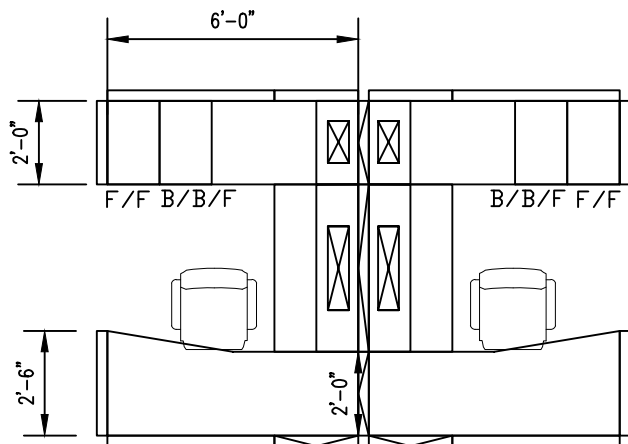

Approx Area: 96 Sq Ft

STANDARD COMPONENTS PER CUBICLE:

U-shaped worksurface with Wave top
 Standing height privacy (62" - 70" High Panels)
 Powered panels as shown →
 (3) Duplex Receptacles (6 plug in points) per cubicle
 (1) Voice & Data Quad port per cubicle
 (1) Power Pole per 2-pod
 Mid-grade recycled fabric, metal connectors
 All Connectors, finish trim, hardware and support
 Worksurfaces as shown - laminate with vinyl edge
 Storage:
 (1) B/B/F (2 Small drawers + 1 Large drawer)
 with locks, pencil tray and rails
 (1) F/F (2 Large drawers), with locks and rails
 Overheads - 6 lineal feet as shown →
 full length tackboards and task lights under each
 Includes lockable metal flipper doors for each
 Seating not included

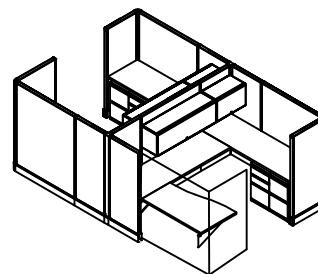

STANDARD MODIFICATIONS:

- 1M Panel height variation - Admin height (36" - 42"), removes overhead storage
- 2M Panel height variation - Seated Height Privacy (45" - 57"), removes overhead storage
- 5M Worksurface - change Wave top to 24 x 72" straight top (see Example C)
- 6M Change 24" x 72" worksurface to 30" Deep rectangular worksurface
- 9Mx8 Worksurface - change from U-shape to L-shape configuration (see Example B)
- 11M Storage - Change B/B/F to Mobile B/F pedestal with cushion
- 13M Panel power - Power ALL Panels
- 14M* Add Ergonomic Keyboard tray with Mouse attachment
- 15M Add Center Drawer
- 17M* Add 48" Panel Mounted Toolbar with (2) organizational accessories
- 18M* Add CPU Holder
- 19M* Add Monitor Arm
- 20M Add 6' of Transaction Counter top (42" high panels only)
- 21M* Task Light - Change to LED under cabinet task light
- 24M Add Sliding Door (64" high panels only)
- 26M Add wood veneer worksurfaces in lieu of laminate

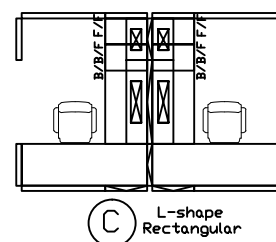
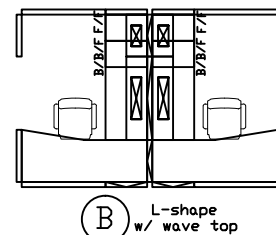

FCC TYPICALS - 6' X 8' - Quad

STAFF CUBE - SMALL

MONOLITHIC PANEL SYSTEM

CLIN

0001AF

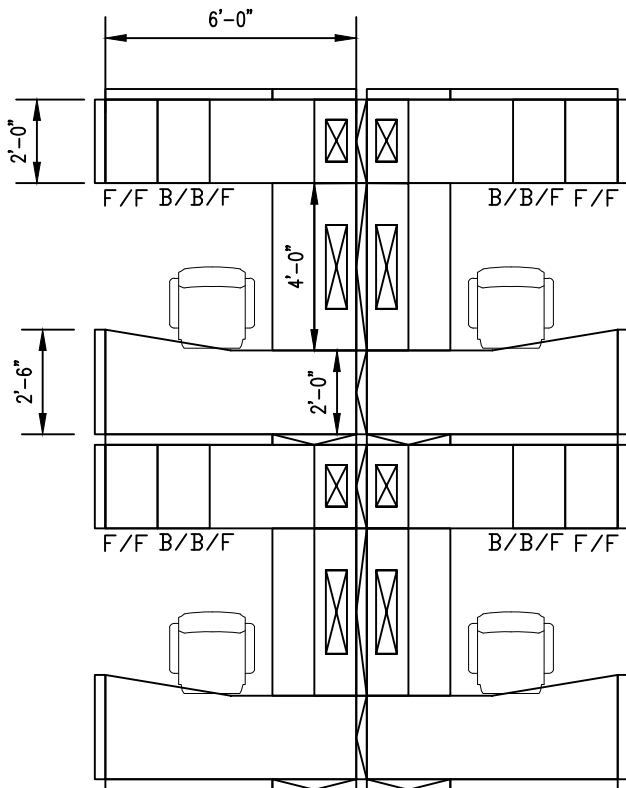

AF

Approx Area: 192 Sq Ft

STANDARD COMPONENTS PER CUBICLE:

U-shaped worksurface with Wave top
 Standing height privacy (62" - 70" High Panels)
 Powered panels as shown →
 (3) Duplex Receptacles (6 plug in points) per cubicle
 (1) Voice & Data Quad port per cubicle
 Power Pole
 Mid-grade recycled fabric, metal connectors
 All Connectors, finish trim, hardware and support
 Worksurfaces as shown - laminate with vinyl edge
 Storage:
 (1) B/B/F (2 Small drawers + 1 Large drawer)
 with locks, pencil tray and rails
 (1) F/F (2 Large drawers), with locks and rails
 Overheads - 6 lineal feet as shown →
 full length tackboards and task lights under each
 Includes lockable metal flipper doors for each
 Seating not included

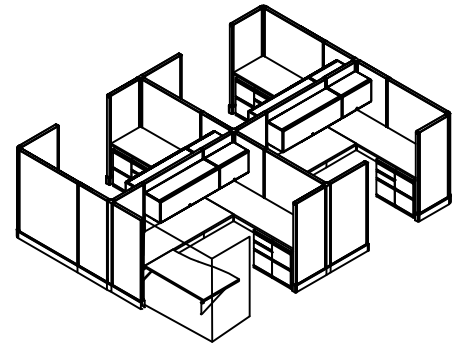

STANDARD MODIFICATIONS:

- 1M Panel height variation - Admin height (36" - 42"), removes overhead storage
- 2M Panel height variation - Seated Height Privacy (45" - 57"), removes overhead storage
- 5M Worksurface - change Wave top to 24 x 72" straight top (see Example C)
- 6M Change 24" x 72" worksurface to 30" Deep rectangular worksurface
- 9Mx8 Worksurface - change from U-shape to L-shape configuration (see Example B)
- 11M Storage - Change B/B/F to Mobile B/F pedestal with cushion
- 13M Panel power - Power ALL Panels
- 14M* Add Ergonomic Keyboard tray with Mouse attachment
- 15M Add Center Drawer
- 17M* Add 48" Panel Mounted Toolbar with (2) organizational accessories
- 18M* Add CPU Holder
- 19M* Add Monitor Arm
- 20M Add 6' of Transaction Counter top (42" high panels only)
- 21M* Task Light - Change to LED under cabinet task light
- 24M Add Sliding Door (64" high panels only)
- 26M Add wood veneer worksurfaces in lieu of laminate

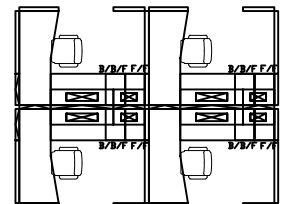

(B) L-shape
w/ wave top

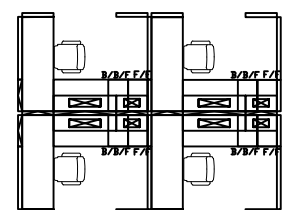

(C) L-shape
Rectangular

FCC TYPICALS - 8' X 8' Single

STAFF CUBE - LARGE

MONOLITHIC PANEL SYSTEM

CLIN

0001AG

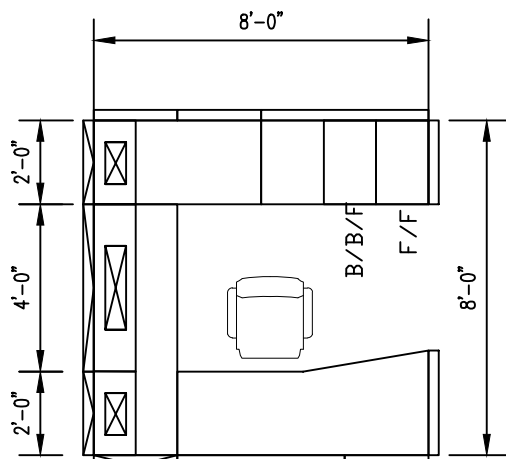

Cubicle Area: 64 Sq Ft

STANDARD COMPONENTS PER CUBICLE:

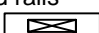
U-shaped worksurface with Wave top
 Standing height privacy (62" - 70" High Panels)
 Powered panels as shown → 
 (3) Duplex Receptacles (6 plug in points)
 (1) Voice & Data Quad port per cubicle
 Power Pole
 Mid-grade recycled fabric, metal connectors
 All Connectors, finish trim, hardware and support
 Worksurfaces as shown - laminate with vinyl edge
 Storage:
 (1) B/B/F (2 Small drawers + 1 Large drawer)
 with locks, pencil tray and rails
 (1) F/F (2 Large drawers), with locks and rails
 Overheads - 8 lineal feet as shown → 
 full length tackboards and task lights under each
 Includes lockable metal flipper doors for each
 Seating not included

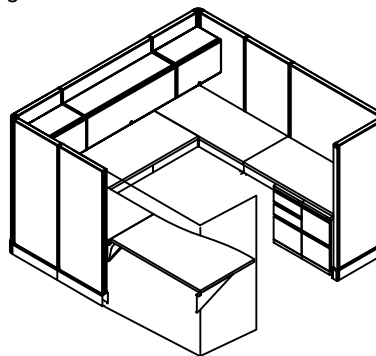

STANDARD MODIFICATIONS:

- 1M Panel height variation - Admin height (36" - 42"), removes overhead storage
- 2M Panel height variation - Seated Height Privacy (45" - 57"), removes overhead storage
- 5M Worksurface - change Wave top to 24 x 72" straight top (see Example C)
- 6M Change 24" x 72" worksurface to 30" Deep rectangular worksurface
- 9M8x8 Worksurface - change from U-shape to L-shape configuration (see Example B)
- 11M Storage - Change B/B/F to Mobile B/F pedestal with cushion
- 13M Panel power - Power ALL Panels
- 14M* Add Ergonomic Keyboard tray with Mouse attachment
- 15M Add Center Drawer
- 17M* Add 48" Panel Mounted Toolbar with (2) organizational accessories
- 18M* Add CPU Holder
- 19M* Add Monitor Arm
- 20M Add 6' of Transaction Counter top (42" high panels only)
- 21M* Task Light - Change to LED under cabinet task light
- 22M Add 24" wide Storage Tower with file drawers and closed shelving
- 23M Add 24" wide Storage Tower with Coat Closet
- 24M Add Sliding Door (64" high panels only - See Example "C")
- 26M Add wood veneer worksurfaces in lieu of laminate

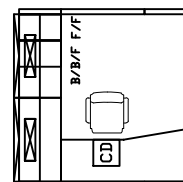

B L-shape
w/ wave top

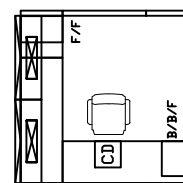

C L-shape
Rectangular tops,
shows sliding door

FCC TYPICALS - 8' X 8' - Double

STAFF CUBE - LARGE

MONOLITHIC PANEL SYSTEM

CLIN

0001AH

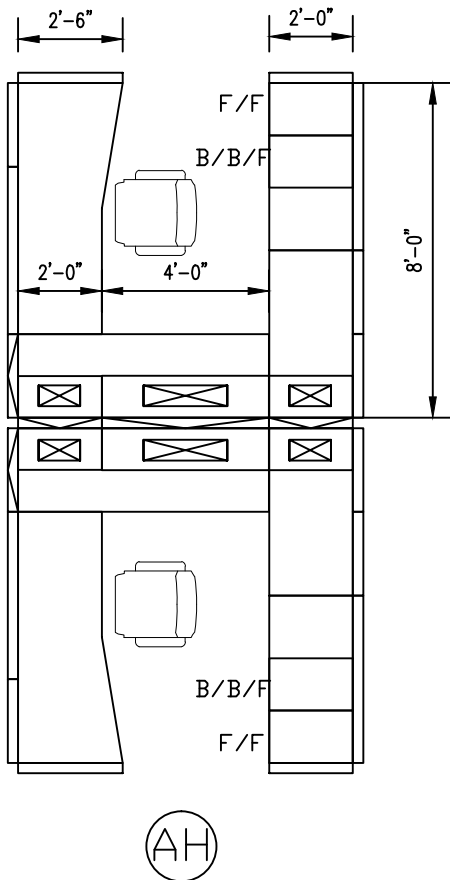

Approx Area: 128 Sq Ft

STANDARD COMPONENTS PER CUBICLE:

U-shaped worksurface with Wave top
 Standing height privacy (62" - 70" High Panels)
 Powered panels as shown →
 (3) Duplex Receptacles (6 plug in points) per cubicle
 (1) Voice & Data Quad port per cubicle
 (1) Power Pole per 2-pod
 Mid-grade recycled fabric, metal connectors
 All Connectors, finish trim, hardware and support
 Worksurfaces as shown - laminate with vinyl edge
 Storage:
 (1) B/B/F (2 Small drawers + 1 Large drawer)
 with locks, pencil tray and rails
 (1) F/F (2 Large drawers), with locks and rails
 Overheads - 8 lineal feet as shown →
 full length tackboards and task lights under each
 Includes lockable metal flipper doors for each
 Seating not included

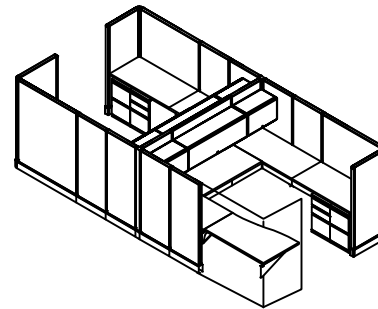

STANDARD MODIFICATIONS:

- 1M Panel height variation - Admin height (36" - 42"), removes overhead storage
- 2M Panel height variation - Seated Height Privacy (45" - 57"), removes overhead storage
- 5M Worksurface - change Wave top to 24 x 72" straight top (see Example C)
- 6M Change 24" x 72" worksurface to 30" Deep rectangular worksurface
- 9M8x8 Worksurface - change from U-shape to L-shape configuration (see Example B)
- 11M Storage - Change B/B/F to Mobile B/F pedestal with cushion
- 13M Panel power - Power ALL Panels
- 14M* Add Ergonomic Keyboard tray with Mouse attachment
- 15M Add Center Drawer
- 17M* Add 48" Panel Mounted Toolbar with (2) organizational accessories
- 18M* Add CPU Holder
- 19M* Add Monitor Arm
- 20M Add 6' of Transaction Counter top (42" high panels only)
- 21M* Task Light - Change to LED under cabinet task light
- 22M Add 24" wide Storage Tower with file drawers and closed shelving
- 23M Add 24" wide Storage Tower with Coat Close
- 24M Add Sliding Door (64" high panels only - See Example "C")
- 26M Add wood veneer worksurfaces in lieu of laminate

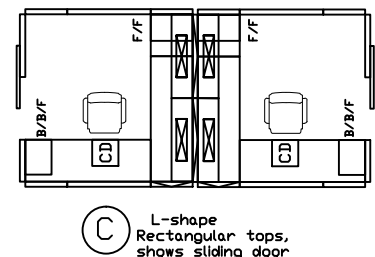
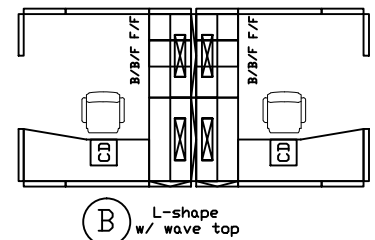

FCC TYPICALS - 8' X 8' - Quad

STAFF CUBE - LARGE

MONOLITHIC PANEL SYSTEM

CLIN

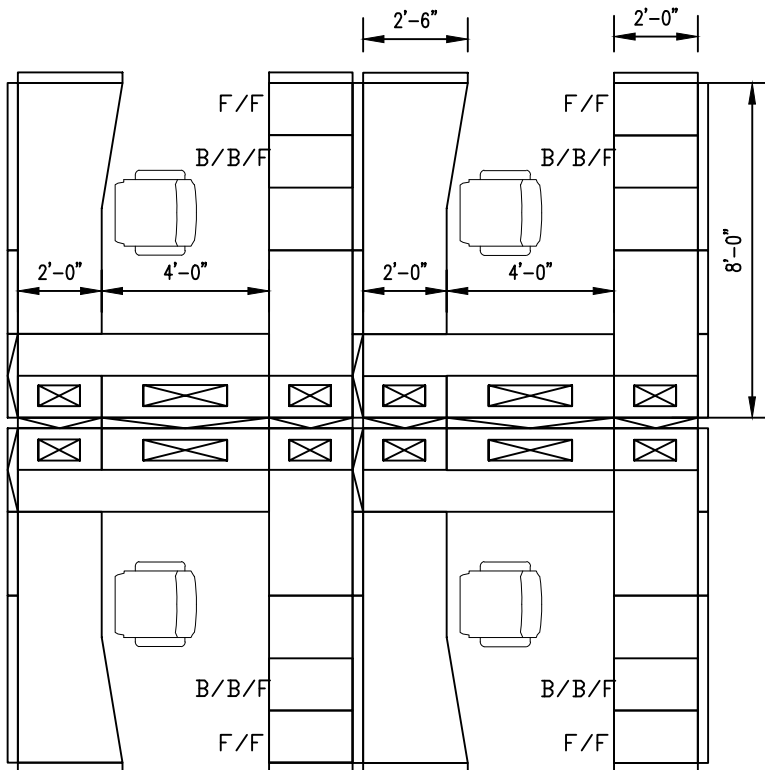

0001AJ



(AJ)

Approx Area: 256 Sq Ft

STANDARD COMPONENTS PER CUBICLE:

U-shaped worksurface with Wave top
 Standing height privacy (62" - 70" High Panels)
 Powered panels as shown → 
 (3) Duplex Receptacles (6 plug in points) per cubicle
 (1) Voice & Data Quad port per cubicle
 Power Pole
 Mid-grade recycled fabric, metal connectors
 All Connectors, finish trim, hardware and support
 Worksurfaces as shown - laminate with vinyl edge
 Storage:
 (1) B/B/F (2 Small drawers + 1 Large drawer)
 with locks, pencil tray and rails
 (1) F/F (2 Large drawers), with locks and rails
 Overheads - 8 lineal feet as shown → 
 full length tackboards and task lights under each
 Includes lockable metal flipper doors for each
 Seating not included

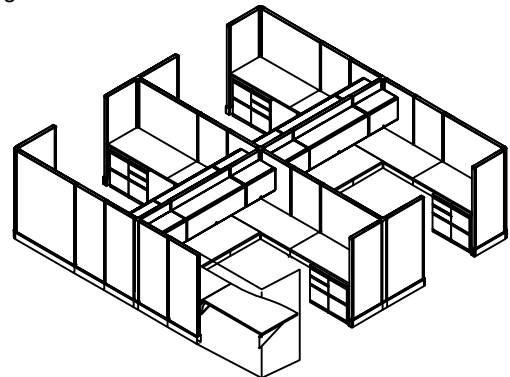

STANDARD MODIFICATIONS:

- 1M Panel height variation - Admin height (36" - 42"), removes overhead storage
- 2M Panel height variation - Seated Height Privacy (45" - 57"), removes overhead storage
- 5M Worksurface - change Wave top to 24 x 72" straight top (see Example C)
- 6M Change 24" x 72" worksurface to 30" Deep rectangular worksurface
- 9M8x8 Worksurface - change from U-shape to L-shape configuration (see Example B)
- 11M Storage - Change B/B/F to Mobile B/F pedestal with cushion
- 13M Panel power - Power ALL Panels
- 14M* Add Ergonomic Keyboard tray with Mouse attachment
- 15M Add Center Drawer
- 17M* Add 48" Panel Mounted Toolbar with (2) organizational accessories
- 18M* Add CPU Holder
- 19M* Add Monitor Arm
- 20M Add 6' of Transaction Counter top (42" high panels only)
- 21M* Task Light - Change to LED under cabinet task light
- 22M Add 24" wide Storage Tower with file drawers and closed shelving
- 23M Add 24" wide Storage Tower with Coat Closet
- 24M Add Sliding Door (64" high panels only - See Example "C")
- 26M Add wood veneer worksurfaces in lieu of laminate

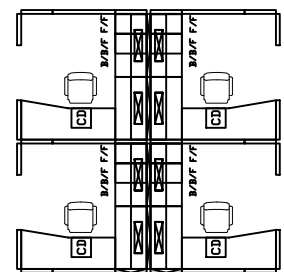

(B) L-shape w/ wave top

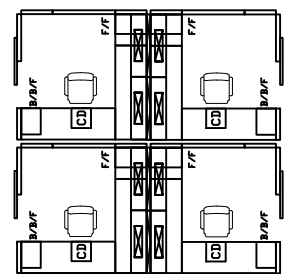

(C) L-shape Rectangular tops, shows sliding door

FCC TYPICALS - 8' X 10' - Single

MANAGER CUBE - SMALL

MONOLITHIC PANEL SYSTEM

CLIN

0001AK

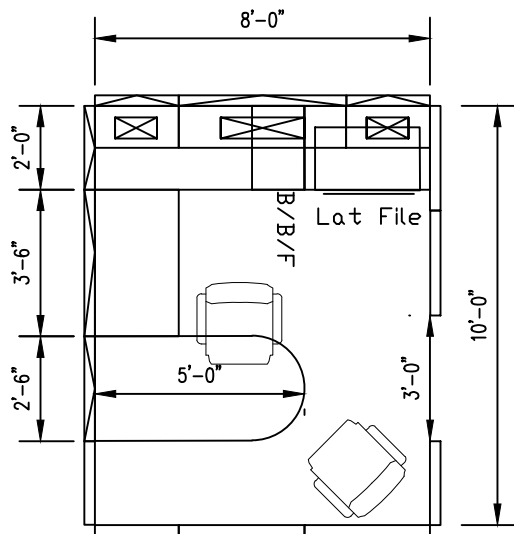

Cubicle Area: 80 Sq Ft

STANDARD COMPONENTS PER CUBICLE:

U-shaped worksurface with D-top
 Standing height privacy (62" - 70" High Panels)
 Powered panels as shown →
 (3) Duplex Receptacles (6 plug in points)
 (1) Voice & Data Quad port per cubicle
 Power Pole
 Mid-grade recycled fabric, metal connectors
 All Connectors, finish trim, hardware and support
 Worksurfaces as shown - laminate with vinyl edge
 Storage:
 (1) B/B/F (2 Small drawers + 1 Large drawer)
 with locks, pencil tray and rails
 (1) 30" wide, two drawer lateral file with lock and rails
 Overheads - 8 lineal feet as shown →
 full length tackboards and task lights under each
 Includes lockable metal flipper doors for each
 Seating not included

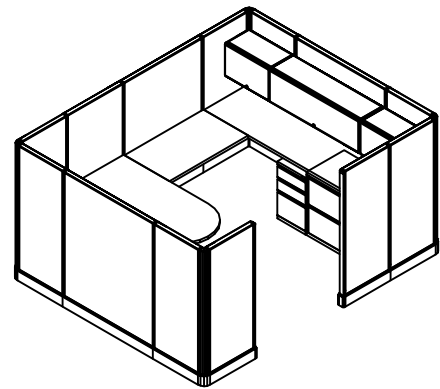

STANDARD MODIFICATIONS:

- 2M Panel height variation - Seated Height Privacy (45" - 57"), removes overhead storage
- 4M Panel height variation - Office Height Panels (76" - 81"), with door
- 7M Change 24" x 96" worksurface to be 30" Deep
- 8M Worksurface - change to Expanded U-shape with wave top (see Example B)
- 9M8x10 Worksurface - change from U-shape to L-shape configuration (see Example C)
- 11M Storage - Change B/B/F to Mobile B/F pedestal with cushion
- 13M Panel power - Power ALL Panels
- 14M* Add Ergonomic Keyboard tray with Mouse attachment
- 15M Add Center Drawer
- 17M* Add 48" Panel Mounted Toolbar with (2) organizational accessories
- 18M* Add CPU Holder
- 19M* Add Monitor Arm
- 21M* Task Light - Change to LED under cabinet task light
- 22M Add 24" wide Storage Tower with file drawers and closed shelving
- 23M Add 24" wide Storage Tower with Coat Closet
- 24M Add Sliding Door (64" high panels only - See Example "C")
- 26M Add wood veneer worksurfaces in lieu of laminate

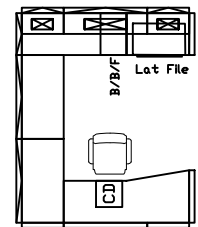

B Expanded U-shape w/ wave top

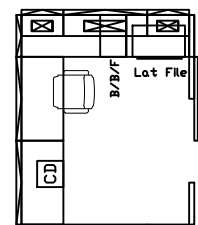

C L-shape Rectangular top shows sliding door

FCC TYPICALS - 8' X 10' - Double MANAGER CUBE - SMALL MONOLITHIC PANEL SYSTEM

CLIN

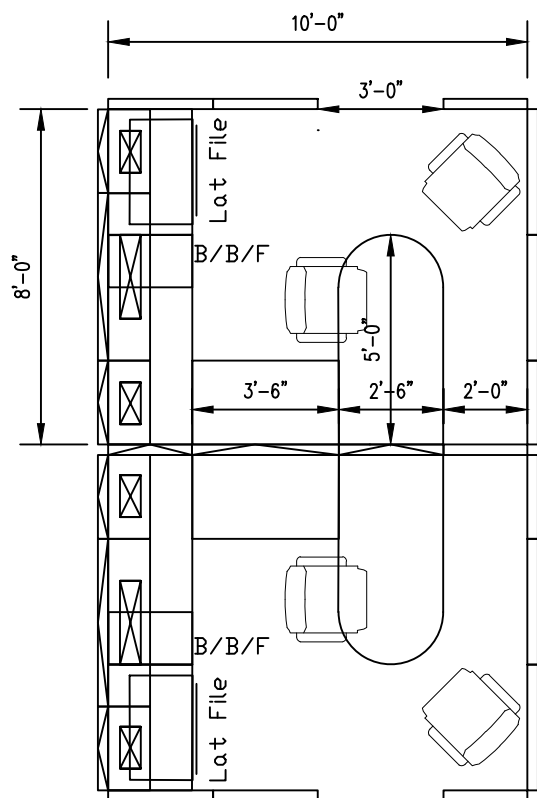

0001AL



AL

Approx Area: 160 Sq Ft

STANDARD COMPONENTS PER CUBICLE:

U-shaped worksurface with D-top
Standing height privacy (62" - 70" High Panels)
Powered panels as shown → 
(3) Duplex Receptacles (6 plug in points) per cubicle
(1) Voice & Data Quad port per cubicle
(1) Power Pole per 2-pod
Mid-grade recycled fabric, metal connectors
All Connectors, finish trim, hardware and support
Worksurfaces as shown - laminate with vinyl edge
Storage:
(1) B/B/F (2 Small drawers + 1 Large drawer)
with locks, pencil tray and rails
(1) 30" wide, two drawer lateral file with lock and rails
Overheads - 8 lineal feet as shown → 
full length tackboards and task lights under each
Includes lockable metal flipper doors for each
Seating not included

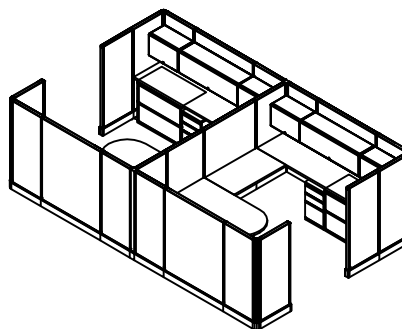

STANDARD MODIFICATIONS:

- 2M Panel height variation - Seated Height Privacy (45" - 57"), removes overhead storage
- 4M Panel height variation - Office Height Panels (76" - 81"), with door
- 7M Change 24" x 96" worksurface to be 30" Deep
- 8M Worksurface - change to Expanded U-shape with wave top (see Example B)
- 9M8x10 Worksurface - change from U-shape to L-shape configuration (see Example C)
- 11M Storage - Change B/B/F to Mobile B/F pedestal with cushion
- 13M Panel power - Power ALL Panels
- 14M* Add Ergonomic Keyboard tray with Mouse attachment
- 15M Add Center Drawer
- 17M* Add 48" Panel Mounted Toolbar with (2) organizational accessories
- 18M* Add CPU Holder
- 19M* Add Monitor Arm
- 21M* Task Light - Change to LED under cabinet task light
- 22M Add 24" wide Storage Tower with file drawers and closed shelving
- 23M Add 24" wide Storage Tower with Coat Closet
- 24M Add Sliding Door (64" high panels only - See Example "C")
- 26M Add wood veneer worksurfaces in lieu of laminate

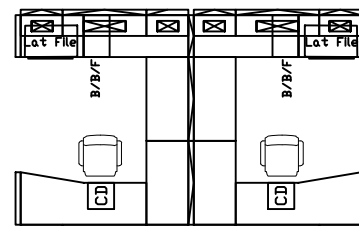

B Expanded U-shape
w/ wave top

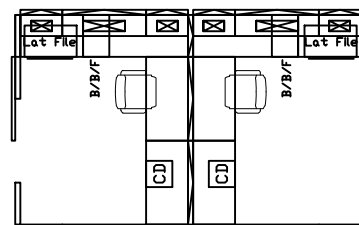

C L-shape
Rectangular top
shows sliding door

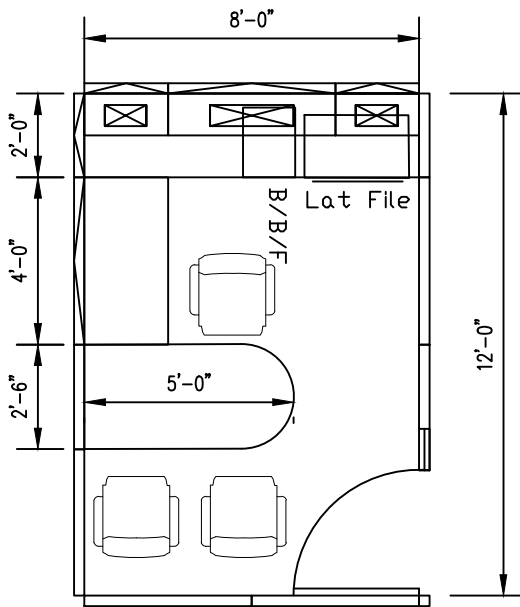

FCC TYPICALS - 8' X 12' - Single MANAGER CUBE - LARGE MONOLITHIC PANEL SYSTEM

CLIN
0001AM



Cubicle Area: 96 Sq Ft

STANDARD COMPONENTS PER CUBICLE:

U-shaped worksurface with D-top
Office Height Panels (76" - 81"), with door & sidelight
Powered panels as shown → 
(3) Duplex Receptacles (6 plug in points)
(1) Voice & Data Quad port per cubicle
Power Pole
Mid-grade recycled fabric, metal connectors
All Connectors, finish trim, hardware and support
Worksurfaces as shown - laminate with vinyl edge
Storage:
(1) B/B/F (2 Small drawers + 1 Large drawer)
with locks, pencil tray and rails
(1) 30" wide, two drawer lateral file with lock and rails
Overheads - 8 lineal feet as shown → 
full length tackboards and task lights under each
Includes lockable metal flipper doors for each
Seating not included

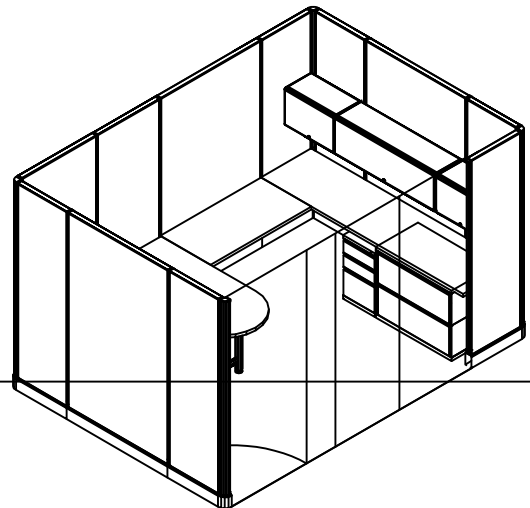

STANDARD MODIFICATIONS:

- 3M Panel variation - Standing height privacy (62" - 70" High Panels)
- 7M Change 24" x 96" worksurface to 30" Deep
- 11M Storage - Change B/B/F to Mobile B/F pedestal with cushion
- 13M Panel power - Power ALL Panels
- 14M* Add Ergonomic Keyboard tray with Mouse attachment
- 15M Add Center Drawer
- 17M* Add 48" Panel Mounted Toolbar with (2) organizational accessories
- 18M* Add CPU Holder
- 19M* Add Monitor Arm
- 21M* Task Light - Change to LED under cabinet task light
- 22M Add 24" wide Storage Tower with file drawers and closed shelving
- 23M Add 24" wide Storage Tower with Coat Closet
- 24M Add Sliding Door (64" high panels only - See Example "B")
- 26M Add wood veneer worksurfaces in lieu of laminate
- 27M Change D-top worksurface to P-top (See Example "C")

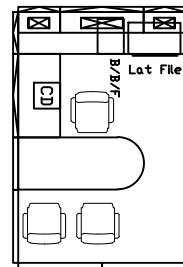

(B) U-shape station with a sliding door

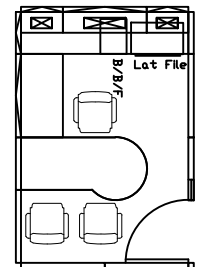

(C) U-shape station with a P-top

FCC TYPICALS - 8' X 12' - Double MANAGER CUBE - LARGE MONOLITHIC PANEL SYSTEM

CLIN

0001AN

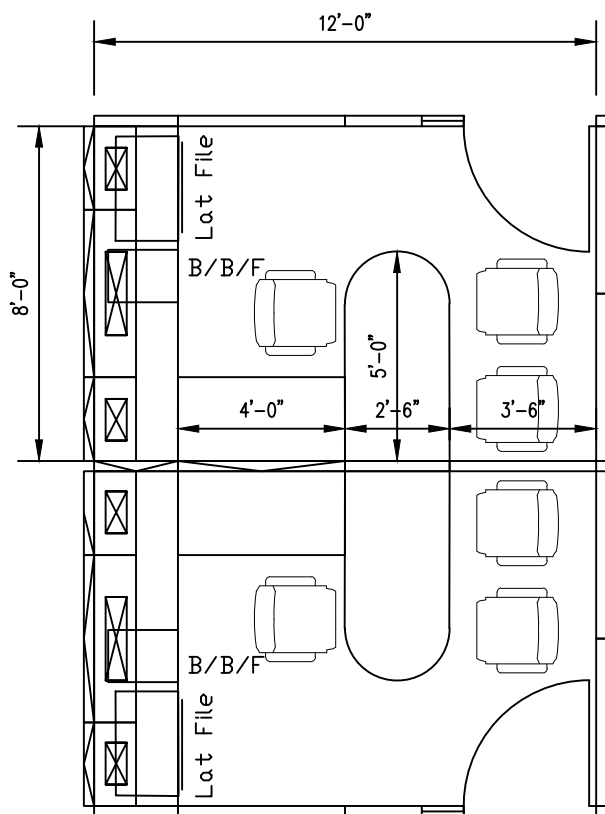

AN

Approx Area: 192 Sq Ft

STANDARD COMPONENTS PER CUBICLE:

U-shaped worksurface with D-top
Office Height Panels (76" - 81"), with door & sidelight
Powered panels as shown →
(3) Duplex Receptacles (6 plug in points) per cubicle
(1) Voice & Data Quad port per cubicle
(1) Power Pole per 2-pod
Mid-grade recycled fabric, metal connectors
All Connectors, finish trim, hardware and support
Worksurfaces as shown - laminate with vinyl edge
Storage:
(1) B/B/F (2 Small drawers + 1 Large drawer)
with locks, pencil tray and rails
(1) 30" wide, two drawer lateral file with lock and rails
Overheads - 8 lineal feet as shown →
full length tackboards and task lights under each
Includes lockable metal flipper doors on each
Seating not included

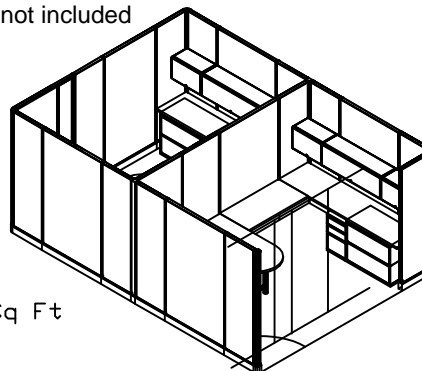

STANDARD MODIFICATIONS:

- 3M Panel variation - Standing height privacy (62" - 70" High Panels)
- 7M Change 24" x 96" worksurface to 30" Deep
- 11M Storage - Change B/B/F to Mobile B/F pedestal with cushion
- 13M Panel power - Power ALL Panels
- 14M* Add Ergonomic Keyboard tray with Mouse attachment
- 15M Add Center Drawer
- 17M* Add 48" Panel Mounted Toolbar with (2) organizational accessories
- 18M* Add CPU Holder
- 19M* Add Monitor Arm
- 21M* Task Light - Change to LED under cabinet task light
- 22M Add 24" wide Storage Tower with file drawers and closed shelving
- 23M Add 24" wide Storage Tower with Coat Closet
- 24M Add Sliding Door (64" high panels only - See Example "B")
- 26M Add wood veneer worksurfaces in lieu of laminate
- 27M Change D-top worksurface to P-top (See Example "C")

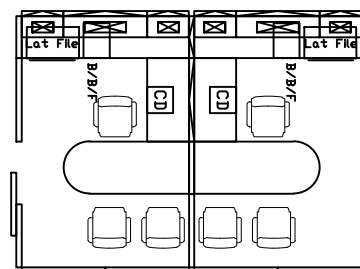

(B) U-shape station with a sliding door

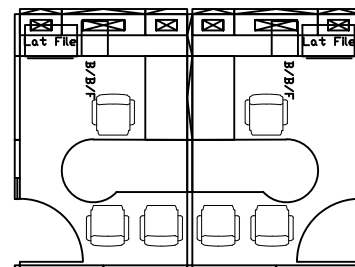

(C) U-shape station with a P-Top

FCC TYPICALS - 8' X 12'

2 - PERSON COLLABORATIVE STATION

MONOLITHIC PANEL SYSTEM

CLIN

0001AP

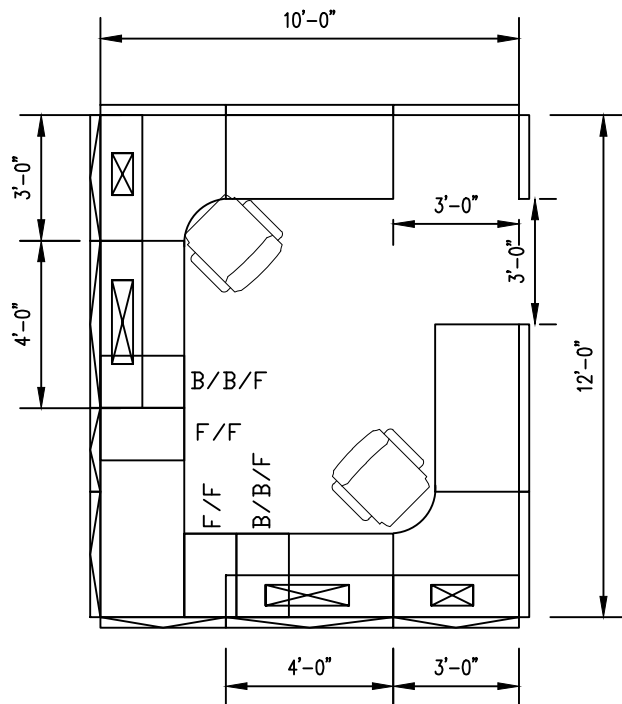

AP

Cubicle Area: 96 Sq Ft

(2) L-SHAPED WORKSTATIONS

STANDARD COMPONENTS PER CUBICLE:

Standing height privacy (62" - 70" High Panels)

Powered panels as shown →

(3) Duplex Receptacles (6 plug in points) per cubicle

(1) Voice & Data Quad port per cubicle

Power Pole

Mid-grade recycled fabric, metal connectors

All Connectors, finish trim, hardware and support

Worksurfaces as shown - laminate with vinyl edge

Storage:

(1) B/B/F (2 Small drawers + 1 Large drawer)

with locks, pencil tray and rails per station

(1) F/F (2 Large drawers), with locks and rails per station

Overheads - 7 lineal feet as shown per station →

full length tackboards and task lights under each

Includes lockable metal flipper doors for each

Seating not included

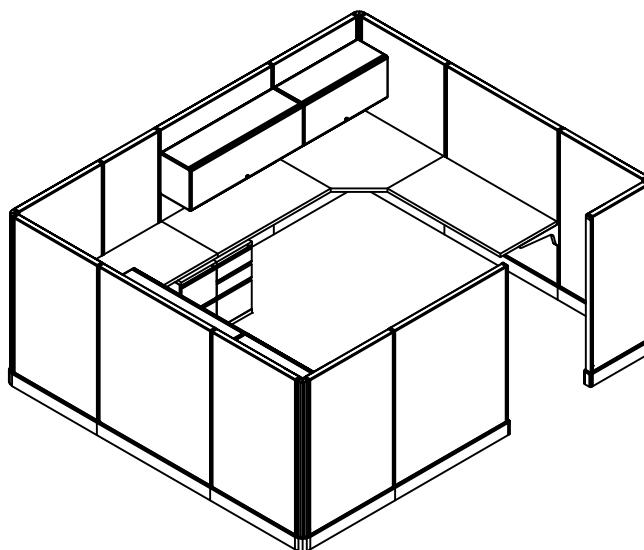

STANDARD MODIFICATIONS:

- 2M Panel height variation - Seated Height Privacy (45" - 57"), removes overhead storage
- 11M Storage - Change B/B/F to Mobile B/F pedestal with cushion
- 13M Panel power - Power ALL Panels
- 14M* Add Ergonomic Keyboard tray with Mouse attachment
- 15M Add Center Drawer
- 17M* Add 48" Panel Mounted Toolbar with (2) organizational accessories
- 18M* Add CPU Holder
- 19M* Add Monitor Arm
- 21M* Task Light - Change to LED under cabinet task light
- 26M Add wood veneer worksurfaces in lieu of laminate

FCC TYPICALS - 12'-3" X 15'-6"

4 - PERSON COLLABORATIVE STATION

MONOLITHIC PANEL SYSTEM

CLIN

0001AQ

(4) L-SHAPED WORKSTATIONS W/ FULL HT PANEL DIVIDERS IN BETWEEN AS SHOWN STANDARD COMPONENTS PER CUBICLE:

Standing height privacy (62" - 70" High Panels)

Powered panels as shown → 

(3) Duplex Receptacles (6 plug in points) per cubicle

(1) Voice & Data Quad port per cubicle

Power Pole

Mid-grade recycled fabric, metal connectors

All Connectors, finish trim, hardware and support

Worksurfaces as shown - laminate with vinyl edge

Storage:

(1) B/B/F (2 Small drawers + 1 Large drawer)

with locks, pencil tray and rails per station

(1) F/F (2 Large drawers), with locks and rails per station

(1) 36" 2H Lateral file with locks, rails & worksurface

Overhead shelves - 6 lin ft per station, plus (1) 36" 

with locks, tackboards and task lights under each

Includes lockable metal flipper doors for each

Note: Overall dimension may vary by 1" to 2" depending on panel thickness.

Seating not included

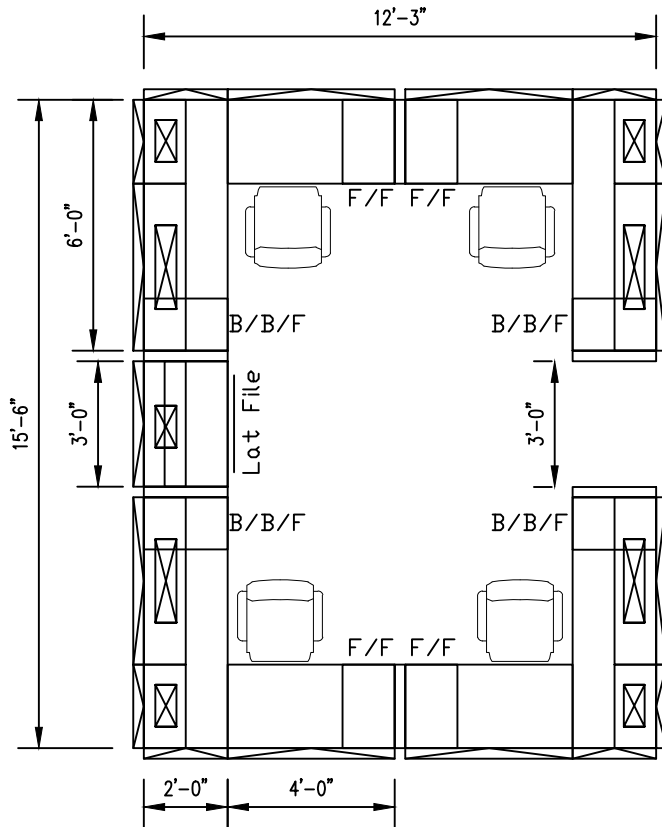

Cubicle Area: 190 Sq Ft

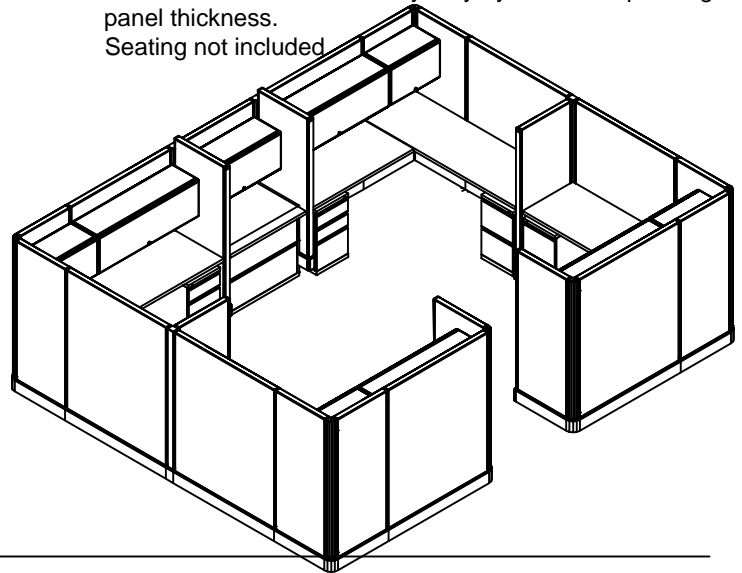

STANDARD MODIFICATIONS:

- 2M Panel height variation - Seated Height Privacy (45" - 57"), removes overhead storage
- 10M Change from "L" shaped to Corner workstations
- 11M Storage - Change B/B/F to Mobile B/F pedestal with cushion
- 13M Panel power - Power ALL Panels
- 14M* Add Ergonomic Keyboard tray with Mouse attachment
- 15M Add Center Drawer
- 17M* Add 48" Panel Mounted Toolbar with (2) organizational accessories
- 18M* Add CPU Holder
- 19M* Add Monitor Arm
- 21M* Task Light - Change to LED under cabinet task light
- 26M Add wood veneer worksurfaces in lieu of laminate

FCC TYPICALS - 15' X 16'

4 - COLLABORATIVE STATION

MONOLITHIC PANEL SYSTEM

CLIN

0001AR

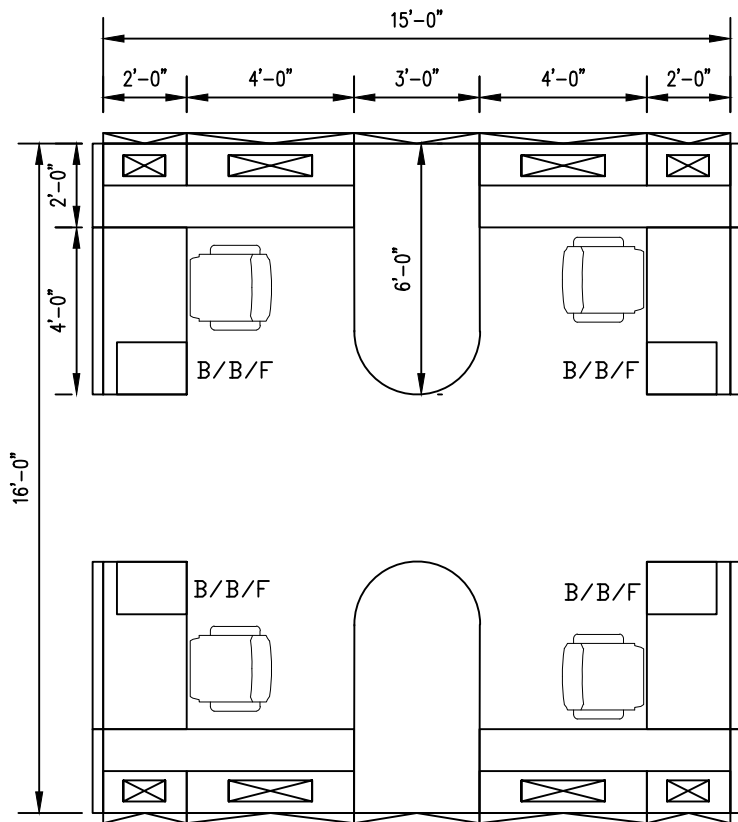

Cubicle Area: 240 Sq Ft

(4) L-SHAPED WORKSTATIONS W/ (2) 36" X 72" D-TOPS STANDARD COMPONENTS PER CUBICLE:

Standing height privacy (62" - 70" High Panels)

Powered panels as shown →

(3) Duplex Receptacles (6 plug in points) per cubicle

(1) Voice & Data Quad port per cubicle

Power Pole

Mid-grade recycled fabric, metal connectors

All Connectors, finish trim, hardware and support

Worksurfaces as shown - to include shared D-Top laminate with vinyl edge

Storage:

(1) B/B/F (2 Small drawers + 1 Large drawer)

with locks, pencil tray and rails per station

Overhead shelves 6 lineal feet per station

with locks, tackboards and task lights under each

with locks, tackboards and task lights under each

Includes lockable metal flipper doors for each

Seating not included

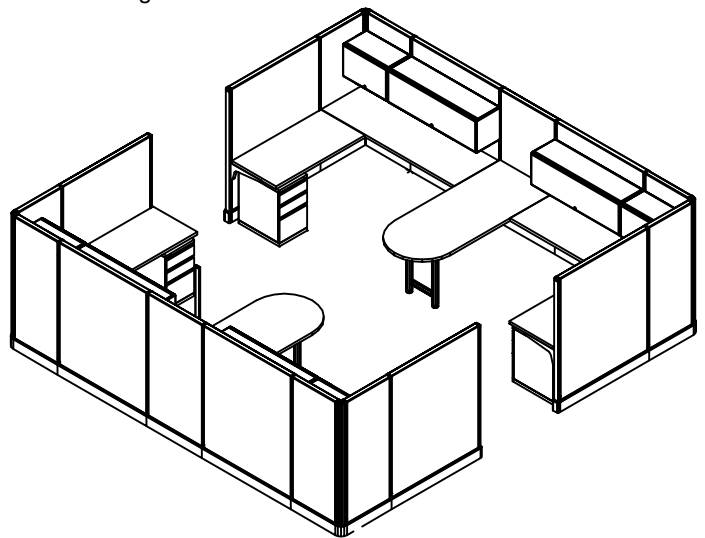

STANDARD MODIFICATIONS:

- 2M Panel height variation - Seated Height Privacy (45" - 57"), removes overhead storage
- 11M Storage - Change B/B/F to Mobile B/F pedestal with cushion
- 13M Add Power to ALL Panels
- 14M* Add Ergonomic Keyboard tray with Mouse attachment
- 15M Add Center Drawer
- 17M* Add 48" Panel Mounted Toolbar with (2) organizational accessories
- 18M* Add CPU Holder
- 19M* Add Monitor Arm
- 21M* Task Light - Change to LED under cabinet task light
- 26M Add wood veneer worksurfaces in lieu of laminate

FCC TYPICALS - 2' X 4'

SINGLE BENCHING STATION

MONOLITHIC PANEL SYSTEM

CLIN

0001AS

STANDARD COMPONENTS PER STATION:

Seated height privacy (45" - 57" High Panels)

Powered panels as shown → 

(2) Duplex Receptacles (4 plug in points)

(1) Voice & Data Quad port

Power Pole

Mid-grade recycled fabric, metal connectors

All Connectors, finish trim, hardware and support

Worksurfaces as shown - laminate with vinyl edge

Storage:

(1) B/B/F (2 Small drawers + 1 Large drawer),
with locks, pencil tray and rails

Full length tackboards above worksurface

Seating not included

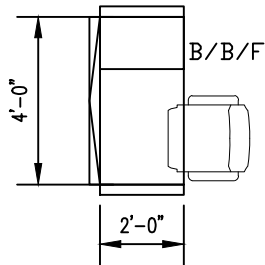

Cubicle Area: 8 Sq Ft

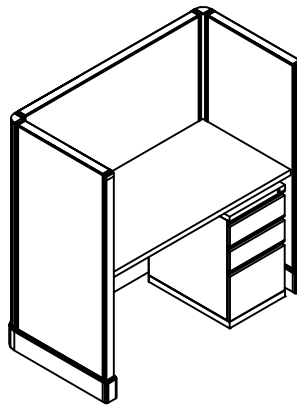

STANDARD MODIFICATIONS:

- 1M Panel height variation - Admin height (36" - 42"), removes overhead storage
- 3M Panel height variation -Standing Height Privacy (62" -70"),
- 11M Change B/B/F to mobile B/F with cushion
- 13M Panel power - Power ALL Panels
- 14M* Add Ergonomic Keyboard tray with Mouse attachment
- 17M* Add 48" Panel Mounted Toolbar with (2) organizational accessories
- 18M* Add CPU Holder

FCC TYPICALS - 2' X 8' - Double BENCHING STATION MONOLITHIC PANEL SYSTEM

CLIN

0001AT

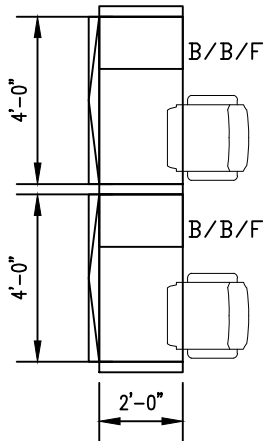

Approx Area: 16 Sq Ft

(2) PERSON BENCHING STATION STANDARD COMPONENTS PER STATION:

Seated height privacy (45" - 57" High Panels)

Powered panels as shown →

(2) Duplex Receptacles (4 plug in points) per station

(1) Voice & Data Quad port per station

(1) Power Pole per grouping of (2) stations

Mid-grade recycled fabric, metal connectors

All Connectors, finish trim, hardware and support

Worksurfaces as shown - laminate with vinyl edge

Storage:

(1) B/B/F (2 Small drawers + 1 Large drawer),
with locks, pencil tray and rails

Full length tackboards above worksurface

Note: Overall dimension may vary depending on panel thickness

Seating not included

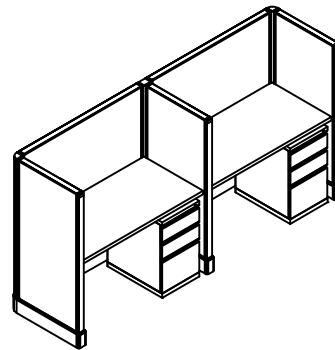

STANDARD MODIFICATIONS:

- 1M Panel height variation - Admin height (36" - 42"), removes overhead storage
- 3M Panel height variation - Standing Height Privacy (62" - 70"),
- 11M Change B/B/F to mobile B/F with cushion
- 13M Panel power - Power ALL Panels
- 14M* Add Ergonomic Keyboard tray with Mouse attachment
- 17M* Add 48" Panel Mounted Toolbar with (2) organizational accessories
- 18M* Add CPU Holder

FCC TYPICALS - 2' X 16' Quad

4-PERSON BENCHING STATION

MONOLITHIC PANEL SYSTEM

CLIN

0001AU

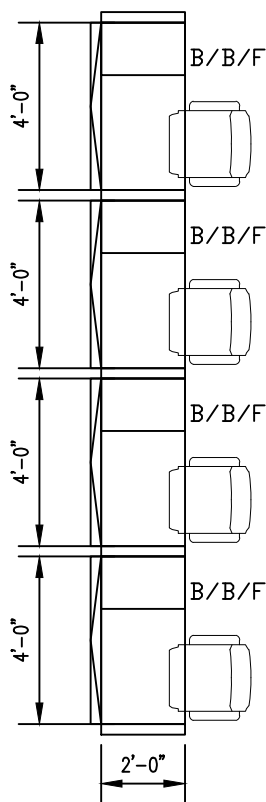

Approx Area: 32 Sq Ft

(4) PERSON BENCHING STATION

STANDARD COMPONENTS PER STATION:

Seated height privacy (45" - 57" High Panels)

Powered panels as shown →

(2) Duplex Receptacles (4 plug in points) per station

(1) Voice & Data Quad port per station

(1) Power Pole per grouping of (4) stations

Mid-grade recycled fabric, metal connectors

All Connectors, finish trim, hardware and support

Worksurfaces as shown - laminate with vinyl edge

Storage:

(1) B/B/F (2 Small drawers + 1 Large drawer),
with locks, pencil tray and rails

Full length tackboards above worksurface

Note: Overall dimension may vary depending on panel thickness.

Seating not included

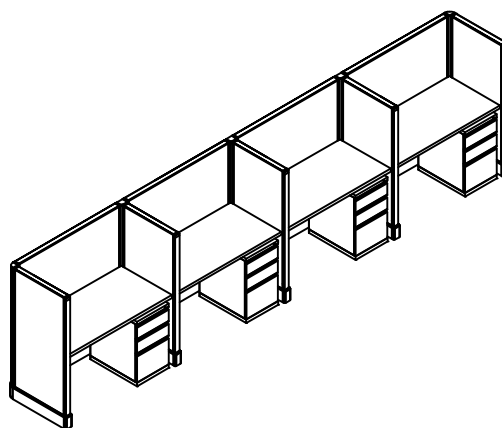

STANDARD MODIFICATIONS:

- 1M Panel height variation - Admin height (36" - 42"), removes overhead storage
- 3M Panel height variation -Standing Height Privacy (62" -70"),
- 11M Change B/B/F to mobile B/F with cushion
- 13M Panel power - Power ALL Panels
- 14M* Add Ergonomic Keyboard tray with Mouse attachment
- 17M* Add 48" Panel Mounted Toolbar with (2) organizational accessories
- 18M* Add CPU Holder

FCC TYPICALS - 6' X 6' - Single

STAFF CUBE - EFFICIENCY

STACKABLE PANEL SYSTEM

CLIN

0001BA

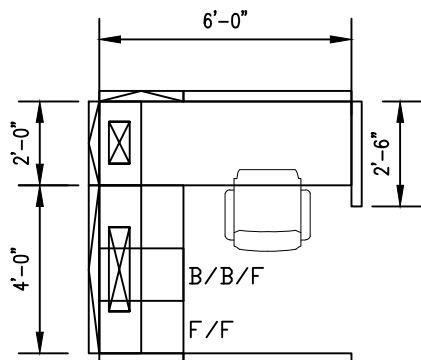

Cubicle Area: 36 Sq Ft

STANDARD COMPONENTS PER CUBICLE:

L-shaped worksurface configuration

Standing height privacy (62" - 70" High Panels)

includes 45"-57" base panels with stack panels above

Powered panels as shown →

(3) Duplex Receptacles (6 plug in points)

(1) Voice & Data Quad port

Power Pole

Mid-grade recycled fabric, metal connectors

All Connectors, finish trim, hardware and support

Worksurfaces as shown - laminate with vinyl edge

Storage:

(1) B/B/F (2 Small drawers + 1 Large drawer),
with locks, pencil tray and rails

(1) F/F (2 Large drawers), with locks and rails

Overheads 6 lineal feet as shown →

full length tackboards and task light under each

Includes lockable metal flipper doors for each

Seating not included

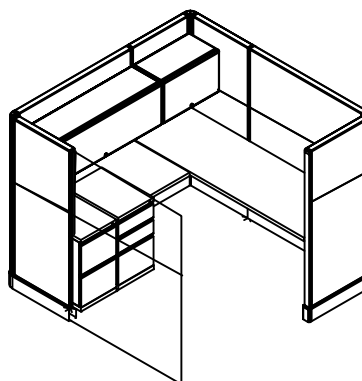

STANDARD MODIFICATIONS:

- 1S Panel height variation - Admin height (36" - 42"), removes overhead storage
- 2S Panel height variation - Seated Height Privacy (45" - 57"), removes overhead storage
- 5S Worksurface - change a 24" x 72" straight top to a wave top (see Example B)
- 10S Worksurface - add corner worksurface (see Example C)
- 11S Change B/B/F to mobile B/F with cushion
- 13S Panel power - Power ALL Panels
- 14S* Add Ergonomic Keyboard tray with Mouse attachment
- 17S* Add 48" Panel Mounted Toolbar with (2) organizational accessories
- 18S* Add CPU Holder
- 19S* Add Monitor Arm
- 20S Add 6' of Transaction Counter top (42" high panels only)
- 21S* Task Light - Change to LED under cabinet task light
- 26S Add wood veneer worksurfaces in lieu of laminate

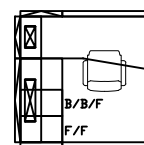

L-shape
w/ wave top

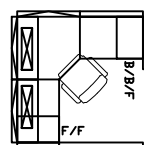

Corner Worksurface

FCC TYPICALS - 6' X 6' - Double STAFF CUBE - EFFICIENCY STACKABLE PANEL SYSTEM

CLIN

0001BB

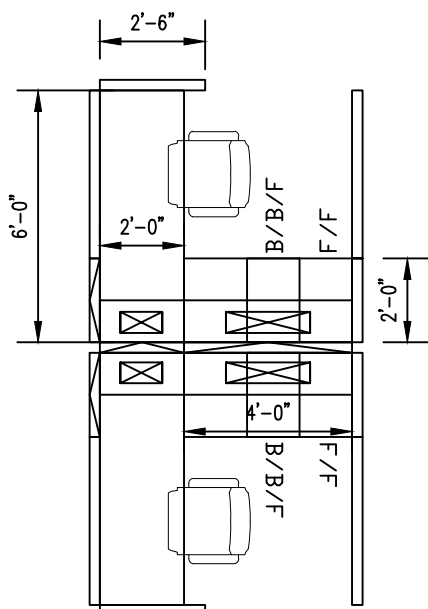

BB

Approx Area: 72 Sq Ft

STANDARD COMPONENTS PER CUBICLE:

L-shaped worksurface configuration

Standing height privacy (62" - 70" High Panels)

includes 45"-57" base panels with stack panels above

Powered panels as shown →

(3) Duplex Receptacles (6 plug in points) per cubicle

(1) Voice & Data Quad port per cubicle

(1) Power Pole per 2-pod

Mid-grade recycled fabric, metal connectors

All Connectors, finish trim, hardware and support

Worksurfaces as shown - laminate with vinyl edge

Storage:

(1) B/B/F (2 Small drawers + 1 Large drawer),

with locks, pencil tray and rails

(1) F/F (2 Large drawers), with locks and rails

Overheads 6 lineal feet as shown →

full length tackboards and task light under each

Includes lockable metal flipper doors for each

Seating not included

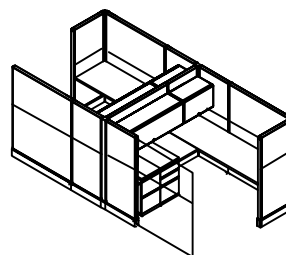

STANDARD MODIFICATIONS:

- 1S Panel height variation - Admin height (36" - 42"), removes overhead storage
- 2S Panel height variation - Seated Height Privacy (45" - 57"), removes overhead storage
- 5S Worksurface - change 24 x 72" straight top to wave top (see Example B)
- 10S Worksurface - add corner worksurface (see Example C)
- 11S Change B/B/F to mobile B/F with cushion
- 13S Panel power - Power ALL Panels
- 14S* Add Ergonomic Keyboard tray with Mouse attachment
- 17S* Add 48" Panel Mounted Toolbar with (2) organizational accessories
- 18S* Add CPU Holder
- 19S* Add Monitor Arm
- 20S Add 6" of Transaction Counter top (42" high panels only)
- 21S* Task Light - Change to LED under cabinet task light
- 26S Add wood veneer worksurfaces in lieu of laminate

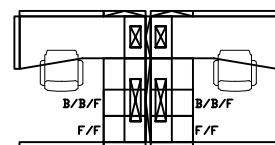

B L-shape
w/ wave top

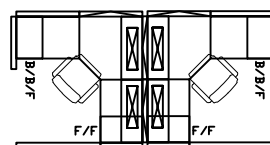

C Corner Worksurface

FCC TYPICALS - 6' X 6' - Quad

STAFF CUBE - EFFICIENCY

STACKABLE PANEL SYSTEM

CLIN

0001BC

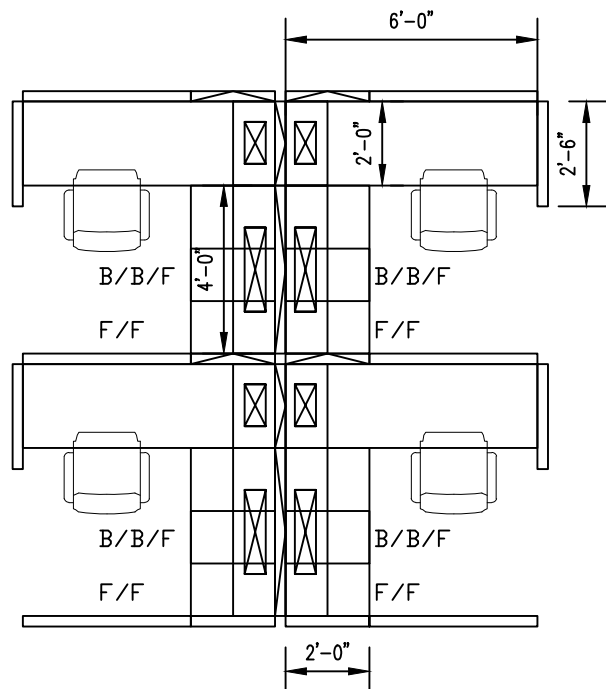

Approx Area: 144 Sq Ft

STANDARD COMPONENTS PER CUBICLE:

L-shaped worksurface configuration

Standing height privacy (62" - 70" High Panels)

includes 45"-57" base panels with stack panels above

Powered panels as shown →

(3) Duplex Receptacles (6 plug in points) per cubicle

(1) Voice & Data Quad port per cubicle

Power Pole

Mid-grade recycled fabric, metal connectors

All Connectors, finish trim, hardware and support

Worksurfaces as shown - laminate with vinyl edge

Storage:

(1) B/B/F (2 Small drawers + 1 Large drawer),

with locks, pencil tray and rails

(1) F/F (2 Large drawers), with locks and rails

Overheads 6 lineal feet as shown →

full length tackboards and task light under each

Includes lockable metal flipper doors for each

Seating not included

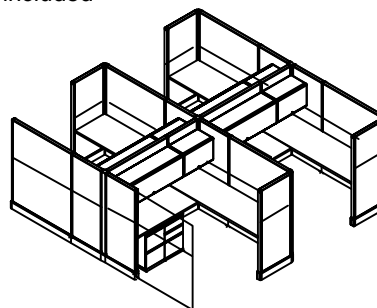

STANDARD MODIFICATIONS:

- 1S Panel height variation - Admin height (36" - 42"), removes overhead storage
- 2S Panel height variation - Seated Height Privacy (45" - 57"), removes overhead storage
- 5S Worksurface - change 24 x 72" straight top to wave top (see Example B)
- 10S Worksurface - add corner worksurface (see Example C)
- 11S Change B/B/F to mobile B/F with cushion
- 13S Panel power - Power ALL Panels
- 14S* Add Ergonomic Keyboard tray with Mouse attachment
- 17S* Add 48" Panel Mounted Toolbar with (2) organizational accessories
- 18S* Add CPU Holder
- 19S* Add Monitor Arm
- 20S Add 6" of Transaction Counter top (42" high panels only)
- 21S* Task Light - Change to LED under cabinet task light
- 26S Add wood veneer worksurfaces in lieu of laminate

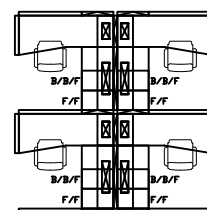

B L-shape w/ wave top

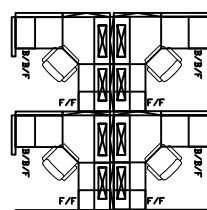

C Corner Worksurface

FCC TYPICALS - 6' X 8' - Single

STAFF CUBE - SMALL

STACKABLE PANEL SYSTEM

CLIN

0001BD

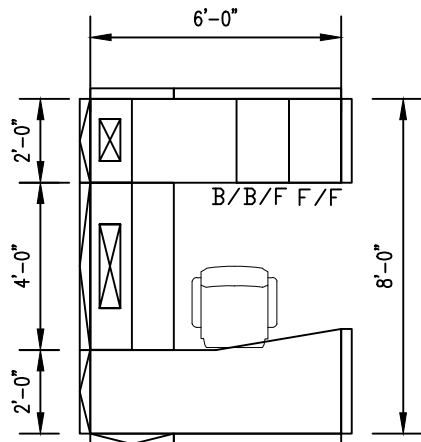

Cubicle Area: 48 Sq Ft

STANDARD COMPONENTS PER CUBICLE:

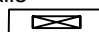
- U-shaped worksurface with Wave top
- Standing height privacy (62" - 70" High Panels)
includes 45"-57" base panels with stack panels above
- Powered panels as shown → 
 - (3) Duplex Receptacles (6 plug in points)
 - (1) Voice & Data Quad port per cubicle
 - Power Pole
 - Mid-grade recycled fabric, metal connectors
- All Connectors, finish trim, hardware and support
- Worksurfaces as shown - laminate with vinyl edge
- Storage:
 - (1) B/B/F (2 Small drawers + 1 Large drawer)
with locks, pencil tray and rails
 - (1) F/F (2 Large drawers), with locks and rails
- Overheads - 6 lineal feet as shown → 
 - full length tackboards and task lights under each
 - Includes lockable metal flipper doors for each
- Seating not included

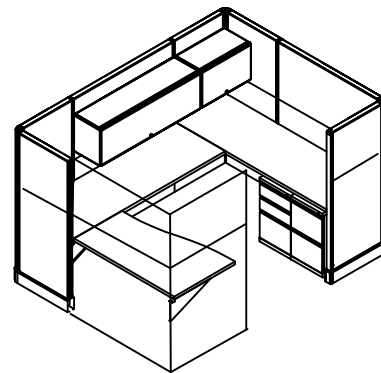

STANDARD MODIFICATIONS:

- 1S Panel height variation - Admin height (36" - 42"), removes overhead storage
- 2S Panel height variation - Seated Height Privacy (45" - 57"), removes overhead storage
- 5S Worksurface - change Wave top to 24 x 72" straight top (see Example C)
- 6S Change 24" x 72" worksurface to 30" Deep rectangular worksurface
- 9S6x8 Worksurface - change from U-shape to L-shape configuration (see Example B)
- 11S Storage - Change B/B/F to Mobile B/F pedestal with cushion
- 13S Panel power - Power ALL Panels
- 14S* Add Ergonomic Keyboard tray with Mouse attachment
- 15S Add Center Drawer
- 17S* Add 48" Panel Mounted Toolbar with (2) organizational accessories
- 18S* Add CPU Holder
- 19S* Add Monitor Arm
- 20S Add 6' of Transaction Counter top (42" high panels only)
- 21S* Task Light - Change to LED under cabinet task light
- 24S Add Sliding Door (64" high panels only)
- 26S Add wood veneer worksurfaces in lieu of laminate

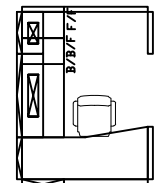

B L-shape
w/ wave top

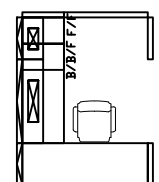

C L-shape
Rectangular

FCC TYPICALS - 6' X 8' - Double

STAFF CUBE - SMALL

STACKABLE PANEL SYSTEM

CLIN

0001BE

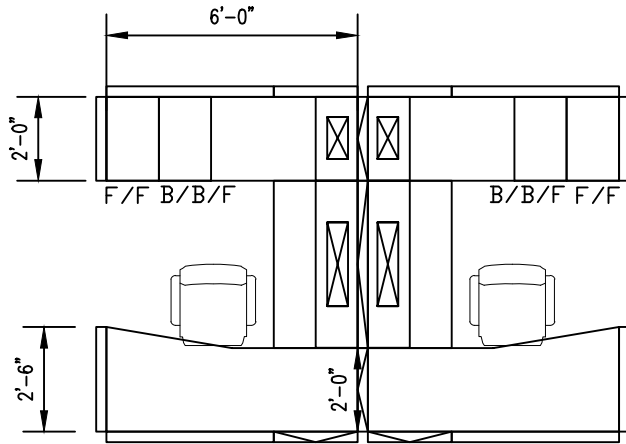

Approx Area: 96 Sq Ft

STANDARD COMPONENTS PER CUBICLE:

- U-shaped worksurface with Wave top
- Standing height privacy (62" - 70" High Panels)
includes 45"-57" base panels with stack panels above
- Powered panels as shown →
- (3) Duplex Receptacles (6 plug in points) per cubicle
- (1) Voice & Data Quad port per cubicle
- (1) Power Pole per 2-pod
- Mid-grade recycled fabric, metal connectors
- All Connectors, finish trim, hardware and support
- Worksurfaces as shown - laminate with vinyl edge
- Storage:
- (1) B/B/F (2 Small drawers + 1 Large drawer)
with locks, pencil tray and rails
- (1) F/F (2 Large drawers), with locks and rails
- Overheads - 6 lineal feet as shown →
- full length tackboards and task lights under each
- Includes lockable metal flipper doors for each
- Seating not included

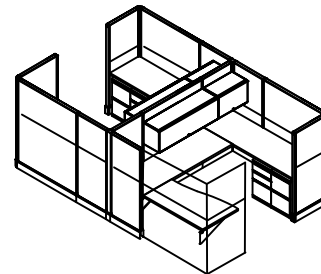

STANDARD MODIFICATIONS:

- 1S Panel height variation - Admin height (36" - 42"), removes overhead storage
- 2S Panel height variation - Seated Height Privacy (45" - 57"), removes overhead storage
- 5S Worksurface - change Wave top to 24 x 72" straight top (see Example C)
- 6S Change 24" x 72" worksurface to 30" Deep rectangular worksurface
- 9S6x8 Worksurface - change from U-shape to L-shape configuration (see Example B)
- 11S Storage - Change B/B/F to Mobile B/F pedestal with cushion
- 13S Panel power - Power ALL Panels
- 14S* Add Ergonomic Keyboard tray with Mouse attachment
- 15S Add Center Drawer
- 17S* Add 48" Panel Mounted Toolbar with (2) organizational accessories
- 18S* Add CPU Holder
- 19S* Add Monitor Arm
- 20S Add 6' of Transaction Counter top (42" high panels only)
- 21S* Task Light - Change to LED under cabinet task light
- 24S Add Sliding Door (64" high panels only)
- 26S Add wood veneer worksurfaces in lieu of laminate

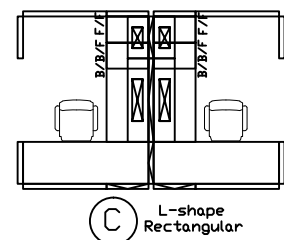
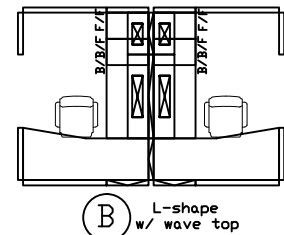

FCC TYPICALS - 6' X 8' - Quad

STAFF CUBE - SMALL

STACKABLE PANEL SYSTEM

CLIN

0001BF

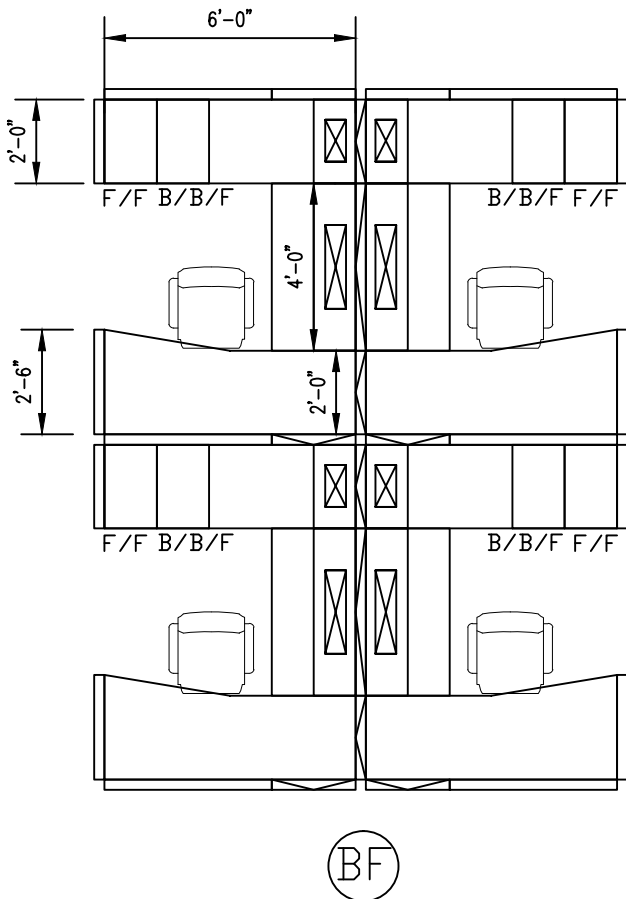

Approx Area: 192 Sq Ft

STANDARD COMPONENTS PER CUBICLE:

- U-shaped worksurface with Wave top
- Standing height privacy (62" - 70" High Panels)
includes 45"-57" base panels with stack panels above
- Powered panels as shown →
- (3) Duplex Receptacles (6 plug in points) per cubicle
- (1) Voice & Data Quad port per cubicle
- Power Pole
- Mid-grade recycled fabric, metal connectors
- All Connectors, finish trim, hardware and support
- Worksurfaces as shown - laminate with vinyl edge
- Storage:
- (1) B/B/F (2 Small drawers + 1 Large drawer)
with locks, pencil tray and rails
- (1) F/F (2 Large drawers), with locks and rails
- Overheads - 6 lineal feet as shown →
- full length tackboards and task lights under each
- Includes lockable metal flipper doors for each
- Seating not included

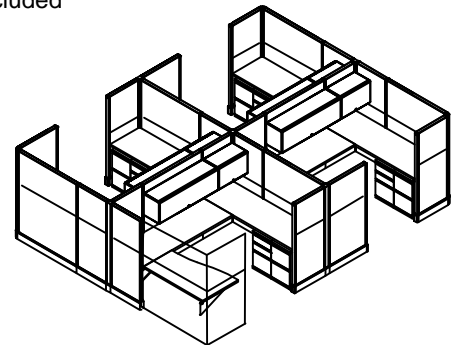

STANDARD MODIFICATIONS:

- 1S Panel height variation - Admin height (36" - 42"), removes overhead storage
- 2S Panel height variation - Seated Height Privacy (45" - 57"), removes overhead storage
- 5S Worksurface - change Wave top to 24 x 72" straight top (see Example C)
- 6S Change 24" x 72" worksurface to 30" Deep rectangular worksurface
- 9S6x8 Worksurface - change from U-shape to L-shape configuration (see Example B)
- 11S Storage - Change B/B/F to Mobile B/F pedestal with cushion
- 13S Panel power - Power ALL Panels
- 14S* Add Ergonomic Keyboard tray with Mouse attachment
- 15S Add Center Drawer
- 17S* Add 48" Panel Mounted Toolbar with (2) organizational accessories
- 18S* Add CPU Holder
- 19S* Add Monitor Arm
- 20S Add 6' of Transaction Counter top (42" high panels only)
- 21S* Task Light - Change to LED under cabinet task light
- 24S Add Sliding Door (64" high panels only)
- 26S Add wood veneer worksurfaces in lieu of laminate

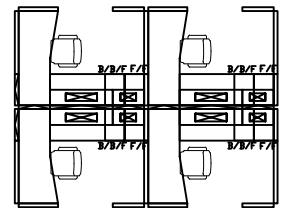

(B) L-shape
w/ wave top

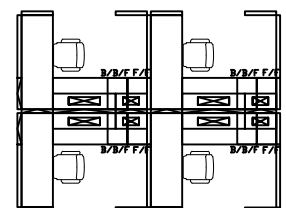

(C) L-shape
Rectangular

FCC TYPICALS - 8' X 8' - Single

STAFF CUBE - LARGE

STACKABLE PANEL SYSTEM

CLIN

0001BG

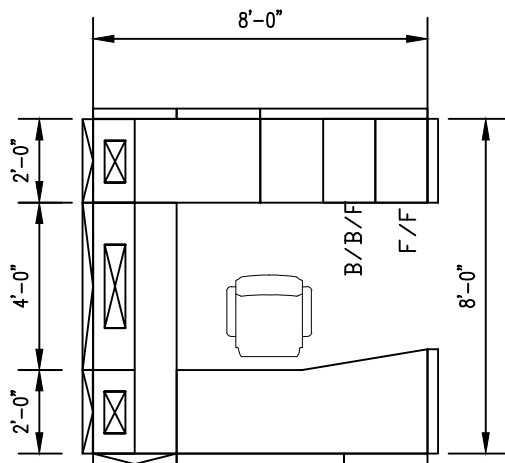

Cubicle Area: 64 Sq Ft

STANDARD COMPONENTS PER CUBICLE:

U-shaped worksurface with Wave top
 Standing height privacy (62" - 70" High Panels)
 includes 45"-57" base panels with stack panels
 Powered panels as shown →
 (3) Duplex Receptacles (6 plug in points)
 (1) Voice & Data Quad port per cubicle
 Power Pole
 Mid-grade recycled fabric, metal connectors
 All Connectors, finish trim, hardware and support
 Worksurfaces as shown - laminate with vinyl edge
 Storage:
 (1) B/B/F (2 Small drawers + 1 Large drawer)
 with locks, pencil tray and rails
 (1) F/F (2 Large drawers), with locks and rails
 Overheads - 8 lineal feet as shown →
 full length tackboards and task lights under each
 Includes lockable metal flipper doors for each
 Seating not included

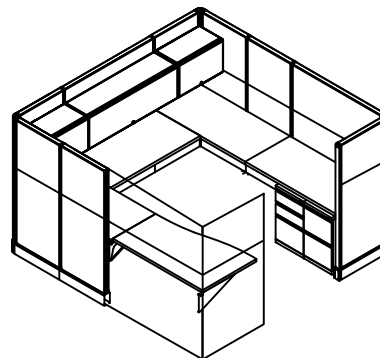

STANDARD MODIFICATIONS:

- 1S Panel height variation - Admin height (36" - 42"), removes overhead storage
- 2S Panel height variation - Seated Height Privacy (45" - 57"), removes overhead storage
- 5S Worksurface - change Wave top to 24 x 72" straight top (see Example C)
- 6S Change 24" x 72" worksurface to 30" Deep rectangular worksurface
- 9S8x8 Worksurface - change from U-shape to L-shape configuration (see Example B)
- 11S Storage - Change B/B/F to Mobile B/F pedestal with cushion
- 13S Panel power - Power ALL Panels
- 14S* Add Ergonomic Keyboard tray with Mouse attachment
- 15S Add Center Drawer
- 17S* Add 48" Panel Mounted Toolbar with (2) organizational accessories
- 18S* Add CPU Holder
- 19S* Add Monitor Arm
- 20S Add 6" of Transaction Counter top (42" high panels only)
- 21S* Task Light - Change to LED under cabinet task light
- 22S Add 24" wide Storage Tower with file drawers and closed shelving
- 23S Add 24" wide Storage Tower with Coat Closet
- 24S Add Sliding Door (64" high panels only - (see Example "C"))
- 26S Add wood veneer worksurfaces in lieu of laminate

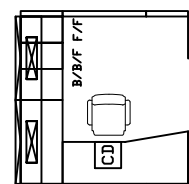

B L-shape
w/ wave top

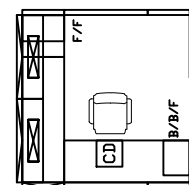

C L-shape
Rectangular tops,
shows sliding door

FCC TYPICALS - 8' X 8' - Double

STAFF CUBE - LARGE

STACKABLE PANEL SYSTEM

CLIN

0001BH

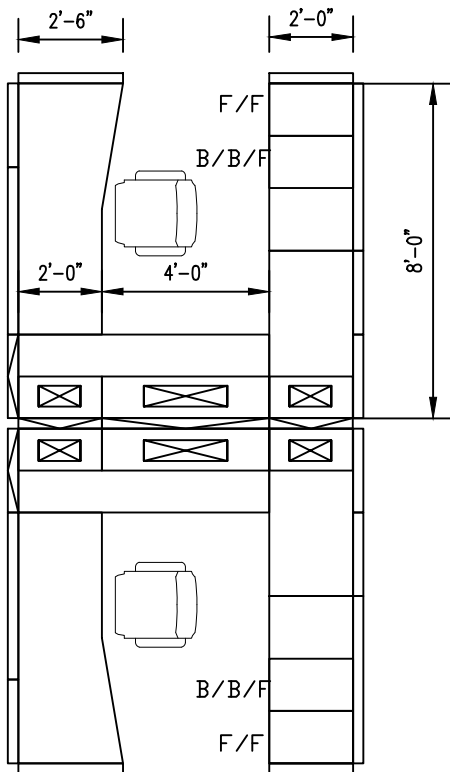

Approx Area: 128 Sq Ft

STANDARD COMPONENTS PER CUBICLE:

U-shaped worksurface with Wave top
 Standing height privacy (62" - 70" High Panels)
 includes 45"-57" base panels with stack panels
 Powered panels as shown →
 (3) Duplex Receptacles (6 plug in points) per cubicle
 (1) Voice & Data Quad port per cubicle
 (1) Power Pole per 2-pod
 Mid-grade recycled fabric, metal connectors
 All Connectors, finish trim, hardware and support
 Worksurfaces as shown - laminate with vinyl edge
 Storage:
 (1) B/B/F (2 Small drawers + 1 Large drawer)
 with locks, pencil tray and rails
 (1) F/F (2 Large drawers), with locks and rails
 Overheads - 8 lineal feet as shown →
 full length tackboards and task lights under each
 Includes lockable metal flipper doors on each
 Seating not included

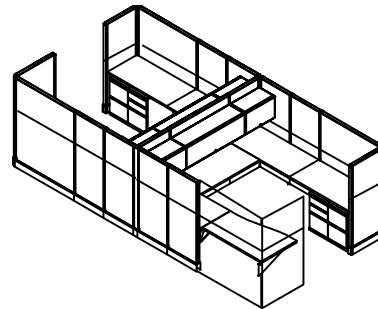

STANDARD MODIFICATIONS:

- 1S Panel height variation - Admin height (36" - 42"), removes overhead storage
- 2S Panel height variation - Seated Height Privacy (45" - 57"), removes overhead storage
- 5S Worksurface - change Wave top to 24 x 72" straight top (see Example C)
- 6S Change 24" x 72" worksurface to 30" Deep rectangular worksurface
- 9S8x8 Worksurface - change from U-shape to L-shape configuration (see Example B)
- 11S Storage - Change B/B/F to Mobile B/F pedestal with cushion
- 13S Panel power - Power ALL Panels
- 14S* Add Ergonomic Keyboard tray with Mouse attachment
- 15S Add Center Drawer
- 17S* Add 48" Panel Mounted Toolbar with (2) organizational accessories
- 18S* Add CPU Holder
- 19S* Add Monitor Arm
- 20S Add 6" of Transaction Counter top (42" high panels only)
- 21S* Task Light - Change to LED under cabinet task light
- 22S Add 24" wide Storage Tower with file drawers and closed shelving
- 23S Add 24" wide Storage Tower with Coat Close
- 24S Add Sliding Door (64" high panels only - See Example "C")
- 26S Add wood veneer worksurfaces in lieu of laminate

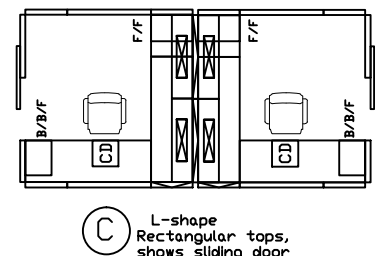
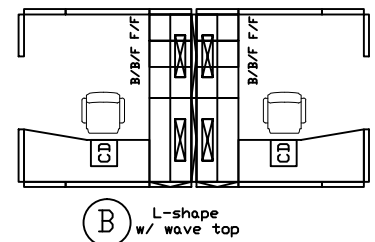

FCC TYPICALS - 8' X 8' - Quad

STAFF CUBE - LARGE

STACKABLE PANEL SYSTEM

CLIN

0001BJ

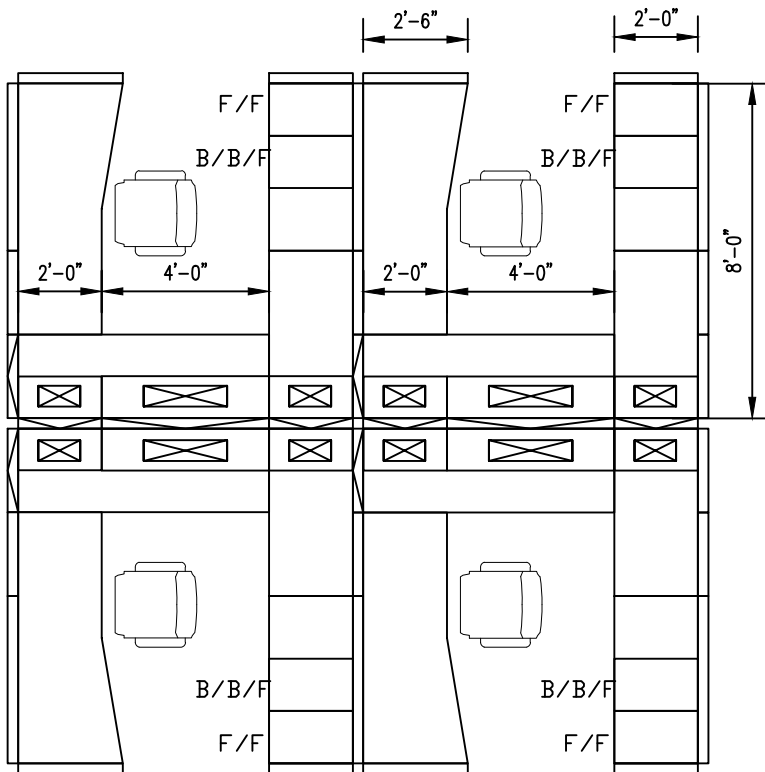

(BJ)

Approx Area: 256 Sq Ft

STANDARD COMPONENTS PER CUBICLE:

- U-shaped worksurface with Wave top
- Standing height privacy (62" - 70" High Panels)
includes 45"-57" base panels with stack panels
- Powered panels as shown →
- (3) Duplex Receptacles (6 plug in points) per cubicle
- (1) Voice & Data Quad port per cubicle
- Power Pole
- Mid-grade recycled fabric, metal connectors
- All Connectors, finish trim, hardware and support
- Worksurfaces as shown - laminate with vinyl edge
- Storage:
 - (1) B/B/F (2 Small drawers + 1 Large drawer)
with locks, pencil tray and rails
 - (1) F/F (2 Large drawers), with locks and rails
- Overheads - 8 lineal feet as shown →
- full length tackboards and task lights under each
- Includes lockable metal flipper doors for each
- Seating not included

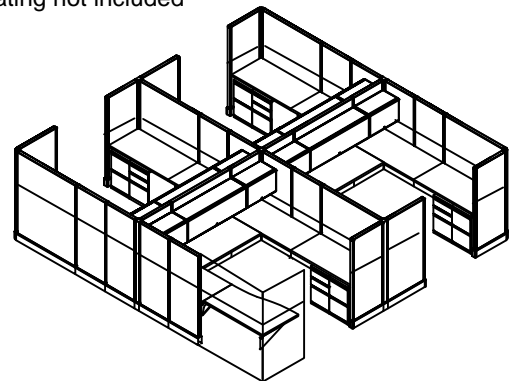

STANDARD MODIFICATIONS:

- 1S Panel height variation - Admin height (36" - 42"), removes overhead storage
- 2S Panel height variation - Seated Height Privacy (45" - 57"), removes overhead storage
- 5S Worksurface - change Wave top to 24 x 72" straight top (see Example C)
- 6S Change 24" x 72" worksurface to 30" Deep rectangular worksurface
- 9S8x8 Worksurface - change from U-shape to L-shape configuration (see Example B)
- 11S Storage - Change B/B/F to Mobile B/F pedestal with cushion
- 13S Panel power - Power ALL Panels
- 14S* Add Ergonomic Keyboard tray with Mouse attachment
- 15S Add Center Drawer
- 17S* Add 48" Panel Mounted Toolbar with (2) organizational accessories
- 18S* Add CPU Holder
- 19S* Add Monitor Arm
- 20S Add 6" of Transaction Counter top (42" high panels only)
- 21S* Task Light - Change to LED under cabinet task light
- 22S Add 24" wide Storage Tower with file drawers and closed shelving
- 23S Add 24" wide Storage Tower with Coat Closet
- 24S Add Sliding Door (64" high panels only - See Example "C")
- 26S Add wood veneer worksurfaces in lieu of laminate

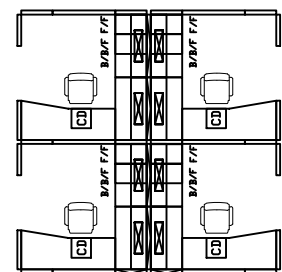

(B) L-shape w/ wave top

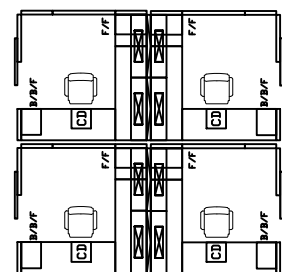

(C) L-shape Rectangular tops, shows sliding door

FCC TYPICALS - 8' X 10' - Single

MANAGER CUBE - SMALL

STACKABLE PANEL SYSTEM

CLIN

0001BK

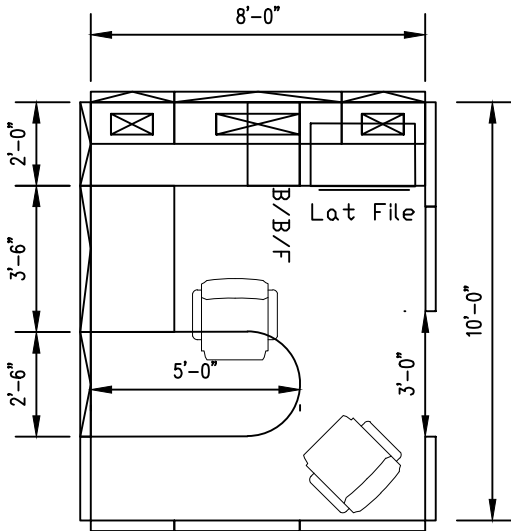

Cubicle Area: 80 Sq Ft

STANDARD COMPONENTS PER CUBICLE:

- U-shaped worksurface with D-top
- Standing height privacy (62" - 70" High Panels)
includes 45"-57" base panels with stack panels
- Powered panels as shown →
- (3) Duplex Receptacles (6 plug in points)
- (1) Voice & Data Quad port per cubicle
- Power Pole
- Mid-grade recycled fabric, metal connectors
- All Connectors, finish trim, hardware and supports
- Worksurfaces as shown - laminate with vinyl edge
- Storage:
- (1) B/B/F (2 Small drawers + 1 Large drawer)
with locks, pencil tray and rails
- (1) 30" wide, two drawer lateral file with lock and rails
- Overheads - 8 lineal feet as shown →
- full length tackboards and task lights under each
- Includes lockable metal flipper doors for each
- Seating not included

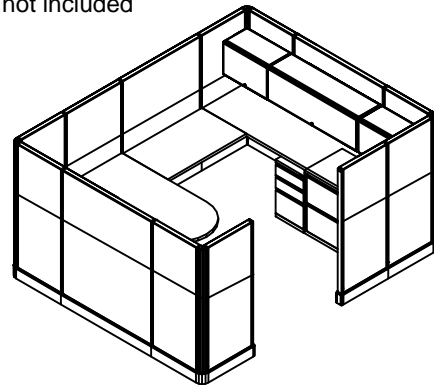

STANDARD MODIFICATIONS:

- 2S Panel height variation - Seated Height Privacy (45" - 57"), removes overhead storage
- 4S Panel height variation - Office Height Panels (76" - 81"), with door
- 7S Change 24" x 96" worksurface to be 30" Deep
- 8S Worksurface - change to Expanded U-shape with wave top (see Example B)
- 9S8x10 Worksurface - change from U-shape to L-shape configuration (see Example C)
- 11S Storage - Change B/B/F to Mobile B/F pedestal with cushion
- 13S Panel power - Power ALL Panels
- 14S* Add Ergonomic Keyboard tray with Mouse attachment
- 15S Add Center Drawer
- 17S* Add 48" Panel Mounted Toolbar with (2) organizational accessories
- 18S* Add CPU Holder
- 19S* Add Monitor Arm
- 21S* Task Light - Change to LED under cabinet task light
- 22S Add 24" wide Storage Tower with file drawers and closed shelving
- 23S Add 24" wide Storage Tower with Coat Closet
- 24S Add Sliding Door (64" high panels only - See Example "C")
- 26S Add wood veneer worksurfaces in lieu of laminate

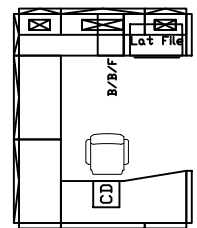

B Expanded U-shape
w/ wave top

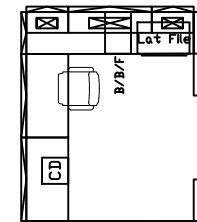

C L-shape
Rectangular top
shows sliding door

FCC TYPICALS - 8' X 10' - Double MANAGER CUBE - SMALL STACKABLE PANEL SYSTEM

CLIN

0001BL

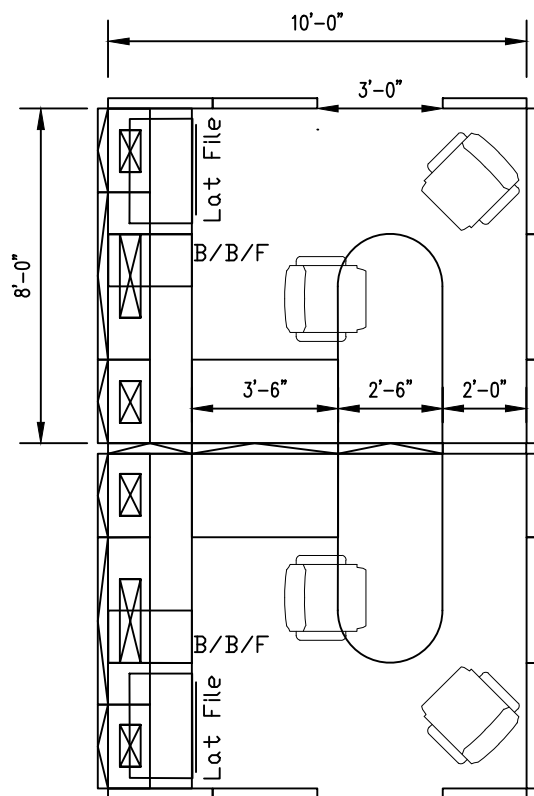

Approx Area: 160 Sq Ft

STANDARD COMPONENTS PER CUBICLE:

U-shaped worksurface with D-top
Standing height privacy (62" - 70" High Panels)
includes 45"-57" base panels with stack panels
Powered panels as shown →
(3) Duplex Receptacles (6 plug in points) per cubicle
(1) Voice & Data Quad port per cubicle
(1) Power Pole per 2-pod
Mid-grade recycled fabric, metal connectors
All Connectors, finish trim, hardware and supports
Worksurfaces as shown - laminate with vinyl edge
Storage:
(1) B/B/F (2 Small drawers + 1 Large drawer)
with locks, pencil tray and rails
(1) 30" wide, two drawer lateral file with lock and rails
Overheads - 8 lineal feet as shown →
full length tackboards and task lights under each
Includes lockable metal flipper doors for each
Seating not included

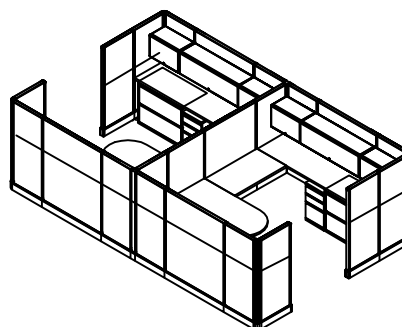

STANDARD MODIFICATIONS:

- 2S Panel height variation - Seated Height Privacy (45" - 57"), removes overhead storage
- 4S Panel height variation - Office Height Panels (76" - 81"), with door
- 7S Change 24" x 96" worksurface to be 30" Deep
- 8S Worksurface - change to Expanded U-shape with wave top (see Example B)
- 9S8x10 Worksurface - change from U-shape to L-shape configuration (see Example C)
- 11S Storage - Change B/B/F to Mobile B/F pedestal with cushion
- 13S Panel power - Power ALL Panels
- 14S* Add Ergonomic Keyboard tray with Mouse attachment
- 15S Add Center Drawer
- 17S* Add 48" Panel Mounted Toolbar with (2) organizational accessories
- 18S* Add CPU Holder
- 19S* Add Monitor Arm
- 21S* Task Light - Change to LED under cabinet task light
- 22S Add 24" wide Storage Tower with file drawers and closed shelving
- 23S Add 24" wide Storage Tower with Coat Closet
- 24S Add Sliding Door (64" high panels only - See Example "C")
- 26S Add wood veneer worksurfaces in lieu of laminate

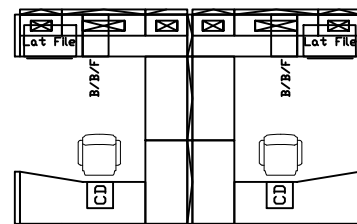

B Expanded U-shape
w/ wave top

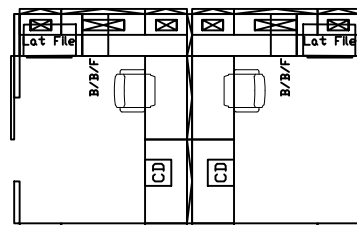

C L-shape
Rectangular top
shows sliding door

FCC TYPICALS - 8' X 12' - Single MANAGER CUBE - LARGE STACKABLE PANEL SYSTEM

CLIN

0001BM

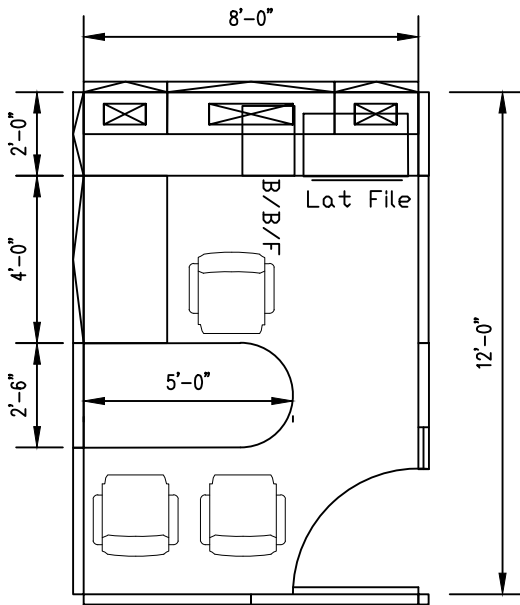

Cubicle Area: 96 Sq Ft

STANDARD COMPONENTS PER CUBICLE:

U-shaped worksurface with D-top
Office Height Panels (76" - 81"), with door & sidelight
includes 45"-57" base panels with (2) stack panels
Powered panels as shown →
(3) Duplex Receptacles (6 plug in points)
(1) Voice & Data Quad port per cubicle
Power Pole
Mid-grade recycled fabric, metal connectors
All Connectors, finish trim, hardware and supports
Worksurfaces as shown - laminate with vinyl edge
Storage:
(1) B/B/F (2 Small drawers + 1 Large drawer)
with locks, pencil tray and rails
(1) 30" wide, two drawer lateral file with lock and rails
Overheads - 8 lineal feet as shown →
full length tackboards and task lights under each
Includes lockable metal flipper doors for each
Seating not included

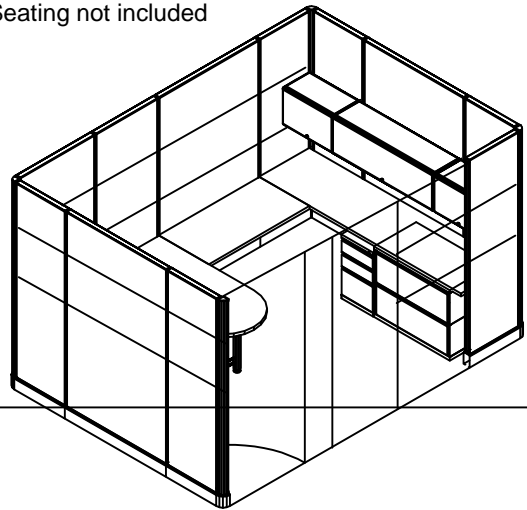

STANDARD MODIFICATIONS:

- 3S Panel variation - Standing height privacy (62" - 70" High Panels)
includes 45"-57" base panels with stack panels
- 7S Change 24" x 96" worksurface to 30" Deep
- 11S Storage - Change B/B/F to Mobile B/F pedestal with cushion
- 13S Panel power - Power ALL Panels
- 14S* Add Ergonomic Keyboard tray with Mouse attachment
- 15S Add Center Drawer
- 17S* Add 48" Panel Mounted Toolbar with (2) organizational accessories
- 18S* Add CPU Holder
- 19S* Add Monitor Arm
- 21S* Task Light - Change to LED under cabinet task light
- 22S Add 24" wide Storage Tower with file drawers and closed shelving
- 23S Add 24" wide Storage Tower with Coat Closet
- 24S Add Sliding Door (64" high panels only - See Example "B")
- 26S Add wood veneer worksurfaces in lieu of laminate
- 27S Change D-top worksurface to P-top (See Example "C")

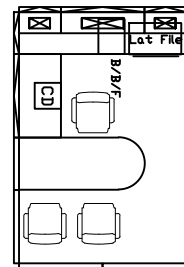

B U-shape station with a sliding door

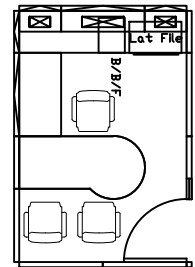

C U-shape station with a P-top

FCC TYPICALS - 8' X 12' - Double MANAGER CUBE - LARGE STACKABLE PANEL SYSTEM

CLIN

0001BN

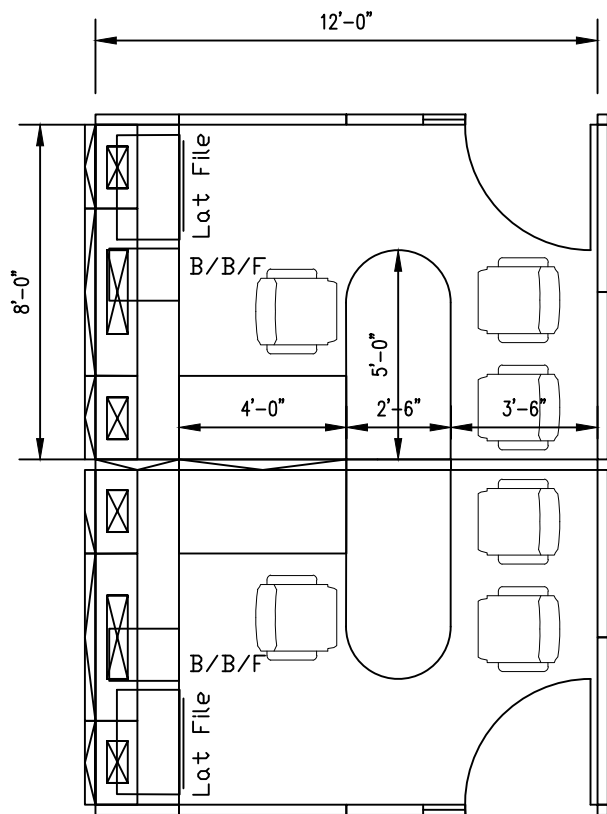

BN

Approx Area: 192 Sq Ft

STANDARD COMPONENTS PER CUBICLE:

- U-shaped worksurface with D-top
- Office Height Panels (76" - 81"), with door & sidelight includes 45"-57" base panels with (2) stack panels
- Powered panels as shown →
- (3) Duplex Receptacles (6 plug in points) per cubicle
- (1) Voice & Data Quad port per cubicle
- (1) Power Pole per 2-pod
- Mid-grade recycled fabric, metal connectors
- All Connectors, finish trim, hardware and supports
- Worksurfaces as shown - laminate with vinyl edge
- Storage:
 - (1) B/B/F (2 Small drawers + 1 Large drawer) with locks, pencil tray and rails
 - (1) 30" wide, two drawer lateral file with lock and rails
- Overheads - 8 lineal feet as shown →
- full length tackboards and task lights under each
- Includes lockable metal flipper doors for each
- Seating not included

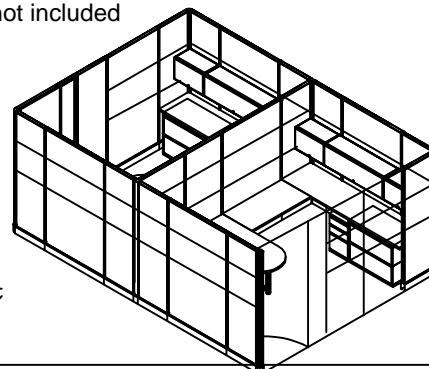

STANDARD MODIFICATIONS:

- 3S Panel variation - Standing height privacy (62" - 70" High Panels) includes 45"-57" base panels with stack panels
- 7S Change 24" x 96" worksurface to 30" Deep
- 11S Storage - Change B/B/F to Mobile B/F pedestal with cushion
- 13S Panel power - Power ALL Panels
- 14S* Add Ergonomic Keyboard tray with Mouse attachment
- 15S Add Center Drawer
- 17S* Add 48" Panel Mounted Toolbar with (2) organizational accessories
- 18S* Add CPU Holder
- 19S* Add Monitor Arm
- 21S* Task Light - Change to LED under cabinet task light
- 22S Add 24" wide Storage Tower with file drawers and closed shelving
- 23S Add 24" wide Storage Tower with Coat Closet
- 24S Add Sliding Door (64" high panels only - See Example "B")
- 26S Add wood veneer worksurfaces in lieu of laminate
- 27S Change D-top worksurface to P-top (See Example "C")

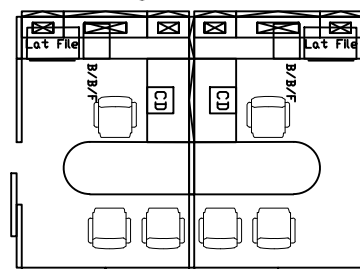

B U-shape station with a sliding door

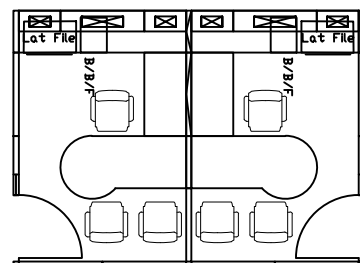

C U-shape station with a P-top

FCC TYPICALS - 8' X 12'

2 - PERSON COLLABORATIVE STATION

STACKABLE PANEL SYSTEM

CLIN

0001BP

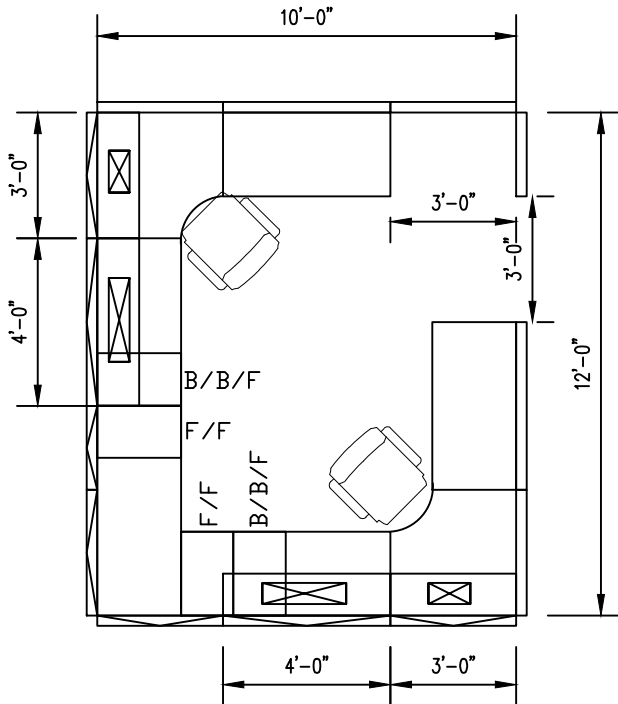

Cubicle Area: 96 Sq Ft

(2) L-SHAPED WORKSTATIONS

STANDARD COMPONENTS PER CUBICLE:

Standing height privacy (62" - 70" High Panels)
Includes 45"-57" base panels with stack panels

Powered panels as shown →

(3) Duplex Receptacles (6 plug in points)

(1) Voice & Data Quad port per cubicle

Power Pole

Mid-grade recycled fabric, metal connectors

All Connectors, finish trim, hardware and support

Worksurfaces as shown - laminate with vinyl edge

Storage:

(1) B/B/F (2 Small drawers + 1 Large drawer)
with locks, pencil tray and rails per station

(1) F/F (2 Large drawers), with locks and rails per station

Overheads - 7 lineal feet as shown per station →

full length tackboards and task lights under each

Includes lockable metal flipper doors for each

Seating not included

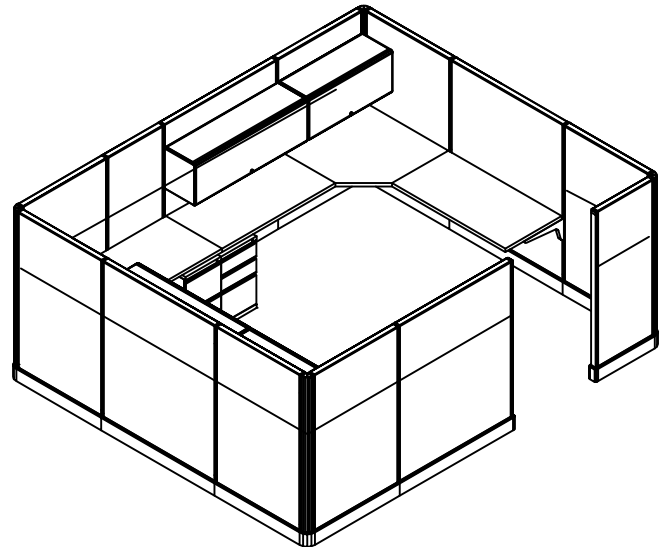

STANDARD MODIFICATIONS:

- 2S Panel height variation - Seated Height Privacy (45" - 57"), removes overhead storage
- 11S Storage - Change B/B/F to Mobile B/F pedestal with cushion
- 13S Panel power - Power ALL Panels
- 14S* Add Ergonomic Keyboard tray with Mouse attachment
- 15S Add Center Drawer
- 17S* Add 48" Panel Mounted Toolbar with (2) organizational accessories
- 18S* Add CPU Holder
- 19S* Add Monitor Arm
- 21S Task Light - Change to LED under cabinet task light
- 26S Add wood veneer worksurfaces in lieu of laminate

FCC TYPICALS - 12'-3" X 15'-6"

4 - PERSON COLLABORATIVE STATION

STACKABLE PANEL SYSTEM

CLIN

0001BQ

(4) L-SHAPED WORKSTATIONS W/ FULL HT PANEL DIVIDERS IN BETWEEN STANDARD COMPONENTS PER CUBICLE:

Standing height privacy (62" - 70" High Panels)

Includes 45"-57" base panels with stack panels

Powered panels as shown → 

(3) Duplex Receptacles (6 plug in points)

(1) Voice & Data Quad port per cubicle

Power Pole

Mid-grade recycled fabric, metal connectors

All Connectors, finish trim, hardware and support

Worksurfaces as shown - laminate with vinyl edge

Storage:

(1) B/B/F (2 Small drawers + 1 Large drawer)

with locks, pencil tray and rails per station

(1) F/F (2 Large drawers), with locks and rails per station

(1) 36" 2H Lateral file with locks, rails & worksurface

Overhead shelves 6 lin ft per station, plus (1) 36" 

with locks, tackboards and task lights under each

Includes lockable metal flipper doors for each

Note: Overall dimension may vary by 1" to 2" depending on panel thickness.

Seating not included

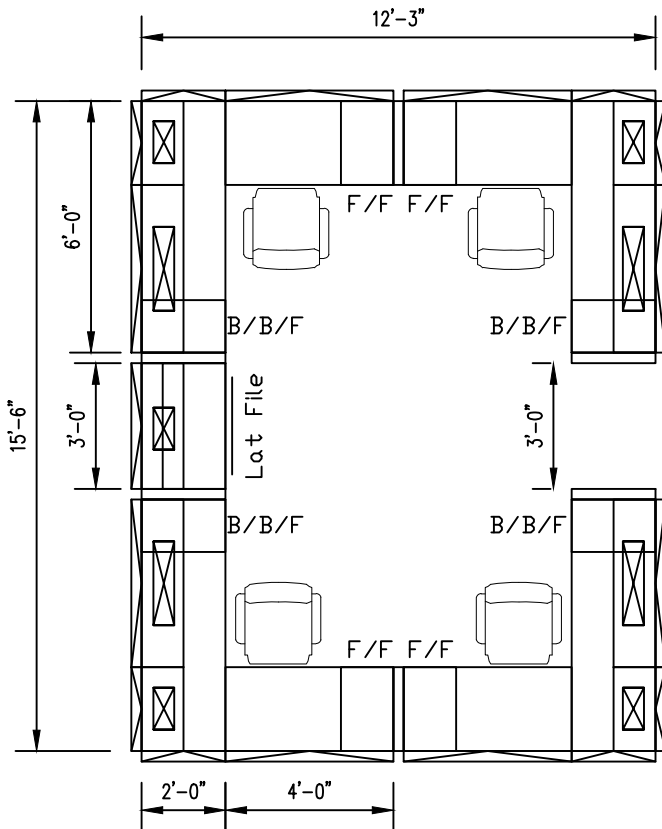
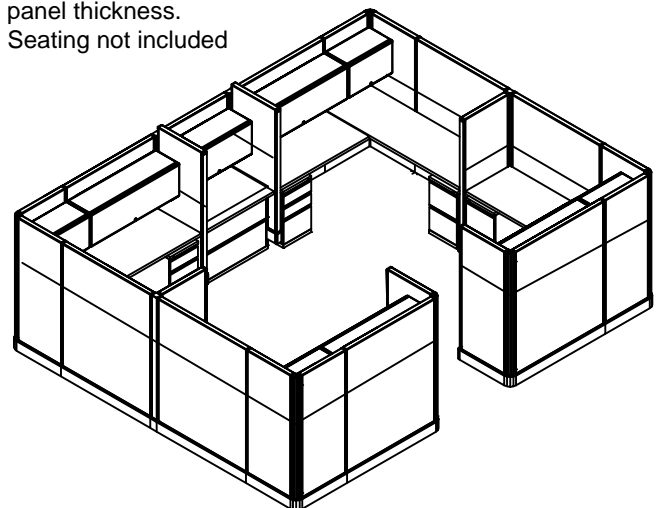

BQ

Cubicle Area: 190 Sq Ft

STANDARD MODIFICATIONS:

- 2S Panel height variation - Seated Height Privacy (45" - 57"), removes overhead storage
- 10S Change from "L" shaped to Corner workstations
- 11S Storage - Change B/B/F to Mobile B/F pedestal with cushion
- 13S Panel power - Power ALL Panels
- 14S* Add Ergonomic Keyboard tray with Mouse attachment
- 15S Add Center Drawer
- 17S* Add 48" Panel Mounted Toolbar with (2) organizational accessories
- 18S* Add CPU Holder
- 19S* Add Monitor Arm
- 21S* Task Light - Change to LED under cabinet task light
- 26S Add wood veneer worksurfaces in lieu of laminate

FCC TYPICALS - 15' X 16'

4 - COLLABORATIVE STATION

STACKABLE PANEL SYSTEM

CLIN

0001BR

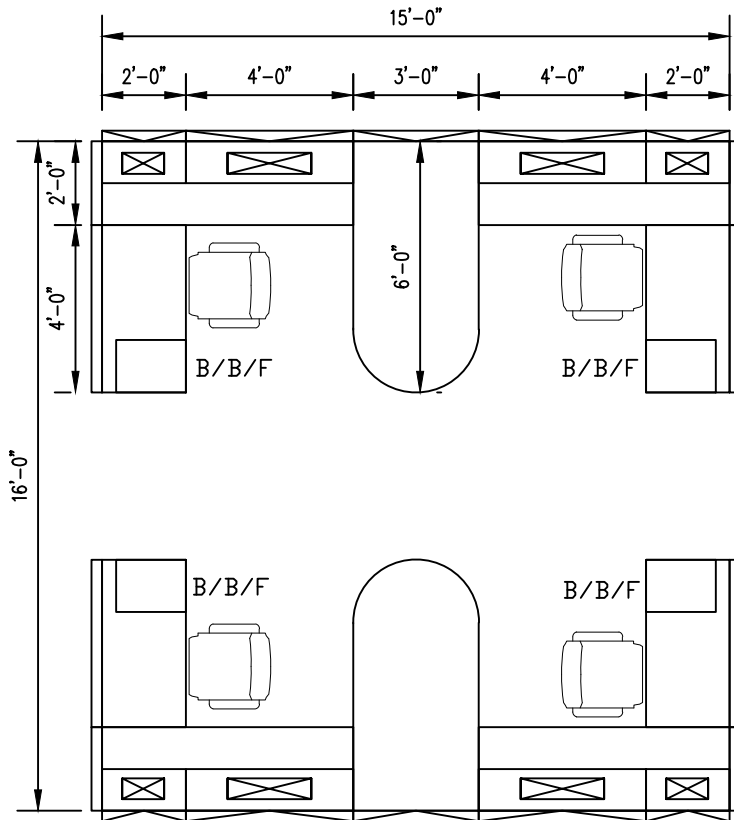

Cubicle Area: 240 Sq Ft

(4) L-SHAPED WORKSTATIONS W/

(2) 36" X 72" D-TOPS

STANDARD COMPONENTS PER CUBICLE:

Standing height privacy (62" - 70" High Panels)

Includes 45"-57" base panels with stack panels

Powered panels as shown →

(3) Duplex Receptacles (6 plug in points)

(1) Voice & Data Quad port per cubicle

Power Pole

Mid-grade recycled fabric, metal connectors

All Connectors, finish trim, hardware and support

Worksurfaces as shown - including shared D-Top

laminated with vinyl edge

Storage:

(1) B/B/F (2 Small drawers + 1 Large drawer)

with locks, pencil tray and rails per station

Overhead shelves 6 lineal feet per station

with locks, tackboards and task lights under each

with locks, tackboards and task lights under each

Includes lockable metal flipper doors for each

Seating not included

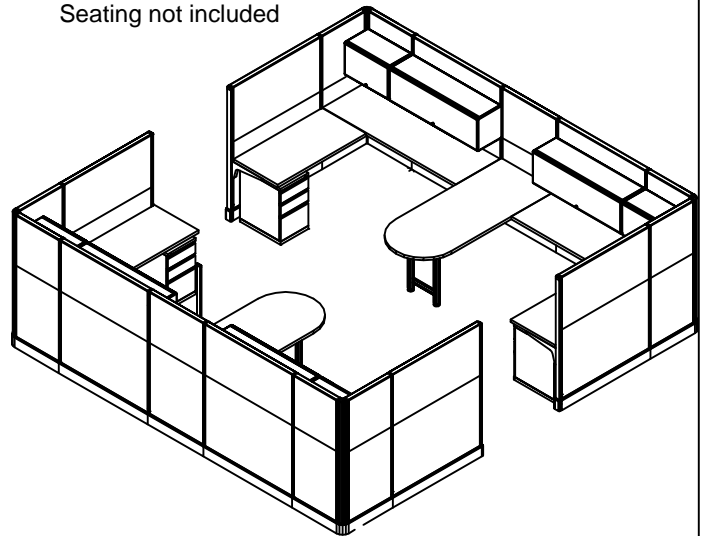

STANDARD MODIFICATIONS:

- 2S Panel height variation - Seated Height Privacy (45" - 57"), removes overhead storage
- 11S Storage - Change B/B/F to Mobile B/F pedestal with cushion
- 13S Add Power to ALL Panels
- 14S* Add Ergonomic Keyboard tray with Mouse attachment
- 15S Add Center Drawer
- 17S* Add 48" Panel Mounted Toolbar with (2) organizational accessories
- 18S* Add CPU Holder
- 19S* Add Monitor Arm
- 21S* Task Light - Change to LED under cabinet task light
- 26S Add wood veneer worksurfaces in lieu of laminate

FCC TYPICALS - 2' X 4' SINGLE BENCHING STATION STACKABLE PANEL SYSTEM

CLIN

0001BS

STANDARD COMPONENTS PER STATION:

Seated height privacy (45" - 57" High Panels)

Powered panels as shown → 

(2) Duplex Receptacles (4 plug in points)

(1) Voice & Data Quad port

Power Pole

Mid-grade recycled fabric, metal connectors

All Connectors, finish trim, hardware and support

Worksurfaces as shown - laminate with vinyl edge

Storage:

(1) B/B/F (2 Small drawers + 1 Large drawer),

with locks, pencil tray and rails

Full length tackboards above worksurface

Seating not included

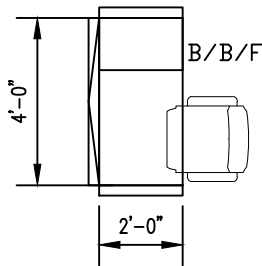

Cubicle Area: 8 Sq Ft

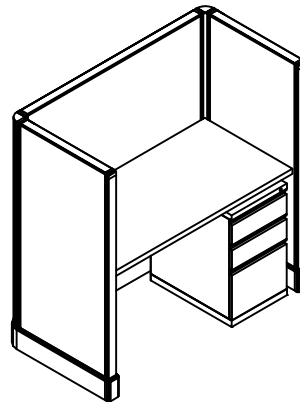

STANDARD MODIFICATIONS:

- 1M Panel height variation - Admin height (36" - 42"), removes overhead storage
- 3M Panel height variation -Standing Height Privacy (62" -70"),
- 11M Change B/B/F to mobile B/F with cushion
- 13M Panel power - Power ALL Panels
- 14M* Add Ergonomic Keyboard tray with Mouse attachment
- 17M* Add 48" Panel Mounted Toolbar with (2) organizational accessories
- 18M* Add CPU Holder

FCC TYPICALS - 2' X 8' - Double BENCHING STATION STACKABLE PANEL SYSTEM

CLIN

0001BT

(2) PERSON BENCHING CONFIGURATION STANDARD COMPONENTS PER STATION:

Seated height privacy (45" - 57" High Panels)

Powered panels as shown → 

(2) Duplex Receptacles (4 plug in points) per station

(1) Voice & Data Quad port per station

(1) Power Pole per grouping of (2) stations

Mid-grade recycled fabric, metal connectors

All Connectors, finish trim, hardware and support

Worksurfaces as shown - laminate with vinyl edge

Storage:

(1) B/B/F (2 Small drawers + 1 Large drawer),
with locks, pencil tray and rails

Full length tackboards above worksurface

Note: Overall dimension may vary depending on panel thickness.

Seating not included

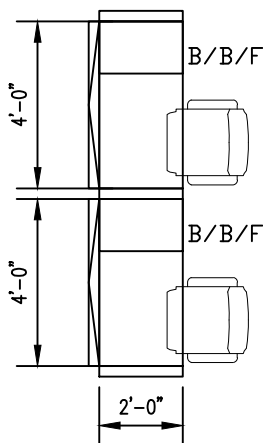

Approx Area: 16 Sq Ft

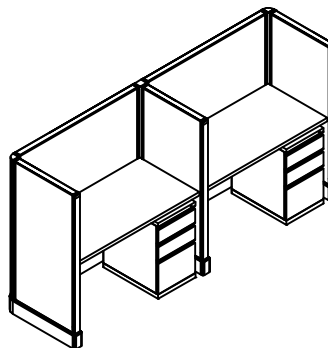

STANDARD MODIFICATIONS:

- 1M Panel height variation - Admin height (36" - 42"), removes overhead storage
- 3M Panel height variation -Standing Height Privacy (62" -70"),
- 11M Change B/B/F to mobile B/F with cushion
- 13M Panel power - Power ALL Panels
- 14M* Add Ergonomic Keyboard tray with Mouse attachment
- 17M* Add 48" Panel Mounted Toolbar with (2) organizational accessories
- 18M* Add CPU Holder

FCC TYPICALS - 2' X 16' - Quad

4-PERSON BENCHING STATION

STACKABLE PANEL SYSTEM

CLIN

0001BU

(4) PERSON BENCHING STATION

STANDARD COMPONENTS PER STATION:

Seated height privacy (45" - 57" High Panels)

Powered panels as shown → 

(2) Duplex Receptacles (4 plug in points) per station

(1) Voice & Data Quad port per station

(1) Power Pole per grouping of (4) stations

Mid-grade recycled fabric, metal connectors

All Connectors, finish trim, hardware and support

Worksurfaces as shown - laminate with vinyl edge

Storage:

(1) B/B/F (2 Small drawers + 1 Large drawer),
with locks, pencil tray and rails

Full length tackboards above workspace

Note: Overall dimension may vary depending on panel thickness.

Seating not included

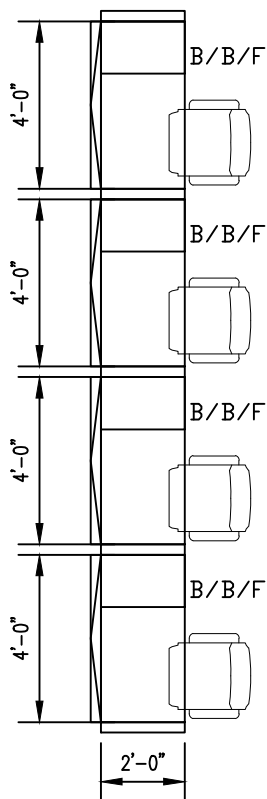

Approx Area: 32 Sq Ft

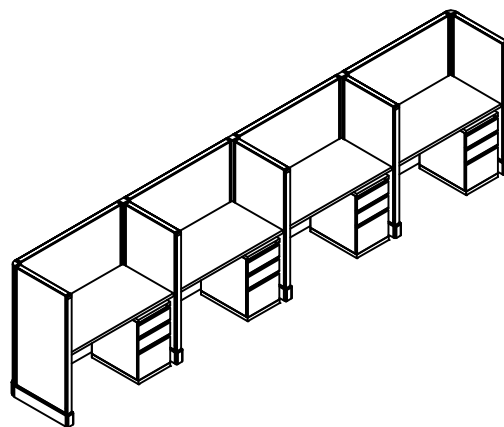

STANDARD MODIFICATIONS:

- 1M Panel height variation - Admin height (36" - 42"), removes overhead storage
- 3M Panel height variation - Standing Height Privacy (62" - 70"),
- 11M Change B/B/F to mobile B/F with cushion
- 13M Panel power - Power ALL Panels
- 14M* Add Ergonomic Keyboard tray with Mouse attachment
- 17M* Add 48" Panel Mounted Toolbar with (2) organizational accessories
- 18M* Add CPU Holder

FCC TYPICALS - MODULAR

FREESTANDING DOUBLE PEDESTAL DESK

CLIN

0001CA

Includes lockable metal flipper doors for each

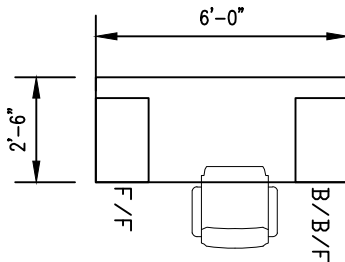

Seating not included

CA

STANDARD COMPONENTS PER CUBICLE:

Freestanding Double Pedestal Desk
Worksurfaces as shown - laminate with vinyl edge
Support:

Full depth end panels on each end
Full height modesty panel on front
All hardware, finish trim and supports

Storage:

- (1) B/B/F (2 Small drawers + 1 Large drawer),
with locks, pencil tray and rails
- (1) F/F (2 Large drawers), with locks and rails

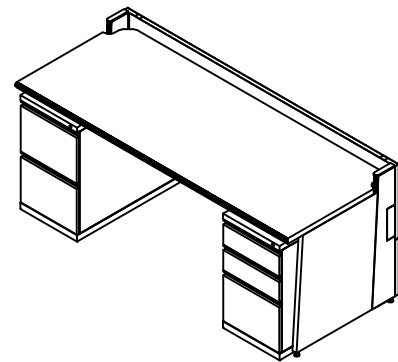

STANDARD MODIFICATIONS:

- 1D Change size to 30" x 60" (See Example B)
- 2D Change size to 30" x 66" (See Example C)
- 14D* Add Ergonomic Keyboard tray with Mouse attachment
- 15D Add Center Drawer
- 19D* Add Monitor Arm
- 26D Add wood veneer worksurfaces in lieu of laminate

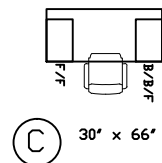
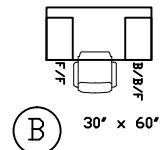

FCC TYPICALS - MODULAR

FREESTANDING "L" SHAPED DESK

CLIN

0001CB

STANDARD COMPONENTS PER CUBICLE:

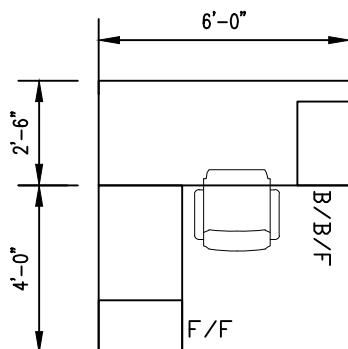

Seating not included

CB

Freestanding L-shaped configuration
 Worksurfaces as shown - laminate with vinyl edge
 Support:
 Full depth end panels on each end
 Full height modesty panel on front
 3/4 or 1/2 height modesty panel on side
 All hardware, finish trim and supports
 Storage:
 (1) B/B/F (2 Small drawers + 1 Large drawer),
 with locks, pencil tray and rails
 (1) F/F (2 Large drawers), with locks and rails

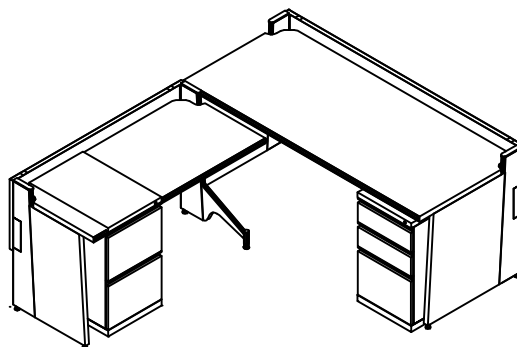

STANDARD MODIFICATIONS:

- 3D Reduce front desk size to 60" wide (See Example B)
- 4D Reduce front desk size to 66" wide (See Example C)
- 5D Reduce return size to 42" (See Example B)
- 6D Increase return size to 60" (See Example C)
- 11D Change Pedestal File drawer to a Lateral File (See Example C)
- 14D* Add Ergonomic Keyboard tray with Mouse attachment
- 15D Add Center Drawer
- 18D* Add CPU Holder
- 19D* Add Monitor Arm
- 21D* Task Light - Change to LED under cabinet task light
- 26D Add wood veneer worksurfaces in lieu of laminate
- 27D Add Overhead Hutch to return as shown →  Includes sliding or flipper doors, full length tackboards and task light underneath

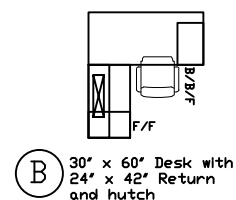

B 30' x 60' Desk with
 24' x 42' Return
 and hutch

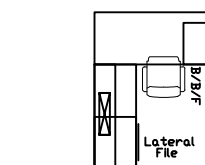

C 30' x 66' Desk with
 24' x 60' Return
 and lateral file

FCC TYPICALS - MODULAR

FREESTANDING "U" SHAPED DESK

CLIN

0001CC

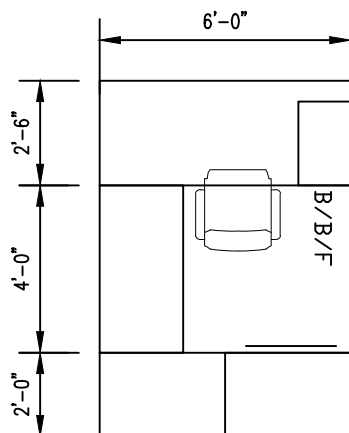

Seating not included



STANDARD COMPONENTS PER CUBICLE:

Freestanding U-shaped configuration

Worksurfaces as shown - laminate with vinyl edge

Support:

Full depth end panels on each end

Full height modesty panel on front

3/4 or 1/2 height modesty panel on back and side

All hardware, finish trim and supports

Storage:

(1) B/B/F (2 Small drawers + 1 Large drawer),
with locks, pencil tray and rails

(1) 36"W 2-drawer Lateral file with with locks and rails

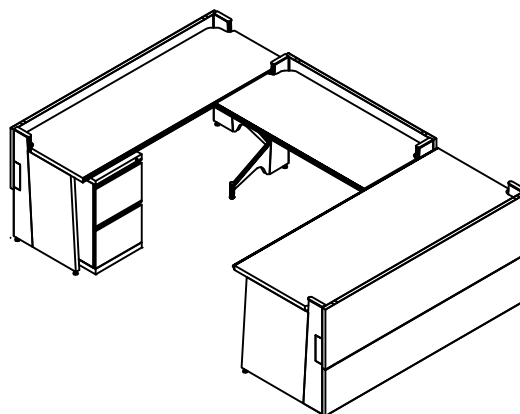

STANDARD MODIFICATIONS:

- 7D Reduce front desk and rear credenza size to 60" wide (See Example B)
- 8D Reduce front desk and rear credenza to 66" wide (See Example C)
- 9D Reduce bridge size to 42"
- 12D Exchange lateral file with a file pedestal drawer stack (See Example B)
- 14D* Add Ergonomic Keyboard tray with Mouse attachment
- 15D Add Center Drawer
- 18D* Add CPU Holder
- 19D* Add Monitor Arm
- 21D* Task Light - Change to LED under cabinet task light
- 22D Add 24" wide Storage Tower with Shelves
- 23D Add 24" wide storage Tower with coat closet
- 26D Add wood veneer worksurfaces in lieu of laminate
- 28D Add Overhead Hutch to top of credenza as shown → 

Includes sliding or flipper doors, full length tackboards and task light underneath

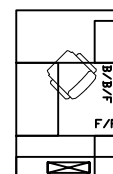

(B) 60"W Desk/Credenza
24" x 42" Bridge
and hutch

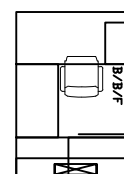

(C) 66"W Desk/Credenza
24" x 42" Bridge
and hutch