

SITE SYMBOL

- ① SAW CUT AT NEAREST EXISTING JOINT
MATCH EXISTING ELEVATIONS, ENSURE
NO TRIPPING HAZARD
- ② TRANSITION FLUSH CURB TO FULL REVEAL
CURB ON EITHER SIDE OF CURB RAMP USING
FLARED TAPER. GRADE BEHIND CURB TO
MATCH TOP OF CURB.
- Ⓛ LANDING AREA

NOTES

1. ACCESSIBLE RAMPS SHALL BE CONSTRUCTED AS
DESIGNED.
2. THE EXACT LOCATION OF THE NEAREST JOINT SHALL
BE FIELD VERIFIED. DESIGN SLOPES MAY BE ALTERED
AS NECESSARY TO ACCOUNT FOR A CHANGE IN RAMP
LENGTH. HOWEVER, IN NO CASE CAN ANY ACCESSIBLE
RAMP EXCEED A MAXIMUM GRADE OF 8% AND CROSS
GRADE OF 2%. ANY GRADE EXCEEDING THESE LIMITS
SHALL BE COORDINATED WITH COR TO DETERMINE
EXTENT OF REPAIR.
3. THE DETECTABLE WARNING SURFACE SHALL BE A
LENGTH OF 2 FEET, SPAN THE ENTIRE WIDTH OF THE
RAMP AND BE LOCATED NO FARTHER THAN 2 INCHES
FROM THE BACK OF CURB.
4. DETECTABLE WARNING PLATE SHALL BE NEENAH#4984,
OR EQUIVALENT.
5. CONCRETE TAPERS ALONG THE RAMP, TO TRANSITION
FROM FLUSH CURB TO FULL REVEAL CURB, SHALL NOT
EXCEED A SLOPE OF 10:1.
6. REFER TO THE RAMP CONSTRUCTION DETAILS FOR
ADDITIONAL INFORMATION.

KEY MAP
1"=250'

CURB RAMP DETAIL #2
1"=10'

CURB RAMP DETAIL #4
1"=10'

CONSULTANTS:

ARCHITECT/ENGINEERS:

acela
architects + engineers
acela architects + engineers, pc office: 610.365.4023
2633 Moravian Ave. website: www.acela-ae.com
Allentown, PA 18103 email: info@acela-ae.com

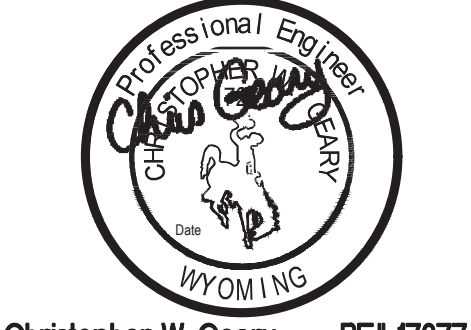

Christopher W. Geary PE# 17277

Drawing Title
Curb Ramp + Sidewalk Detail

Approved: Project Director
SHERIDAN VAHCS PLANNING AND ENGINEERING

Project Title
Resurface Roads And Parking Lots

Location
Sheridan VA Medical Center Sheridan, WY
Date
6/14/2020
Checked
Geary
Drawn
Peters

Project Number
666-17-104

Building Number
-

Drawing Number
CS207

Dwg. 111 of 195

Office of
Construction
and Facilities
Management



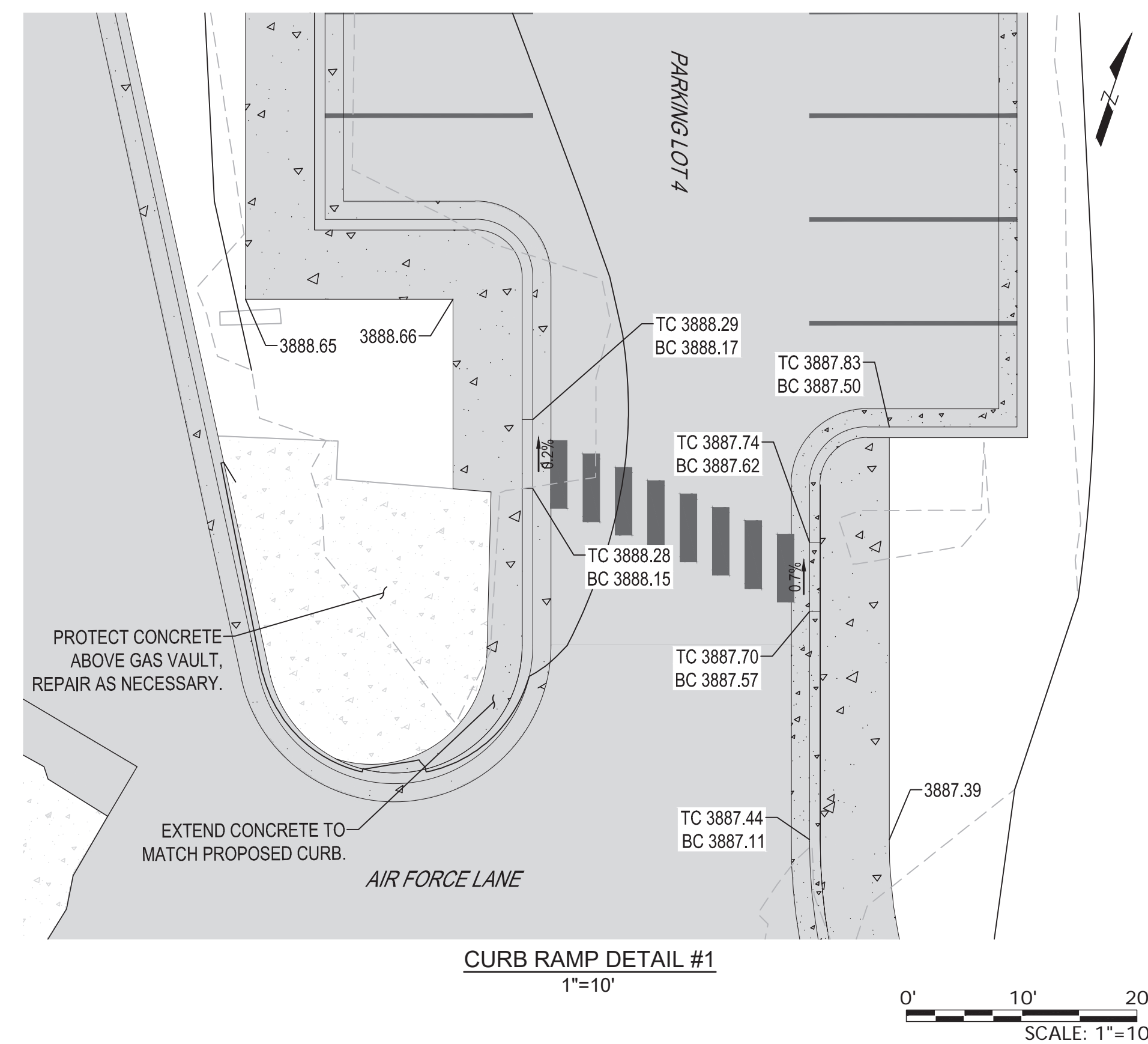
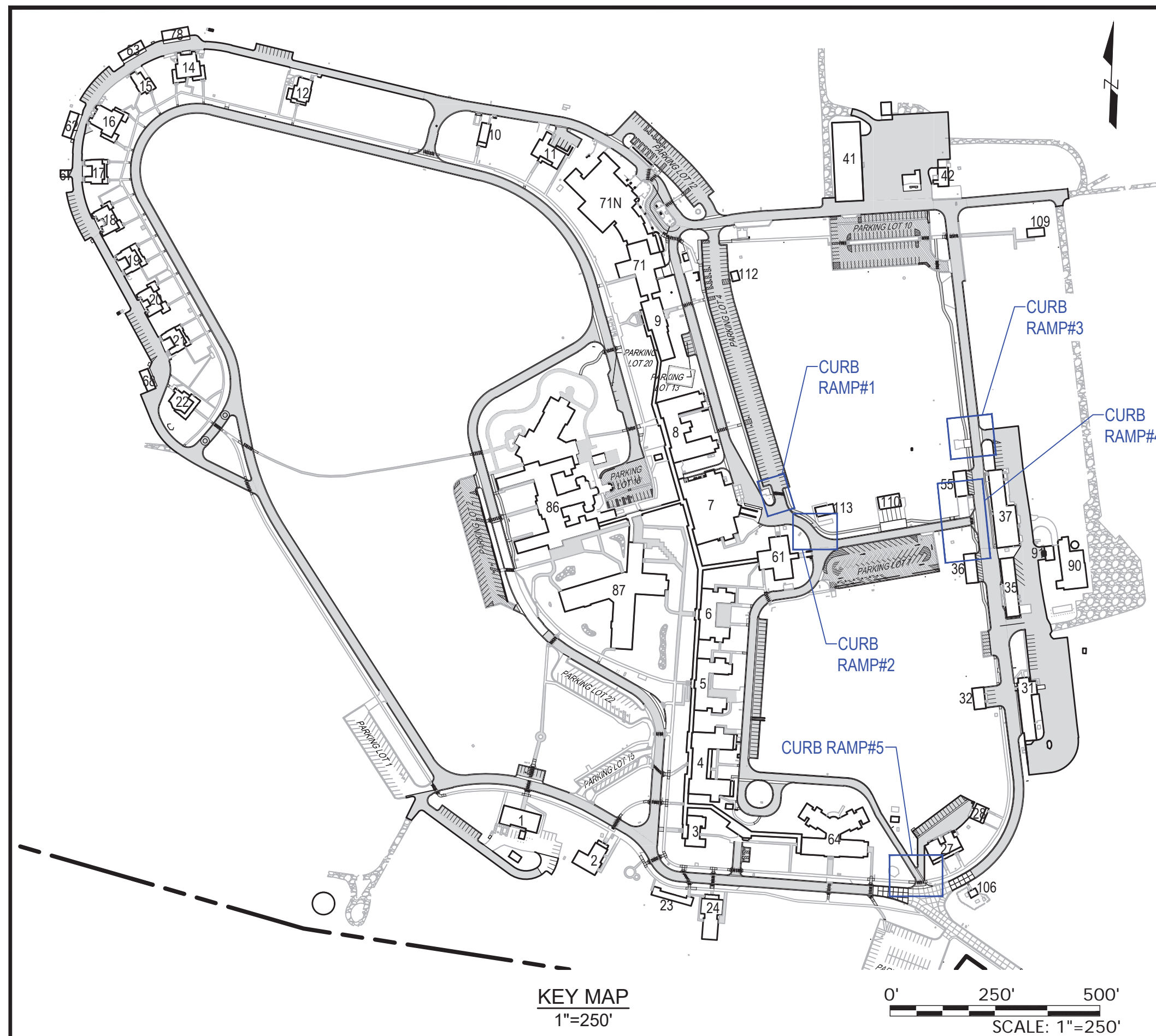

SITE SYMBOL

- ① SAW CUT AT NEAREST EXISTING JOINT
MATCH EXISTING ELEVATIONS, ENSURE
NO TRIPPING HAZARD
- ② TRANSITION FLUSH CURB TO FULL REVEAL
CURB ON EITHER SIDE OF CURB RAMP USING
FLARED TAPER. GRADE BEHIND CURB TO
MATCH TOP OF CURB.
- ③ LANDING AREA

- ## NOTES

1. ACCESSIBLE RAMPS SHALL BE CONSTRUCTED AS DESIGNED.

NOTES

1. ACCESSIBLE RAMPS SHALL BE CONSTRUCTED AS DESIGNED.
2. THE EXACT LOCATION OF THE NEAREST JOINT SHALL BE FIELD VERIFIED. DESIGN SLOPES MAY BE ALTERED AS NECESSARY TO ACCOUNT FOR A CHANGE IN RAMP LENGTH. HOWEVER, IN NO CASE CAN ANY ACCESSIBLE RAMP EXCEED A MAXIMUM GRADE OF 8% AND CROSS GRADE OF 2%. ANY GRADE EXCEEDING THESE LIMITS SHALL BE COORDINATED WITH COR TO DETERMINE EXTENT OF REPAIR.
3. THE DETECTABLE WARNING SURFACE SHALL BE A LENGTH OF 2 FEET. SPAN THE ENTIRE WIDTH OF THE RAMP AND BE LOCATED NO FARTHER THAN 2 INCHES FROM THE BACK OF CURB.
4. DETECTABLE WARNING PLATE SHALL BE NEENAH#4984, OR EQUIVALENT.
5. CONCRETE TAPERS ALONG THE RAMP, TO TRANSITION FROM FLUSH CURB TO FULL REVEAL CURB, SHALL NOT EXCEED A SLOPE OF 10:1.
6. REFER TO THE RAMP CONSTRUCTION DETAILS FOR ADDITIONAL INFORMATION.

2. THE EXACT LOCATION OF THE NEAREST JOINT SHALL BE FIELD VERIFIED. DESIGN SLOPES MAY BE ALTERED AS NECESSARY TO ACCOUNT FOR A CHANGE IN RAMP LENGTH. HOWEVER, IN NO CASE CAN ANY ACCESSIBLE RAMP EXCEED A MAXIMUM GRADE OF 8% AND CROSS GRADE OF 2%. ANY GRADE EXCEEDING THESE LIMITS SHALL BE COORDINATED WITH COR TO DETERMINE EXTENT OF REPAIR.

3. THE DETECTABLE WARNING SURFACE SHALL BE A LENGTH OF 2 FEET, SPAN THE ENTIRE WIDTH OF THE RAMP AND BE LOCATED NO FARTHER THAN 2 INCHES FROM THE BACK OF CURB.

4. DETECTABLE WARNING PLATE SHALL BE NEENAH#4984, OR EQUIVALENT.

5. CONCRETE TAPERS ALONG THE RAMP, TO TRANSITION FROM FLUSH CURB TO FULL REVEAL CURB, SHALL NOT EXCEED A SLOPE OF 10:1.

6. REFER TO THE RAMP CONSTRUCTION DETAILS FOR ADDITIONAL INFORMATION.

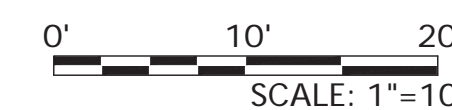
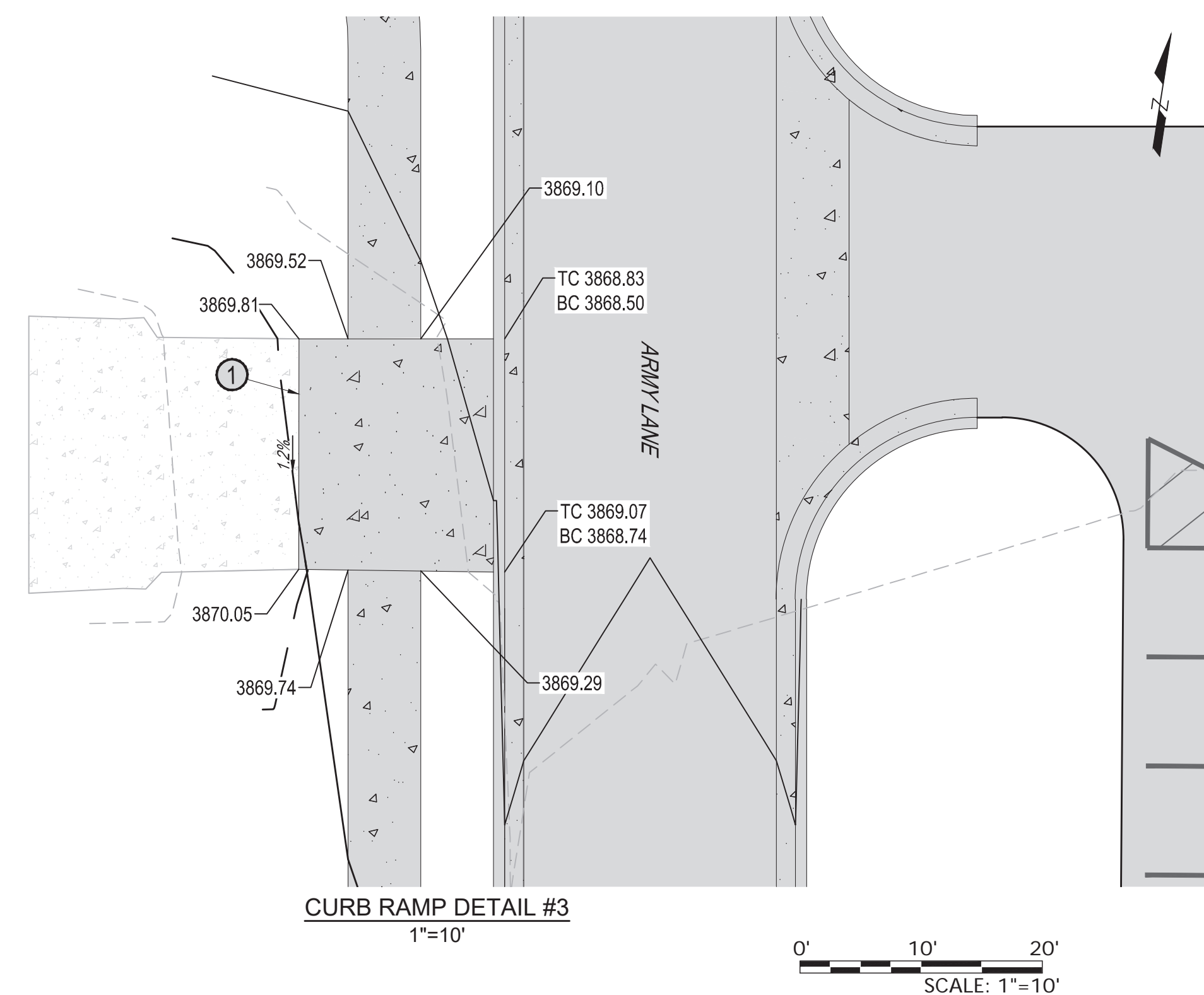
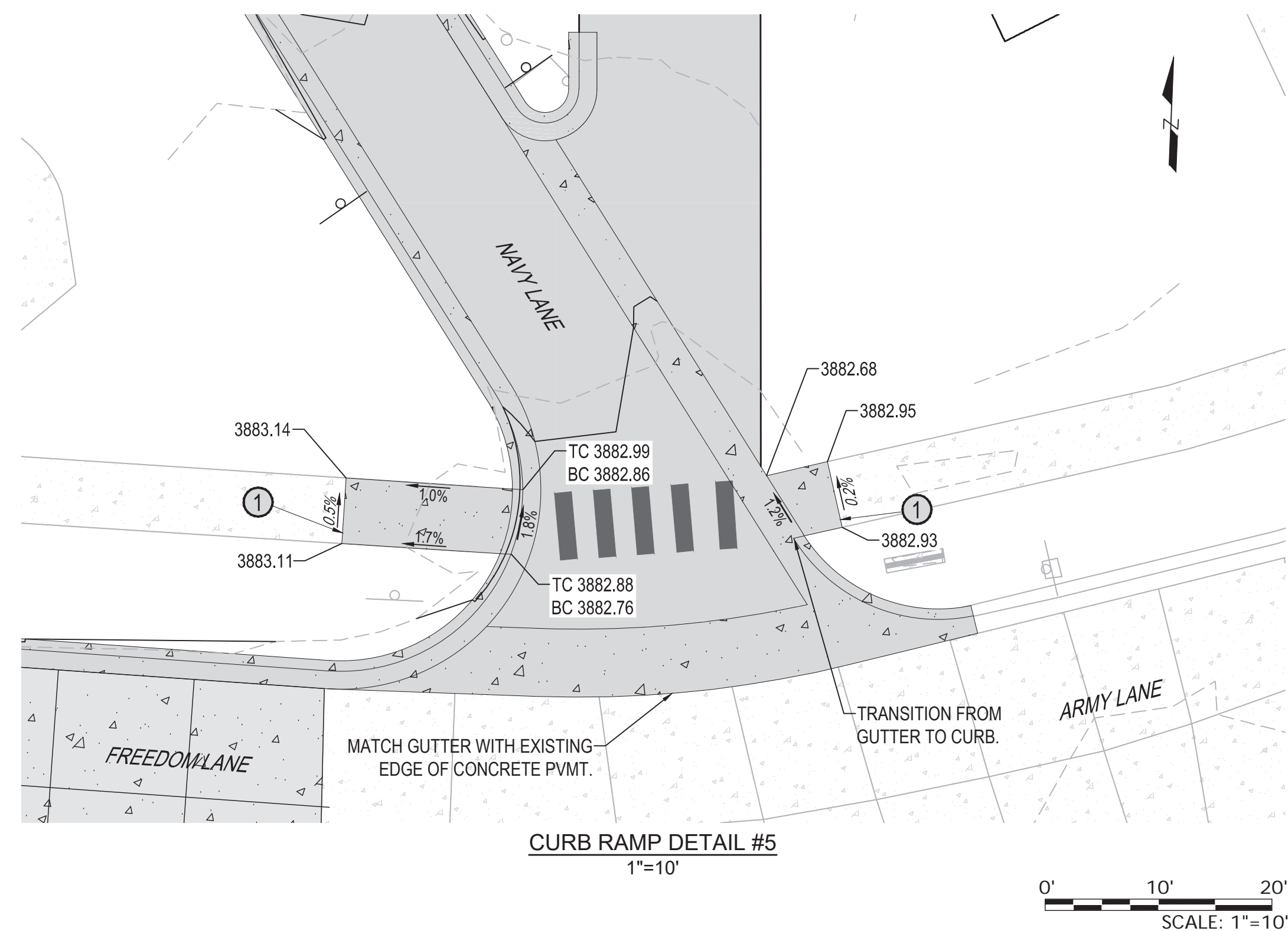

-	-
-	-
-	-
-	-
Revisions:	Date

CONSULTANTS:

ARCHITECT/ENGINEERS:

acela
architects + engineers

acela architects + engineers, pc office: 610.365.4023
2633 Moravian Ave. website: www.acela-ae.com
Allentown, PA 18103 email: info@acela-ae.com

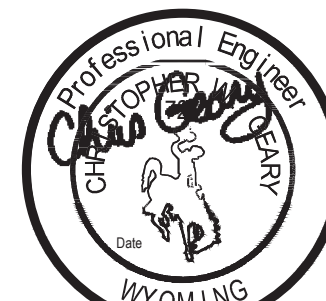

Christopher W. Geary PE# 1727

Drawing Title	Curb Ramp + Sidewalk Detail
---------------	-----------------------------

Approved: Project Director
-
-
SHERIDAN VAHCS PLANNING AND ENGINEERING

Project Title	Resurface Roads And Parking Lots
---------------	----------------------------------

Location	Sheridan VA Medical Center	Sheridan, WY
----------	----------------------------	--------------

Date
6/14/2020

Checked
Geary

Drawn	
Peters	

Project Number	666-17-104
----------------	------------

Building Number
-

	Drawing Number

CS208
Dwg. 112 of 195

Office of
Construction
and Facilities
Management

