

1

2

3

4

5

D

C

B

A

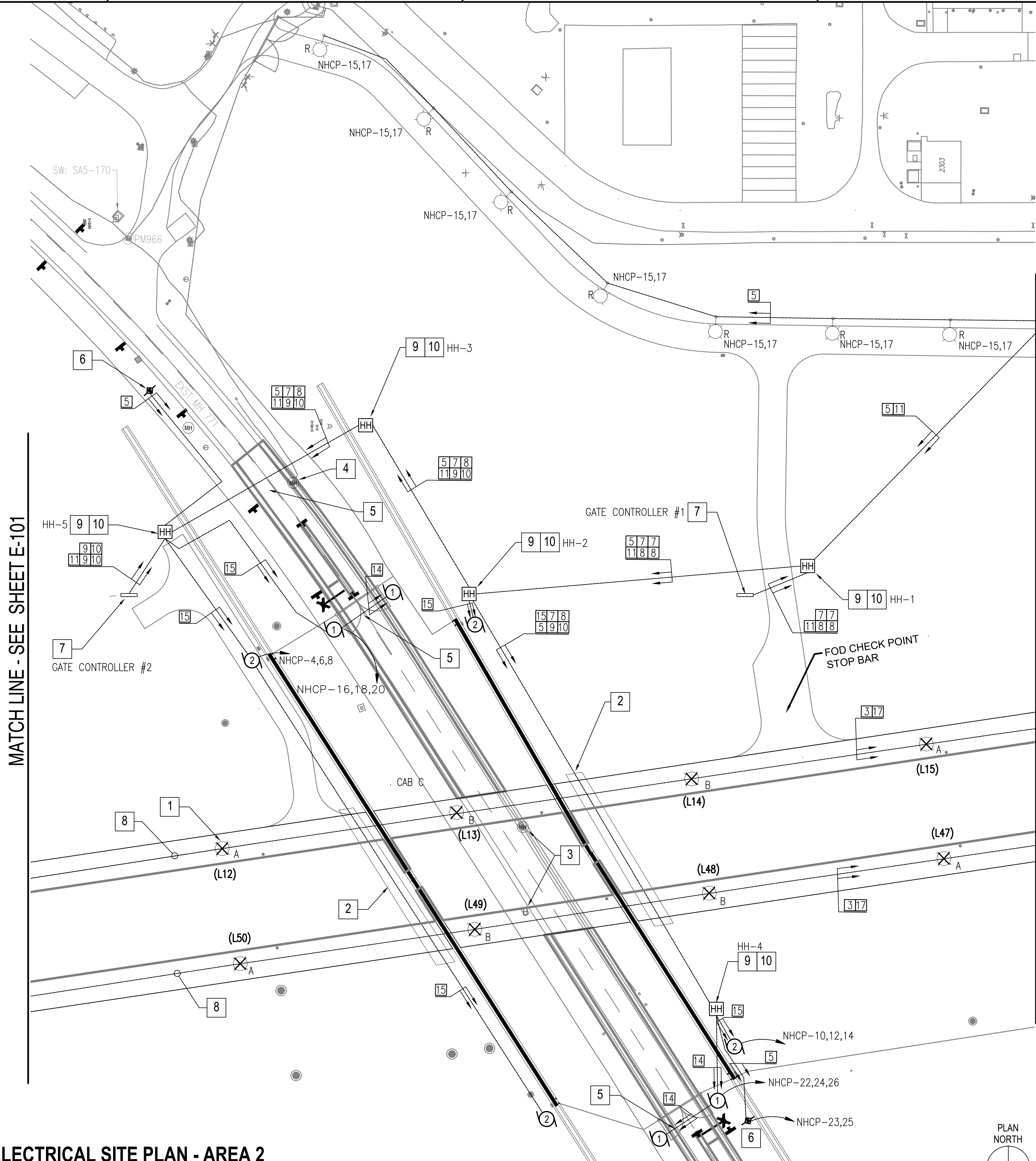

**A1 ELECTRICAL SITE PLAN - AREA 2**  
1" = 50'



## GENERAL NOTES

1. ALL EXISTING UNDERGROUND UTILITY LOCATIONS AS SHOWN ON THESE PLANS ARE APPROXIMATE AND MAY NOT REPRESENT ALL UNDERGROUND UTILITIES OR SERVICE LINES. SOURCE OF EXISTING UTILITY MAPPING: UTILITY LOCATIONS ARE BASED ON QUALITY LEVEL "B" AS DEFINED BY ASCE STANDARD 38-02 "STANDARD GUIDELINE FOR THE COLLECTION AND DEPICTION OF EXISTING SUBSURFACE UTILITY DATA". VERIFY EXACT LOCATION, DEPTH, SIZE, AND TYPE OF UTILITIES SHOWN AND NOTIFYING ENGINEER OF DISCREPANCIES. REPAIR AND REPATCH AS NEEDED SUBSEQUENT TO ANY DAMAGE TO PROPERTY OR UTILITIES.
2. CONTACT "MARYLAND MISS UTILITY" AT 1-800-257-7777 PRIOR TO BEGINNING ANY EXCAVATION OR DEMOLITION.
3. SEE SHEET E-501 FOR SITE LIGHTING FIXTURE SCHEDULE.
4. SEE SHEET E-104 FOR CABLE SCHEDULE.
5. COORDINATE SITE LIGHTING POLE BASE EXACT LOCATION WITH THE LANDSCAPING DESIGN.

## WORK NOTES

1. PROVIDE AIRFIELD LIGHTING FIXTURES AS INDICATED ON PLAN. ENSURE AIRFIELD LIGHTING FIXTURES ARE LOCATED AT A DISTANCE NO GREATER THAN 200' FROM EACH OTHER AT STRAIGHT TAXIWAY SECTIONS. AIRFIELD LIGHTING FIXTURES LOCATED 10' FROM EDGE OF CONCRETE TAXIWAY.
2. THIS PORTION UNDER PAVED SECTION IS CONCRETE-ENCASED DUCT BANK. SEE CABLE SCHEDULE ON SHEET E-104 TO DETERMINE NUMBER OF WAYS. ROUTE SITE LIGHTING ELECTRICAL CONDUIT/DUCT BANK BELOW GATE FOUNDATION.
3. SEE STRUCTURAL AND CIVIL PLANS FOR DETAILS REGARDING ELECTRICAL AND TELECOMM STRUCTURES.
4. MODIFY EXISTING ELECTRICAL MANHOLE RIM ELEVATION TO MATCH PROPOSED GRADE. SEE SHEET E-501, DETAIL M.
5. PROVIDE DIRECTIONAL BORING FOR LOCATIONS UNDERNEATH OF SOUTH PERIMETER RD. COORDINATE SPECIFIC REQUIREMENTS WITH BASE.
6. PROVIDE ROADWAY FLASHERS FOR TRAFFIC. SEE DETAIL (FIG. 84D) ON SHEET E-501.
7. PROVIDE NEMA-4X, STAINLESS STEEL, C-CHANNEL RACK-MOUNTED, NEMA-4X ENCLOSURE AND CONTROLLERS FOR GATE MOTORS. SEE DETAIL C3 ON SHEET E-502. PROVIDE CONTROL CABLING PER MANUFACTURERS INSTRUCTIONS AND RECOMMENDATION. COORDINATE WITH GATE CONTROLLER VENDOR TO PREVENT SIMULTANEOUS ENERGIZATION OF ALTERNATE CIRCUITS.
8. SEE DETAIL A1, SHEET E-504.
9. PROVIDE TYPE 10 HANDHOLE. SEE DETAIL C1 ON SHEET E-503.
10. SEE SHEET E-506 FOR MANHOLE AND HANDHOLE DIAGRAMS.

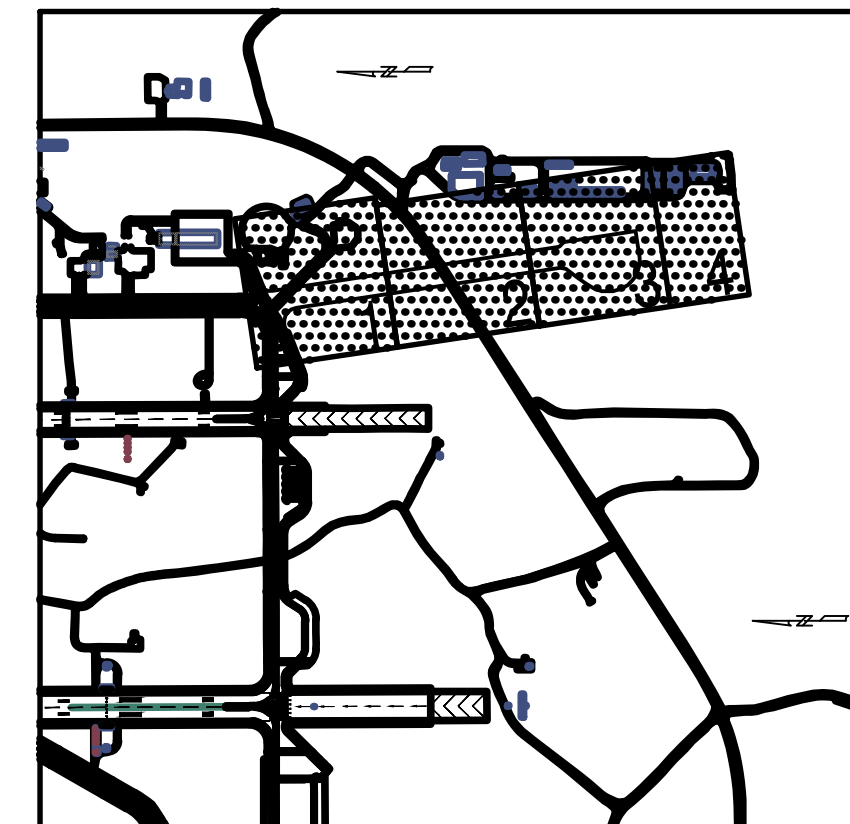

**KEY PLAN**

SYN	DESCRIPTION	DATE	APPR
1	AMENDMENT 005	04/15/2023	
0	ISSUE FOR CONSTRUCTION	9/26/2022	

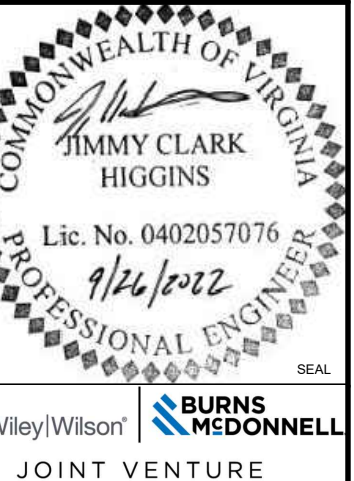

APPROVED: AVE INFO

FOR COMMANDER NAVFAC:

ACTIVITY:

SATISFACTORY TO: DATE:

DES: JCH | DRW: JCH | CHK: PO

BRANCH MANAGER:

CHIEF ENGINEER:

FIRE PROTECTION:

DEPARTMENT OF THE NAVY

NAVAL FACILITIES ENGINEERING COMMAND

WASHINGTON, DC

WASHINGTON NAVY YARD

CAMP SPRINGS, MD

P-3002 RELOCATE HAZARDOUS CARGO

PAD AND EOD PROFICIENCY RANGE

ELECTRICAL SITE PLAN - AREA 2

SCALE: AS NOTED

PROJECT NO.: 1396650

CONSTR. CONTR. NO. N40080-15-D-0452

NAVFAC DRAWING NO. 13132525

SHEET 180 OF 212

E-102

DRAWING REVISION: 06 APRIL 2017