

GENERAL NOTES

- ALL EXISTING EQUIPMENT MAY NOT BE SHOWN FOR CLARITY. CONTRACTOR SHALL FIELD VERIFY ALL POWER, LIGHTING AND ASSOCIATED CIRCUITRY AS REQUIRED. ALL RACEWAYS AND CONDUCTORS ASSOCIATED WITH EQUIPMENT TO BE DEMOLISHED SHALL BE DEMOLISHED BACK TO THEIR SOURCE, UNLESS OTHERWISE NOTED.
- CONTRACTOR SHALL DEMOLISH ALL ELECTRICAL EQUIPMENT, CONDUCTORS, AND RACEWAYS ASSOCIATED WITH WALLS BEING REMOVED AND IN ALL LOCATIONS WHERE JUNCTION BOXES WILL NOT REMAIN ACCESSIBLE AFTER INSTALLATION OF MILLWORK, UNLESS OTHERWISE NOTED.
- PROTECT ALL EXISTING WORK FROM DAMAGE DURING CONSTRUCTION. ANY DAMAGED MATERIALS, SYSTEMS, COMPONENTS, FINISHES BE LIKE, SHALL BE REPAIRED OR REPLACED AT THE EXPENSE OF THE CONTRACTOR TO THE ACCEPTANCE OF THE OWNER.
- CONTRACTOR SHALL COORDINATE NORMAL/ESSENTIAL ELECTRICAL SYSTEM SHUTDOWNS AND PHASING WITH THE VA PRIOR TO PERFORMING REQUIRED EQUIPMENT UPGRADES. CONTRACTOR TO PROVIDE BACKUP EMERGENCY POWER AND DETERMINE TIE-IN/CONNECTION PLAN WITH EXISTING EQUIPMENT. POWER TO ALL EXISTING ESSENTIAL EQUIPMENT CANNOT BE INTERRUPTED AND SHALL REMAIN ACTIVE DURING CONSTRUCTION. BACKUP POWER AND TIE-IN SHALL CONFORM WITH VA STANDARDS.
- SEAL ALL INTERIOR WALL AND CEILING PENETRATIONS TO MATCH EXISTING FIRE RATING OR NEW FIRE RATING, IF REQUIRED. COORDINATE WITH ARCHITECTURAL DRAWINGS AS REQUIRED.
- REFERENCE CORRESPONDING ONE-LINE DIAGRAM FOR ADDITIONAL INFORMATION.
- CONTRACTOR SHALL PROVIDE UPDATED CIRCUIT PANEL DIRECTORIES FOR ALL PANELS THAT CONTAIN CIRCUITS IMPACTED BY THIS PROJECT.
- CONTRACTOR SHALL BE RESPONSIBLE FOR RELOCATING FURNITURE, INCLUDING TRANSPORTATION, FOR ALL WORK TO DESIRED VA STORAGE LOCATION. COORDINATE WITH VA AS REQUIRED.

KEY NOTES

KEY PLAN

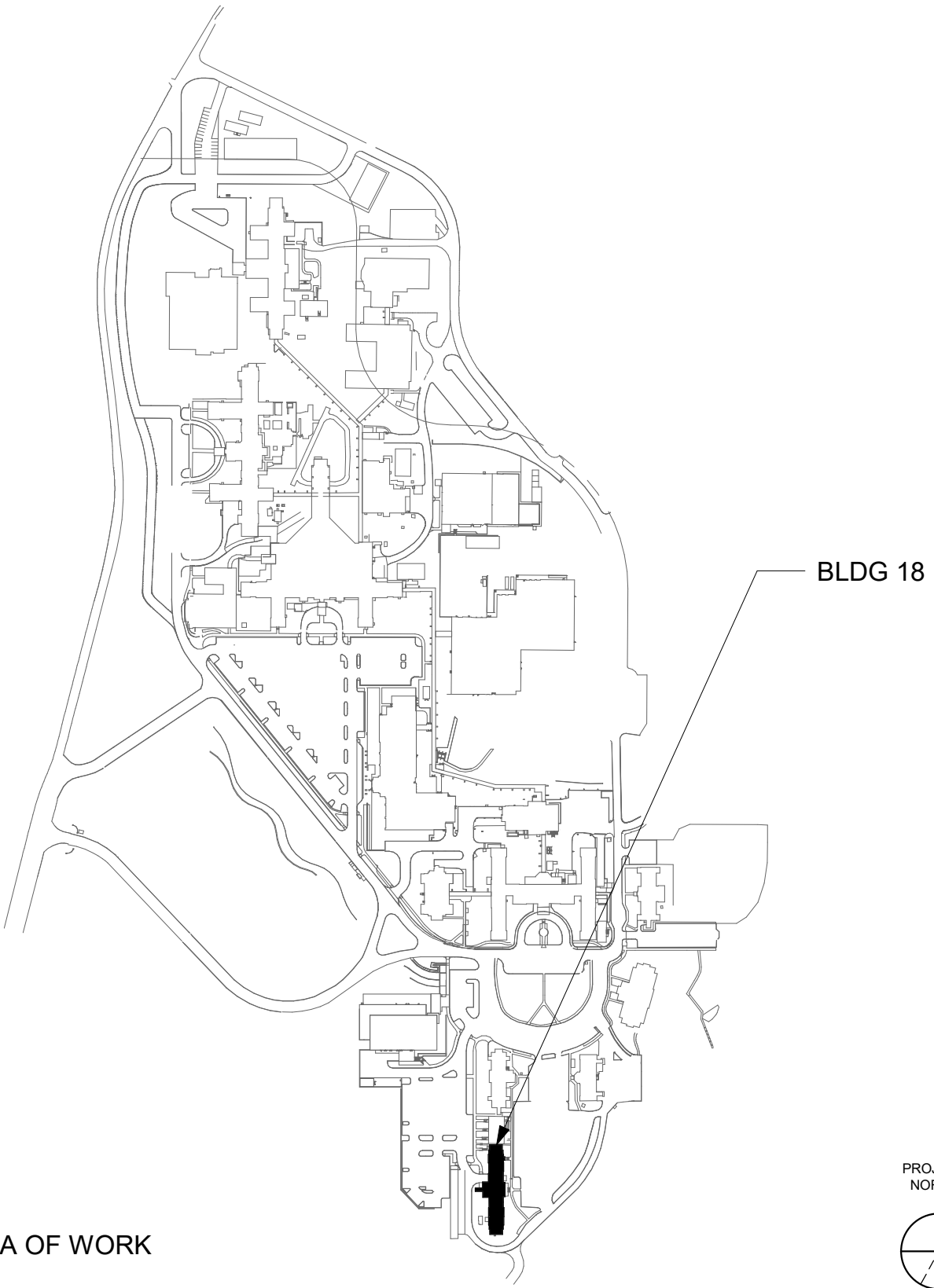

1 BLDG 18 - FLOOR 0 - ELECTRICAL PLAN
1/8" = 1'-0"

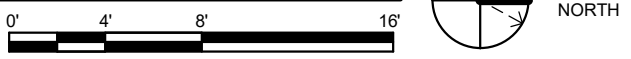

Revisions:	Date:

CONSULTANT

ARCHITECT/ENGINEER OF RECORD
A/E: SPEES DESIGN BUILD 625 1ST AVE, STE 301 SEATTLE, WA 98104 (206) 590-2118 RAY SPEES

STAMP

Office of Construction and Facilities Management
U.S. Department of Veterans Affairs

Drawing Title
BLDG 18 - FLOOR 0 - ELECTRICAL PLAN
Approved:

Phase
CONSTRUCTION DOCUMENTS
NON SPRINKLERED

Project Title
EHRM INFRASTRUCTURE UPGRADES
Location
ST. LOUIS VA MEDICAL CENTER - JEFFERSON BARRACKS, MO
Issue Date
03/31/2022
Checked
LRL/WM
Drawn
LLT/JPS

Project Number
657-21-701JB
Building Number
18
Drawing Number
18EP100
143 OF 435

GENERAL NOTES

- ALL EXISTING EQUIPMENT MAY NOT BE SHOWN FOR CLARITY. CONTRACTOR SHALL FIELD VERIFY ALL POWER, LIGHTING AND ASSOCIATED CIRCUITRY AS REQUIRED. ALL RACEWAYS AND CONDUCTORS ASSOCIATED WITH EQUIPMENT TO BE DEMOLISHED SHALL BE DEMOLISHED BACK TO THEIR SOURCE, UNLESS OTHERWISE NOTED.
- CONTRACTOR SHALL DEMOLISH ALL ELECTRICAL EQUIPMENT, CONDUCTORS, AND RACEWAYS ASSOCIATED WITH WALLS BEING REMOVED AND IN ALL LOCATIONS WHERE JUNCTION BOXES WILL NOT REMAIN ACCESSIBLE AFTER INSTALLATION OF MILLWORK, UNLESS OTHERWISE NOTED.
- PROTECT ALL EXISTING WORK FROM DAMAGE DURING CONSTRUCTION. ANY DAMAGED MATERIALS, SYSTEMS, COMPONENTS, FINISHES BE LIKE, SHALL BE REPAIRED OR REPLACED AT THE EXPENSE OF THE CONTRACTOR TO THE ACCEPTANCE OF THE OWNER.
- CONTRACTOR SHALL COORDINATE NORMAL/ESSENTIAL ELECTRICAL SYSTEM SHUTDOWNS AND PHASING WITH THE VA PRIOR TO PERFORMING REQUIRED EQUIPMENT UPGRADES. CONTRACTOR TO PROVIDE BACKUP EMERGENCY POWER AND DETERMINE TIE-IN/CONNECTION PLAN WITH EXISTING EQUIPMENT. POWER TO ALL EXISTING ESSENTIAL EQUIPMENT CANNOT BE INTERRUPTED AND SHALL REMAIN ACTIVE DURING CONSTRUCTION. BACKUP POWER AND TIE-IN SHALL CONFORM WITH VA STANDARDS.
- SEAL ALL INTERIOR WALL AND CEILING PENETRATIONS TO MATCH EXISTING FIRE RATING OR NEW FIRE RATING, IF REQUIRED. COORDINATE WITH ARCHITECTURAL DRAWINGS AS REQUIRED.
- REFERENCE CORRESPONDING ONE-LINE DIAGRAM FOR ADDITIONAL INFORMATION.
- CONTRACTOR SHALL PROVIDE UPDATED CIRCUIT PANEL DIRECTORIES FOR ALL PANELS THAT CONTAIN CIRCUITS IMPACTED BY THIS PROJECT.
- CONTRACTOR SHALL BE RESPONSIBLE FOR RELOCATING FURNITURE, INCLUDING TRANSPORTATION, FOR ALL WORK TO DESIRED VA STORAGE LOCATION. COORDINATE WITH VA AS REQUIRED.

KEY NOTES

- 1 PROVIDE CONDUIT AND WIRE FROM CONDENSING UNIT TO ASSOCIATED AC UNIT AS REQUIRED PER MANUFACTURER'S INSTRUCTIONS. COORDINATE WITH MECHANICAL CONTRACTOR AS REQUIRED.

KEY PLAN

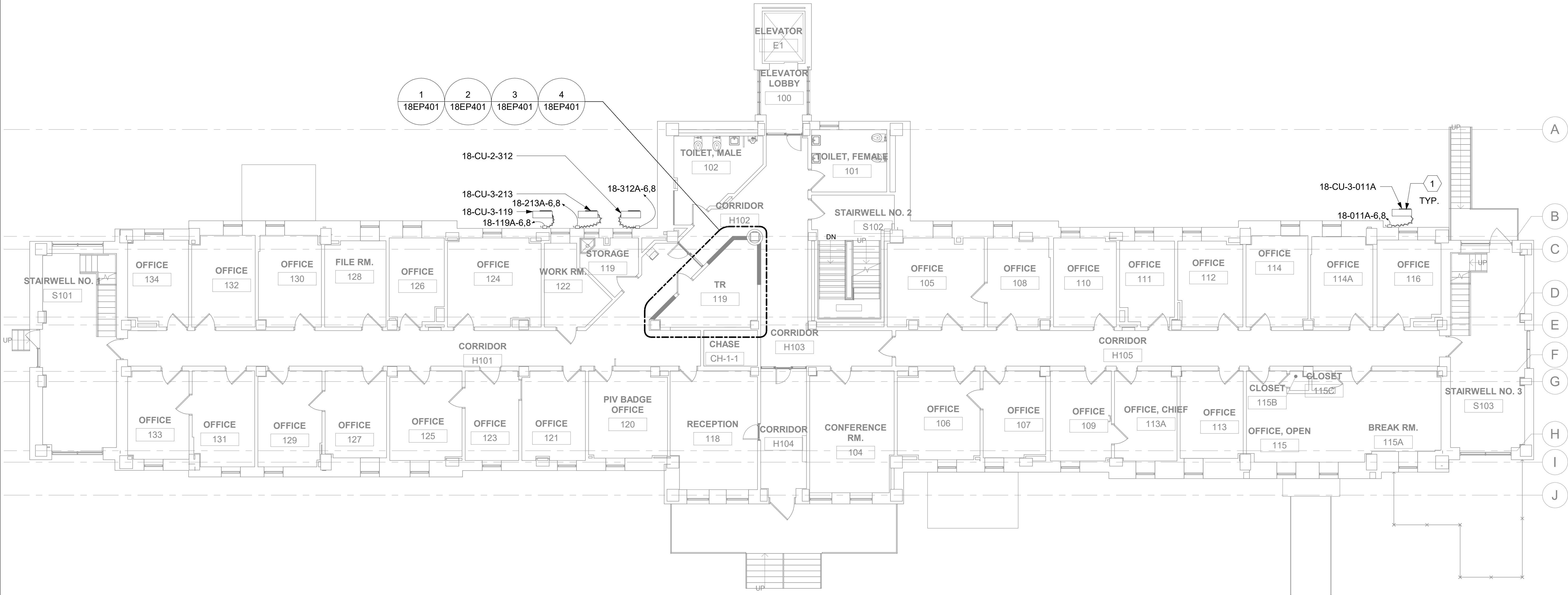
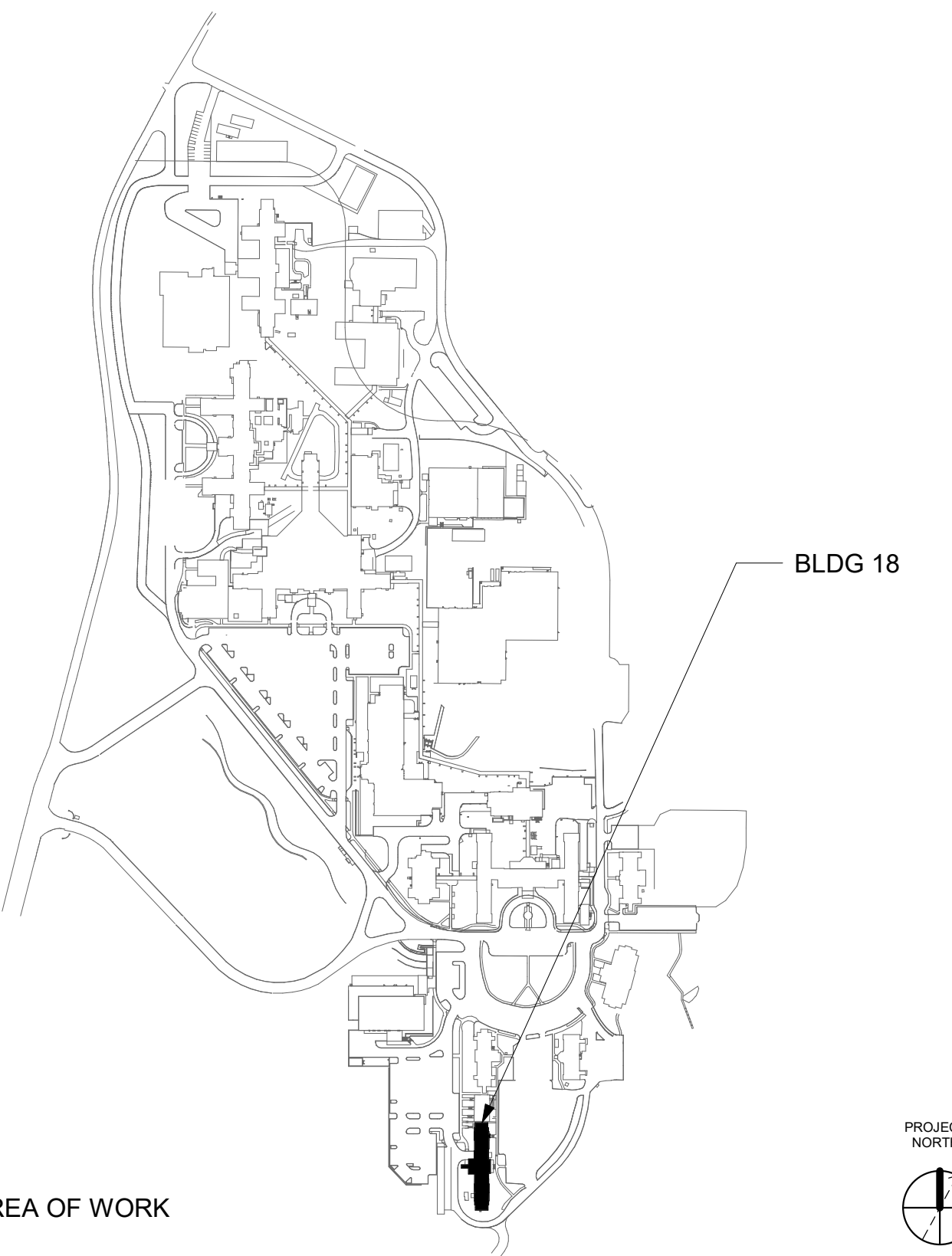

1 BLDG 18 - FLOOR 1 - ELECTRICAL PLAN
1/8" = 1'-0"

Revisions:	Date:	CONSULTANT	ARCHITECT/ENGINEER OF RECORD A/E: SPEES DESIGN BUILD 625 1ST AVE, STE 301 SEATTLE, WA 98104 (206) 590-2118 RAY SPEES	STAMP LOUIS R. LITZARD STATE OF WASHINGTON REGISTERED PROFESSIONAL ENGINEER 3-1-2023	Office of Construction and Facilities Management VA U.S. Department of Veterans Affairs	Drawing Title BLDG 18 - FLOOR 1 - ELECTRICAL PLAN	Phase CONSTRUCTION DOCUMENTS	Project Title EHRM INFRASTRUCTURE UPGRADES	Project Number 657-21-701JB
						Approved:	NON SPRINKLERED	Location ST. LOUIS VA MEDICAL CENTER - JEFFERSON BARRACKS, MO	Building Number 18
								Issue Date 03/31/2022	Drawing Number 18EP101
								Checked LRL/WM	144 OF 435
								Drawn LLT/JPS	

GENERAL NOTES

1. ALL EXISTING EQUIPMENT MAY NOT BE SHOWN FOR CLARITY. CONTRACTOR SHALL FIELD VERIFY ALL POWER, LIGHTING AND ASSOCIATED CIRCUITRY AS REQUIRED. ALL RACEWAYS AND CONDUCTORS ASSOCIATED WITH EQUIPMENT TO BE DEMOLISHED SHALL BE DEMOLISHED BACK TO THEIR SOURCE, UNLESS OTHERWISE NOTED.
2. CONTRACTOR SHALL DEMOLISH ALL ELECTRICAL EQUIPMENT, CONDUCTORS, AND RACEWAYS ASSOCIATED WITH WALLS BEING REMOVED AND IN ALL LOCATIONS WHERE JUNCTION BOXES WILL NOT REMAIN ACCESSIBLE AFTER INSTALLATION OF MILLWORK, UNLESS OTHERWISE NOTED.
3. PROTECT ALL EXISTING WORK FROM DAMAGE DURING CONSTRUCTION. ANY DAMAGED MATERIALS, SYSTEMS, COMPONENTS, FINISHES ETC. LIKE SHALL BE REPAIRED OR REPLACED AT THE EXPENSE OF THE CONTRACTOR TO THE ACCEPTANCE OF THE OWNER.
4. CONTRACTOR SHALL COORDINATE NORMAL/ESSENTIAL ELECTRICAL SYSTEM SHUTDOWNS AND PHASING WITH THE VA PRIOR TO PERFORMING REQUIRED EQUIPMENT UPGRADES. CONTRACTOR TO PROVIDE BACKUP EMERGENCY POWER AND OBTAIN THE TIE-IN CONNECTION PLAN WITH EXISTING EQUIPMENT. POWER TO ALL EXISTING ESSENTIAL EQUIPMENT CANNOT BE INTERRUPTED AND SHALL REMAIN ACTIVE DURING CONSTRUCTION. BACKUP POWER AND TIE-IN SHALL CONFORM WITH VA STANDARDS.
5. SEAL ALL INTERIOR WALL AND CEILING PENETRATIONS TO MATCH EXISTING FIRE RATING OR NEW FIRE RATING, IF REQUIRED. COORDINATE WITH ARCHITECTURAL DRAWINGS AS REQUIRED.
6. REFERENCE CORRESPONDING ONE-LINE DIAGRAM FOR ADDITIONAL INFORMATION.
7. CONTRACTOR SHALL PROVIDE UPDATED CIRCUIT PANEL DIRECTORIES FOR ALL PANELS THAT CONTAIN CIRCUITS IMPACTED BY THIS PROJECT.
8. CONTRACTOR SHALL BE RESPONSIBLE FOR RELOCATING FURNITURE, INCLUDING TRANSPORTATION, FOR ALL WORK TO DESIRED VA STORAGE LOCATION. COORDINATE WITH VA AS REQUIRED.

KEY NOTES

KEY PLAN

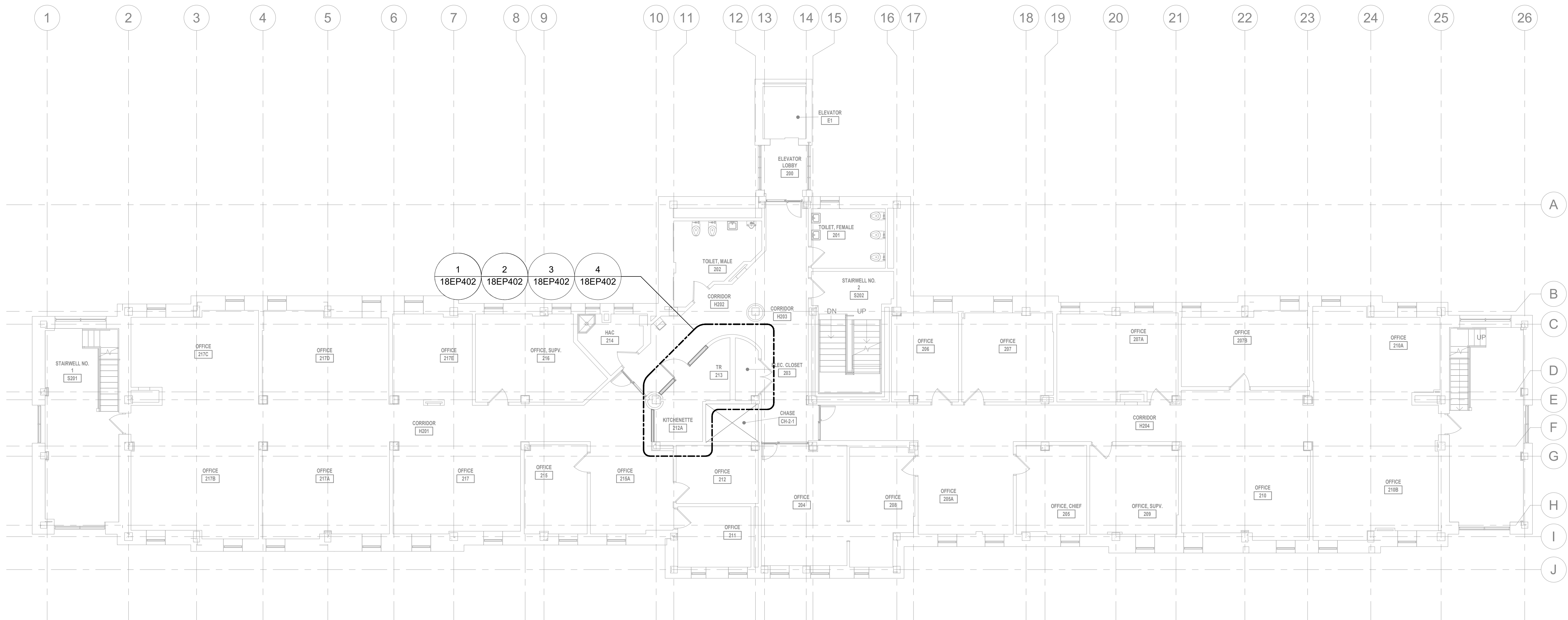
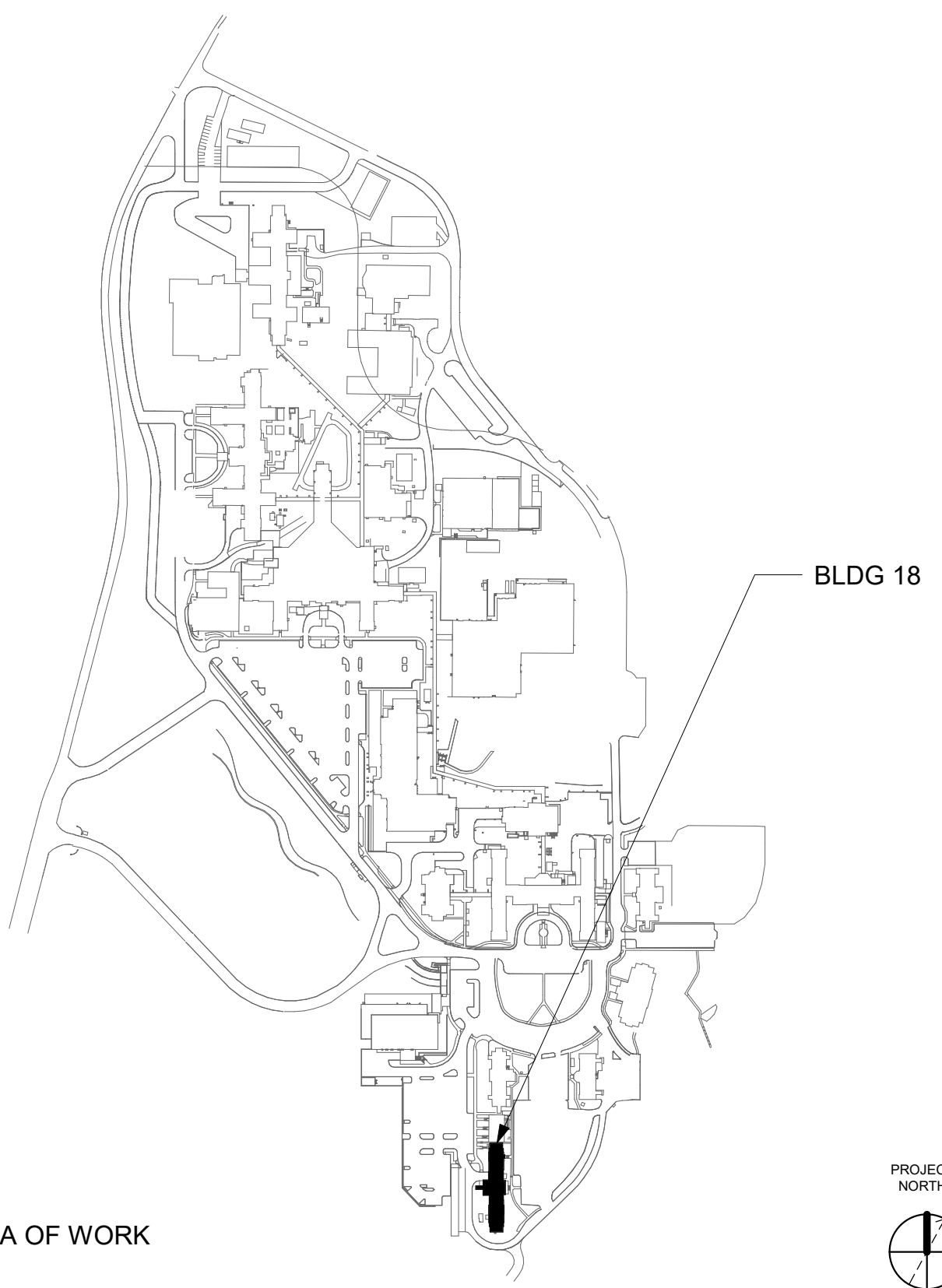

1 BLDG 18 - FLOOR 2 - ELECTRICAL PLAN
1/8" = 1'-0" 0' 4' 8' 16' PROJECT NORTH

--	--	--	--	--	--	--	--	--	--	--	--	--	--	--	--	--	--	--	--	--	--	--	--	--	--	--	--	--	--	--	--	--	--	--	--	--	--	--	--	--	--	--	--	--	--	--	--	--	--	--	--	--	--	--	--	--	--	--	--	--	--	--	--	--	--	--	--	--	--	--	--	--	--	--	--	--	--	--	--	--	--	--	--	--	--	--	--	--	--	--	--	--	--	--	--	--	--	--	--	--	--	--	--	--	--	--	--	--	--	--	--	--	--	--	--	--	--	--	--	--	--	--	--	--	--	--	--	--	--	--	--	--	--	--	--	--	--	--	--	--	--	--	--	--	--	--	--	--	--	--	--	--	--	--	--	--	--	--	--	--	--	--	--	--	--	--	--	--	--	--	--	--	--	--	--	--	--	--	--	--	--	--	--	--	--	--	--	--	--	--	--	--	--	--	--	--	--	--	--	--	--	--	--	--	--	--	--	--	--	--	--	--	--	--	--	--	--	--	--	--	--	--	--	--	--	--	--	--	--	--	--	--	--	--	--	--	--	--	--	--	--	--	--	--	--	--	--	--	--	--	--	--	--	--	--	--	--	--	--	--	--	--	--	--	--	--	--	--	--	--	--	--	--	--	--	--	--	--	--	--	--	--	--	--	--	--	--	--	--	--	--	--	--	--	--	--	--	--	--	--	--	--	--	--	--	--	--	--	--	--	--	--	--	--	--	--	--	--	--	--	--	--	--	--	--	--	--	--	--	--	--	--	--	--	--	--	--	--	--	--	--	--	--	--	--	--	--	--	--	--	--	--	--	--	--	--	--	--	--	--	--	--	--	--	--	--	--	--	--	--	--	--	--	--	--	--	--	--	--	--	--	--	--	--	--	--	--	--	--	--	--	--	--	--	--	--	--	--	--	--	--	--	--	--	--	--	--	--	--	--	--	--	--	--	--	--	--	--	--	--	--	--	--	--	--	--	--	--	--	--	--	--	--	--	--	--	--	--	--	--	--	--	--	--	--	--	--	--	--	--	--	--	--	--	--	--	--	--	--	--	--	--	--	--	--	--	--	--	--	--	--	--	--	--	--	--	--	--	--	--	--	--	--	--	--	--	--	--	--	--	--	--	--	--	--	--	--	--	--	--	--	--	--	--	--	--	--	--	--	--	--	--	--	--	--	--	--	--	--	--	--	--	--	--	--	--	--	--	--	--	--	--	--	--	--	--	--	--	--	--	--	--	--	--	--	--	--	--	--	--	--	--	--	--	--	--	--	--	--	--	--	--	--	--	--	--	--	--	--	--	--	--	--	--	--	--	--	--	--	--	--	--	--	--

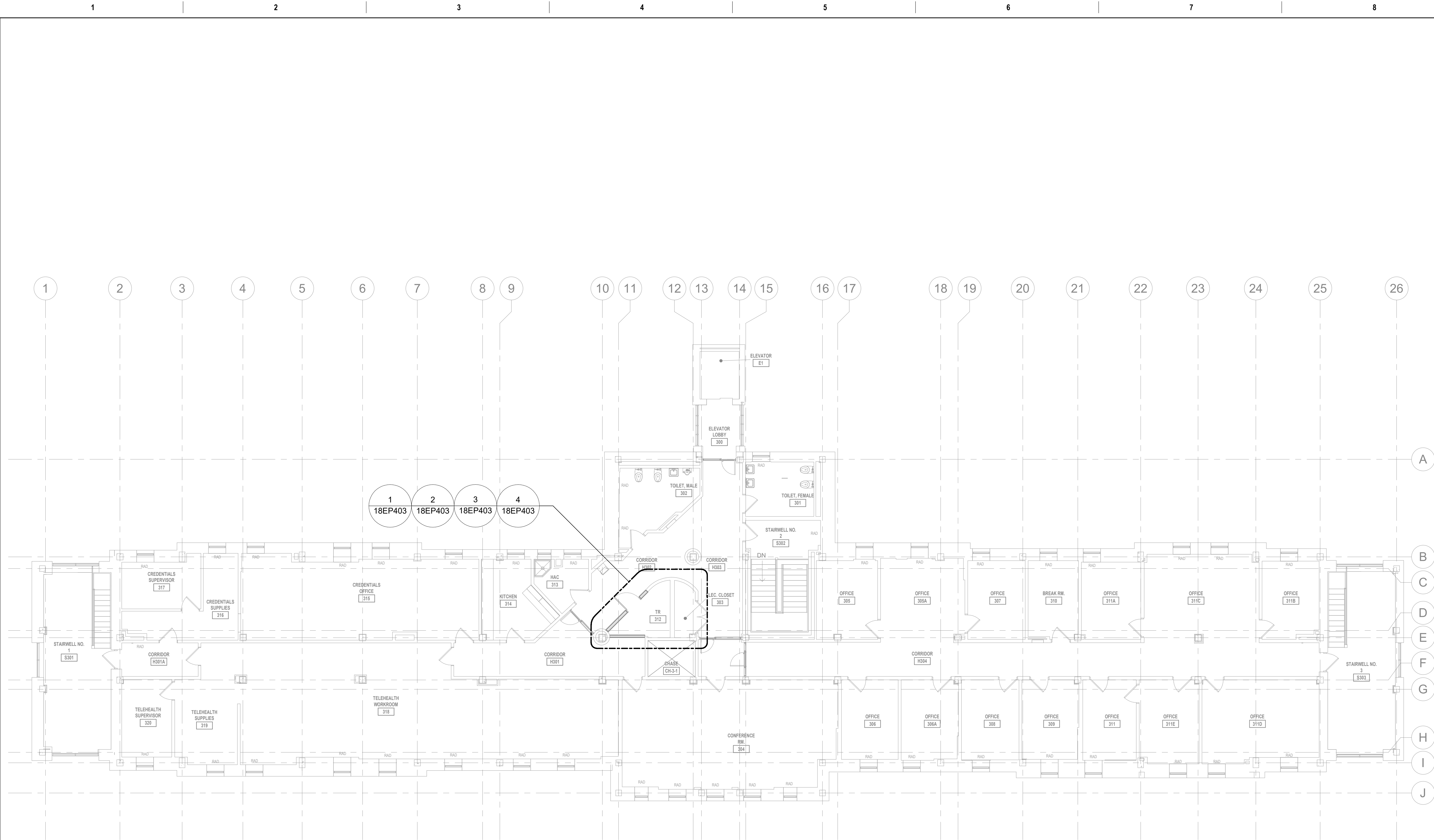

1 BLDG 18 - FLOOR 3 - ELECTRICAL PLAN
1/8" = 1'-0"

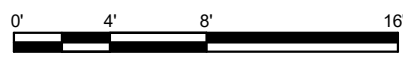

GENERAL NOTES

- ALL EXISTING EQUIPMENT MAY NOT BE SHOWN FOR CLARITY. CONTRACTOR SHALL FIELD VERIFY ALL POWER, LIGHTING AND ASSOCIATED CIRCUITRY AS REQUIRED. ALL RACEWAYS AND CONDUCTORS ASSOCIATED WITH EQUIPMENT TO BE DEMOLISHED SHALL BE DEMOLISHED BACK TO THEIR SOURCE, UNLESS OTHERWISE NOTED.
- CONTRACTOR SHALL DEMOLISH ALL ELECTRICAL EQUIPMENT, CONDUCTORS, AND RACEWAYS ASSOCIATED WITH WALLS BEING REMOVED AND IN ALL LOCATIONS WHERE JUNCTION BOXES WILL NOT REMAIN ACCESSIBLE AFTER INSTALLATION OF MILLWORK, UNLESS OTHERWISE NOTED.
- PROTECT ALL EXISTING WORK FROM DAMAGE DURING CONSTRUCTION. ANY DAMAGED MATERIALS, SYSTEMS, COMPONENTS, FINISHES BE LIKE, SHALL BE REPAIRED OR REPLACED AT THE EXPENSE OF THE CONTRACTOR TO THE ACCEPTANCE OF THE OWNER.
- CONTRACTOR SHALL COORDINATE NORMAL/ESSENTIAL ELECTRICAL SYSTEM SHUTDOWNS AND PHASING WITH THE VA PRIOR TO PERFORMING REQUIRED EQUIPMENT UPGRADES. CONTRACTOR TO PROVIDE BACKUP EMERGENCY POWER AND DETERMINE TIE-IN/CONNECTION PLAN WITH EXISTING EQUIPMENT. POWER TO ALL EXISTING ESSENTIAL EQUIPMENT CANNOT BE INTERRUPTED AND SHALL REMAIN ACTIVE DURING CONSTRUCTION. BACKUP POWER AND TIE-IN SHALL CONFORM WITH VA STANDARDS.
- SEAL ALL INTERIOR WALL AND CEILING PENETRATIONS TO MATCH EXISTING FIRE RATING OR NEW FIRE RATING, IF REQUIRED. COORDINATE WITH ARCHITECTURAL DRAWINGS AS REQUIRED.
- REFERENCE CORRESPONDING ONE-LINE DIAGRAM FOR ADDITIONAL INFORMATION.
- CONTRACTOR SHALL PROVIDE UPDATED CIRCUIT PANEL DIRECTORIES FOR ALL PANELS THAT CONTAIN CIRCUITS IMPACTED BY THIS PROJECT.
- CONTRACTOR SHALL BE RESPONSIBLE FOR RELOCATING FURNITURE, INCLUDING TRANSPORTATION, FOR ALL WORK TO DESIRED VA STORAGE LOCATION. COORDINATE WITH VA AS REQUIRED.

KEY NOTES

KEY PLAN

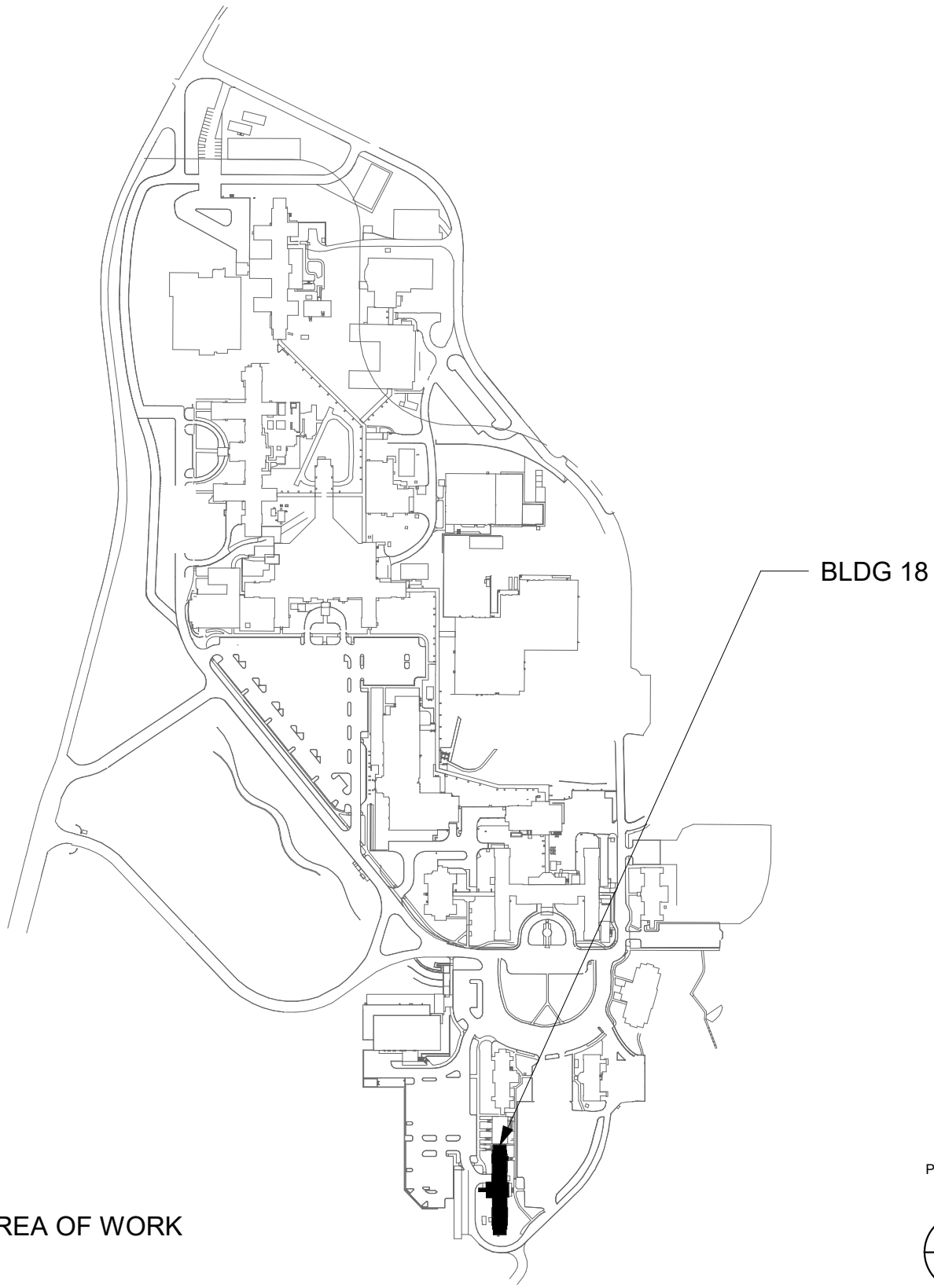

Revisions:	Date:

CONSULTANT

ARCHITECT/ENGINEER OF RECORD
A/E: SPEES DESIGN BUILD 625 1ST AVE, STE 301 SEATTLE, WA 98104 (206) 590-2118 RAY SPEES

STAMP

Office of Construction and Facilities Management
U.S. Department of Veterans Affairs

Drawing Title
BLDG 18 - FLOOR 3 - ELECTRICAL PLAN
Approved:

Phase
CONSTRUCTION DOCUMENTS
NON SPRINKLERED

Project Title
EHRM INFRASTRUCTURE UPGRADES
Location
ST. LOUIS VA MEDICAL CENTER - JEFFERSON BARRACKS, MO
Issue Date
03/31/2022
Checked
LRL/WM
Drawn
LLT/JPS

Project Number
657-21-701JB
Building Number
18
Drawing Number
18EP103
146 OF 435

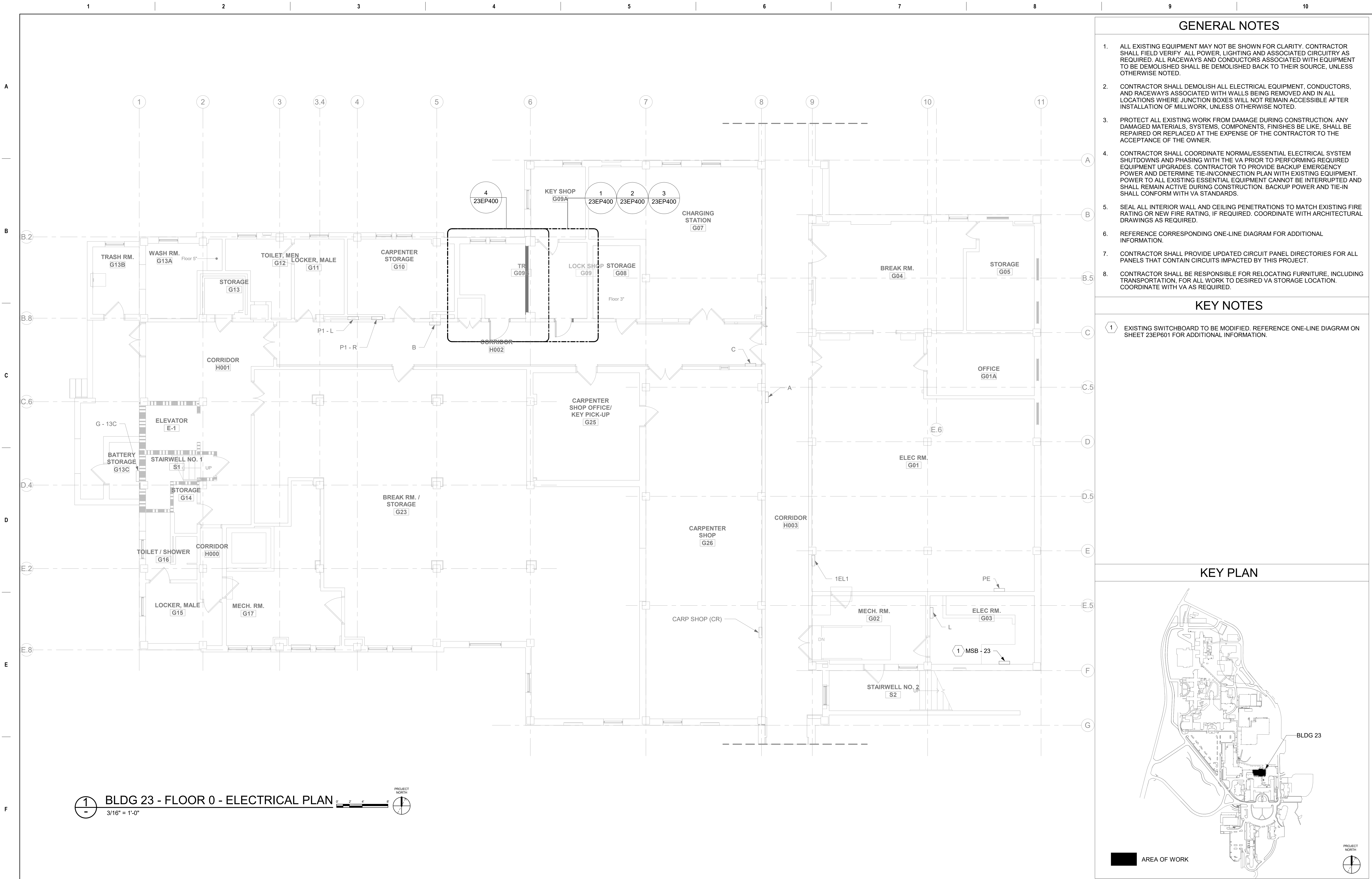

GENERAL NOTES

1. ALL EXISTING EQUIPMENT MAY NOT BE SHOWN FOR CLARITY. CONTRACTOR SHALL FIELD VERIFY ALL POWER, LIGHTING AND ASSOCIATED CIRCUITRY AS REQUIRED. ALL RACEWAYS AND CONDUCTORS ASSOCIATED WITH EQUIPMENT TO BE DEMOLISHED SHALL BE DEMOLISHED BACK TO THEIR SOURCE, UNLESS OTHERWISE NOTED.
2. CONTRACTOR SHALL DEMOLISH ALL ELECTRICAL EQUIPMENT, CONDUCTORS, AND RACEWAYS ASSOCIATED WITH WALLS BEING REMOVED AND IN ALL LOCATIONS WHERE JUNCTION BOXES WILL NOT REMAIN ACCESSIBLE AFTER INSTALLATION OF MILLWORK, UNLESS OTHERWISE NOTED.
3. PROTECT ALL EXISTING WORK FROM DAMAGE DURING CONSTRUCTION. ANY DAMAGED MATERIALS, SYSTEMS, COMPONENTS, FINISHES BE LIKE, SHALL BE REPAIRED OR REPLACED AT THE EXPENSE OF THE CONTRACTOR TO THE ACCEPTANCE OF THE OWNER.
4. CONTRACTOR SHALL COORDINATE NORMAL/ESSENTIAL ELECTRICAL SYSTEM SHUTDOWNS AND PHASING WITH THE VA PRIOR TO PERFORMING REQUIRED EQUIPMENT UPGRADES. CONTRACTOR TO PROVIDE BACKUP EMERGENCY POWER AND DETERMINE TIE-IN/CONNECTION PLAN WITH EXISTING EQUIPMENT. POWER TO ALL EXISTING ESSENTIAL EQUIPMENT CANNOT BE INTERRUPTED AND SHALL REMAIN ACTIVE DURING CONSTRUCTION. BACKUP POWER AND TIE-IN SHALL CONFORM WITH VA STANDARDS.
5. SEAL ALL INTERIOR WALL AND CEILING PENETRATIONS TO MATCH EXISTING FIRE RATING OR NEW FIRE RATING, IF REQUIRED. COORDINATE WITH ARCHITECTURAL DRAWINGS AS REQUIRED.
6. REFERENCE CORRESPONDING ONE-LINE DIAGRAM FOR ADDITIONAL INFORMATION.
7. CONTRACTOR SHALL PROVIDE UPDATED CIRCUIT PANEL DIRECTORIES FOR ALL PANELS THAT CONTAIN CIRCUITS IMPACTED BY THIS PROJECT.
8. CONTRACTOR SHALL BE RESPONSIBLE FOR RELOCATING FURNITURE, INCLUDING TRANSPORTATION, FOR ALL WORK TO DESIRED VA STORAGE LOCATION. COORDINATE WITH VA AS REQUIRED.

KEY NOTES

1. EXISTING SWITCHBOARD TO BE MODIFIED. REFERENCE ONE-LINE DIAGRAM ON SHEET 23EP601 FOR ADDITIONAL INFORMATION.

KEY PLAN

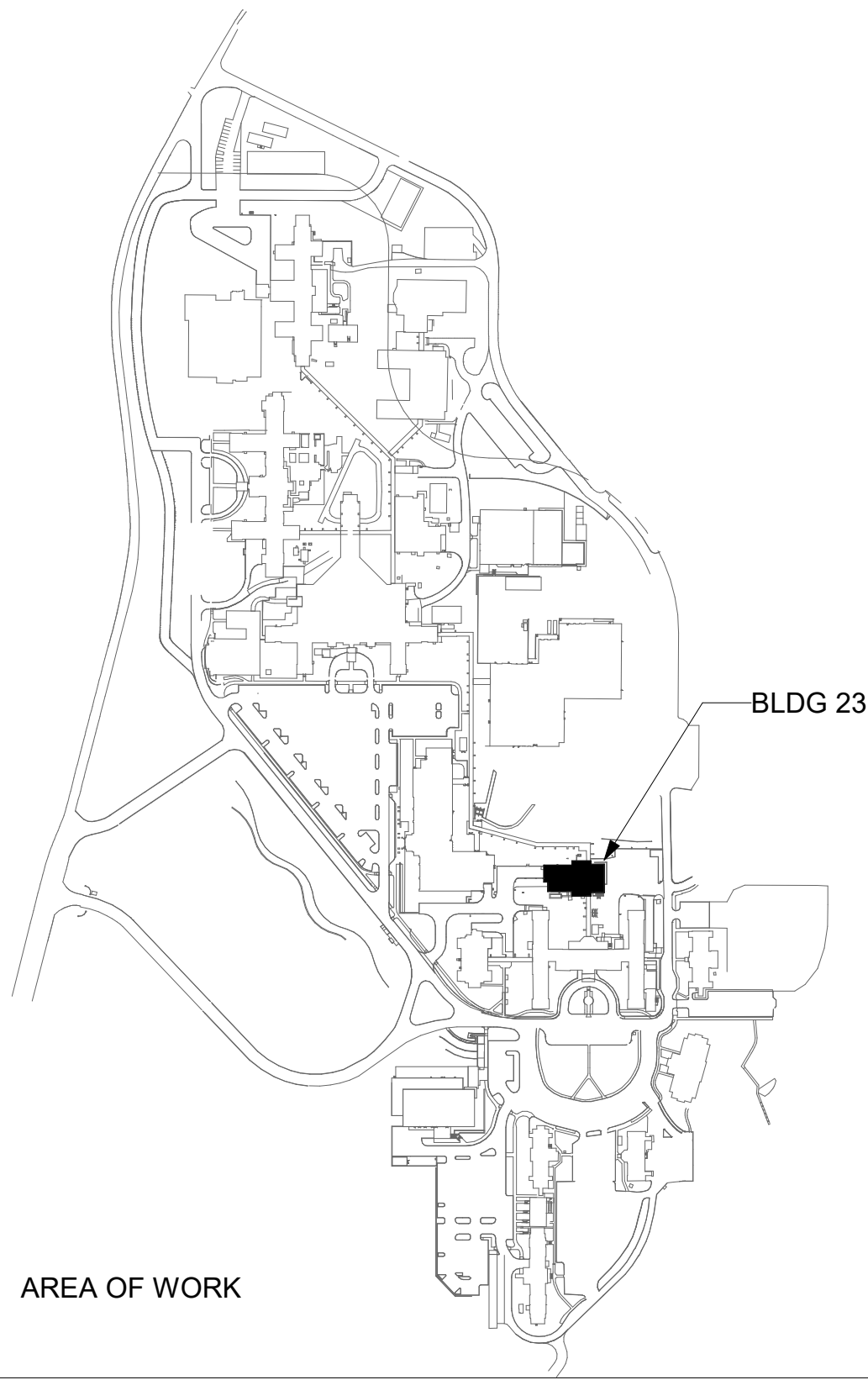

		CONSULTANT	ARCHITECT/ENGINEER OF RECORD	STAMP	Office of Construction and Facilities Management	Drawing Title BLDG 23 - FLOOR 0 - ELECTRICAL PLAN	Phase CONSTRUCTION DOCUMENTS	Project Title EHRM INFRASTRUCTURE UPGRADES	Project Number 657-21-701JB							
										A/E: SPEES DESIGN BUILD 625 1ST AVE, STE 301 SEATTLE, WA 98104 (206) 590-2118 RAY SPEES		VA U.S. Department of Veterans Affairs	Approved:	NON SPRINKLER	Location ST. LOUIS VA MEDICAL CENTER - JEFFERSON BARRACKS, MO	Building Number 23
Revisions:	Date:							Issue Date 03/31/2022	Checked LRL/WM	Drawn LLT/JPS	Drawing Number 23EP100					
											147 OF 435					

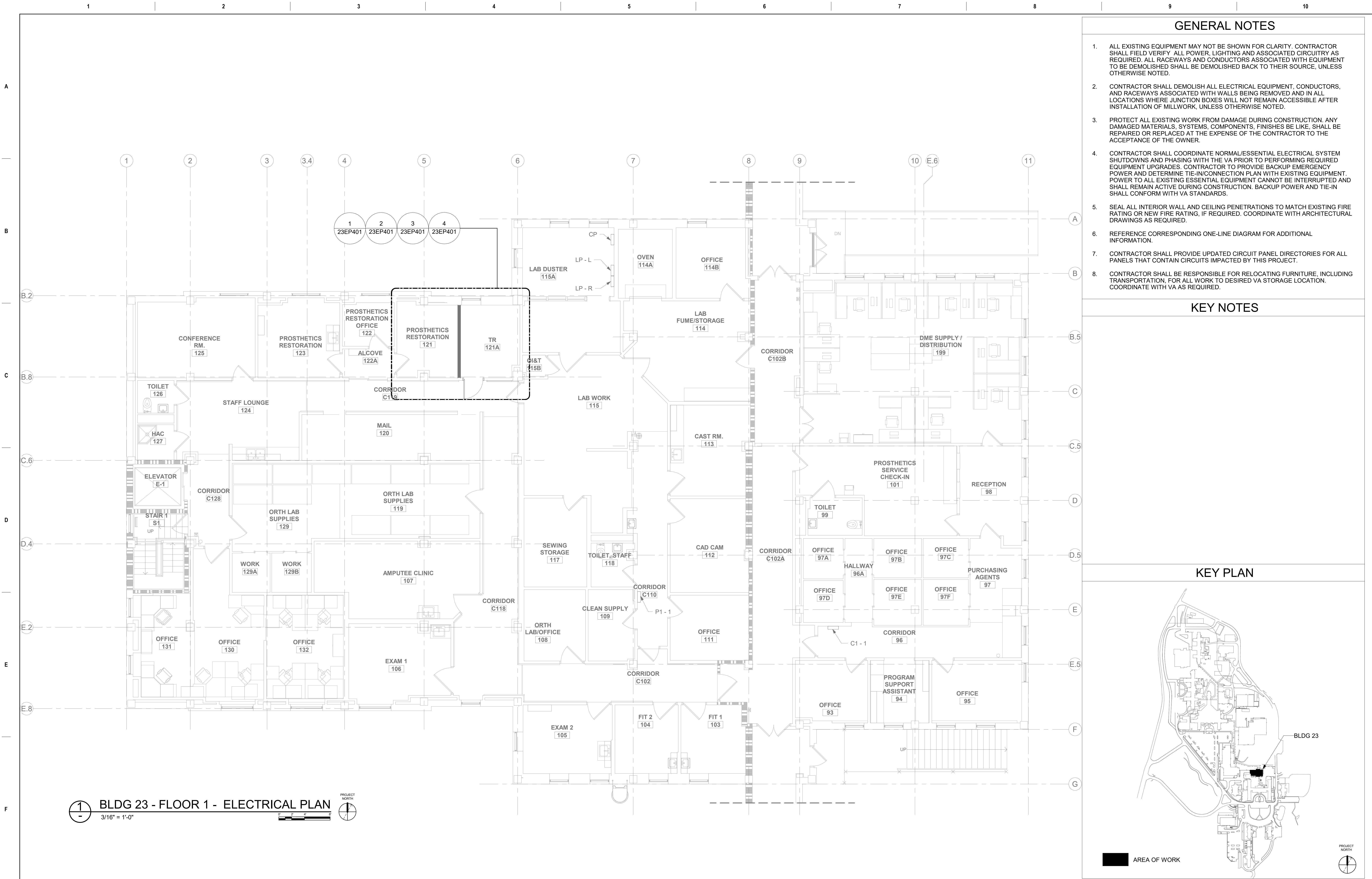

GENERAL NOTES

- ALL EXISTING EQUIPMENT MAY NOT BE SHOWN FOR CLARITY. CONTRACTOR SHALL FIELD VERIFY ALL POWER, LIGHTING AND ASSOCIATED CIRCUITRY AS REQUIRED. ALL RACEWAYS AND CONDUCTORS ASSOCIATED WITH EQUIPMENT TO BE DEMOLISHED SHALL BE DEMOLISHED BACK TO THEIR SOURCE, UNLESS OTHERWISE NOTED.
- CONTRACTOR SHALL DEMOLISH ALL ELECTRICAL EQUIPMENT, CONDUCTORS, AND RACEWAYS ASSOCIATED WITH WALLS BEING REMOVED AND IN ALL LOCATIONS WHERE JUNCTION BOXES WILL NOT REMAIN ACCESSIBLE AFTER INSTALLATION OF MILLWORK, UNLESS OTHERWISE NOTED.
- PROTECT ALL EXISTING WORK FROM DAMAGE DURING CONSTRUCTION. ANY DAMAGED MATERIALS, SYSTEMS, COMPONENTS, FINISHES BE LIKE, SHALL BE REPAIRED OR REPLACED AT THE EXPENSE OF THE CONTRACTOR TO THE ACCEPTANCE OF THE OWNER.
- CONTRACTOR SHALL COORDINATE NORMAL/ESSENTIAL ELECTRICAL SYSTEM SHUTDOWNS AND PHASING WITH THE VA PRIOR TO PERFORMING REQUIRED EQUIPMENT UPGRADES. CONTRACTOR TO PROVIDE BACKUP EMERGENCY POWER AND DETERMINE TIE-IN/CONNECTION PLAN WITH EXISTING EQUIPMENT. POWER TO ALL EXISTING ESSENTIAL EQUIPMENT CANNOT BE INTERRUPTED AND SHALL REMAIN ACTIVE DURING CONSTRUCTION. BACKUP POWER AND TIE-IN SHALL CONFORM WITH VA STANDARDS.
- SEAL ALL INTERIOR WALL AND CEILING PENETRATIONS TO MATCH EXISTING FIRE RATING OR NEW FIRE RATING, IF REQUIRED. COORDINATE WITH ARCHITECTURAL DRAWINGS AS REQUIRED.
- REFERENCE CORRESPONDING ONE-LINE DIAGRAM FOR ADDITIONAL INFORMATION.
- CONTRACTOR SHALL PROVIDE UPDATED CIRCUIT PANEL DIRECTORIES FOR ALL PANELS THAT CONTAIN CIRCUITS IMPACTED BY THIS PROJECT.
- CONTRACTOR SHALL BE RESPONSIBLE FOR RELOCATING FURNITURE, INCLUDING TRANSPORTATION, FOR ALL WORK TO DESIRED VA STORAGE LOCATION. COORDINATE WITH VA AS REQUIRED.

KEY NOTES

KEY PLAN

--	--	--	--	--	--	--	--	--	--	--	--	--	--	--	--	--	--	--	--	--	--	--	--	--	--	--	--	--	--	--	--	--	--	--	--	--	--	--	--	--	--	--	--	--	--	--	--	--	--	--	--	--	--	--	--	--	--	--	--	--	--	--	--	--	--	--	--	--	--	--	--	--	--	--	--	--	--	--	--	--	--	--	--	--	--	--	--	--	--	--	--	--	--	--	--	--	--	--	--	--	--	--	--	--	--	--	--	--	--	--	--	--	--	--	--	--	--	--	--	--	--	--	--	--	--	--	--	--	--	--	--	--	--	--	--	--	--	--	--	--	--	--	--	--	--	--	--	--	--	--	--	--	--	--	--	--	--	--	--	--	--	--	--	--	--	--	--	--	--	--	--	--	--	--	--	--	--	--	--	--	--	--	--	--	--	--	--	--	--	--	--	--	--	--	--	--	--	--	--	--	--	--	--	--	--	--	--	--	--	--	--	--	--	--	--	--	--	--	--	--	--	--	--	--	--	--	--	--	--	--	--	--	--	--	--	--	--	--	--	--	--	--	--	--	--	--	--	--	--	--	--	--	--	--	--	--	--	--	--	--	--	--	--	--	--	--	--	--	--	--	--	--	--	--	--	--	--	--	--	--	--	--	--	--	--	--	--	--	--	--	--	--	--	--	--	--	--	--	--	--	--	--	--	--	--	--	--	--	--	--	--	--	--	--	--	--	--	--	--	--	--	--	--	--	--	--	--	--	--	--	--	--	--	--	--	--	--	--	--	--	--	--	--	--	--	--	--	--	--	--	--	--	--	--	--	--	--	--	--	--	--	--	--	--	--	--	--	--	--	--	--	--	--	--	--	--	--	--	--	--	--	--	--	--	--	--	--	--	--	--	--	--	--	--	--	--	--	--	--	--	--	--	--	--	--	--	--	--	--	--	--	--	--	--	--	--	--	--	--	--	--	--	--	--	--	--	--	--	--	--	--	--	--	--	--	--	--	--	--	--	--	--	--	--	--	--	--	--	--	--	--	--	--	--	--	--	--	--	--	--	--	--	--	--	--	--	--	--	--	--	--	--	--	--	--	--	--	--	--	--	--	--	--	--	--	--	--	--	--	--	--	--	--	--	--	--	--	--	--	--	--	--	--	--	--	--	--	--	--	--	--	--	--	--	--	--	--	--	--	--	--	--	--	--	--	--	--	--	--	--	--	--	--	--	--	--	--	--	--	--	--	--	--	--	--	--	--	--	--	--	--	--	--	--	--	--	--	--	--	--	--	--	--	--	--	--	--	--	--	--	--	--	--	--	--	--	--	--	--	--	--	--	--	--	--	--	--	--	--	--	--	--	--	--	--	--	--	--	--	--	--	--	--	--	--	--	--	--	--	--	--	--	--	--	--	--	--	--	--	--	--	--	--	--	--	--	--	--	--	--	--	--	--	--	--	--	--	--	--	--	--	--	--	--	--	--	--	--	--	--	--	--	--	--	--	--	--	--	--	--	--	--	--	--	--	--	--	--	--	--	--	--	--	--	--	--	--	--	--	--	--	--	--	--	--	--	--	--	--	--	--	--	--	--	--	--	--	--	--	--	--	--	--	--	--	--	--	--	--	--	--	--	--	--	--	--	--	--	--	--	--	--	--	--	--	--	--	--	--	--	--	--	--	--	--	--	--	--	--	--	--	--	--	--	--	--	--	--	--	--	--	--	--	--	--	--	--	--	--	--	--	--	--	--	--	--	--	--	--	--	--	--	--	--	--	--	--	--	--	--	--	--	--	--	--	--	--	--	--	--	--	--	--	--	--	--	--	--	--	--	--	--	--	--	--	--	--	--	--	--	--	--	--	--	--	--	--	--	--	--	--	--	--	--	--	--	--	--	--	--	--	--	--	--	--	--	--	--	--	--	--	--	--	--	--	--	--	--	--	--	--	--	--	--	--	--	--	--	--	--	--	--	--	--	--	--	--	--	--	--	--	--	--	--	--	--	--	--	--	--	--	--	--	--	--	--	--	--	--	--	--	--	--	--	--	--	--	--	--	--	--	--	--	--	--	--	--	--	--	--	--	--	--	--	--	--	--	--	--	--	--	--	--	--	--	--	--	--	--	--	--	--	--	--	--	--	--	--	--	--	--	--	--	--	--	--	--	--	--	--	--	--	--	--	--	--	--	--	--	--	--	--	--	--	--	--	--	--	--	--	--	--	--	--	--	--	--	--	--	--	--	--	--	--	--	--	--	--	--	--	--	--	--	--	--	--	--	--	--	--	--	--	--	--	--	--	--	--	--	--	--	--	--	--	--	--	--	--	--	--	--	--	--	--	--	--	--	--	--	--	--	--	--	--	--	--	--	--	--	--	--	--	--	--	--	--	--	--	--	--	--	--	--	--	--	--	--	--	--	--	--	--	--	--	--	--	--	--	--	--	--	--	--	--	--	--	--	--	--	--	--	--	--	--	--	--	--	--	--	--	--	--	--	--	--	--	--	--	--	--	--	--	--	--	--	--	--	--	--	--	--	--	--	--	--	--	--	--	--	--	--	--	--	--	--	--	--	--	--	--	--	--	--	--	--	--	--	--	--	--	--	--	--	--	--	--	--	--	--	--	--	--	--	--	--	--	--	--	--	--	--	--	--	--	--	--	--	--	--	--	--	--	--	--	--	--	--	--	--	--	--	--	--	--	--	--	--	--	--	--	--	--	--	--	--	--	--	--	--	--	--	--	--	--	--	--	--	--	--	--	--	--	--	--	--	--	--	--	--	--	--	--	--	--	--	--	--	--	--	--	--	--	--	--	--	--	--	--	--	--	--	--	--	--	--	--	--	--	--	--	--	--	--	--	--	--	--	--	--	--	--	--	--	--	--	--	--	--	--	--	--	--	--	--	--	--	--	--	--	--	--	--	--	--	--	--	--	--	--	--	--	--	--	--	--	--	--	--	--	--	--	--	--	--	--	--	--	--	--	--	--	--	--	--	--	--	--	--	--	--	--	--	--	--	--	--	--	--	--	--	--	--	--	--	--	--	--	--	--	--	--	--	--	--	--	--	--	--	--	--	--	--	--	--	--	--	--	--	--	--	--	--	--	--	--	--	--	--	--	--	--	--	--	--	--	--	--	--	--	--	--	--	--	--	--	--	--	--	--	--	--	--	--	--	--	--	--	--	--	--	--	--	--	--	--	--	--	--	--	--	--	--	--	--	--	--	--	--	--	--	--	--	--	--	--	--	--	--	--	--	--	--	--	--	--	--	--	--	--	--	--	--	--	--	--	--	--	--	--	--	--	--	--	--	--	--	--	--	--	--	--

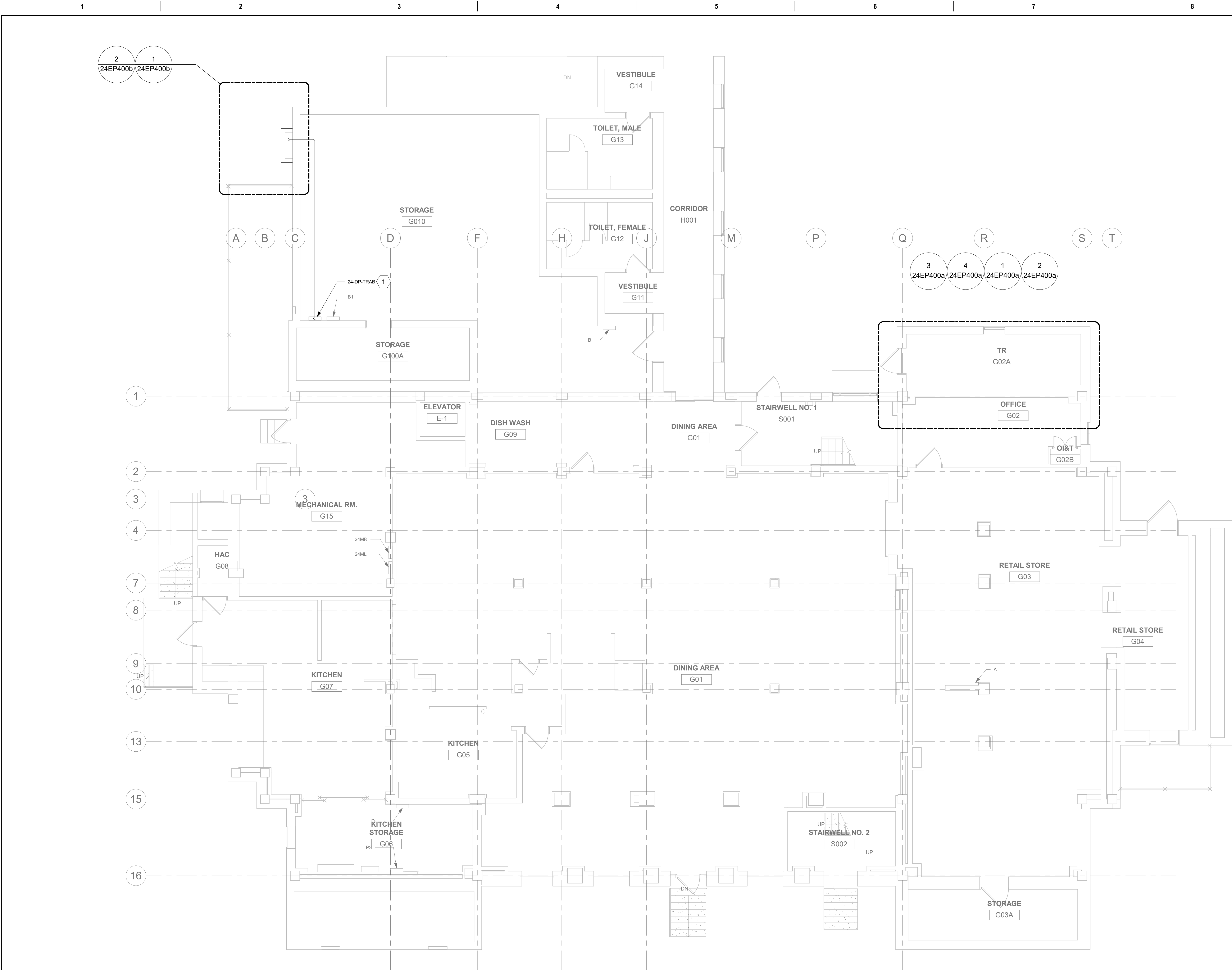

- ### GENERAL NOTES
- ALL EXISTING EQUIPMENT MAY NOT BE SHOWN FOR CLARITY. CONTRACTOR SHALL FIELD VERIFY ALL POWER AND LIGHTING CIRCUITRY AS REQUIRED. ALL RACEWAYS AND CONDUCTORS ASSOCIATED WITH EQUIPMENT TO BE DEMOLISHED SHALL BE DEMOLISHED BACK TO THEIR SOURCE, UNLESS OTHERWISE NOTED.
 - CONTRACTOR SHALL DEMOLISH ALL ELECTRICAL EQUIPMENT, CONDUCTORS, AND RACEWAYS ASSOCIATED WITH WALLS BEING REMOVED AND IN ALL LOCATIONS WHERE JUNCTION BOXES WILL NOT REMAIN ACCESSIBLE AFTER INSTALLATION OF MILLWORK, UNLESS OTHERWISE NOTED.
 - PROTECT ALL EXISTING WORK FROM DAMAGE DURING CONSTRUCTION. ANY DAMAGED MATERIALS, SYSTEMS, COMPONENTS, FINISHES BE LIKE, SHALL BE REPAIRED OR REPLACED AT THE EXPENSE OF THE CONTRACTOR TO THE ACCEPTANCE OF THE OWNER.
 - CONTRACTOR SHALL COORDINATE NORMAL/ESSENTIAL ELECTRICAL SYSTEM SHUTDOWNS AND PHASING WITH THE VA PRIOR TO PERFORMING REQUIRED EQUIPMENT UPGRADES. CONTRACTOR TO PROVIDE BACKUP EMERGENCY POWER AND DETERMINE TIE-IN/CONNECTION PLAN WITH EXISTING EQUIPMENT. POWER TO ALL EXISTING ESSENTIAL EQUIPMENT CANNOT BE INTERRUPTED AND SHALL REMAIN ACTIVE DURING CONSTRUCTION. BACKUP POWER AND TIE-IN SHALL CONFORM WITH VA STANDARDS.
 - SEAL ALL INTERIOR WALL AND CEILING PENETRATIONS TO MATCH EXISTING FIRE RATING OR NEW FIRE RATING, IF REQUIRED. COORDINATE WITH ARCHITECTURAL DRAWINGS AS REQUIRED.
 - REFERENCE CORRESPONDING ONE-LINE DIAGRAM FOR ADDITIONAL INFORMATION.
 - CONTRACTOR SHALL PROVIDE UPDATED CIRCUIT PANEL DIRECTORIES FOR ALL PANELS THAT CONTAIN CIRCUITS IMPACTED BY THIS PROJECT.
 - CONTRACTOR SHALL BE RESPONSIBLE FOR RELOCATING FURNITURE, INCLUDING TRANSPORTATION, FOR ALL WORK TO DESIRED VA STORAGE LOCATION. COORDINATE WITH VA AS REQUIRED.
 - REFERENCE ONE-LINE DIAGRAM ON SHEET 24EP601 FOR CONDUIT AND WIRE SIZING.

- ### KEY NOTES
- EQUIPMENT TO BE ADDED. REFERENCE ONE-LINE DIAGRAM ON SHEET 24EP601 FOR ADDITIONAL INFORMATION.

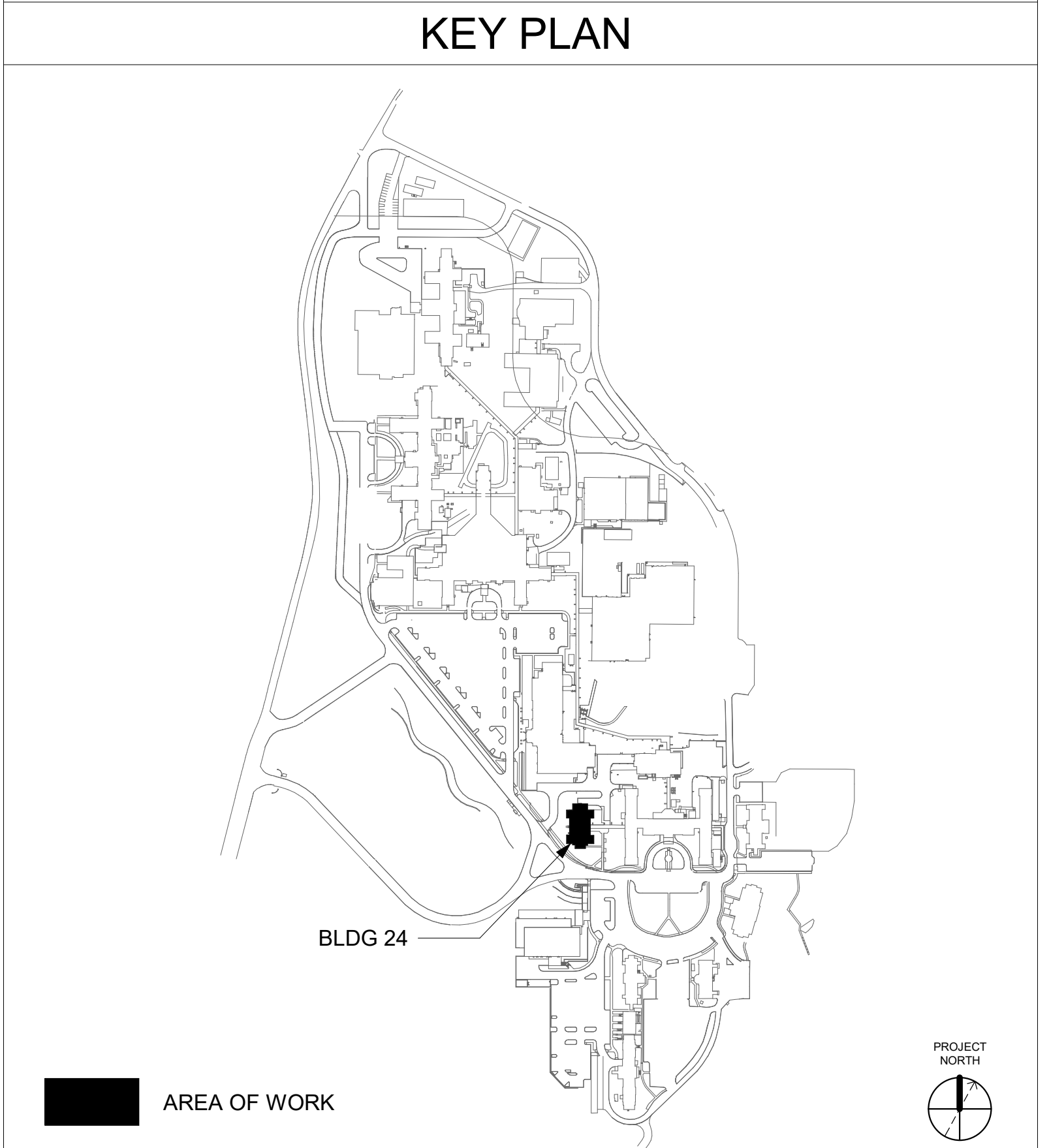

1 BLDG 24 - FLOOR 0 - ELECTRICAL PLAN
3/16" = 1'-0"
0 2' 4' 6'

Revisions:	Date:

CONSULTANT

ARCHITECT/ENGINEER OF RECORD

A/E:
SPEES DESIGN BUILD
625 1ST AVE, STE 301
SEATTLE, WA 98104
(206) 590-2118
RAY SPEES

SPEESDESIGNBUILD

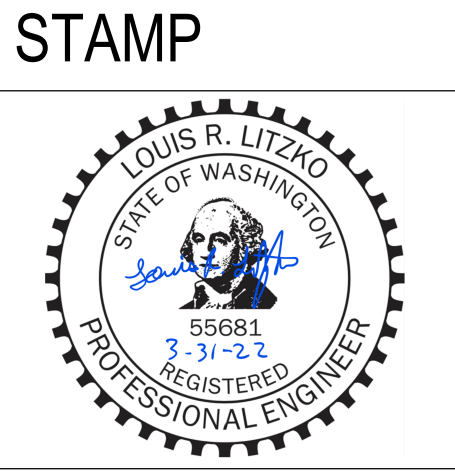

Office of
Construction
and Facilities
Management

VA U.S. Department
of Veterans Affairs

Drawing Title
BLDG 24 - FLOOR 0 - ELECTRICAL
PLAN

Approved:

Phase
CONSTRUCTION
DOCUMENTS

FULLY SPRINKLERED

Project Title
EHRM INFRASTRUCTURE
UPGRADES

Location
ST. LOUIS VA MEDICAL CENTER - JEFFERSON BARRACKS, MO

Issue Date
03/31/2022

Checked
LRL/WM

Drawn
LLT/JPS

Project Number
657-21-701JB

Building Number
24

Drawing Number
24EP100
149 OF 435

GENERAL NOTES

- ALL EXISTING EQUIPMENT MAY NOT BE SHOWN FOR CLARITY. CONTRACTOR SHALL FIELD VERIFY ALL POWER AND LIGHTING CIRCUITRY AS REQUIRED. ALL RACEWAYS AND CONDUCTORS ASSOCIATED WITH EQUIPMENT TO BE DEMOLISHED SHALL BE DEMOLISHED BACK TO THEIR SOURCE, UNLESS OTHERWISE NOTED.
- CONTRACTOR SHALL DEMOLISH ALL ELECTRICAL EQUIPMENT, CONDUCTORS, AND RACEWAYS ASSOCIATED WITH WALLS BEING REMOVED AND IN ALL LOCATIONS WHERE JUNCTION BOXES WILL NOT REMAIN ACCESSIBLE AFTER INSTALLATION OF MILLWORK, UNLESS OTHERWISE NOTED.
- PROTECT ALL EXISTING WORK FROM DAMAGE DURING CONSTRUCTION. ANY DAMAGED MATERIALS, SYSTEMS, COMPONENTS, FINISHES BE LIKE, SHALL BE REPAIRED OR REPLACED AT THE EXPENSE OF THE CONTRACTOR TO THE ACCEPTANCE OF THE OWNER.
- CONTRACTOR SHALL COORDINATE NORMAL/ESSENTIAL ELECTRICAL SYSTEM SHUTDOWNS AND PHASING WITH THE VA PRIOR TO PERFORMING REQUIRED EQUIPMENT UPGRADES. CONTRACTOR TO PROVIDE BACKUP EMERGENCY POWER AND DETERMINE TIE-IN/CONNECTION PLAN WITH EXISTING EQUIPMENT. POWER TO ALL EXISTING ESSENTIAL EQUIPMENT CANNOT BE INTERRUPTED AND SHALL REMAIN ACTIVE DURING CONSTRUCTION. BACKUP POWER AND TIE-IN SHALL CONFORM WITH VA STANDARDS.
- SEAL ALL INTERIOR WALL AND CEILING PENETRATIONS TO MATCH EXISTING FIRE RATING OR NEW FIRE RATING, IF REQUIRED. COORDINATE WITH ARCHITECTURAL DRAWINGS AS REQUIRED.
- REFERENCE CORRESPONDING ONE-LINE DIAGRAM FOR ADDITIONAL INFORMATION.
- CONTRACTOR SHALL PROVIDE UPDATED CIRCUIT PANEL DIRECTORIES FOR ALL PANELS THAT CONTAIN CIRCUITS IMPACTED BY THIS PROJECT.
- CONTRACTOR SHALL BE RESPONSIBLE FOR RELOCATING FURNITURE, INCLUDING TRANSPORTATION, FOR ALL WORK TO DESIRED VA STORAGE LOCATION. COORDINATE WITH VA AS REQUIRED.

KEY NOTES

- 1 PROVIDE CONDUIT AND WIRE FROM CONDENSING UNIT TO ASSOCIATED AC UNIT AS REQUIRED PER MANUFACTURER'S INSTRUCTIONS. COORDINATE WITH MECHANICAL CONTRACTOR AS REQUIRED.

KEY PLAN

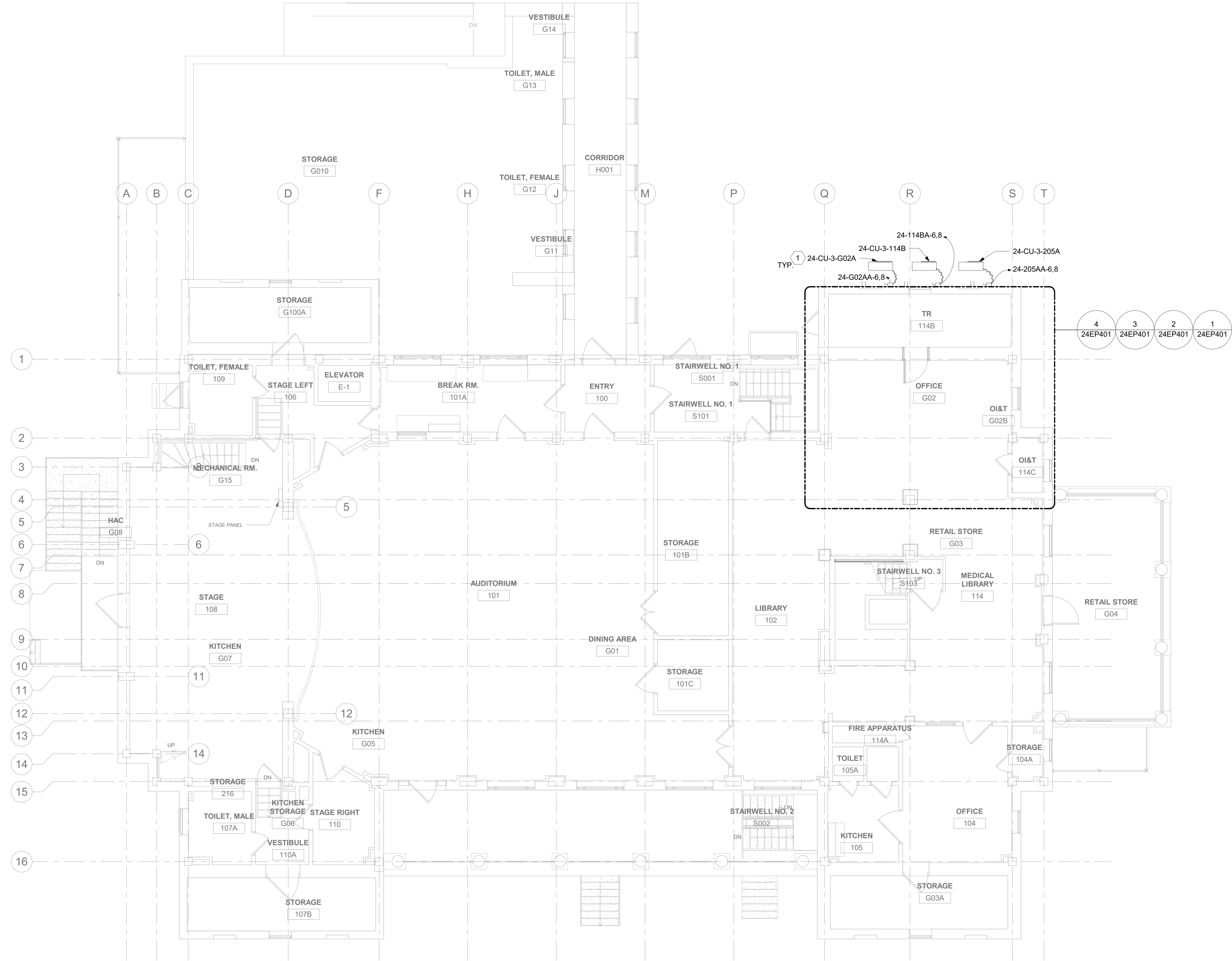
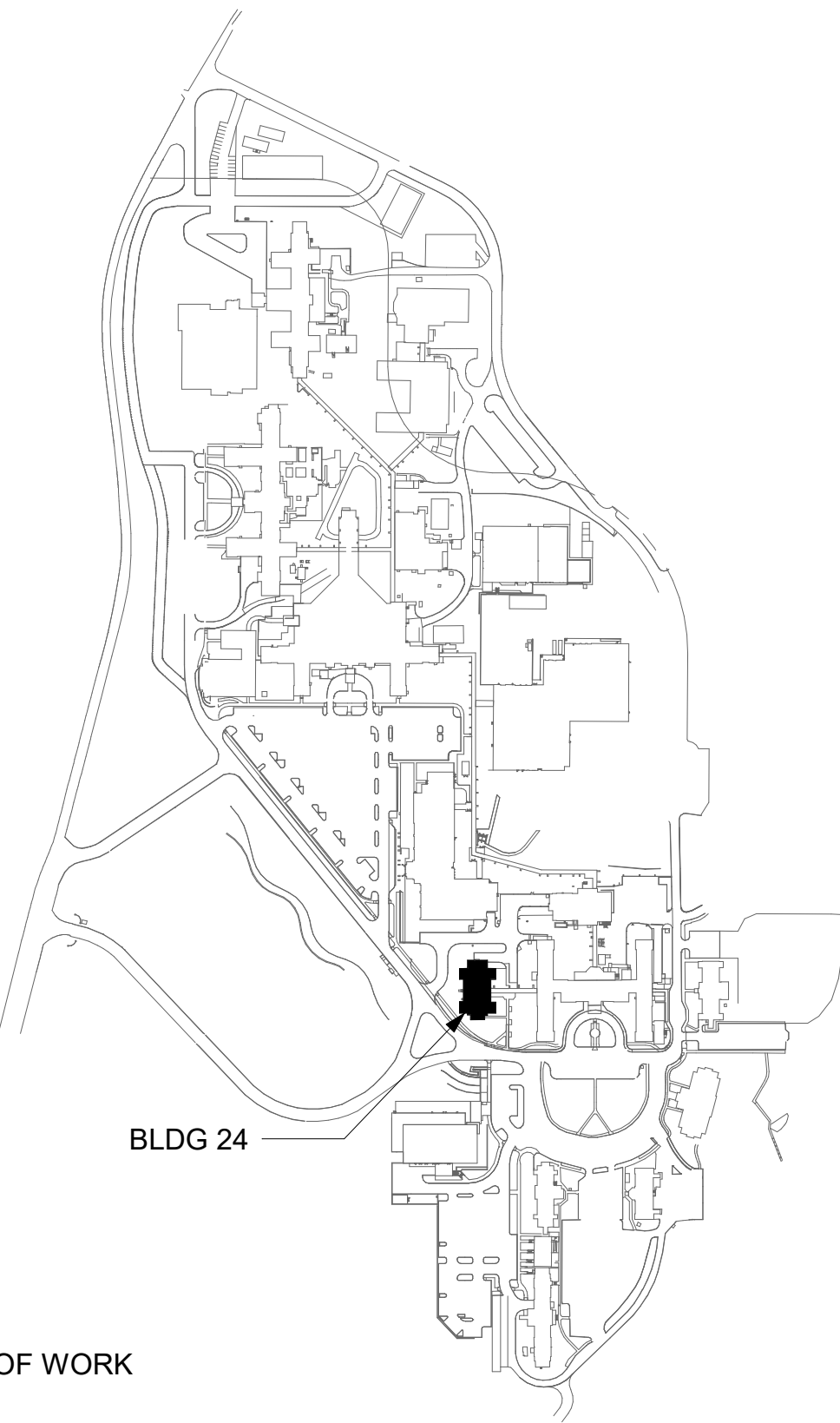

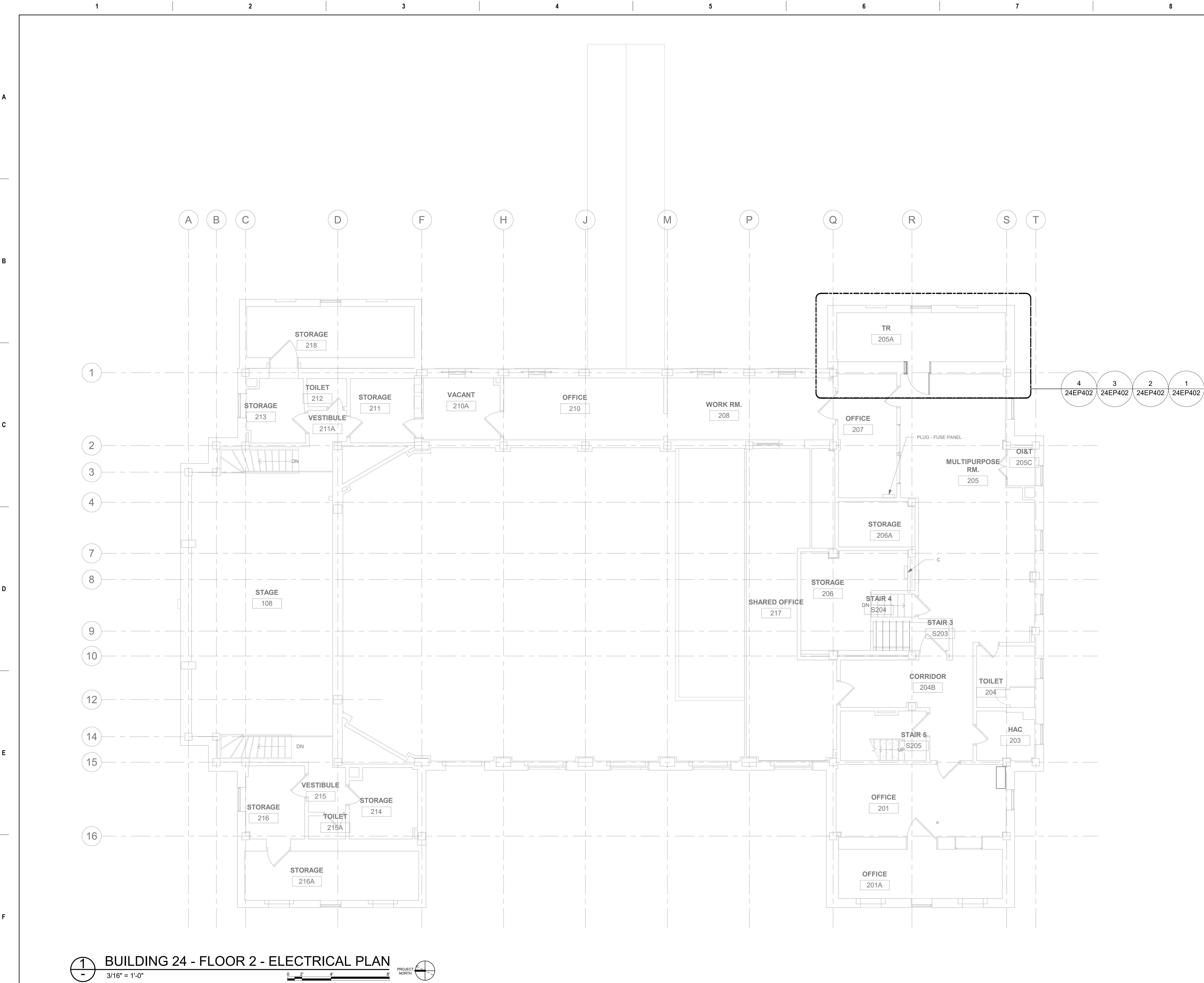

- ### GENERAL NOTES
- ALL EXISTING EQUIPMENT MAY NOT BE SHOWN FOR CLARITY. CONTRACTOR SHALL FIELD VERIFY ALL POWER AND LIGHTING CIRCUITRY AS REQUIRED. ALL RACEWAYS AND CONDUCTORS ASSOCIATED WITH EQUIPMENT TO BE DEMOLISHED SHALL BE DEMOLISHED BACK TO THEIR SOURCE, UNLESS OTHERWISE NOTED.
 - CONTRACTOR SHALL DEMOLISH ALL ELECTRICAL EQUIPMENT, CONDUCTORS, AND RACEWAYS ASSOCIATED WITH WALLS BEING REMOVED AND IN ALL LOCATIONS WHERE JUNCTION BOXES WILL NOT REMAIN ACCESSIBLE AFTER INSTALLATION OF MILLWORK, UNLESS OTHERWISE NOTED.
 - PROTECT ALL EXISTING WORK FROM DAMAGE DURING CONSTRUCTION. ANY DAMAGED MATERIALS, SYSTEMS, COMPONENTS, FINISHES BE LIKE, SHALL BE REPAIRED OR REPLACED AT THE EXPENSE OF THE CONTRACTOR TO THE ACCEPTANCE OF THE OWNER.
 - CONTRACTOR SHALL COORDINATE NORMAL/ESSENTIAL ELECTRICAL SYSTEM SHUTDOWNS AND PHASING WITH THE VA PRIOR TO PERFORMING REQUIRED EQUIPMENT UPGRADES. CONTRACTOR TO PROVIDE BACKUP EMERGENCY POWER AND DETERMINE TIE-IN/CONNECTION PLAN WITH EXISTING EQUIPMENT. POWER TO ALL EXISTING ESSENTIAL EQUIPMENT CANNOT BE INTERRUPTED AND SHALL REMAIN ACTIVE DURING CONSTRUCTION. BACKUP POWER AND TIE-IN SHALL CONFORM WITH VA STANDARDS.
 - SEAL ALL INTERIOR WALL AND CEILING PENETRATIONS TO MATCH EXISTING FIRE RATING OR NEW FIRE RATING, IF REQUIRED. COORDINATE WITH ARCHITECTURAL DRAWINGS AS REQUIRED.
 - REFERENCE CORRESPONDING ONE-LINE DIAGRAM FOR ADDITIONAL INFORMATION.
 - CONTRACTOR SHALL PROVIDE UPDATED CIRCUIT PANEL DIRECTORIES FOR ALL PANELS THAT CONTAIN CIRCUITS IMPACTED BY THIS PROJECT.
 - CONTRACTOR SHALL BE RESPONSIBLE FOR RELOCATING FURNITURE, INCLUDING TRANSPORTATION, FOR ALL WORK TO DESIRED VA STORAGE LOCATION. COORDINATE WITH VA AS REQUIRED.

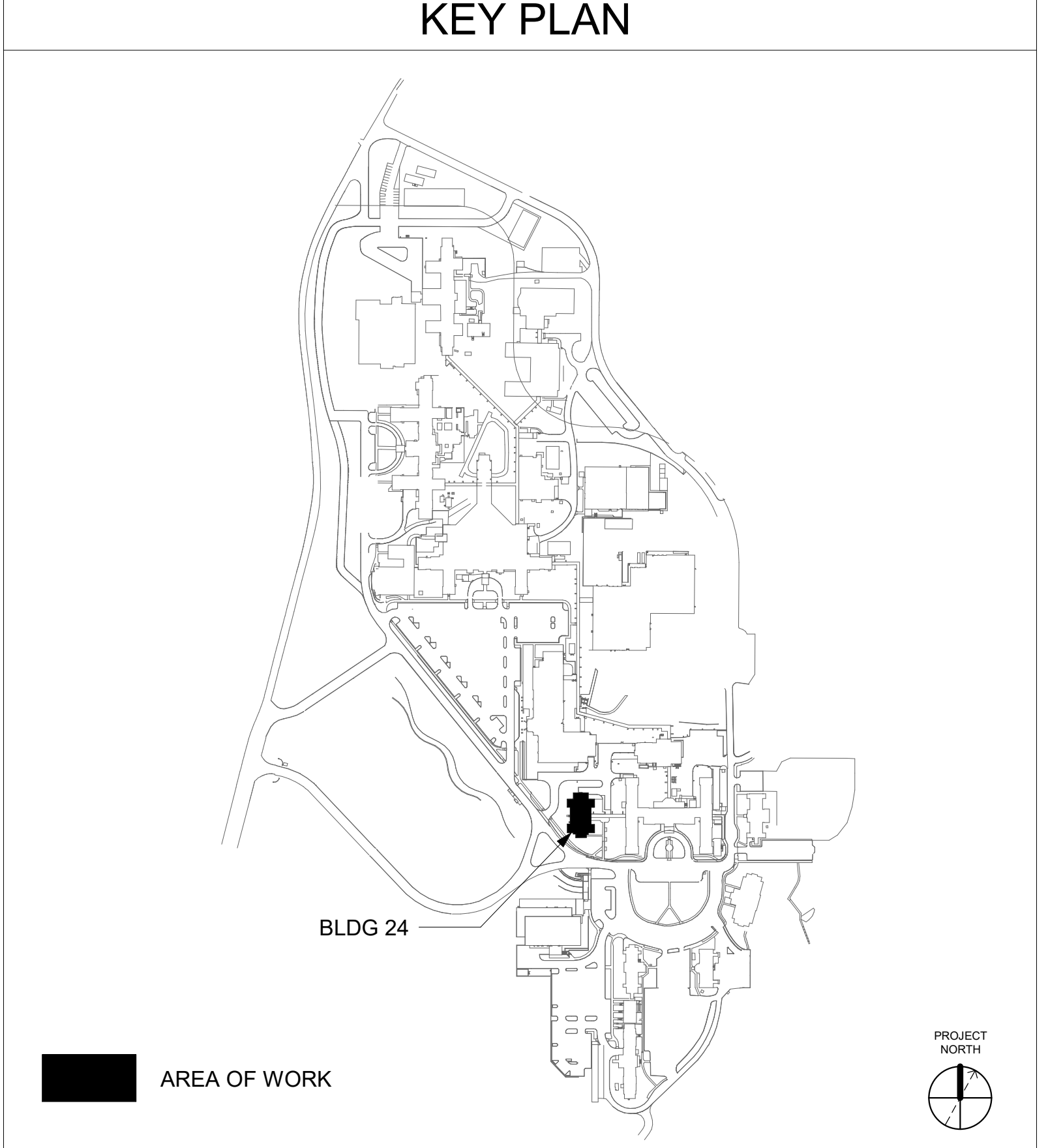
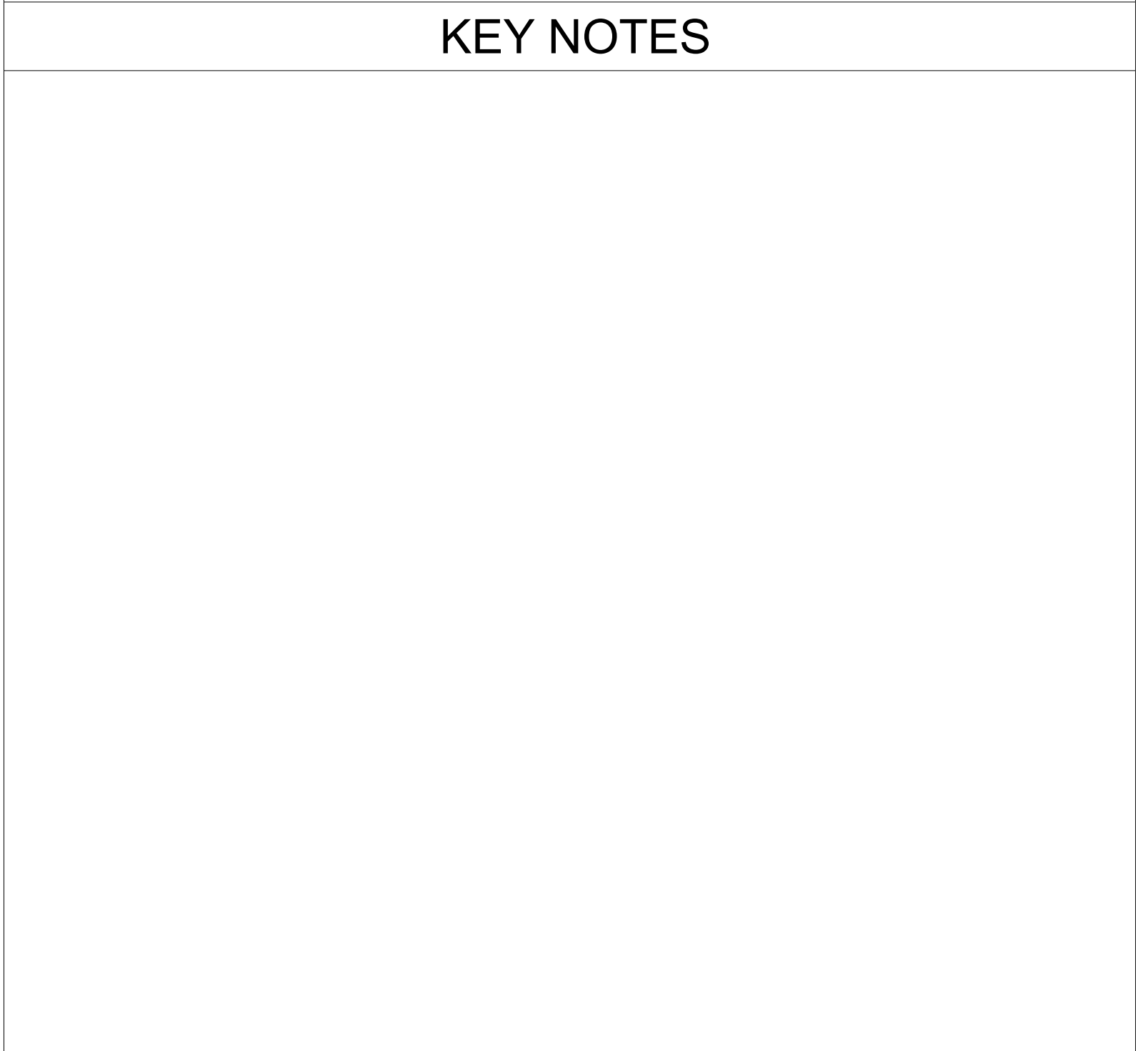

		CONSULTANT	ARCHITECT/ENGINEER OF RECORD	STAMP	Office of Construction and Facilities Management	Drawing Title	BLDG 24 - FLOOR 2 - ELECTRICAL PLAN	Phase	CONSTRUCTION DOCUMENTS	Project Title	EHRM INFRASTRUCTURE UPGRADES	Project Number	657-21-701JB
			A/E: SPEES DESIGN BUILD 625 1ST AVE, STE 301 SEATTLE, WA 98104 (206) 590-2118 RAY SPEES		VA U.S. Department of Veterans Affairs	Approved:	FULLY SPRINKLERED	Location	ST. LOUIS VA MEDICAL CENTER - JEFFERSON BARRACKS, MO	Drawing Number	24EP102		
Revisions:	Date:									Issue Date	Checked	Drawn	151 OF 435
										03/31/2022	LRL/WM	LLT/JPS	

A
B
C
D
E
F

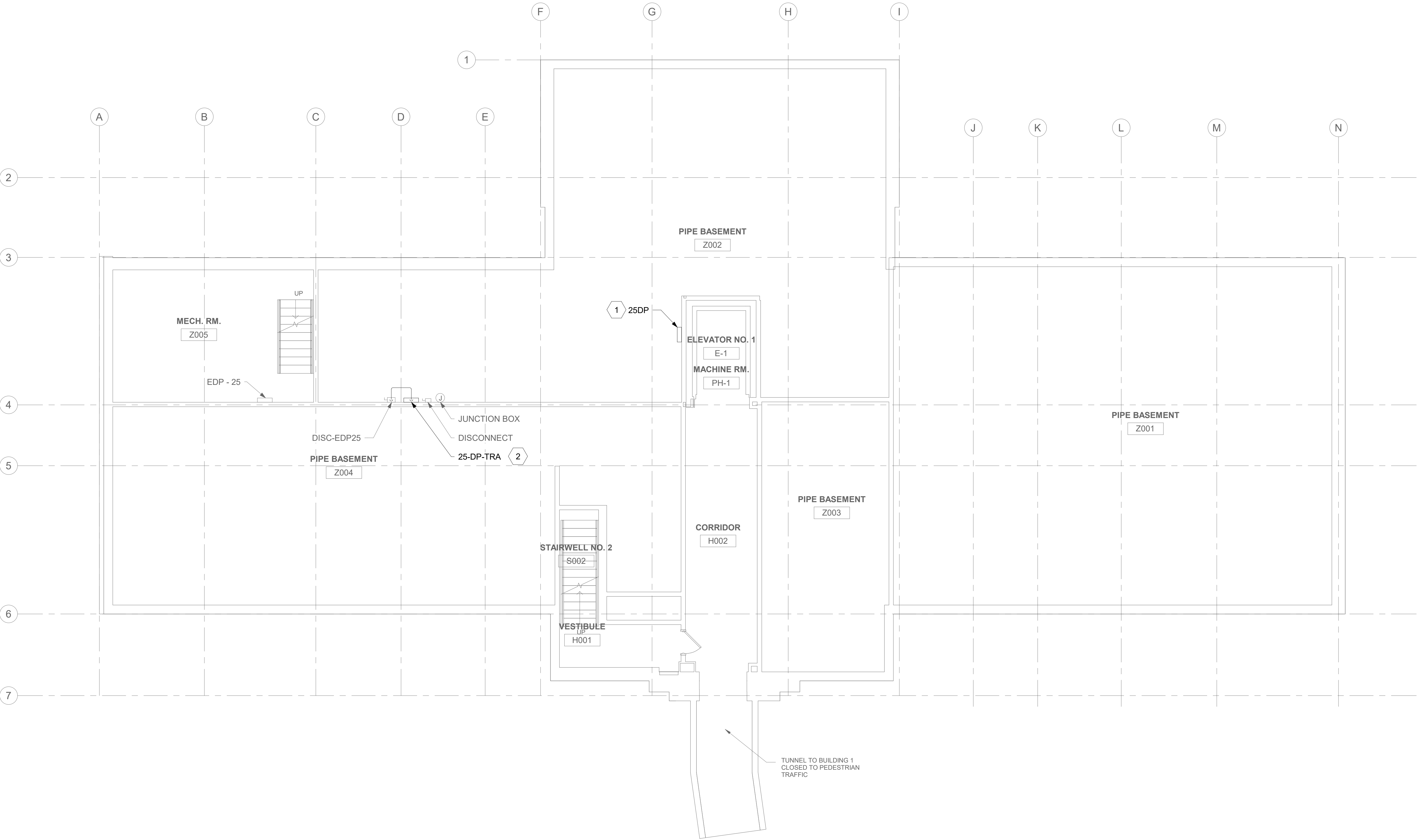

1 BLDG 25 - FLOOR 0 - ELECTRICAL PLAN
3/16" = 1'-0"

GENERAL NOTES

- ALL EXISTING EQUIPMENT MAY NOT BE SHOWN FOR CLARITY. CONTRACTOR SHALL FIELD VERIFY ALL POWER, LIGHTING AND ASSOCIATED CIRCUITRY AS REQUIRED. ALL RACEWAYS AND CONDUCTORS ASSOCIATED WITH EQUIPMENT TO BE DEMOLISHED SHALL BE DEMOLISHED BACK TO THEIR SOURCE, UNLESS OTHERWISE NOTED.
- CONTRACTOR SHALL DEMOLISH ALL ELECTRICAL EQUIPMENT, CONDUCTORS, AND RACEWAYS ASSOCIATED WITH WALLS BEING REMOVED AND IN ALL LOCATIONS WHERE JUNCTION BOXES WILL NOT REMAIN ACCESSIBLE AFTER INSTALLATION OF MILLWORK, UNLESS OTHERWISE NOTED.
- PROTECT ALL EXISTING WORK FROM DAMAGE DURING CONSTRUCTION. ANY DAMAGED MATERIALS, SYSTEMS, COMPONENTS, FINISHES BE LIKE, SHALL BE REPAIRED OR REPLACED AT THE EXPENSE OF THE CONTRACTOR TO THE ACCEPTANCE OF THE OWNER.
- CONTRACTOR TO COORDINATE NORMAL/ESSENTIAL ELECTRICAL SYSTEM SHUTDOWNS AND PHASING WITH THE VA PRIOR TO PERFORMING REQUIRED EQUIPMENT UPGRADES. CONTRACTOR TO PROVIDE BACKUP EMERGENCY POWER AND DETERMINE TIE-IN/CONNECTION PLAN WITH EXISTING EQUIPMENT. POWER TO ALL EXISTING ESSENTIAL EQUIPMENT CANNOT BE INTERRUPTED AND SHALL REMAIN ACTIVE DURING CONSTRUCTION. BACKUP POWER AND TIE-IN SHALL CONFORM WITH VA STANDARDS.
- SEAL ALL INTERIOR WALL AND CEILING PENETRATIONS TO MATCH EXISTING FIRE RATING OR NEW FIRE RATING, IF REQUIRED. COORDINATE WITH ARCHITECTURAL DRAWINGS AS REQUIRED.
- REFERENCE CORRESPONDING ONE-LINE DIAGRAM FOR ADDITIONAL INFORMATION.
- THE CONTRACTOR SHALL PROVIDE UPDATED CIRCUIT PANEL DIRECTORIES FOR ALL PANELS THAT CONTAIN CIRCUITS IMPACTED BY THIS PROJECT.
- CONTRACTOR SHALL BE RESPONSIBLE FOR RELOCATING FURNITURE, INCLUDING TRANSPORTATION, FOR ALL WORK TO DESIRED VA STORAGE LOCATION. COORDINATE WITH VA AS REQUIRED.
- REFERENCE ONE-LINE DIAGRAM ON SHEET 25EP601 FOR CONDUIT AND WIRE SIZING.

KEY NOTES

- 1** EXISTING PANEL TO BE MODIFIED. REFERENCE ONE-LINE DIAGRAM ON SHEET 25EP601 FOR ADDITIONAL INFORMATION.
- 2** EQUIPMENT TO BE ADDED. REFERENCE ONE-LINE DIAGRAM ON SHEET 25EP601 FOR ADDITIONAL INFORMATION.

KEY PLAN

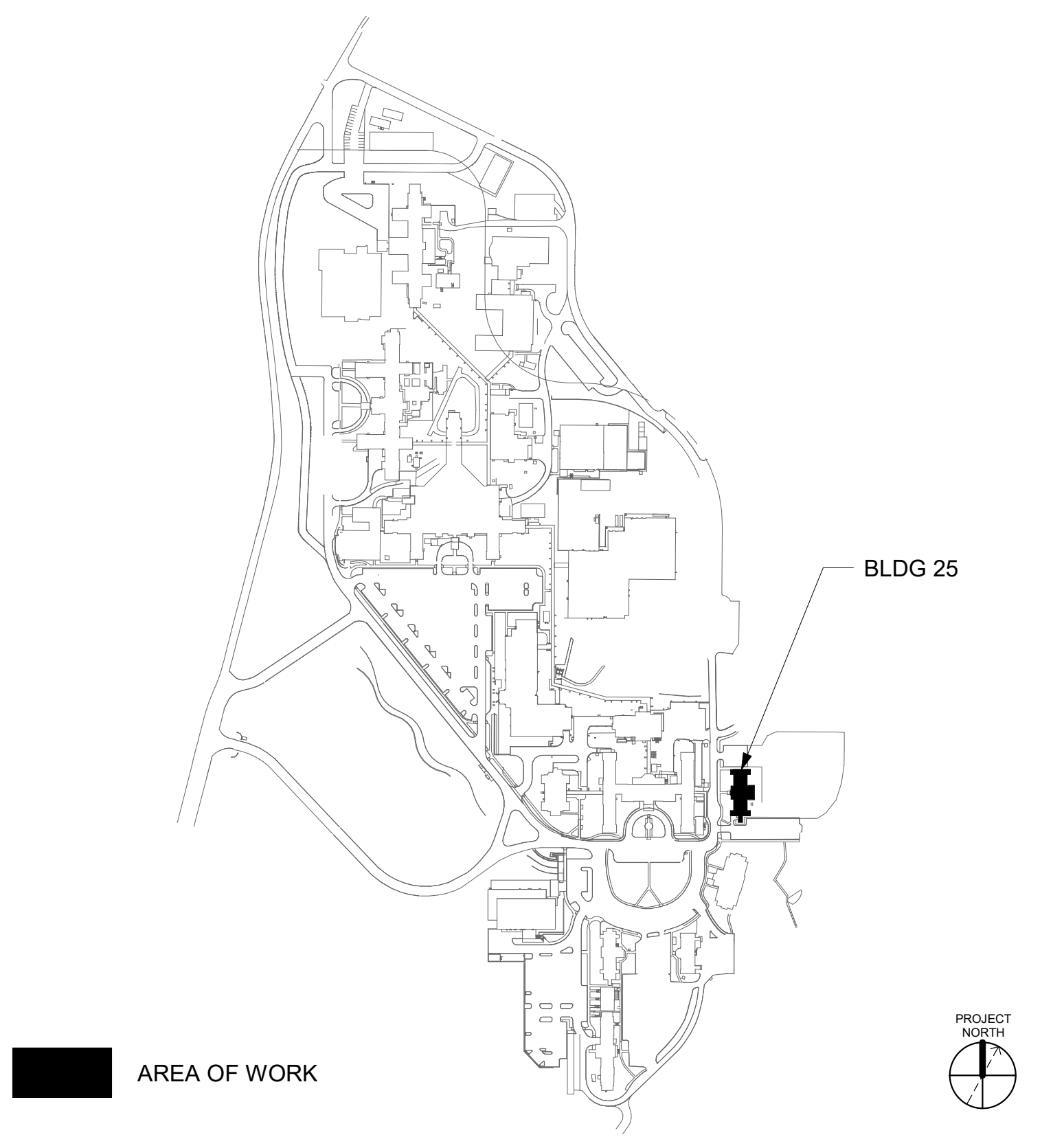

--	--	--	--	--	--	--	--	--	--	--	--	--	--	--	--	--	--	--	--	--	--	--	--	--	--	--	--	--	--	--	--	--	--	--	--	--	--	--	--	--	--	--	--	--	--	--	--	--	--	--	--	--	--	--	--	--	--	--	--	--	--	--	--	--	--	--	--	--	--	--	--	--	--	--	--	--	--	--	--	--	--	--	--	--	--	--	--	--	--	--	--	--	--	--	--	--	--	--	--	--	--	--	--	--	--	--	--	--	--	--	--	--	--	--	--	--	--	--	--	--	--	--	--	--	--	--	--	--	--	--	--	--	--	--	--	--	--	--	--	--	--	--	--	--	--	--	--	--	--	--	--	--	--	--	--	--	--	--	--	--	--	--	--	--	--	--	--	--	--	--	--	--	--	--	--	--	--	--	--	--	--	--	--	--	--	--	--	--	--	--	--	--	--	--	--	--	--	--	--	--	--	--	--	--	--	--	--	--	--	--	--	--	--	--	--	--	--	--	--	--	--	--	--	--	--	--	--	--	--	--	--	--	--	--	--	--	--	--	--	--	--	--	--	--	--	--	--	--	--	--	--	--	--	--	--	--	--	--	--	--	--	--	--	--	--	--	--	--	--	--	--	--	--	--	--	--	--	--	--	--	--	--	--	--	--	--	--	--	--	--	--	--	--	--	--	--	--	--	--	--	--	--	--	--	--	--	--	--	--	--	--	--	--	--	--	--	--	--	--	--	--	--	--	--	--	--	--	--	--	--	--	--	--	--	--	--	--	--	--	--	--	--	--	--	--	--	--	--	--	--	--	--	--	--	--	--	--	--	--	--	--	--	--	--	--	--	--	--	--	--	--	--	--	--	--	--	--	--	--	--	--	--	--	--	--	--	--	--	--	--	--	--	--	--	--	--	--	--	--	--	--	--	--	--	--	--	--	--	--	--	--	--	--	--	--	--	--	--	--	--	--	--	--	--	--	--	--	--	--	--	--	--	--	--	--	--	--	--	--	--	--	--	--	--	--	--	--	--	--	--	--	--	--	--	--	--	--	--	--	--	--	--	--	--	--	--	--	--	--	--	--	--	--	--	--	--	--	--	--	--	--	--	--	--	--	--	--	--	--	--	--	--	--	--	--	--	--	--	--	--	--	--	--	--	--	--	--	--	--	--	--	--	--	--	--	--	--	--	--	--	--	--	--	--	--	--	--	--	--	--	--	--	--	--	--	--	--	--	--	--	--	--	--	--	--	--	--	--	--	--	--	--	--	--	--	--	--	--	--	--	--	--	--	--	--	--	--	--	--	--	--	--	--	--	--	--	--	--	--	--	--	--	--	--	--	--	--	--	--	--	--	--	--	--	--	--	--	--	--	--	--	--	--	--	--	--	--	--	--	--	--	--	--	--	--	--	--	--	--	--	--	--	--	--	--	--	--	--	--	--	--	--	--	--	--	--	--	--	--	--	--	--	--	--	--	--	--	--	--	--	--	--	--	--	--	--	--	--	--	--	--	--	--	--	--	--	--	--	--	--	--	--	--	--	--	--	--	--	--	--	--	--	--	--	--	--	--	--	--	--	--	--	--	--	--	--	--	--	--	--	--	--	--	--	--	--	--	--	--	--	--	--	--	--	--	--	--	--	--	--	--	--	--	--	--	--	--	--	--	--	--	--	--	--	--	--	--	--	--	--	--	--	--	--	--	--	--	--	--	--	--	--	--	--	--	--	--	--	--	--	--	--	--	--	--	--	--	--	--	--	--	--	--	--	--	--	--	--	--	--	--	--	--	--	--	--	--	--	--	--	--	--	--	--	--	--	--	--	--	--	--	--	--	--	--	--	--	--	--	--	--	--	--	--	--	--	--	--	--	--	--	--	--	--	--	--	--	--	--	--	--	--	--	--	--	--	--	--	--	--	--	--	--	--	--	--	--	--	--	--	--	--	--	--	--	--	--	--	--	--	--	--	--	--	--	--	--	--	--	--	--	--	--	--	--	--	--	--	--	--	--	--	--	--	--	--	--	--	--	--	--	--	--	--	--	--	--	--	--	--	--	--	--	--	--	--	--	--	--	--	--	--	--	--	--	--	--	--	--	--	--	--	--	--	--	--	--	--	--	--	--	--	--	--	--	--	--	--	--	--	--	--	--	--	--	--	--	--	--	--	--	--	--	--	--	--	--	--	--	--	--	--	--	--	--	--	--	--	--	--	--	--	--	--	--	--	--	--	--	--	--	--	--	--	--	--	--	--	--	--	--	--	--	--	--	--	--	--	--	--	--	--	--	--	--	--	--	--	--	--	--	--	--	--	--	--	--	--	--	--	--	--	--	--	--	--	--	--	--	--	--	--	--	--	--	--	--	--	--	--	--	--	--	--	--	--	--	--	--	--	--	--	--	--	--	--	--	--	--	--	--	--	--	--	--	--	--	--	--	--	--	--	--	--	--	--	--	--	--	--	--	--	--	--	--	--	--	--	--	--	--	--	--	--	--	--	--	--	--	--	--	--	--	--	--	--	--	--	--	--	--	--	--	--	--	--	--	--	--	--	--	--	--	--	--	--	--	--	--	--	--	--	--	--	--	--	--	--	--	--	--	--	--	--	--	--	--	--	--	--	--	--	--	--	--	--	--	--	--	--	--	--	--	--	--	--	--	--	--

GENERAL NOTES

- ALL EXISTING EQUIPMENT MAY NOT BE SHOWN FOR CLARITY. CONTRACTOR SHALL FIELD VERIFY ALL POWER, LIGHTING AND ASSOCIATED CIRCUITRY AS REQUIRED. ALL RACEWAYS AND CONDUCTORS ASSOCIATED WITH EQUIPMENT TO BE DEMOLISHED SHALL BE DEMOLISHED BACK TO THEIR SOURCE, UNLESS OTHERWISE NOTED.
- CONTRACTOR SHALL DEMOLISH ALL ELECTRICAL EQUIPMENT, CONDUCTORS, AND RACEWAYS ASSOCIATED WITH WALLS BEING REMOVED AND IN ALL LOCATIONS WHERE JUNCTION BOXES WILL NOT REMAIN ACCESSIBLE AFTER INSTALLATION OF MILLWORK, UNLESS OTHERWISE NOTED.
- PROTECT ALL EXISTING WORK FROM DAMAGE DURING CONSTRUCTION. ANY DAMAGED MATERIALS, SYSTEMS, COMPONENTS, FINISHES BE LIKE, SHALL BE REPAIRED OR REPLACED AT THE EXPENSE OF THE CONTRACTOR TO THE ACCEPTANCE OF THE OWNER.
- CONTRACTOR TO COORDINATE NORMAL/ESSENTIAL ELECTRICAL SYSTEM SHUTDOWNS AND PHASING WITH THE VA PRIOR TO PERFORMING REQUIRED EQUIPMENT UPGRADES. CONTRACTOR TO PROVIDE BACKUP EMERGENCY POWER AND DETERMINE TIE-IN/CONNECTION PLAN WITH EXISTING EQUIPMENT. POWER TO ALL EXISTING ESSENTIAL EQUIPMENT CANNOT BE INTERRUPTED AND SHALL REMAIN ACTIVE DURING CONSTRUCTION. BACKUP POWER AND TIE-IN SHALL CONFORM WITH VA STANDARDS.
- SEAL ALL INTERIOR WALL AND CEILING PENETRATIONS TO MATCH EXISTING FIRE RATINGS OR NEW FIRE RATING, IF REQUIRED. COORDINATE WITH ARCHITECTURAL DRAWINGS AS REQUIRED.
- REFERENCE CORRESPONDING ONE-LINE DIAGRAM FOR ADDITIONAL INFORMATION.
- THE CONTRACTOR SHALL PROVIDE UPDATED CIRCUIT PANEL DIRECTORIES FOR ALL PANELS THAT CONTAIN CIRCUITS IMPACTED BY THIS PROJECT.
- CONTRACTOR SHALL BE RESPONSIBLE FOR RELOCATING FURNITURE, INCLUDING TRANSPORTATION, FOR ALL WORK TO DESIRED VA STORAGE LOCATION. COORDINATE WITH VA AS REQUIRED.

KEY NOTES

KEY PLAN

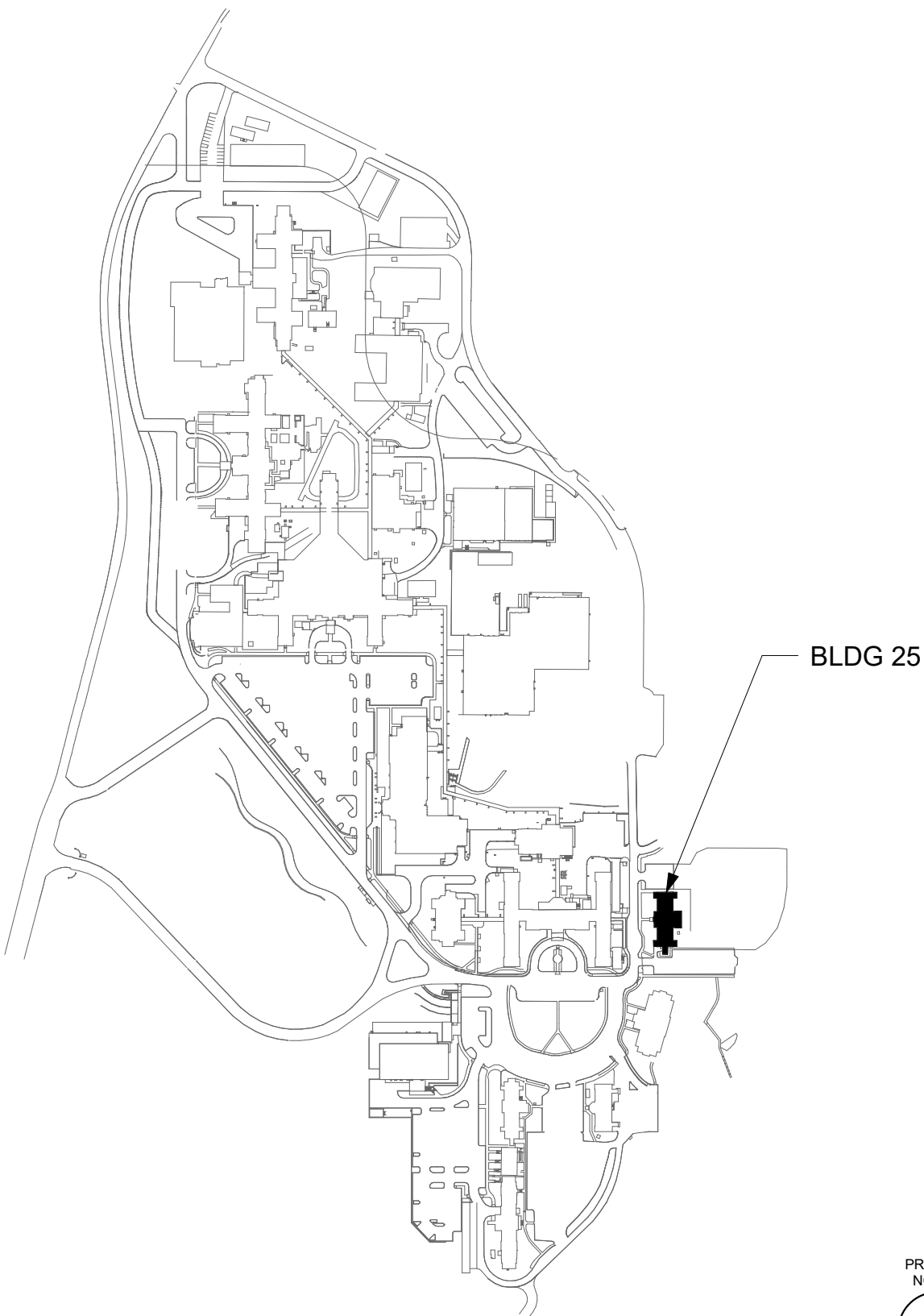

1 BLDG 25 - FLOOR 2 - ELECTRICAL PLAN
3/16" = 1'-0"



Revisions:	Date:

CONSULTANT

ARCHITECT/ENGINEER OF RECORD
A/E: SPEES DESIGN BUILD 625 1ST AVE, STE 301 SEATTLE, WA 98104 (206) 590-2118 RAY SPEES

STAMP

Office of Construction and Facilities Management
U.S. Department of Veterans Affairs

Drawing Title BLDG 25 - FLOOR 2 - ELECTRICAL PLAN
Approved:

Phase CONSTRUCTION DOCUMENTS
NON SPRINKLERED

Project Title EHRM INFRASTRUCTURE UPGRADES
Location ST. LOUIS VA MEDICAL CENTER - JEFFERSON BARRACKS, MO
Issue Date 03/31/2022
Checked LRL/WM
Drawn LLT/JPS

Project Number 657-21-701JB
Building Number 25
Drawing Number 25EP102
154 OF 435