

ONE INCH = TWO-HUNDRED FIFTY FEET

ONE INCH = TWO-HUNDRED FEET

ONE INCH = ONE-HUNDRED FEET

ONE INCH = THIRTY FEET

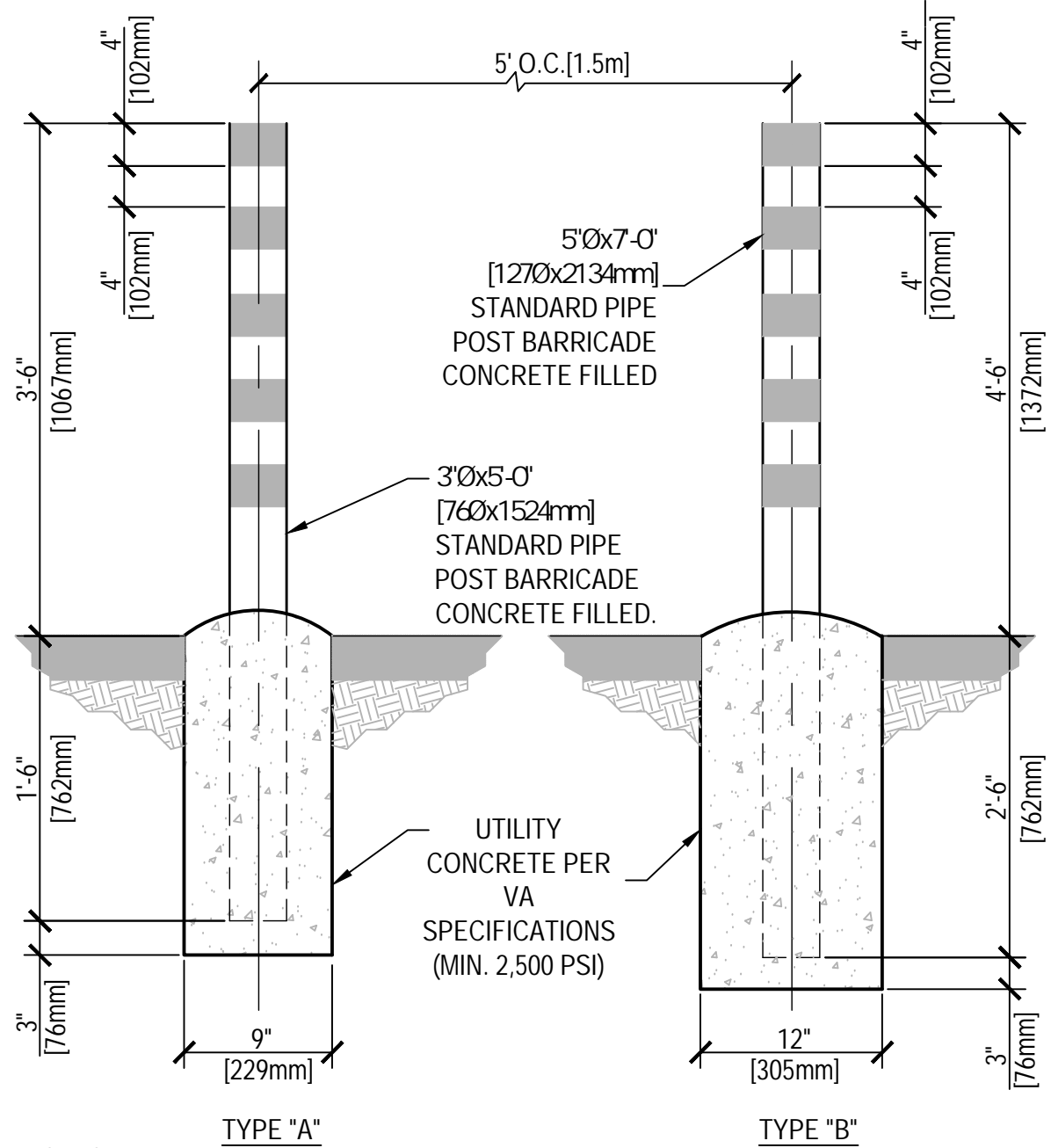

- NOTES:
- POST BARRICADES SHALL BE PAINTED WITH ONE PRIME COAT OF RED OXIDE (PAINT NO.1), ONE FINISH COAT OF DULL BLACK ENAMEL PER VA SPECIFICATIONS AND STRIPES CONSISTING OF 4" [102mm] BANDS OF YELLOW REFLECTORIZED TAPE SHALL BE USED UNLESS OTHERWISE SPECIFIED BY THE COR.
 - FINISH COLOR COMBINATIONS, OTHER THAN THAT SPECIFIED ABOVE, SHALL BE SUBMITTED TO THE COR FOR APPROVAL.

1 CONCRETE POST BARRICADES
NTS

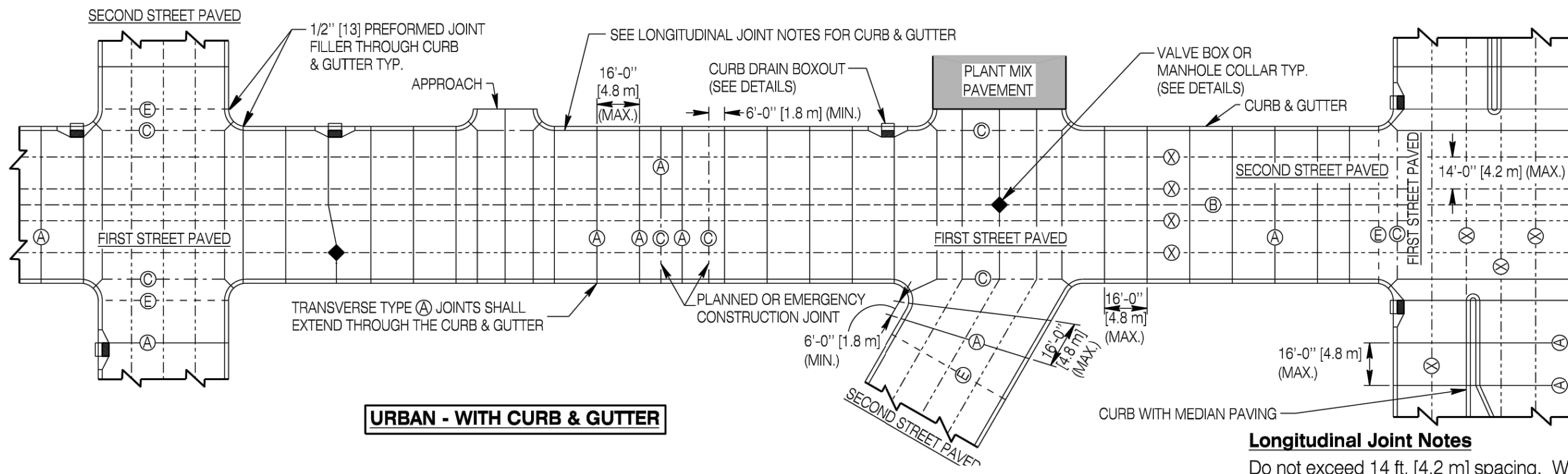

URBAN - WITH CURB & GUTTER

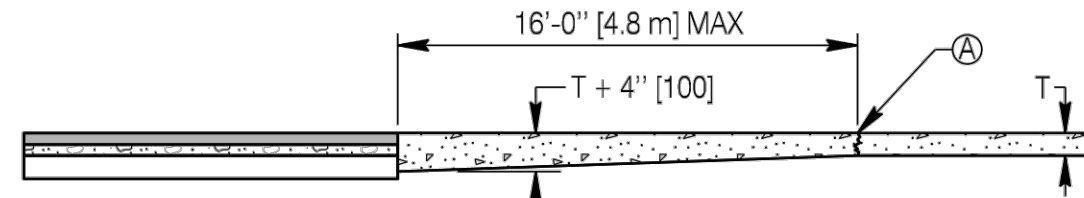

CONCRETE PAVEMENT TO PLANT MIX
PAVEMENT TRANSITION
LONGITUDINAL SECTION VIEW

NOTE:
DETAIL INTENDED TO PROVIDE ILLUSTRATION OF LOCATION OF VARIOUS JOINT
TYPES. JOINTS SHALL BE CONSTRUCTED PER WYDOT SPECIFICATIONS

2 CONCRETE PAVEMENT DETAIL
NTS
SOURCE: WYDOT STANDARD PLAN 414-1B (SEE LATEST VERSION)

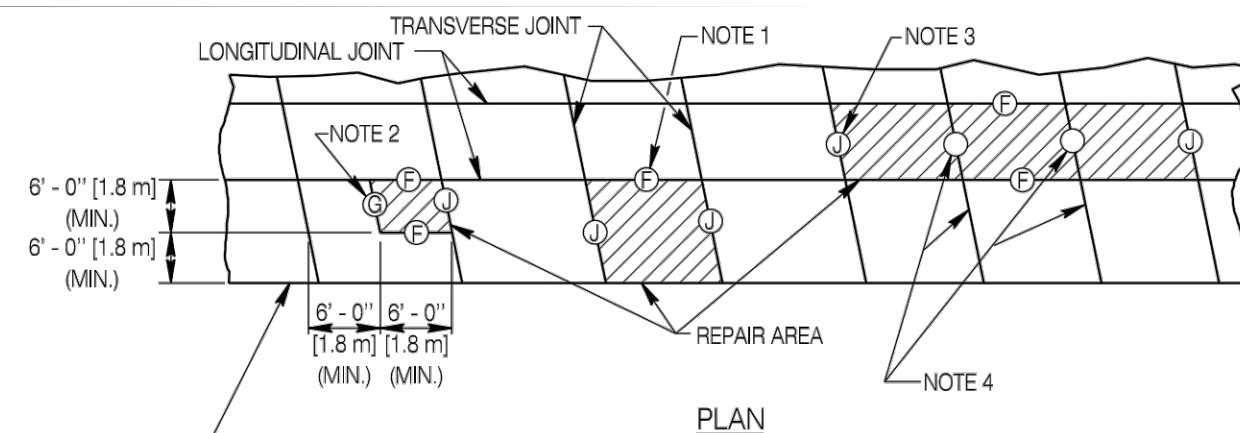

CONCRETE SLAB REPLACEMENT DETAILS
FOR NON-REINFORCED TRANSVERSE JOINTED
CONCRETE PAVEMENT

3 CONCRETE PAVEMENT REPAIR & REPLACEMENT DETAIL
NTS
SOURCE: WYDOT STANDARD PLAN 415-1D (SEE LATEST VERSION)

- NOTES
- Use type "F" joints for longitudinal joint. Bars that are not loose or damaged may be left in place.
 - Use type "G" joints when a transverse joint is located within the interior of an existing slab to remain in place.
 - Use type "J" joints when joining new concrete to existing concrete at an existing transverse joint.
 - Match intermediate transverse joints to the final configuration of the adjacent transverse joints. For example, if the adjacent transverse joints are being upgraded to dowel bar retrofits, install type D joints.
 - When repair limits are less than 6 ft. [1.8 m] from an existing joint, extend the repair limits to the joint.
 - Begin placing rebar and/or smooth steel dowel bars 6 in. [150] from edge of pavement and perpendicular to the joint or as specified.

JOINT LEGEND	
TRANSVERSE JOINTS	
⊖	TYPE A
⊕	TYPE G
⊙	TYPE D
⊗	TYPE J
LONGITUDINAL JOINTS	
⊖	TYPE F
⊗	TYPE X

NOTE:
DETAIL INTENDED TO PROVIDE ILLUSTRATION OF LOCATION OF VARIOUS JOINT
TYPES. JOINTS SHALL BE CONSTRUCTED PER WYDOT SPECIFICATIONS

URBAN PAVEMENT NOTES

General Notes

Whenever possible, meet the following requirements for sawing joints at intersections:

- Intersecting joint angles at 90 degrees or greater.
- Minimum joint length is 2 ft. [610].
- Minimum slab length is 6 ft. [1.8 m].
- T = Slab thickness.

Longitudinal Joint Notes

Do not exceed 14 ft. [4.2 m] spacing. Whenever possible, place to coincide with lane markings.

Use type "Y" joints when a construction joint is required.

Use the following curb and gutter joints:

- Type "Y" joint - no lateral restraint exists behind the curb.
- Type "B" joint - full lateral constraint exists behind the curb.
 - Full lateral constraint exists when sidewalk or curb is placed against a foundation or other immovable object. Soil does not comprise full lateral constraint.

When curb and gutter is placed monolithically with concrete pavement, match curb and gutter depth with the pavement. Delete longitudinal curb joint if overall slab width does not exceed 14 ft. [4.2 m].

Place type "B" joint at or near the centerline of roadways 40 ft. [12.0 m] or more in width.

Transverse Joint Notes

Use type "D" joints when transverse dowel jointed concrete pavement is specified. Do not restrict longitudinal movement of transverse dowel jointed pavement slabs at intersections.

Extend transverse joint sawing through the curb when curb and gutter is placed monolithically with pavement. Do not saw intermittent joints.

When design speeds exceed 45 mph [70 km/h], skew transverse joints 1L:6W counter clockwise. Do not skew doweled transverse joints.

Do not exceed 16 ft. [4.8 m] spacing.

Do not terminate transverse joints at the centerline. Span transverse joints the full width of pavement.

CONSULTANTS:

ARCHITECT/ENGINEERS:

acela
architects + engineers
acela architects + engineers, pc office: 610.365.4023
2633 Moravian Ave. website: www.acela-ae.com
Allentown, PA 18103 email: info@acela-ae.com

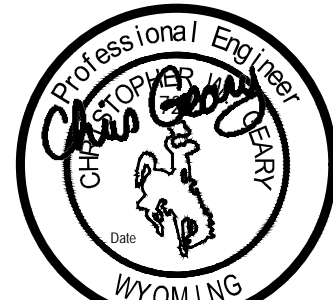

Christopher W. Geary PE# 17277

Drawing Title Construction Details

Approved Project Director

SHERIDAN VAHCS PLANNING AND ENGINEERING

Project Title Resurface Roads And Parking Lots

Location
Sheridan VA Medical Center Sheridan, WY

Date
6/14/2020

Checked
Geary

Drawn
Peters

Project Number
666-17-104

Building Number
-

Drawing Number
CS283

Dwg. 187 of 195

Office of
Construction
and Facilities
Management



Department of
Veterans Affairs

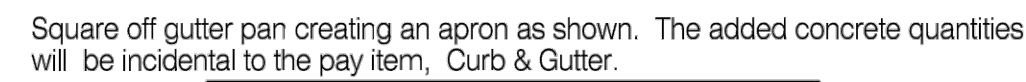
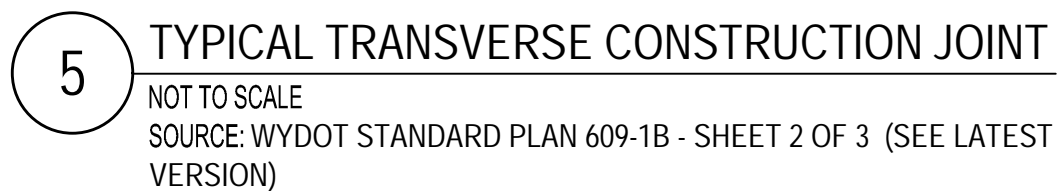
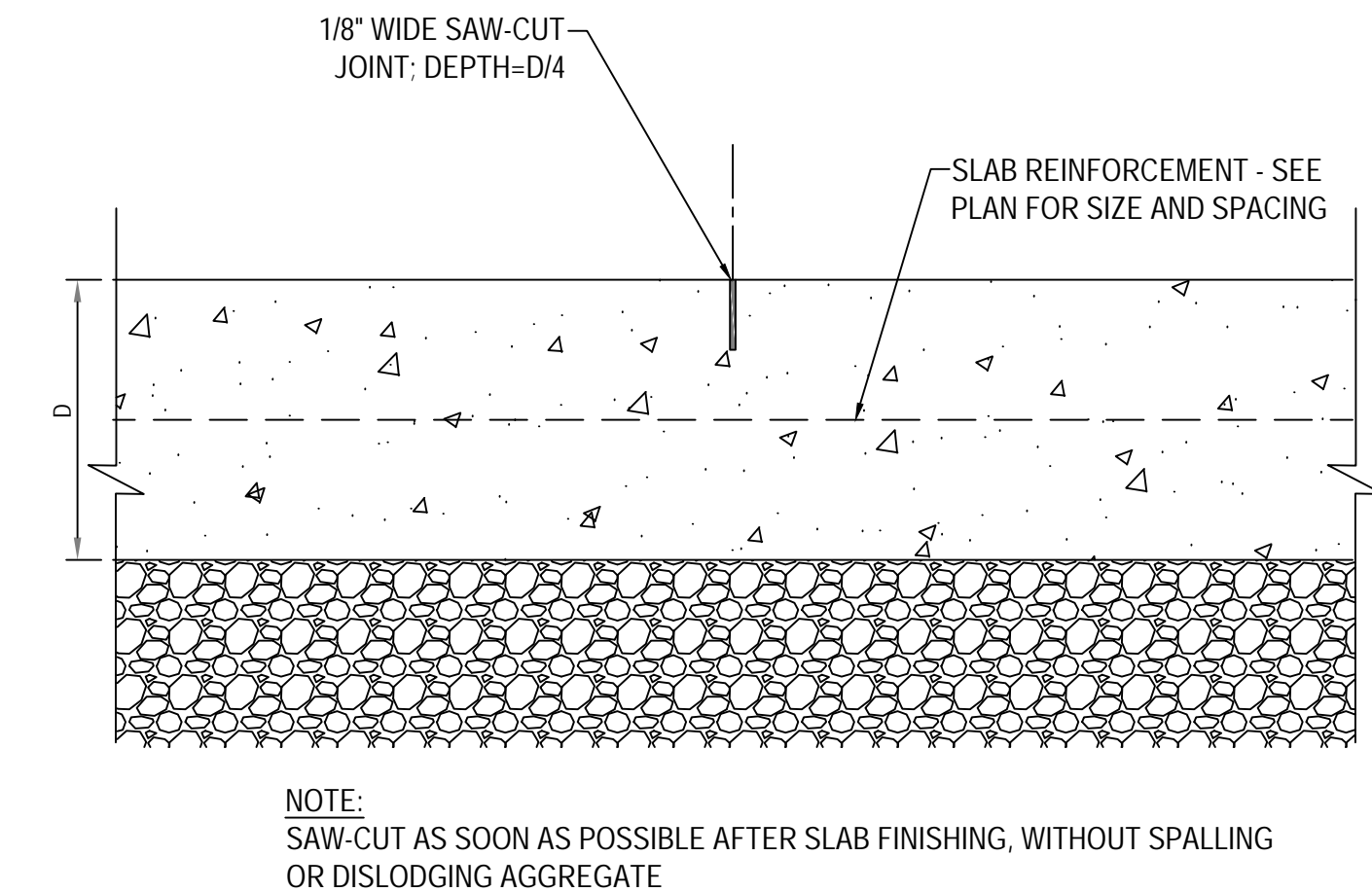
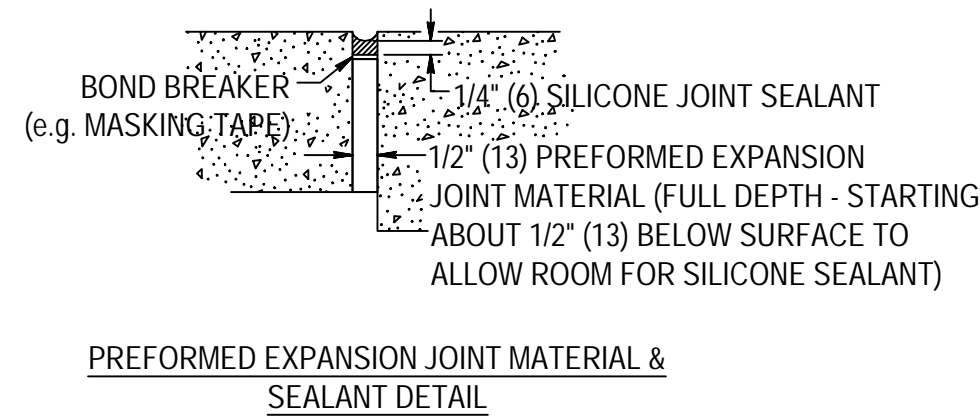
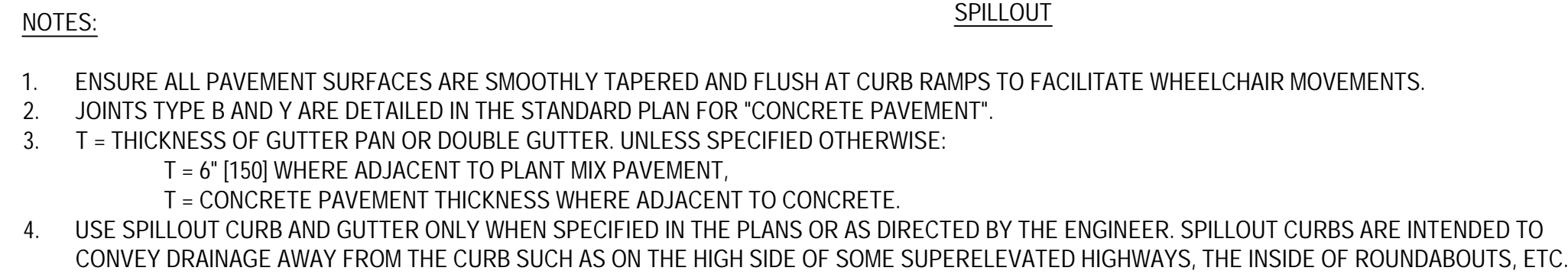

ESTIMATED ADDITIONAL CONCRETE QUANTITIES FOR CROSS-HATCHED AREA FOR PERPENDICULAR INTERSECTIONS ONLY *							
RADIUS		CONCRETE		RADIUS		CONCRETE	
Ft	m	CY	m ³	Ft	m	CY	m ³
5	1.5	0.2	0.15	25	7.6	3.0	2.29
10	3.0	0.6	0.46	30	9.1	4.2	3.21
12	3.7	0.8	0.61	40	12	7.2	5.50
15	4.6	1.2	0.92	45	13.7	9.0	6.86
20	6.1	2.0	1.53	50	15.2	11.0	8.37

*Approximate additional concrete quantity for one square out. Tables values are based on a perpendicular intersection, 6 in. [150] thick gutter and on "D"=2 ft-6in. [760]. Table provided for estimating purposes only.

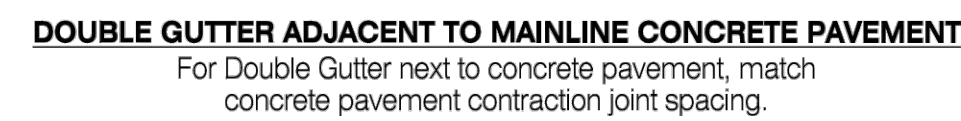

DOUBLE GUTTER REQUIREMENTS

T = See note④, General Notes, Sheet 1

Ⓐ Ensure the backslope for double gutter is 1V:48H or flatter when located in the path of a pedestrian crossing to meet ADA requirements. Otherwise, use a slope as directed by the Engineer.

② See sidewalk standard plan for further requirements for double gutter for (driveway) approaches located within city blocks.

NOT TO SCALE
SOURCE: WYDOT STANDARD PLAN 609-1B - SHEET 3 OF 3
(SEE LATEST VERSION)

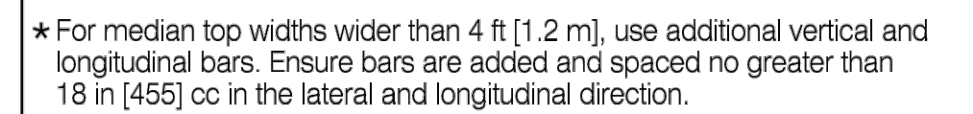

If doweled concrete median is located in an area of concrete pavement, use concrete pavement as base. Dowel top to concrete pavement, measure and pay the base as concrete pavement. Measure and pay the doweled median top as median paving.

If doweled concrete median is located adjacent to plant mix pavement, measure and pay the base of concrete median as median paving. Pay the doweled median top as an additional area of median paving.

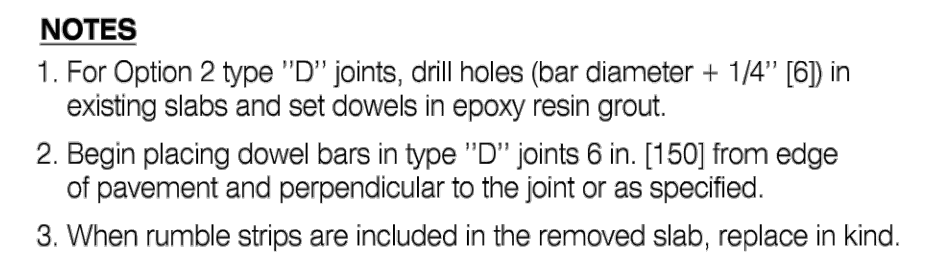
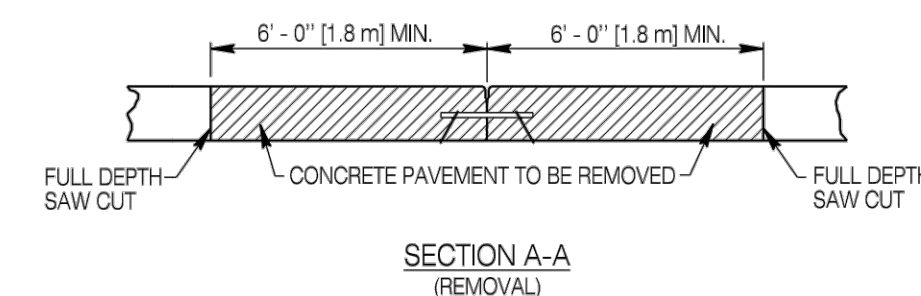

See **Concrete Pavement Joints** Standard Plan for joint details.

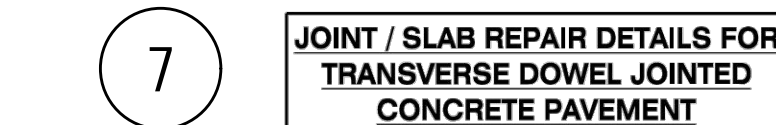

NOT TO SCALE
SOURCE: WYDOT STANDARD PLAN 415-1D - SHEET 1 OF 1 (SEE LATEST VERSION)

-	-
-	-
-	-
-	-
Revisions:	Date

ARCHITECT/ENGINEERS:

acela
architects + engineers

acela architects + engineers, pc
2633 Moravian Ave.
Allentown, PA 18103

office: 610.365.4023
website: www.acela-ae.com
email: info@acela-ae.com

Christopher W. Geary PE# 17277

Drawing Title
Construction Details

Approved: Project Director

SHERIDAN VAHCS PLANNING AND ENGINEERING

Project Title	Resurface Roads And Parking Lots
---------------	----------------------------------

Location	Sheridan VA Medical Center
----------	----------------------------

Date	6/14/2020
------	-----------

Checked
Geary

Drawn
Peters

Project Number	666-17-104
----------------	------------

Building Number

	Drawing Number

CS284

Dwg. 188 of 195

Office of
Construction
and Facilities
Management



Department of
Veterans Affairs

ONE INCH = TWO HUNDRED FIFTY FEET

ONE INCH = TWO HUNDRED FEET

ONE INCH = ONE HUNDRED FEET

ONE INCH = THIRTY FEET

SC-08

SikaQuick VOH
Vertical Repair

1

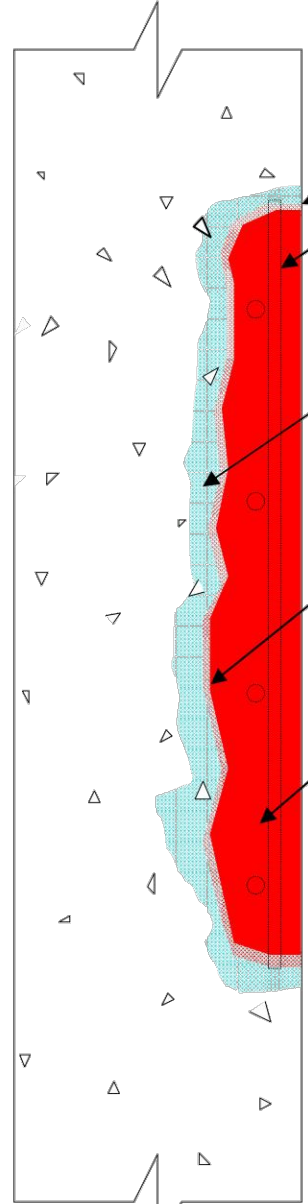

1. Substrate shall be clean, sound and laticence-free prior to repairing. (Refer to ICRI Technical Guideline No. 03730.)
2. Pre-soak the substrate to provide saturated surface dry (SSD) condition prior to applying repair material.
3. Apply scrub coat of the repair material to the prepared substrate, filling all pours and voids.
4. While scrub coat is wet place SikaQuick VOH filling the entire cavity. Strike off and finish as required. Wet cure and protect as per the technical data sheet.

NOTES:
1. FOR USE ON REPAIR OF VERTICAL WALL SOUTH OF BUILDING 31

- Note:
1. Apply scrub coat of repair material to the prepared substrate, filling all pores and voids.
 2. If reinforcing steel is located within the repair location refer to Spec Component SC-201
 3. For vertical applications greater than 3" in depth, a second lift should be applied.

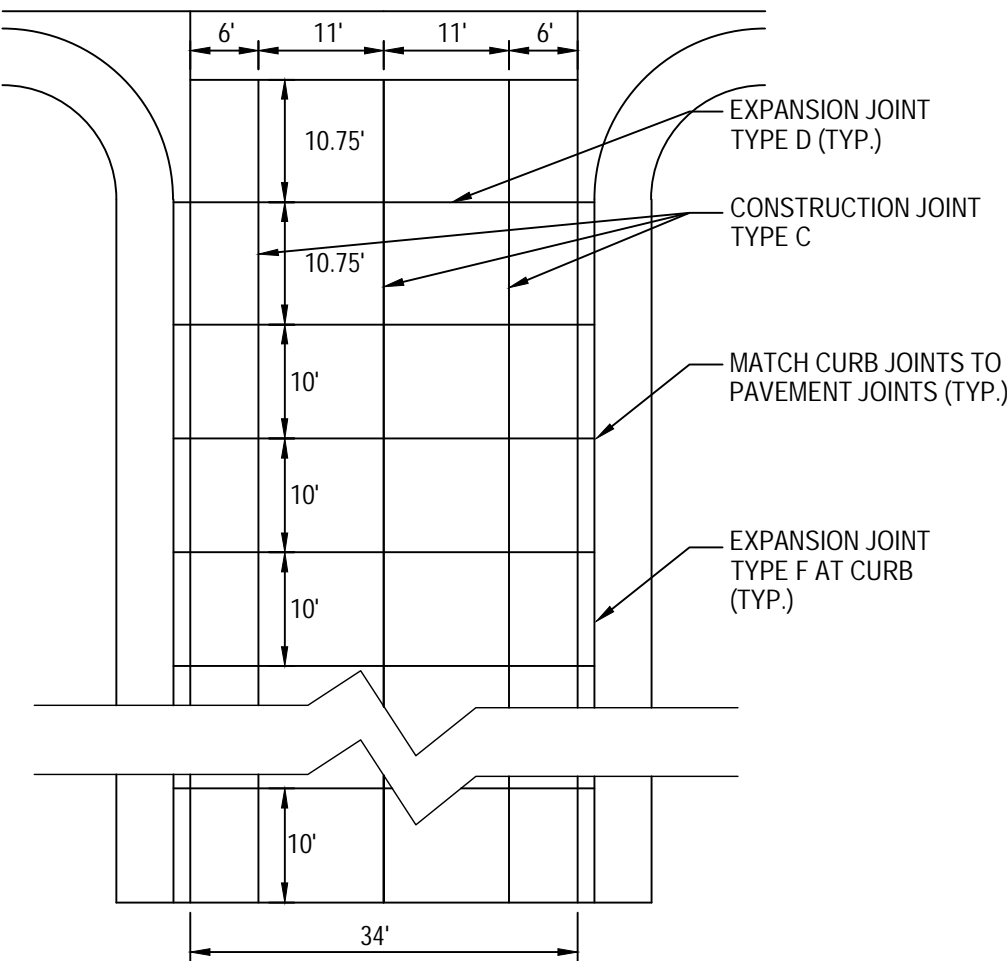

- NOTES:
1. SEE 03040-2.01D FOR CONCRETE PAVEMENT JOINT DETAILS.
 2. THIS DETAIL PERTAINS TO A STANDARD 39-FOOT WIDE STREET (34 FEET OF CONCRETE SURFACING). DETAIL INTENDED TO PROVIDE ILLUSTRATION OF LOCATION OF VARIOUS JOINT TYPES. JOINTS SHALL BE CONSTRUCTED PER WYDOT SPECIFICATIONS. SEE PLANS FOR OTHER WIDTHS.
 3. JOINT A-1 ONLY APPLIES IF THERE IS A TRANSITION TO ASPHALT.
 4. JOINT SEALANT IS INCIDENTAL TO CONCRETE PAVING.

* CONTRACTOR SHALL PROVIDE JOINTING PLAN FOR APPROVAL PRIOR TO PAVING.
** MATCH EXISTING JOINTS FOR FORT ROAD.

2

TYPICAL JOINTS FOR CONCRETE PAVEMENT DETAIL*

NTS
SOURCE: 2016 STANDARD SPECIFICATIONS - CITY OF SHERIDAN

General Notes

- ① T = Slab thickness.
- ② Begin placing deformed rebar and/or smooth bars beginning 6 inches [150] from the edge of pavement or as specified. For longitudinal joints, place rebar perpendicular to joints, for transverse joints, place rebar parallel to the direction of travel.
- ③ When transverse joints do not fracture in the joint at the edge of the slab, saw depth may be increased as approved by the engineer at no additional cost to the department.
- ④ Some joint sealants such as liquid joint sealants may require a 3/16" [5] final joint width. For those conditions it is acceptable to make the initial saw cut width 3/16" [5].
- ⑤ Type K, Pave-Thru Expansion Joints including the required sleeper slab and appurtenances may be substituted for Type E Expansion Joints at the contractor's expense. Provide 24 Gauge [0.7 thick] galvanized sheeting that meets the requirements of ASTM A653, coating designation G90. Cover the entire sleeper slab with the sheeting, acting as a bond breaker. Saw cut or form a full depth joint 1-1/2 inches [38] wide. Do not cut into the galvanized sheet.

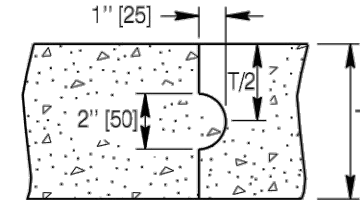

ALTERNATE KEYWAY DETAIL

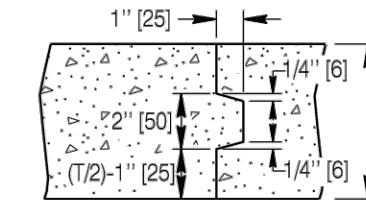

TYPICAL KEYWAY DETAIL

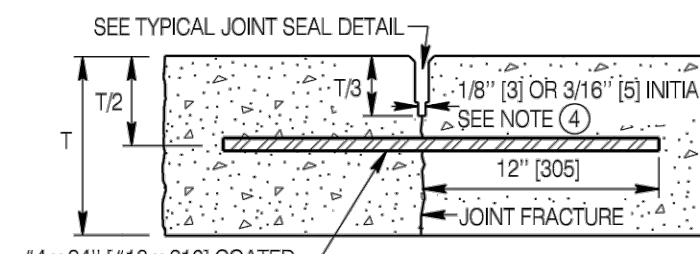

TYPE X TIED WEAKENED PLANE JOINT

3

NOT TO SCALE
SOURCE: WYDOT STANDARD PLAN 414-2 - SHEET 1 OF 3 (SEE LATEST VERSION)

Joint Seal Notes

- △ Use the joint sealant type as specified in the contract.
- △ Seal type "E" joints with silicone seal.
- △ Tape or close joint ends as approved by the engineer to prevent loss of joint sealant.
- △ Seal Type K Pave-Thru Expansion Joints with a compression joint material which is closed-cell, cross-linked, low-density polyethylene copolymer, nitrogen blown resilient foam material with an ultraviolet stabilizer. Recess the compressed joint material 1/4 inch [6] below the top of the concrete pavement. Splices shall be beveled 45 degrees and butted together.

NOTE:
SELF-LEVELING SILICONE SEALANT SHALL BE UTILIZED ON ALL FORT ROAD JOINT REPAIRS UNLESS OTHERWISE STATED, OR GIVEN THE DIRECTION OF THE COR. INSTALL PER MANUFACTURER SPECIFICATIONS.

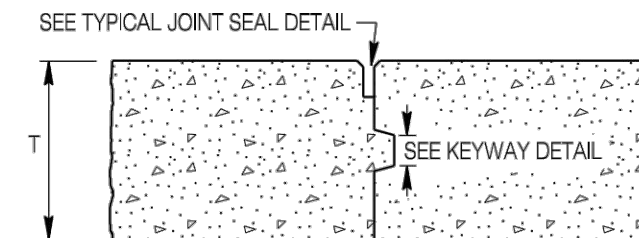

TYPE B KEYED CONSTRUCTION JOINT

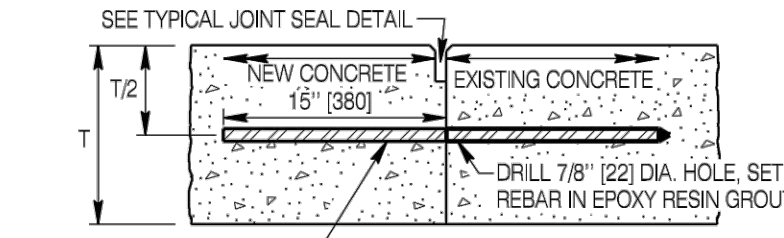

TYPE F TYING TO EXISTING CONCRETE

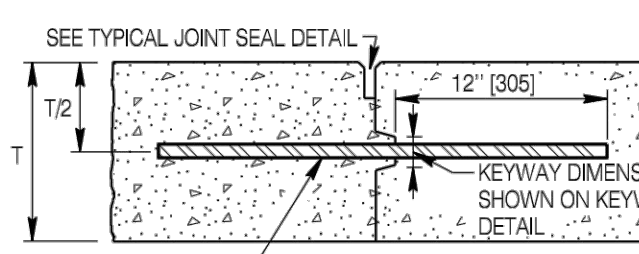

TYPE V CONSTRUCTION JOINT

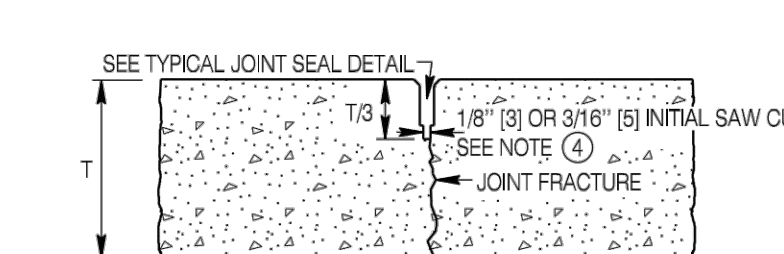

TYPE Z WEAKENED PLANE JOINT

Note: See keyed notes X for joint construction on sheet 1, and keyed notes △ for joint seal on sheet 3.

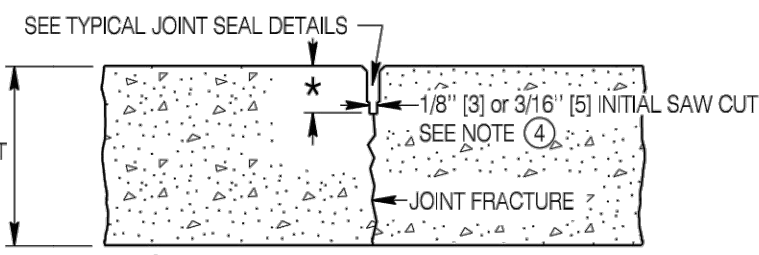

TYPE A WEAKENED PLANE JOINT

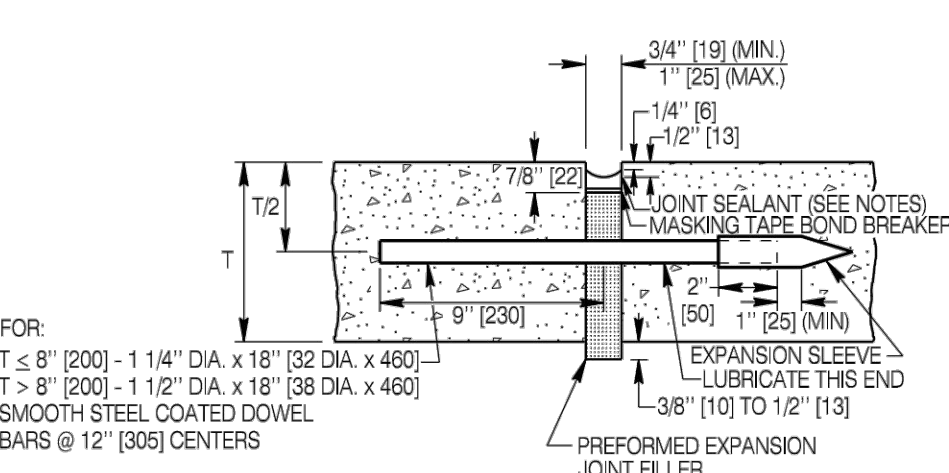

TYPE E EXPANSION JOINT

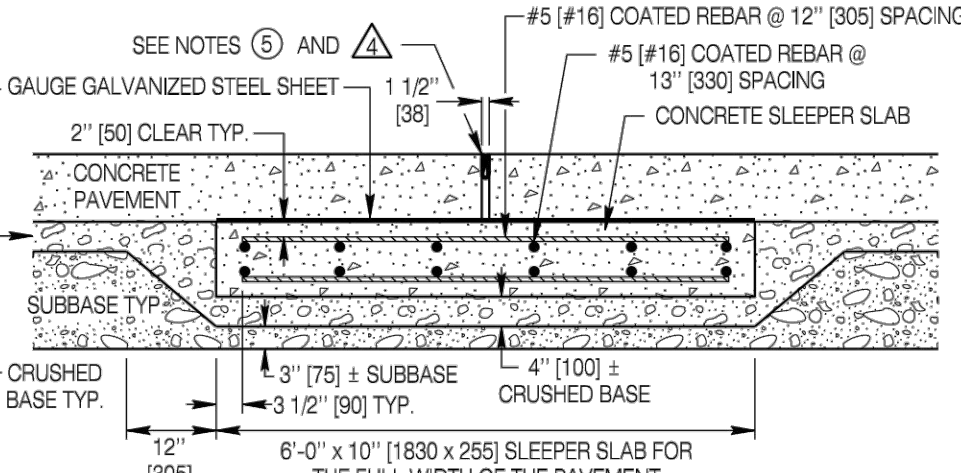

TYPE K PAVE-THRU EXPANSION JOINT DETAIL

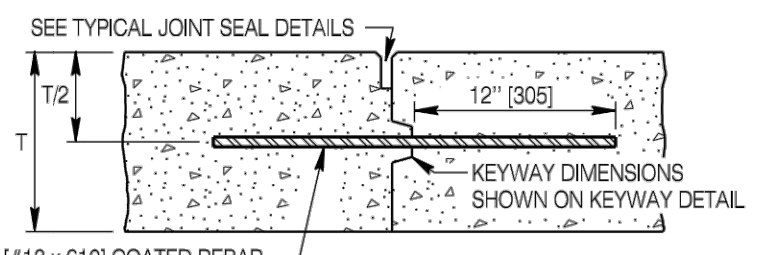

TYPE C CONSTRUCTION JOINT

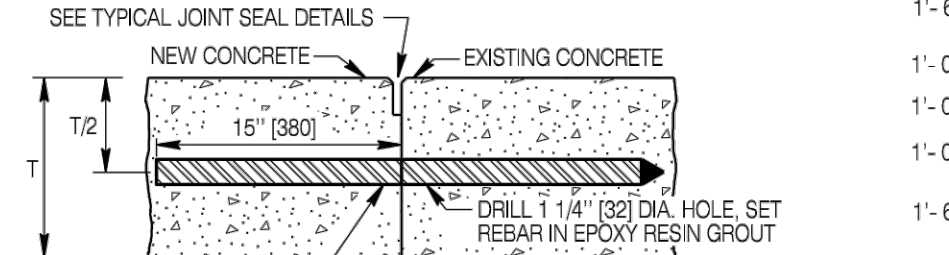

TYPE G SLAB REPLACEMENT TRANSVERSE JOINT (NOT AT EXISTING JOINT)

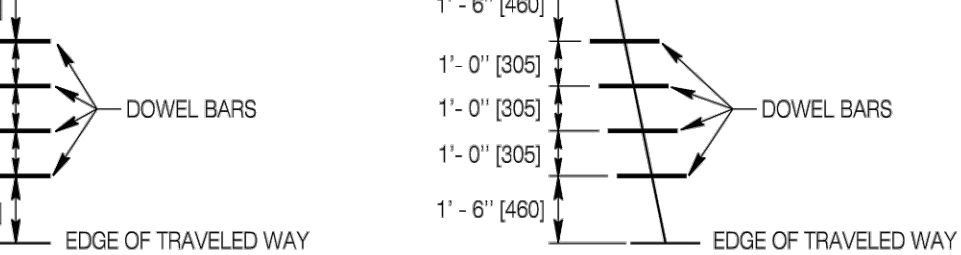

PERPENDICULAR TRANSVERSE JOINT

REBAR SPACING FOR TYPE H TRANSVERSE JOINT

Note: Only for repairs in existing pavements with skewed joints.

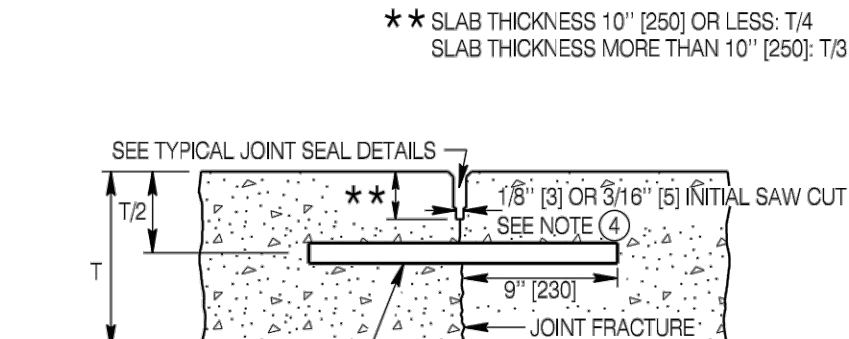

TYPE D TRANSVERSE DOWELED WEAKENED PLANE JOINT

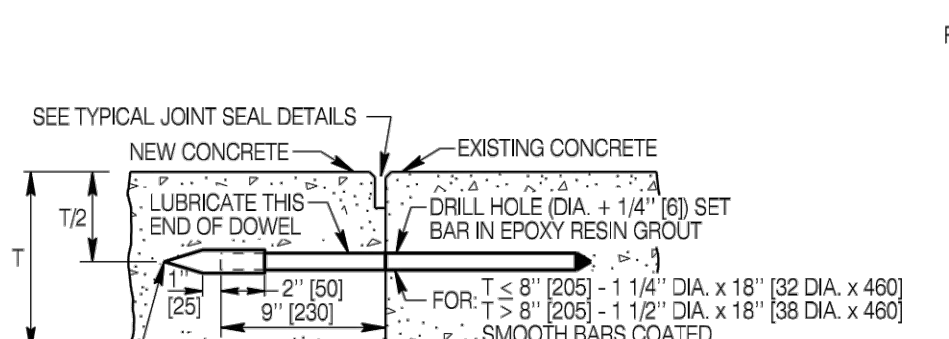

TYPE J SLAB REPLACEMENT TRANSVERSE JOINT (AT EXISTING JOINT)

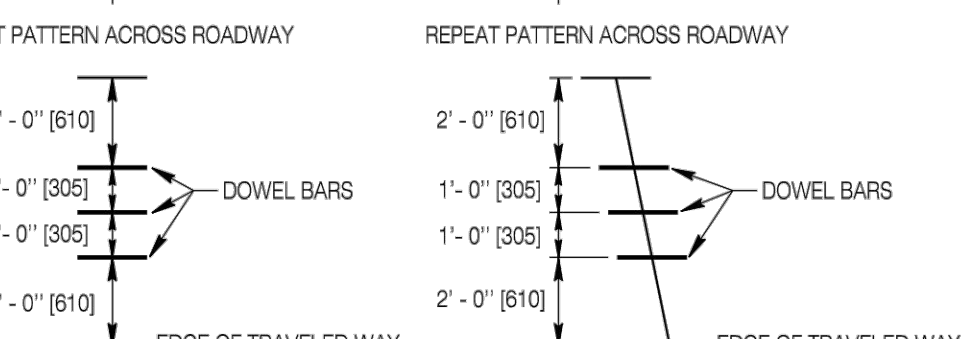

SKewed TRANSVERSE JOINT

DOWEL SPACING FOR TYPE J TRANSVERSE JOINT

Note: Only for repairs in existing pavements with skewed joints.

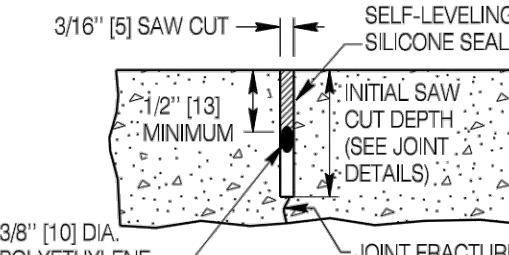

SELF-LEVELING SILICONE SEALANT JOINT

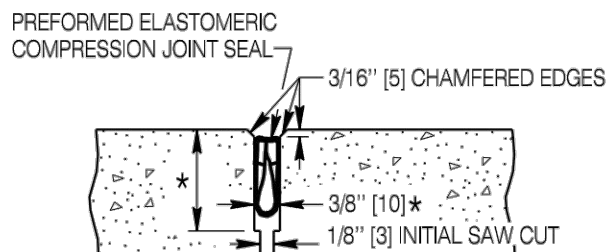

PREFORMED ELASTOMERIC COMPRESSION JOINT SEAL

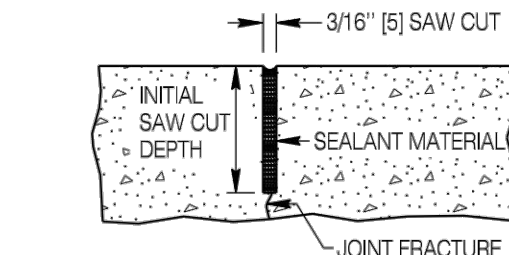

HOT POURED ELASTIC JOINT SEAL

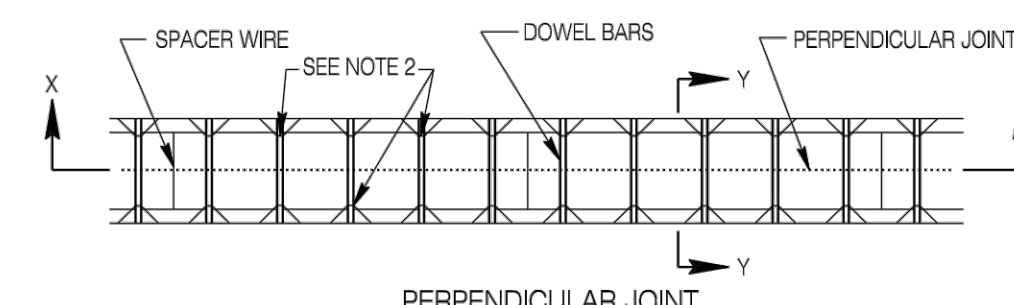

PERPENDICULAR JOINT

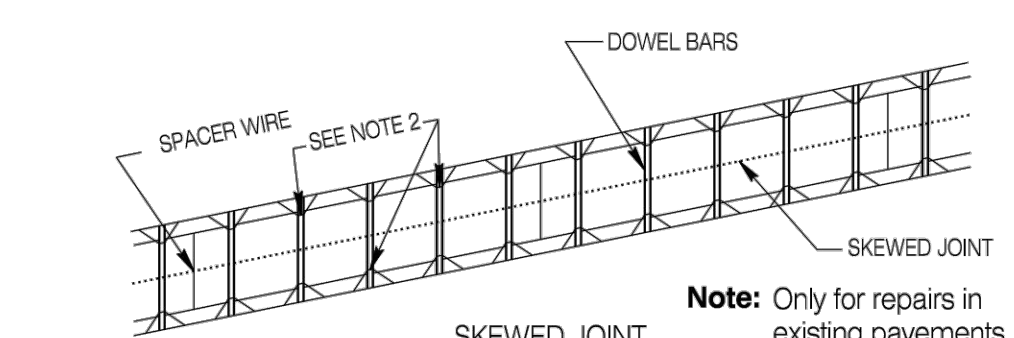

SKewed JOINT

Note: Only for repairs in existing pavements with skewed joints.

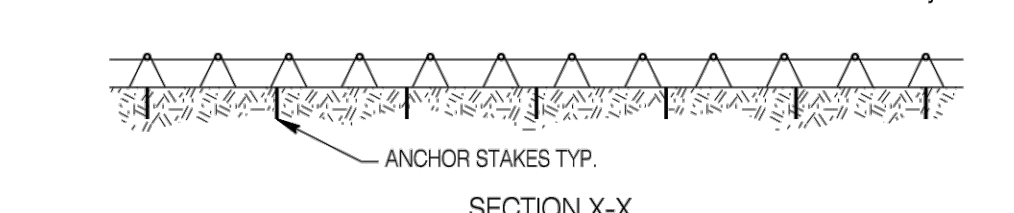

SECTION X-X

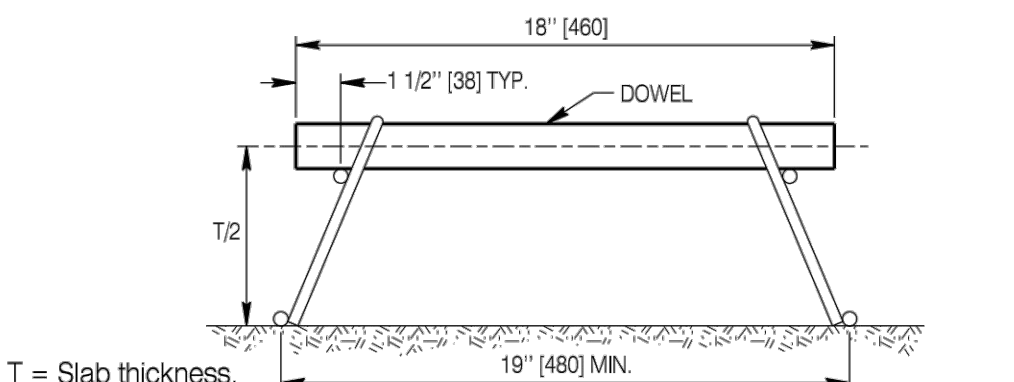

SECTION Y-Y

TYPICAL PLAN OF TRANSVERSE JOINT DOWEL ASSEMBLY

Dowel Basket & Dowel Placement Notes

1. After staking in place, cut spacer wire.
2. Tack weld dowel bars at alternating ends to the basket assembly.
3. Do not crush dowel baskets.

5

TYPICAL JOINT SEAL DETAILS

NOT TO SCALE
SOURCE: WYDOT STANDARD PLAN 414-2 - SHEET 3 OF 3 (SEE LATEST VERSION)

Drawing Title
Construction Details

Approved: Project Director

SHERIDAN VAHCS PLANNING AND ENGINEERING

Project Title
Resurface Roads And Parking Lots

Location
Sheridan VA Medical Center

Date
6/14/2020

Checked
Geary

Drawn
Peters

Project Number
666-17-104

Building Number
-

Drawing Number
CS285

Dwg. 189 of 195

Office of
Construction
and Facilities
Management

Department of
Veterans Affairs

CONSULTANTS:

ARCHITECT/ENGINEERS:

acela
architects + engineers

acela architects + engineers, pc
2633 Moravian Ave.
Allentown, PA 18103

office: 610.365.4023
website: www.acela-ae.com
email: info@acela-ae.com

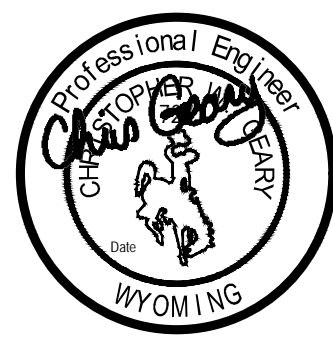

Christopher W. Geary PE# 17277

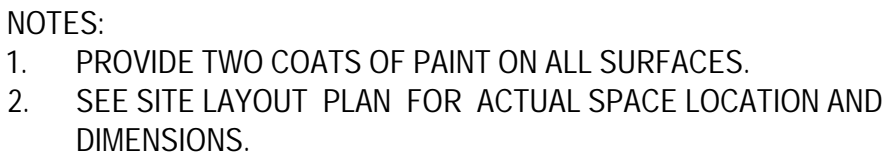

Office of
Construction
and Facilities
Management

 Department of
Veterans Affairs

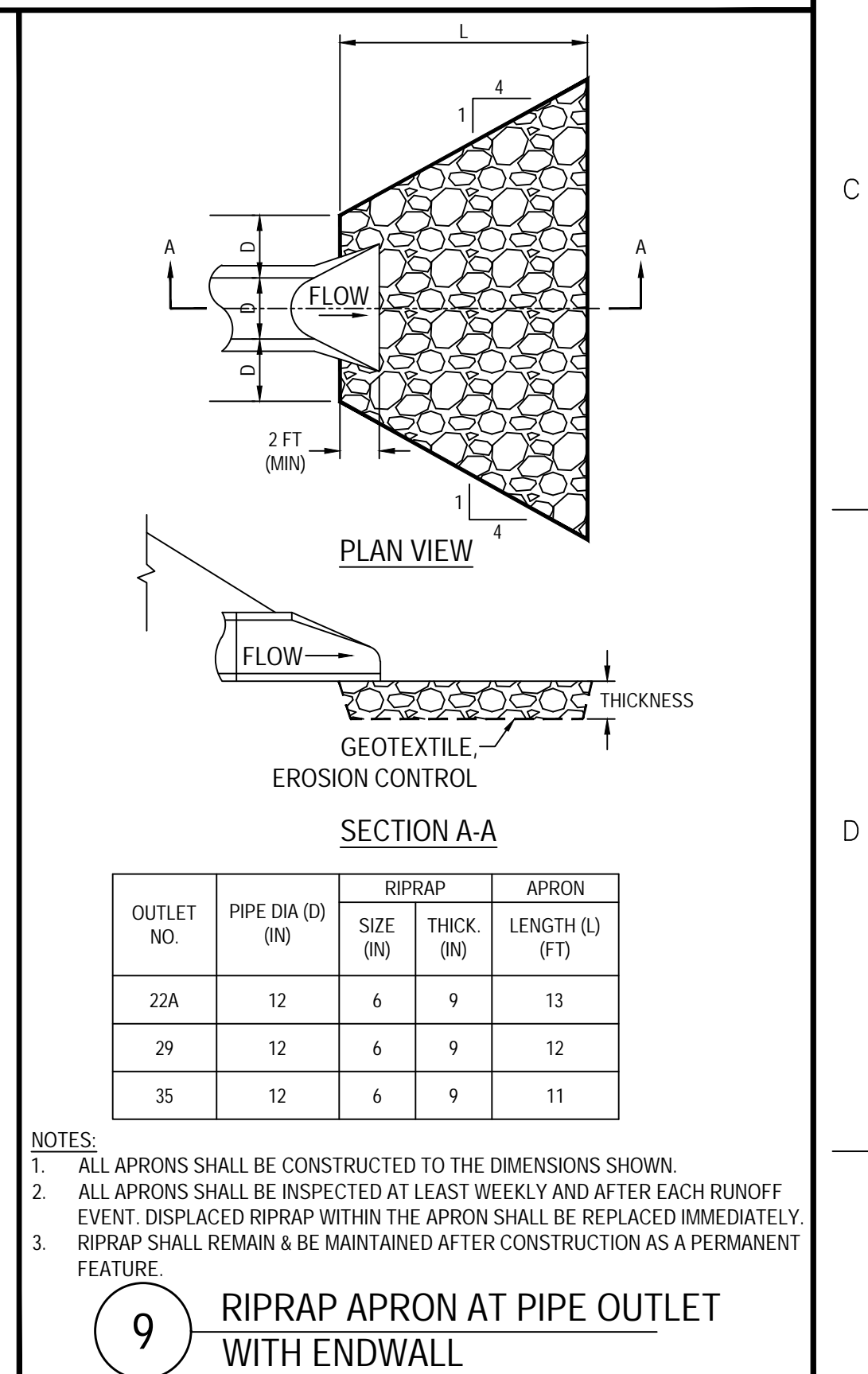
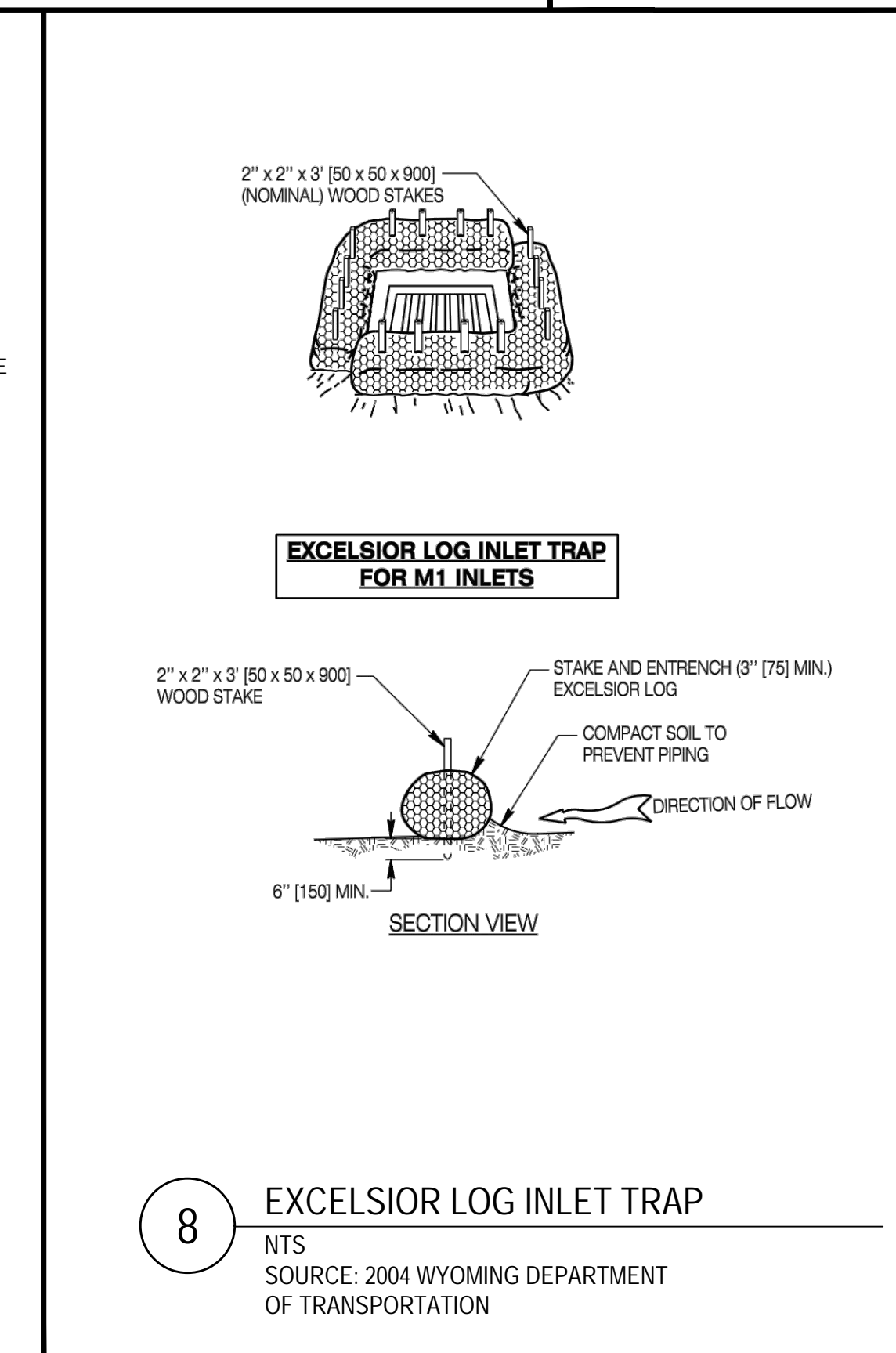
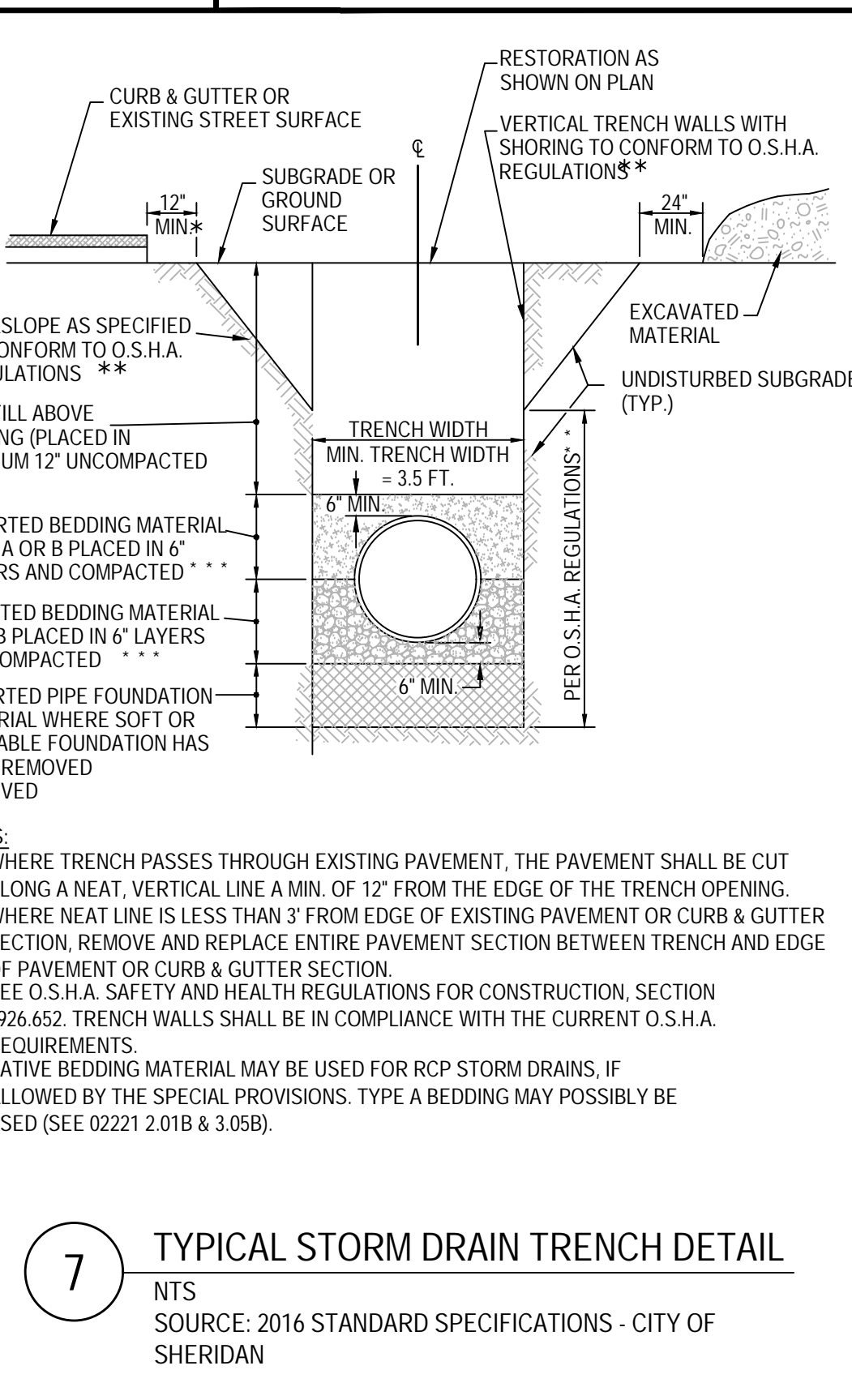
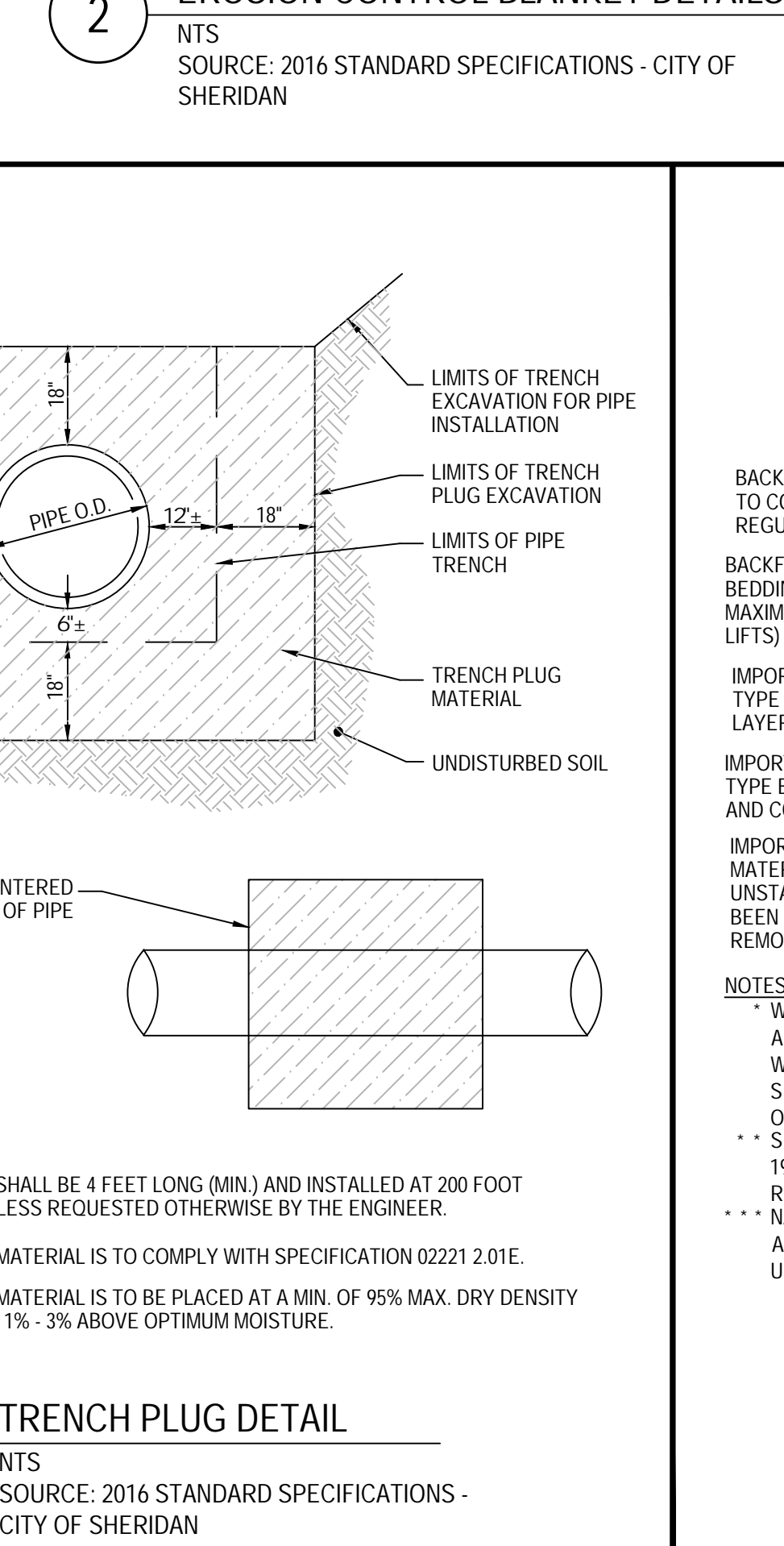
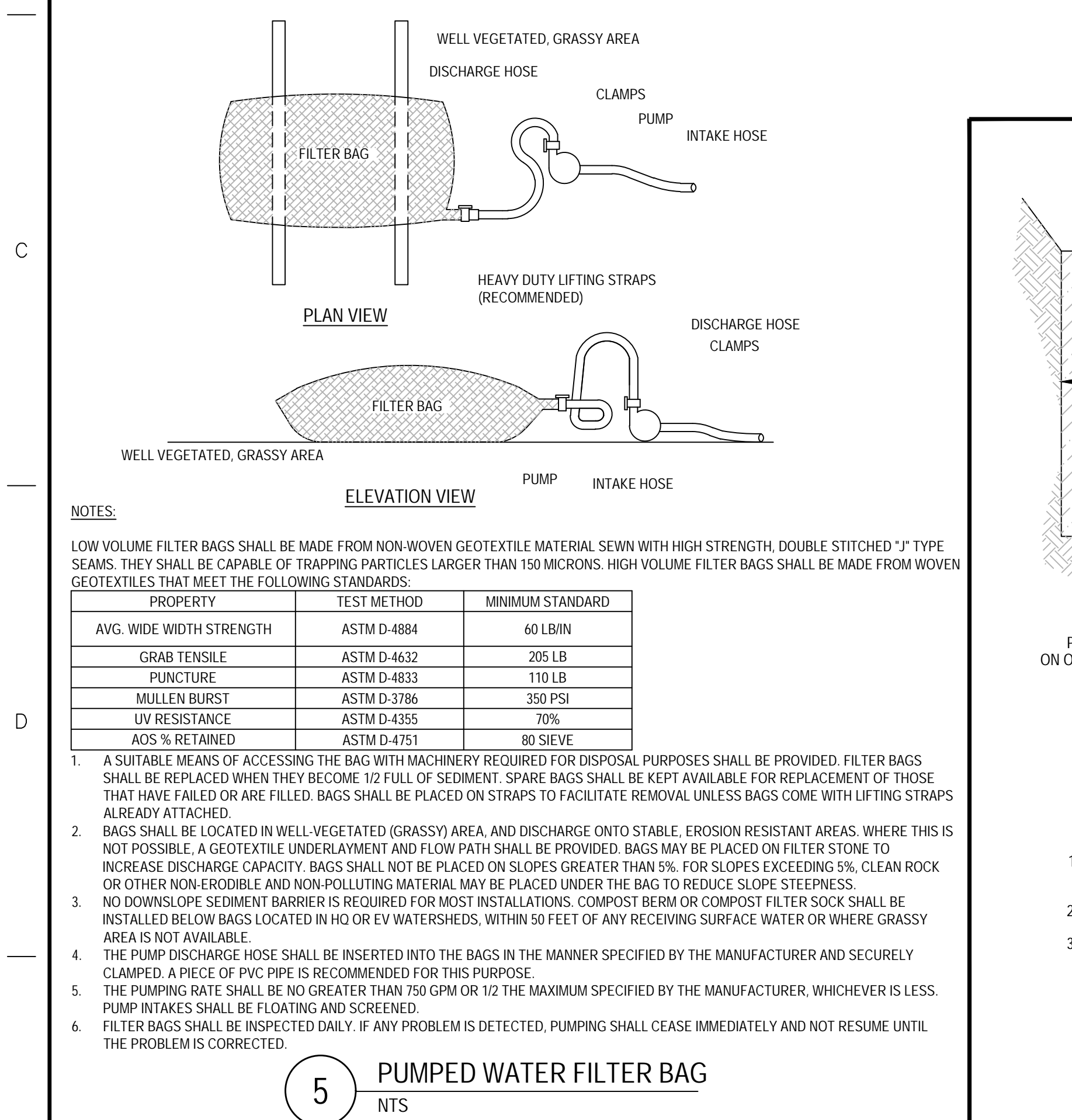
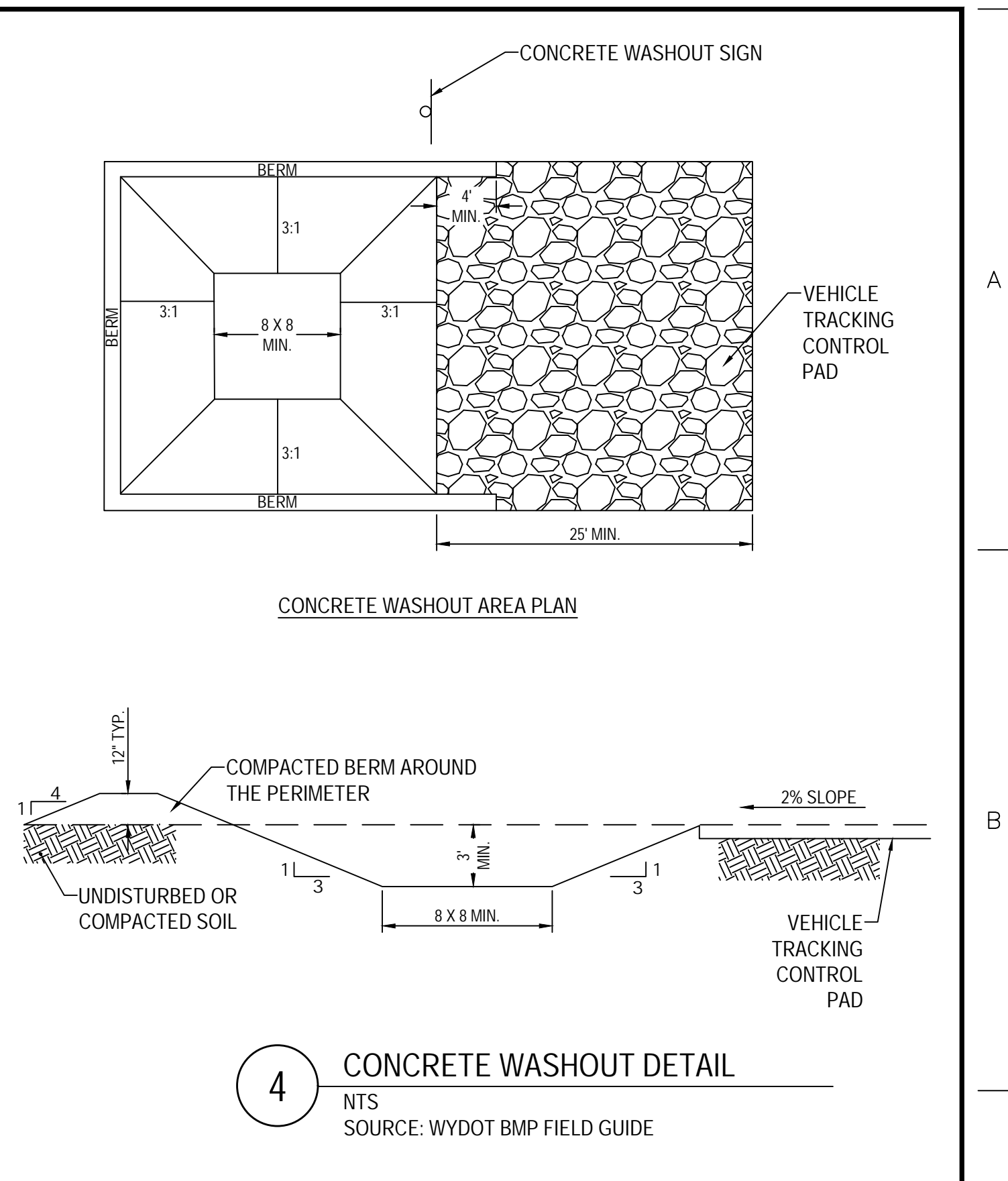
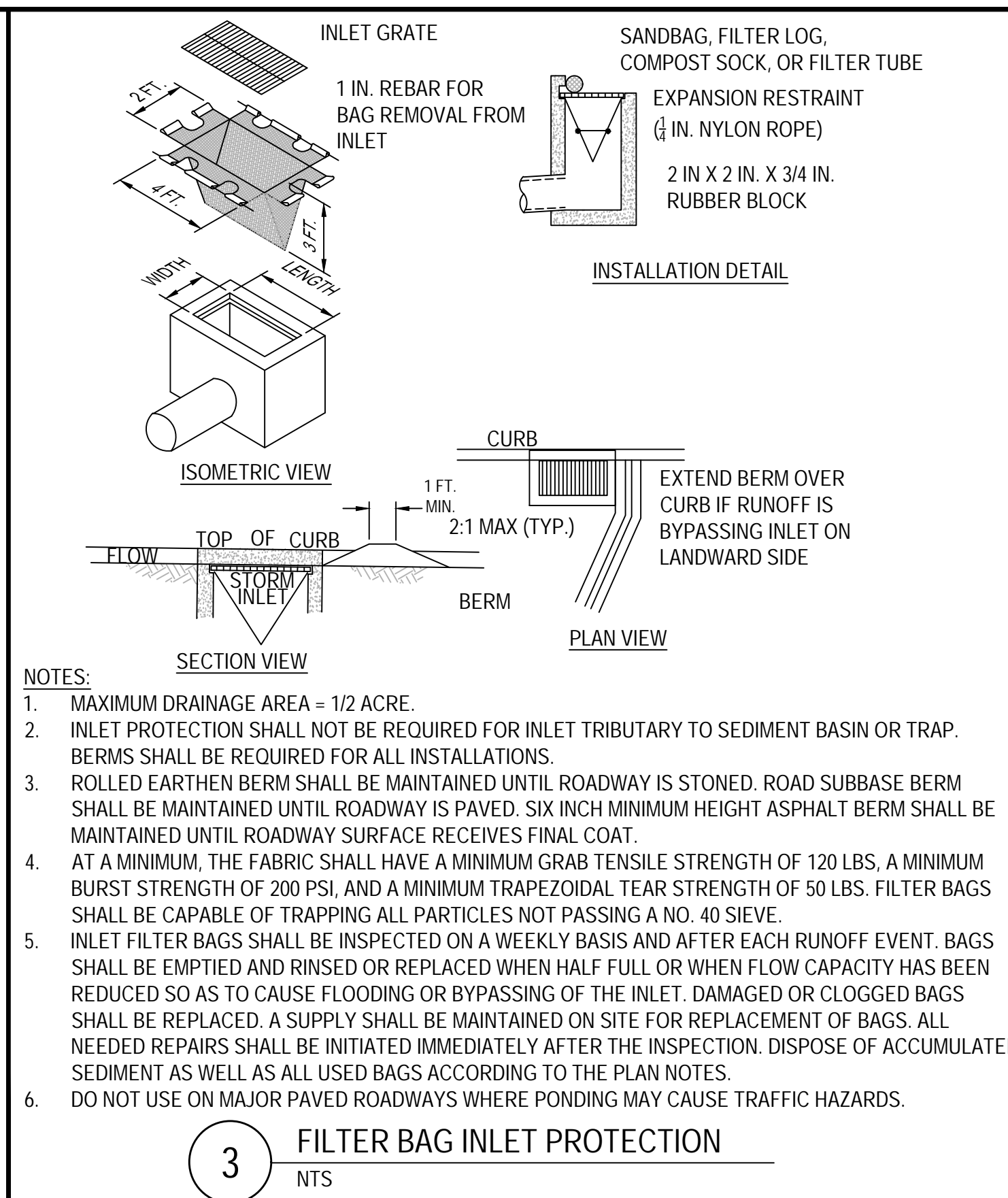
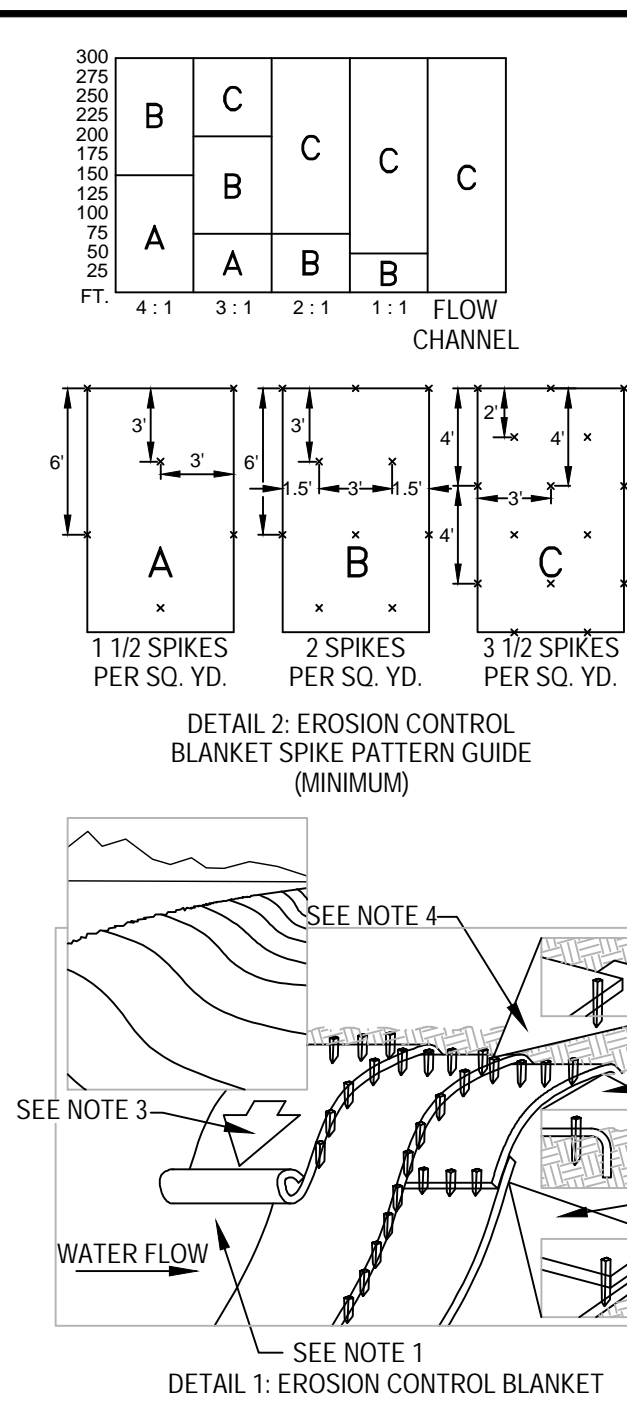
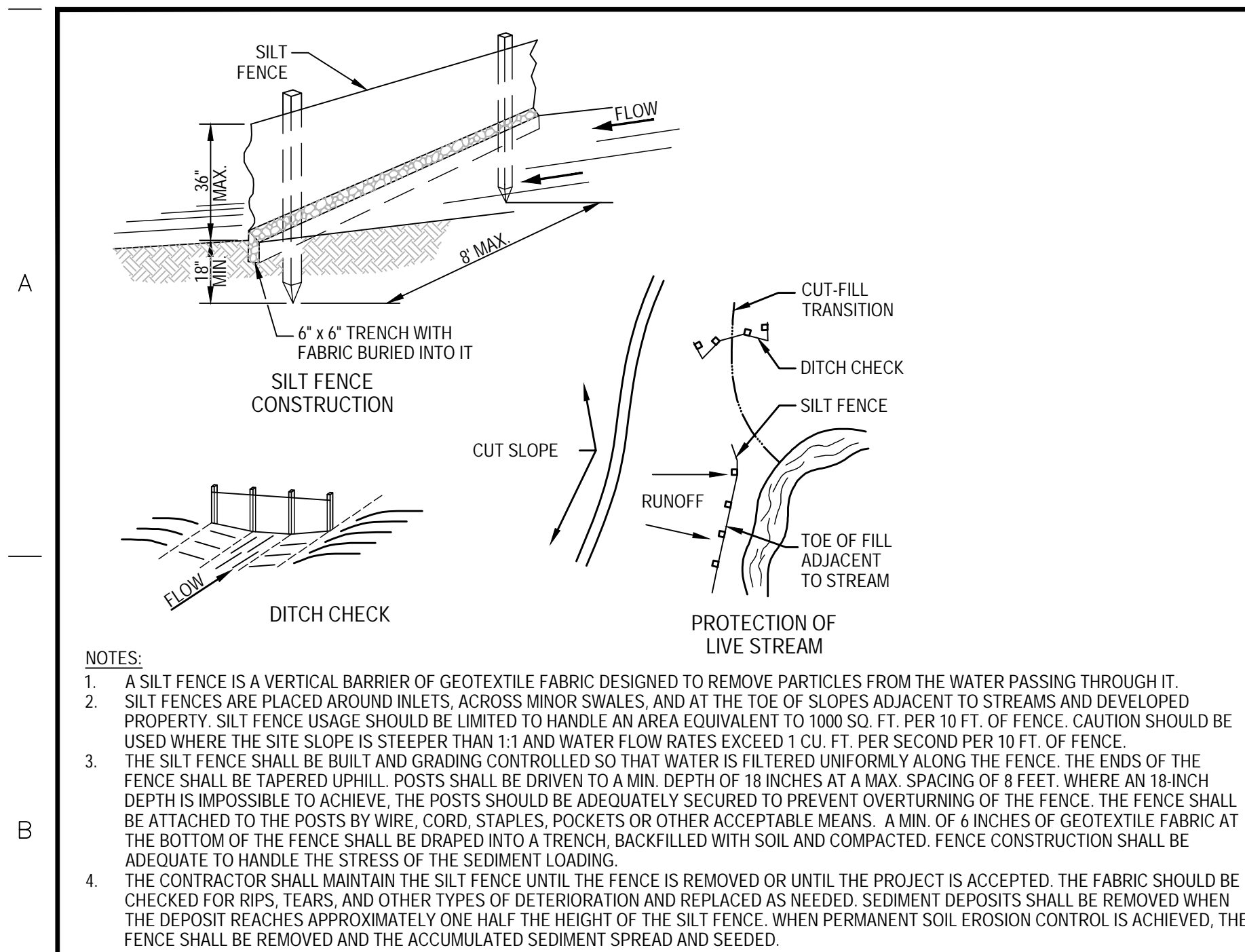

-	-
-	-
-	-
-	-
Revisions:	Date

[illegible]

ARCHITECT/ENGINEERS:

acela

architects + engineers

acela architects + engineers, pc
2633 Moravian Ave.
Allentown, PA 18103

office: 610.365.4023
website: www.acela-ae.com
email: info@acela-ae.com

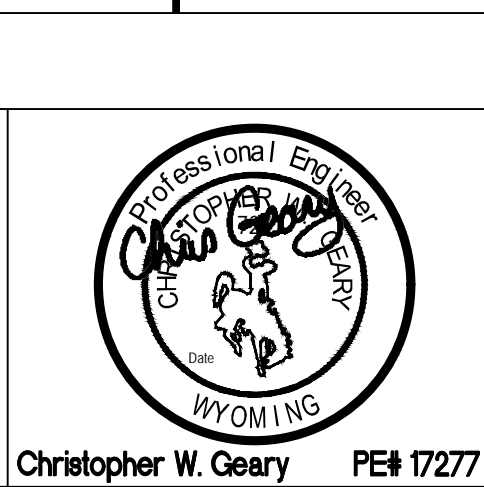

Drawing Title
Construction Details
-
-
Approved: Project Director
-
-
SHERIDAN VAHCS PLANNING AND ENGINEERING

Project Title		
Resurface Roads And Parking Lots		
-		
-		
Location		
Sheridan VA Medical Center		Sheridan, WY
Date	Checked	Drawn
6/14/2020	Geary	Peters



Project Number 666-17-104
Building Number -
Drawing Number CS287
Dwg. 191 of 195

Office of
Construction
and Facilities
Management

 Department of
Veterans Affairs

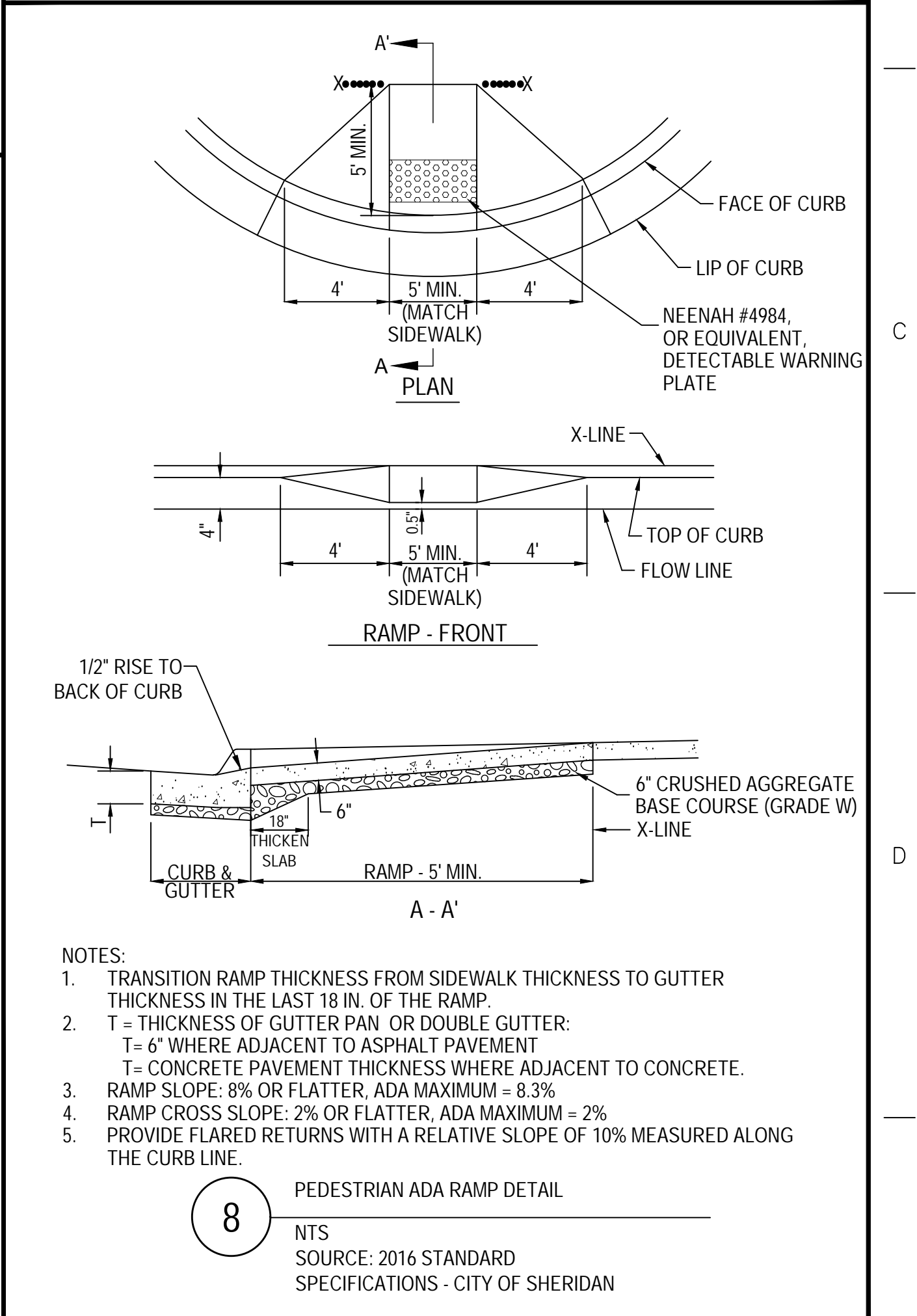
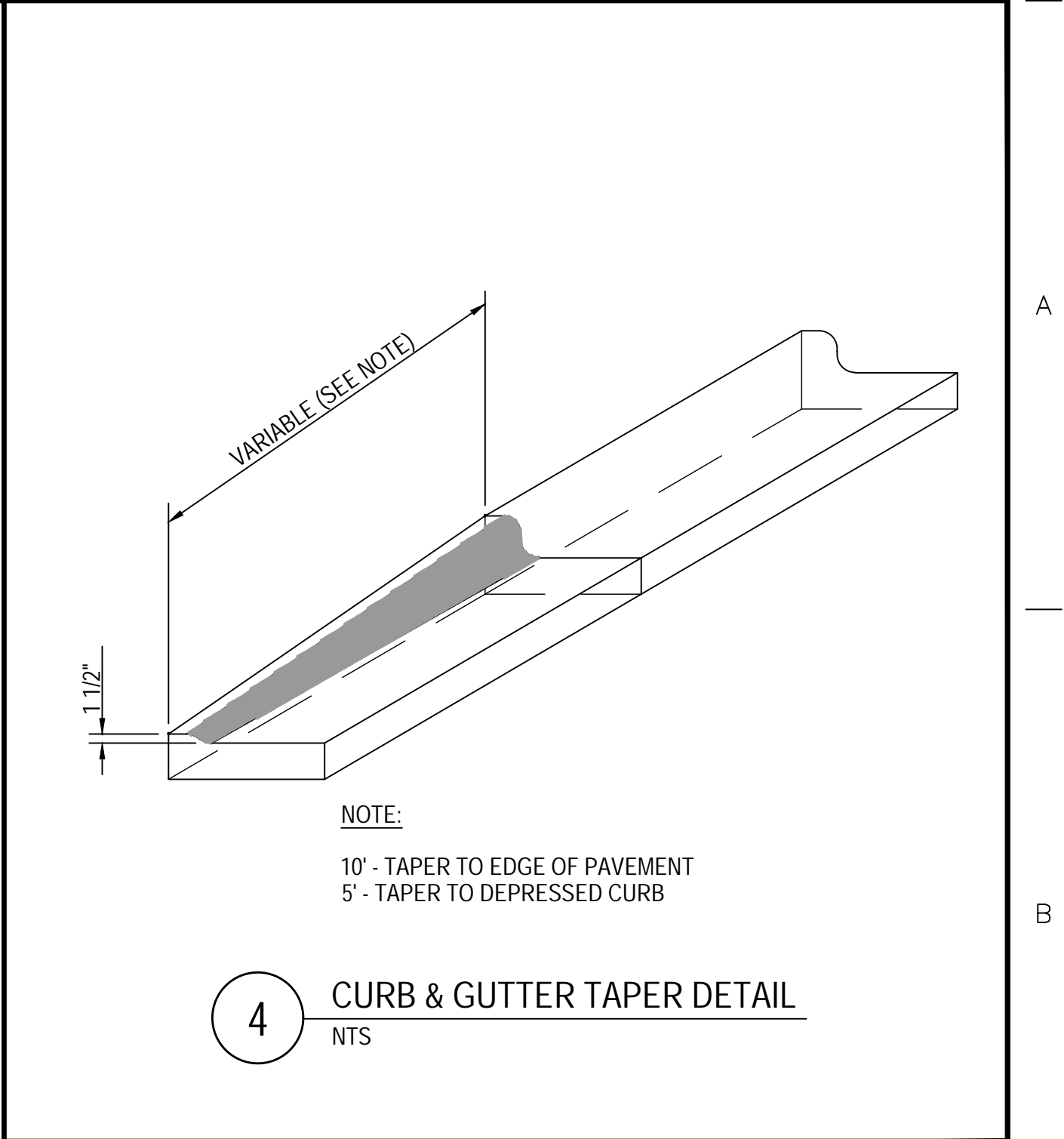
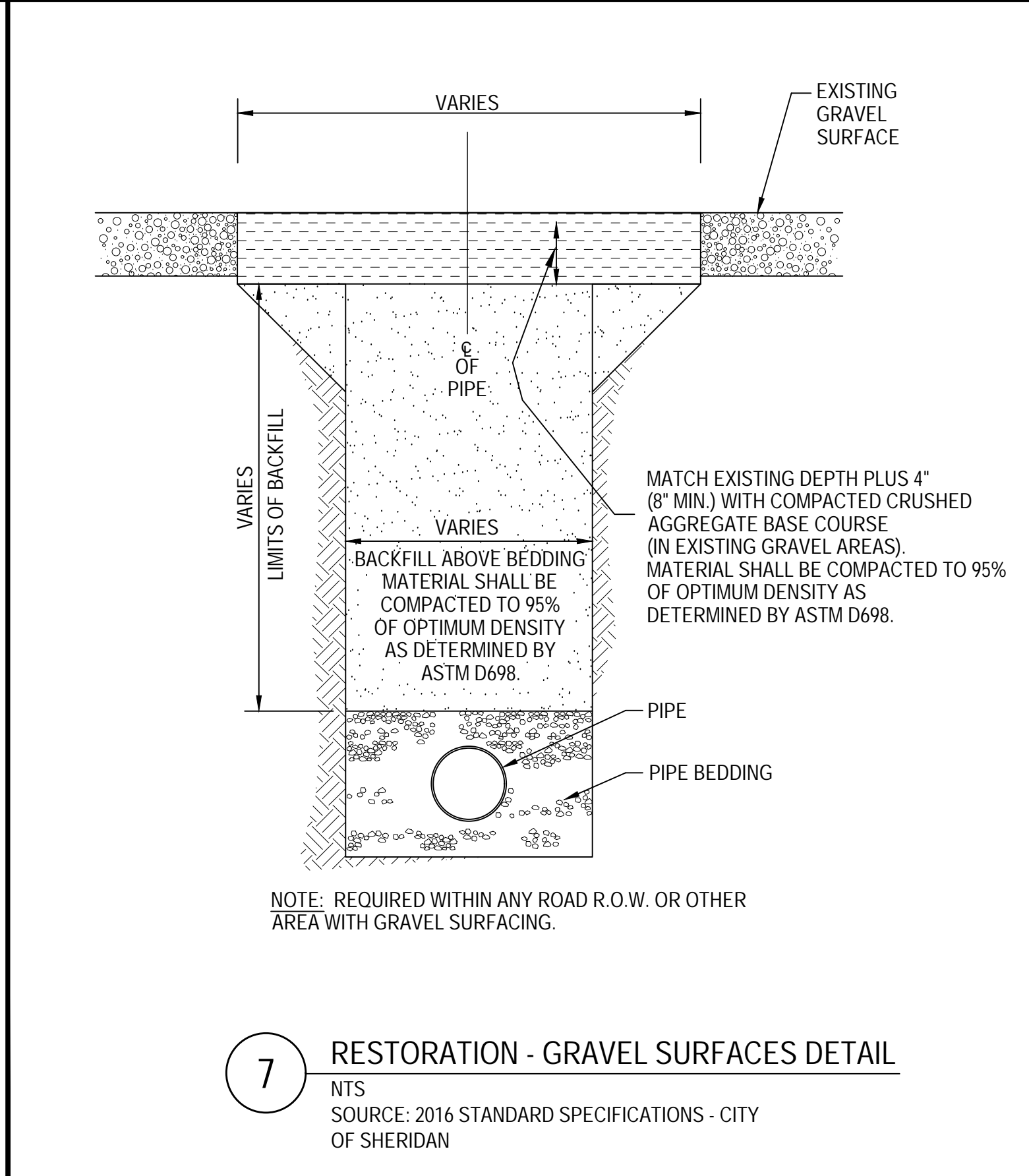
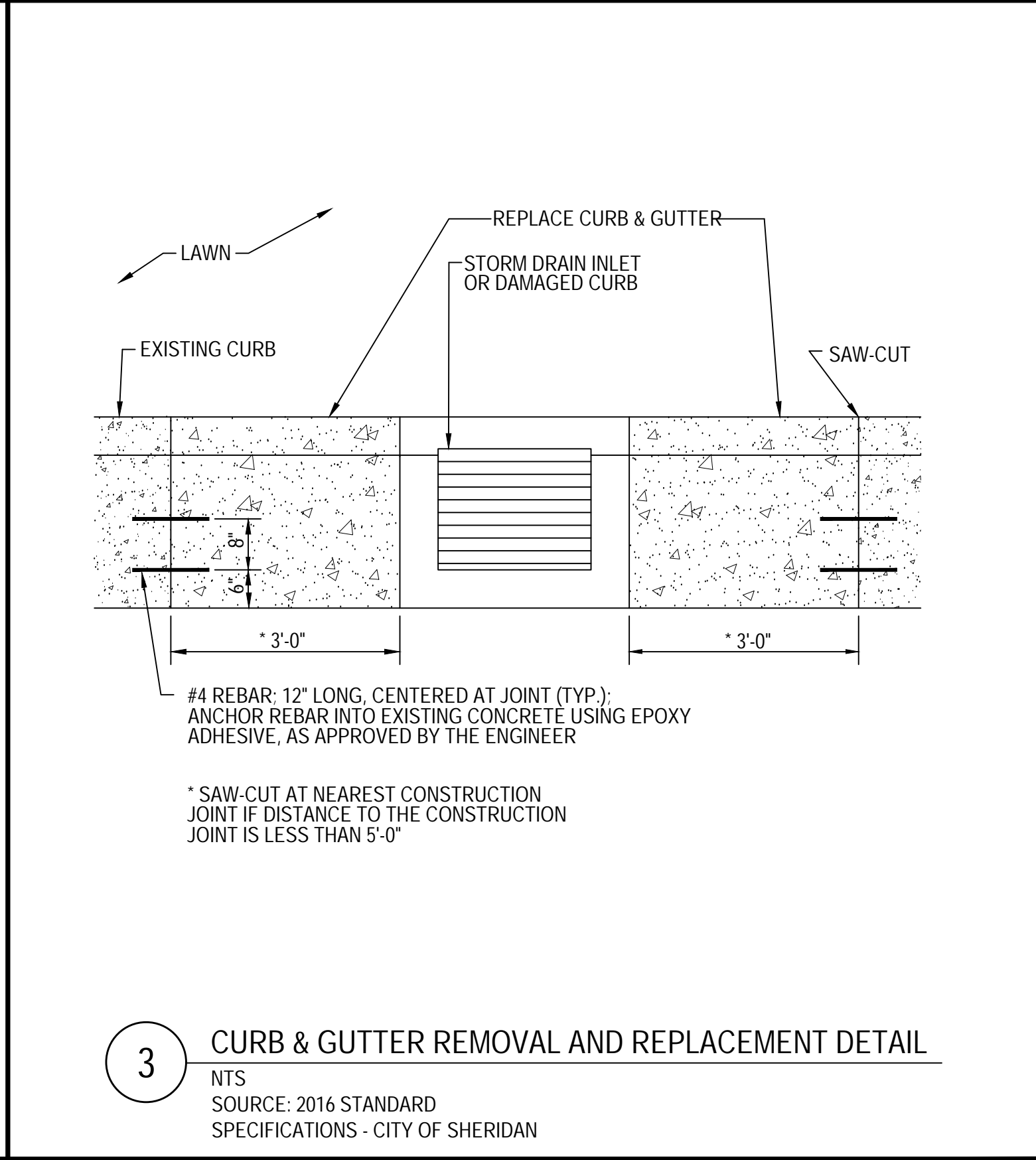
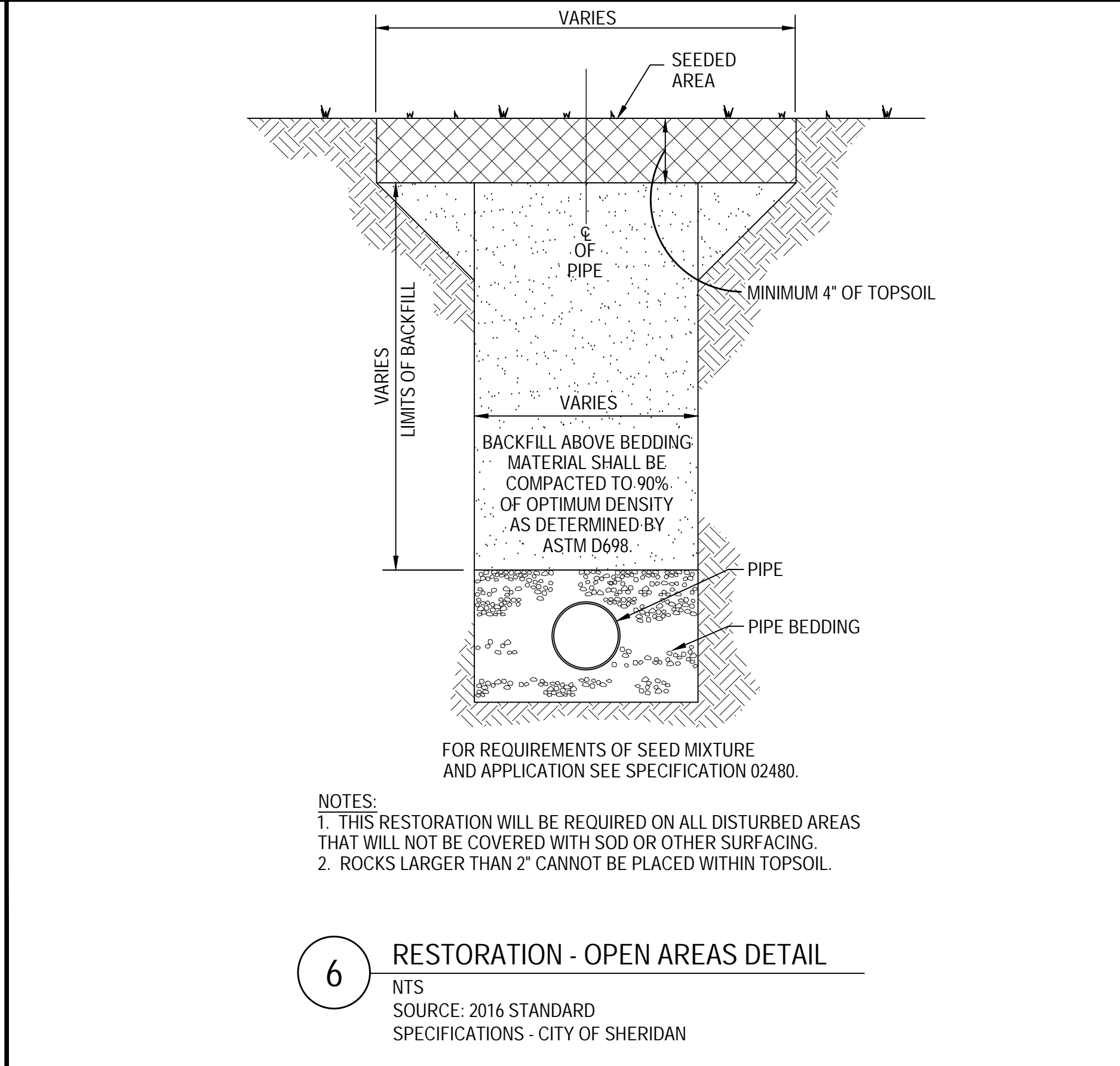
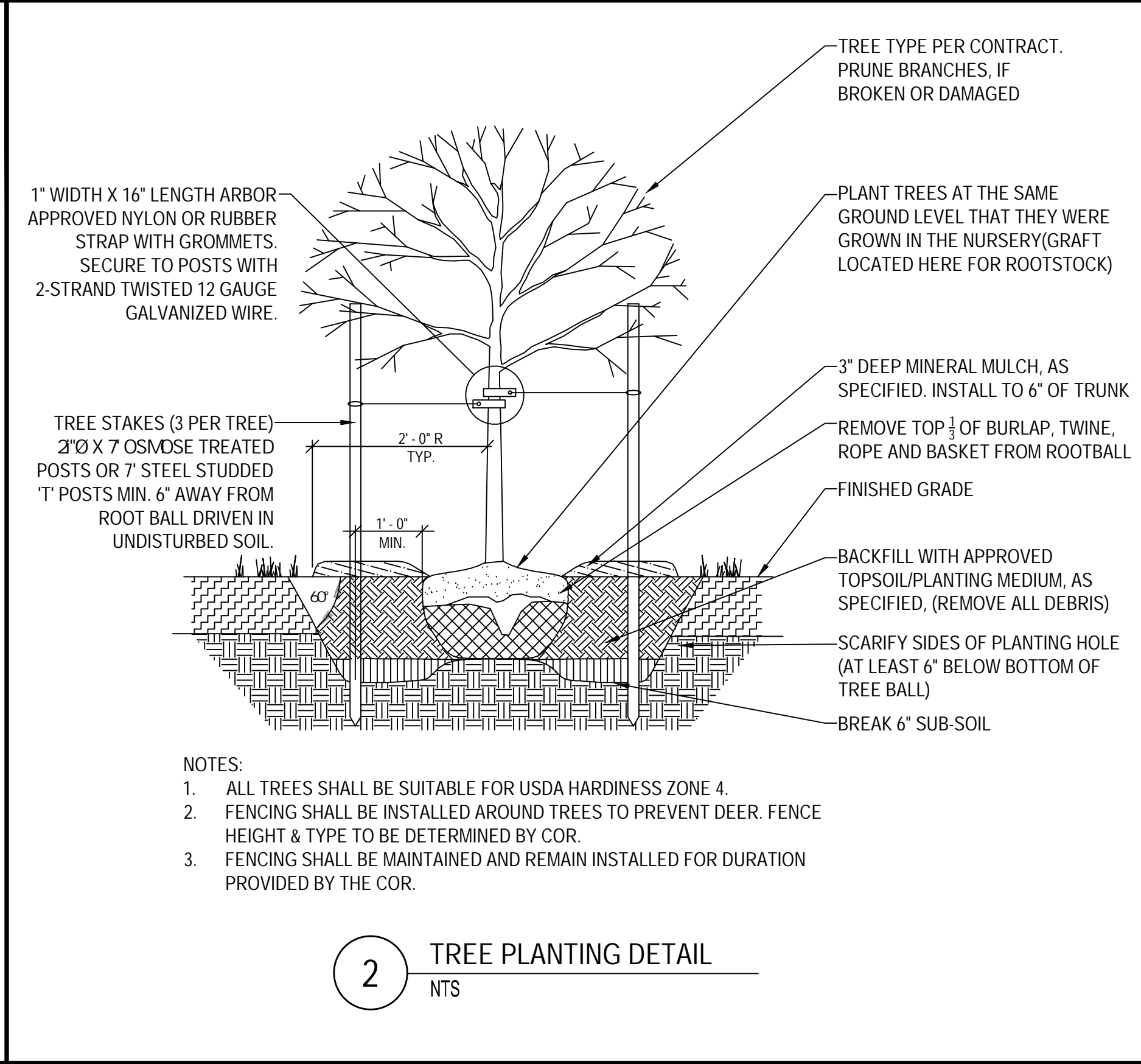
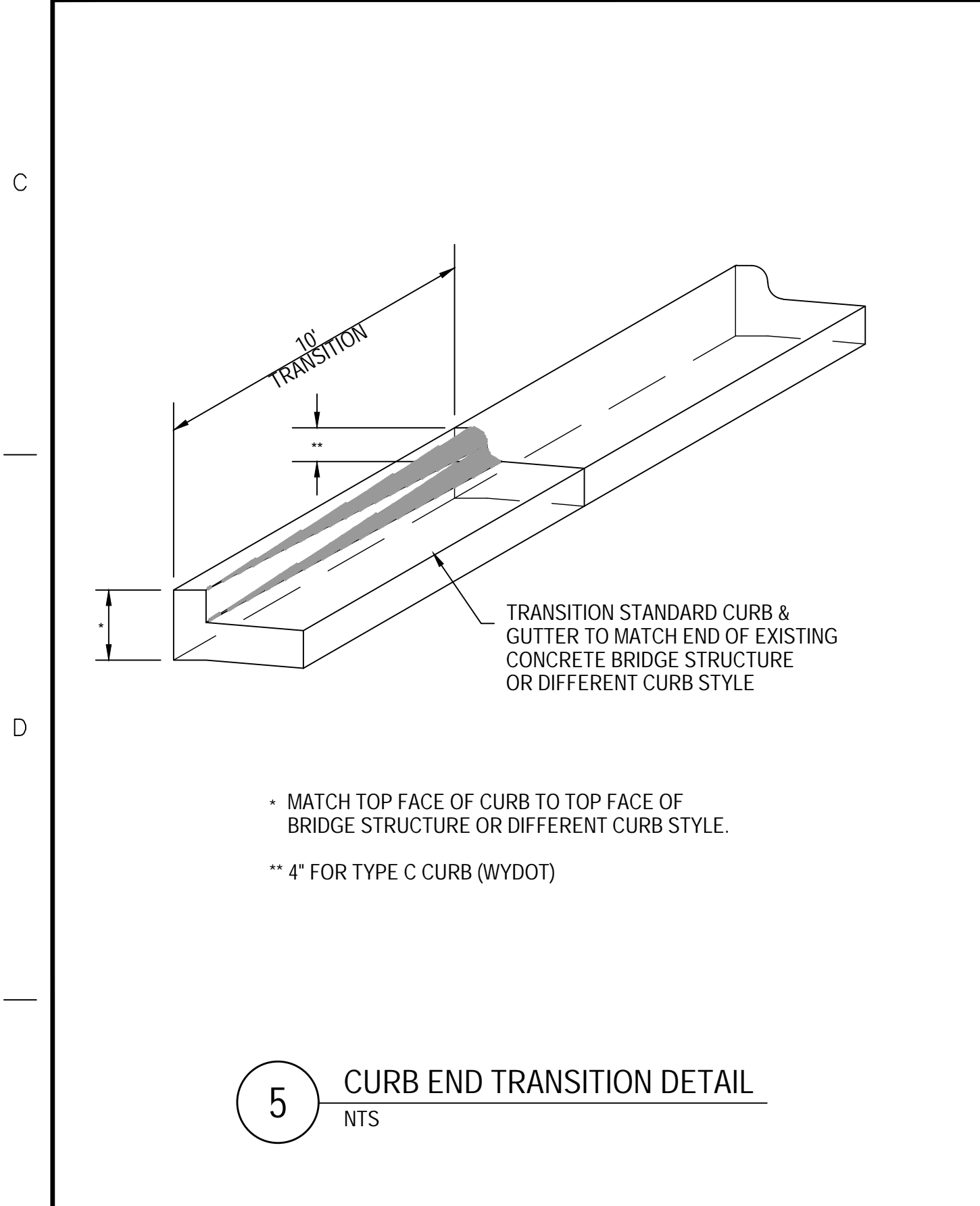
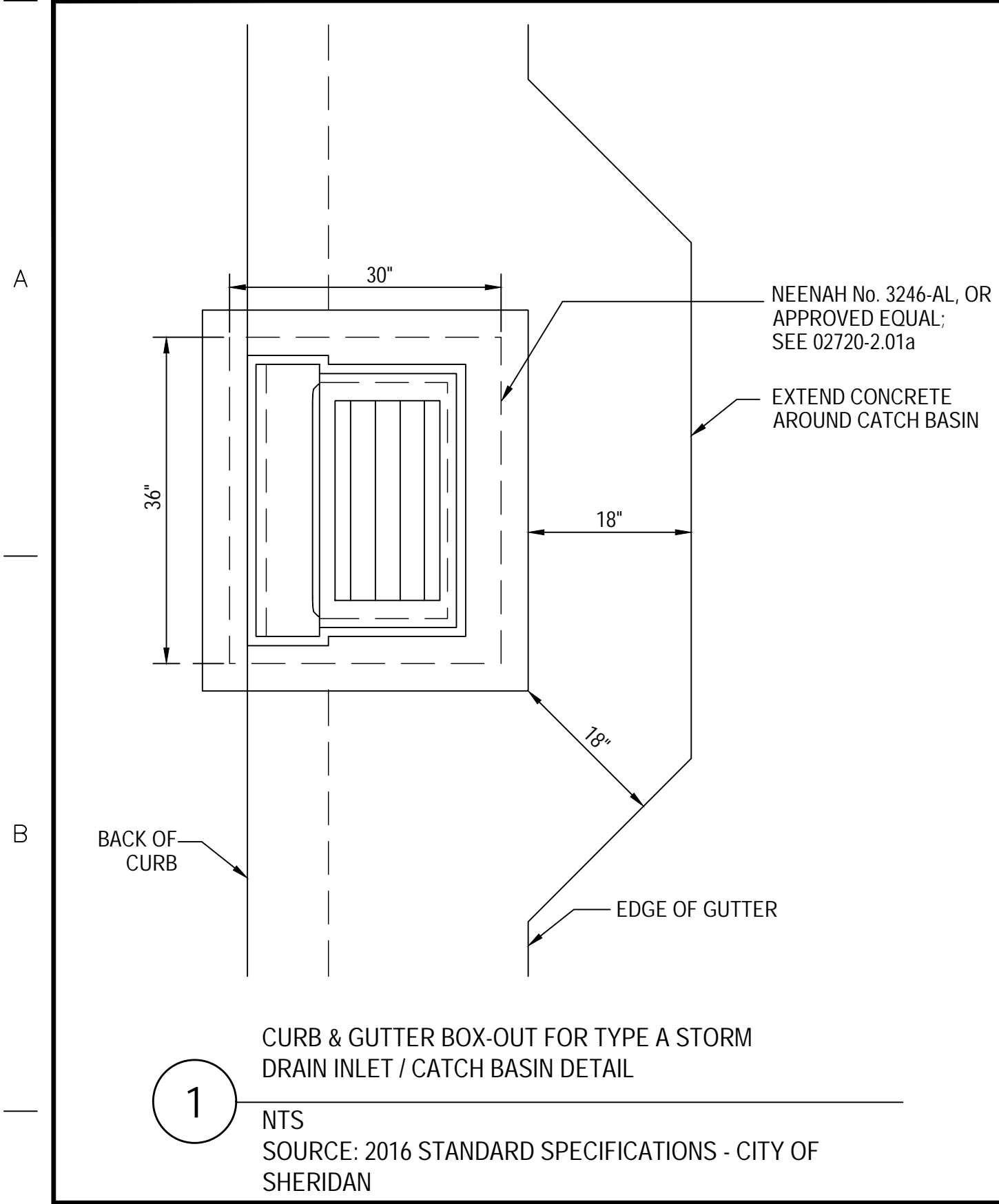
ONE INCH = TWO-HUNDRED FIFTY FEET
ONE INCH = TWO-HUNDRED FEET
ONE INCH = ONE-HUNDRED FEET
ONE INCH = THIRTY FEET



		CONSULTANTS:	<div>ARCHITECT/ENGINEERS:</div> <div><div><div>acela</div><div>architects + engineers</div><div>acela architects + engineers, pc 2633 Moravian Ave. Allentown, PA 18103</div><div>office: 610.365.4023 website: www.acela-ae.com email: info@acela-ae.com</div></div><div><div><div><div>Professional Engineer</div><div></div><div>Christopher W. Geary</div><div>PE# 17277</div></div></div></div></div>	<div>Drawing Title</div> <div>Construction Details</div> <div>-</div> <div>-</div> <div>Approved: Project Director</div> <div>-</div> <div>SHERIDAN VAHCS PLANNING AND ENGINEERING</div>	<div>Project Title</div> <div>Resurface Roads And Parking Lots</div> <div>-</div> <div>-</div> <div>Location</div> <div>Sheridan VA Medical Center</div> <div>Sheridan, WY</div> <div>Date</div> <div>6/14/2020</div> <div>Checked</div> <div>Geary</div> <div>Drawn</div> <div>Peters</div>	<div>Project Number</div> <div>666-17-104</div> <div>Building Number</div> <div>-</div> <div>Drawing Number</div> <div>CS289</div> <div>Dwg. 193 of 195</div>	<div>Office of Construction and Facilities Management</div> <div> Department of Veterans Affairs</div>
-	-						
-	-						
-	-						
Revisions:	Date						

acela
architects + engineers
acela architects + engineers, pc office: 610.365.4023
2633 Moravian Ave. website: www.acela-ae.com
Allentown, PA 18103 email: info@acela-ae.com

Christopher W. Geary PE# 17277

Parking Lot Signs

Recommendations

Position sign so drivers have a clear, unobstructed view of the sign. When placing this type of sign near curbs or parking places, be sure the sign is set far enough back that over hanging front and rear of automobiles do not come in contact with the sign post.



Government
Vehicles
Only



Reserved

**Employee
of the
Month**

- 1) Visitors Only
- 2) Buses Only
- 3) Authorized Vehicles Only
- 4) On Paved Road Only
- 5) Staff Only

- 1) Along Roadway
- 2) Any Time
- 3) Fire Lane
- 4) On the Grass
- 5) 00am - 00pm

- 1) Director
- 2) Chief of Staff
- 3) Volunteers
- 4) Consultant
- 5) Motorcycle Parking
- 6) Officer of the Day
- 7) Outpatient Only
- 8) Government Vehicle
- 9) Police Only
- 10) Car Pool

NTS

Parking Lot Signs

When placing this type of sign near curbs or parking places, be sure the sign is set far enough back that over hanging front and rear of automobiles do not come in contact with the sign post.



NIS

-	-
-	-
-	-
-	-
Revisions:	Date

--

acela
architects + engineers

acela architects + engineers, pc office: 610.365.4023
2633 Moravian Ave. website: www.acela-ae.com
Allentown, PA 18103 email: info@acela-ae.com

Christopher W. Geary PE# 17277

Drawing Title

Construction Details

—

—

Approved: Project Director

—

—

SHERIDAN VAHCS PLANNING AND ENGINEERING

Resources

<p>Resurface Roads And Parking Lots</p> <p>—</p> <p>—</p>		
<p>Location</p> <p>Sheridan VA Medical Center</p> <p>Sheridan, WY</p>		
<p>Date</p> <p>6/14/2020</p>	<p>Checked</p> <p>Geary</p>	<p>Drawn</p> <p>Peters</p>

Building Number
-

Drawing Number
000000

Dwg.194 of 195

Office of
Construction
and Facilities
Management

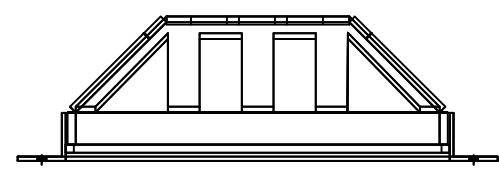
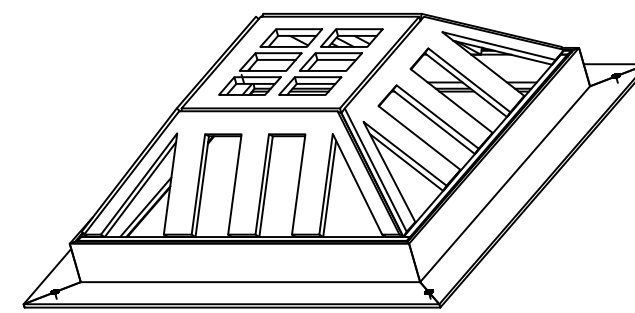
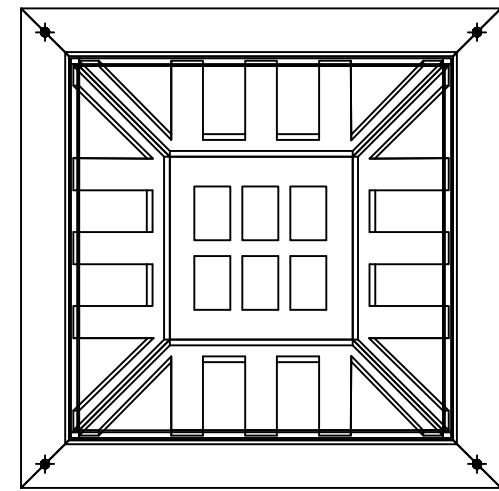

NOTES

1. TRASH RACK FOR INSTALL ON INLET 11 ONLY. REPLACE CONCRETE LID WITH TRASH RACK.
2. PRIOR TO ORDERING AND INSTALLING TRASH RACK, CONTRACTOR SHALL FIELD VERIFY DIMENSIONS OF STRUCTURE TO ENSURE PROPER COVERAGE. SHOP DRAWING OF TRASH RACK SHALL BE PROVIDED TO ENGINEER FOR APPROVAL PRIOR TO CONSTRUCTION.

NT

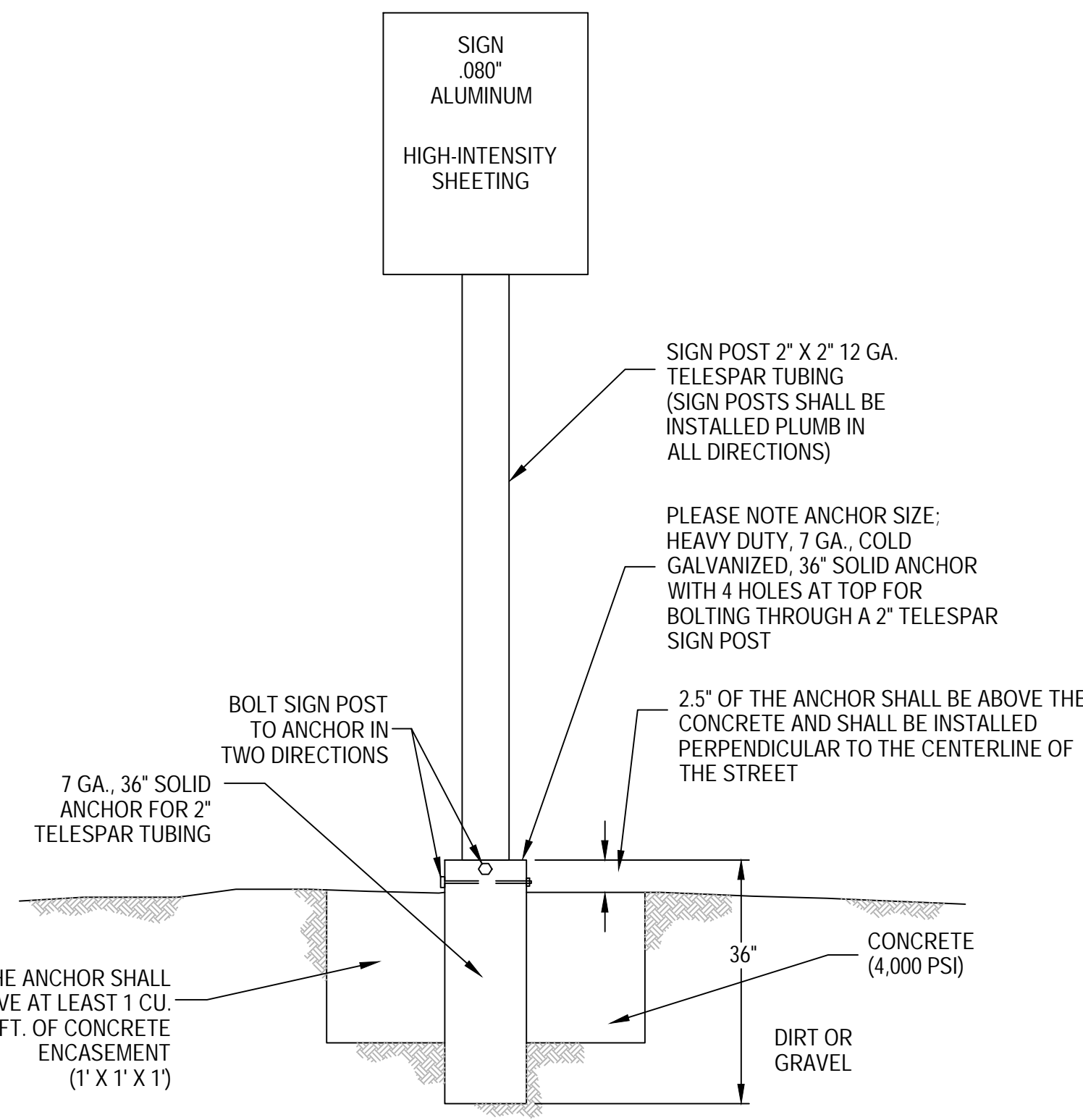

0 NTS

NTS

SOURCE: 2016 STANDARD SPECIFICATIONS-CITY OF SHERIDAN

1. WORK ACTIVITY ON OR ADJACENT TO THE TRAVELED WAY THAT MAY AFFECT THE TRAVELING. PUBLIC OR WORKERS SHALL NOT COMMENCE UNTIL ALL NECESSARY CONSTRUCTION TRAFFIC CONTROL DEVICES ARE IN PLACE AND APPROVED BY THE ENGINEER. (CONSTRUCTION TRAFFIC CONTROL DEVICES SHALL INCLUDE SIGNS, BARRICADES, CHANNELIZING DEVICES, STRIPING, ETC.)
2. ALL SIGNS SHALL BE STAND-MOUNTED AND KEPT CLEAN, LEGIBLE AND MAINTAIN REFLECTIVITY.
3. FLASHERS SHALL BE INSTALLED AND IN WORKING ORDER ON ALL WC-4S AND BARRELS.
4. ONLY TWO BLOCKS SHALL BE CLOSED AT A TIME UNLESS APPROVED BY THE CITY OF SHERIDAN.
5. ALL CONSTRUCTION SITES SHOULD BE CHECKED PERIODICALLY, DAY AND NIGHT, TO ENSURE ADEQUATE TRAFFIC CONTROL.
6. ALL CONSTRUCTION TRAFFIC CONTROL DEVICE SPACING IS APPROXIMATE AND SHOULD BE ADJUSTED TO FIT FIELD CONDITIONS. ROADWAY CONDITIONS, OBSTACLES, GEOMETRICS AND PERMANENT SIGNING SHOULD BE CONSIDERED IN PLACEMENT OF CONSTRUCTION SIGNS AND / OR FLAGGERS, TO PROVIDE MAXIMUM VISIBILITY OF WARNING DEVICES TO ONCOMING MOTORISTS.
7. ADDITIONAL CONSTRUCTION TRAFFIC CONTROL DEVICES MAY BE ADDED AS CONDITIONS WARRANT.
8. ALL CONSTRUCTION TRAFFIC CONTROL DEVICES REQUIRED FOR THE CONSTRUCTION PROJECT SHALL BE FURNISHED AND INSTALLED BY THE CONTRACTOR. REPLACEMENT DEVICES SHALL BE AVAILABLE AS REQUIRED. DEVICES SHALL BE MAINTAINED IN A STATE OF GOOD REPAIR BY THE CONTRACTOR.
9. ALL CONSTRUCTION TRAFFIC CONTROL DEVICES REQUIRED, INCLUDING ALL POSTS AND SIGNS, SHALL COMPLY WITH ALL REQUIREMENTS OF THE CURRENT EDITION OF THE MANUAL ON UNIFORM TRAFFIC CONTROL DEVICES.
10. EXISTING TRAFFIC CONTROL DEVICES CONFLICTING WITH THESE TRAFFIC CONTROL PLANS SHALL BE COVERED OR REMOVED AS DIRECTED BY THE ENGINEER AND RETURNED TO THEIR PREVIOUS LOCATIONS AS NEEDED.
11. CONSTRUCTION TRAFFIC CONTROL DEVICES SHALL BE REMOVED OR COVERED WHEN NOT NEEDED.
12. PORTABLE SIGN SUPPORTS AND BARRICADES TURNED AWAY FROM THE ROADWAY AND NOT REMOVED AT LEAST 30 FEET FROM THE EDGE OF THE TRAVELED WAY SHALL HAVE A TYPE II OBJECT MARKER VISIBLE TO ALL APPROACHING TRAFFIC.
13. WHEN CONSTRUCTION CEASES DURING THE WINTER, ANY CONSTRUCTION TRAFFIC CONTROL DEVICES, INCLUDING POSTS UNNEEDED AT THIS TIME, SHALL BE REMOVED. REQUIRED DEVICES SHALL BE MAINTAINED THROUGHOUT THE WINTER.
14. ALL CONSTRUCTION MATERIALS AND EQUIPMENT SHALL BE STORED IN AREAS AS FAR FROM THE USABLE TRAVELED WAY AS POSSIBLE (30 FEET MINIMUM).
15. ADDITIONAL WARNING LIGHTS MAY BE REQUIRED ON CONSTRUCTION TRAFFIC CONTROL DEVICES FOR ADDITIONAL EMPHASIS AT NIGHT. ONLY STEADY BURN WARNING LIGHTS SHALL BE USED ON TAPERS. DRUMS WITH ARROWS SHALL BE USED ON TAPERS, AND DRUMS WITHOUT ARROWS SHALL BE USED ON TANGENTS. SIGNS AND CHANNELIZING DEVICES SHALL BE REFLECTORIZED WHEN USED AT NIGHT.
16. ADDITIONAL FLAGGERS MAY BE UTILIZED AT THE DISCRETION OF THE CONTRACTOR. ADDITIONAL WARNING SIGNS FOR THE FLAGGERS SHALL THEN BE INSTALLED. LIGHTING SHALL BE PROVIDED IF FLAGGERS ARE UTILIZED DURING HOURS OF DARKNESS.
17. ALL DRUMS USED FOR TEMPORARY TRAFFIC CONTROL SHALL BE PLASTIC AND MEET ALL REQUIREMENTS OF THE CURRENT EDITION OF THE MANUAL ON UNIFORM TRAFFIC CONTROL DEVICES.
18. IN URBAN AREAS, PEDESTRIAN SAFETY AND MOVEMENTS SHALL BE CONSIDERED WHEN PLACING TRAFFIC CONTROL DEVICES.
19. THE ENGINEER RESERVES THE RIGHT TO ADD, DELETE OR MODIFY ANY CONSTRUCTION TRAFFIC CONTROL DEVICE OR SETUPS AS REQUIRED TO COMPLY WITH THE MANUAL ON UNIFORM TRAFFIC CONTROL DEVICES AND TO PROVIDE FOR THE SAFETY OF TRAVELING MOTORISTS OR PEDESTRIANS.
20. ANY ADDITIONS OR MODIFICATIONS TO TRAFFIC CONTROL WILL BE AT DISCRETION OF COR AT THE CONTRACTORS EXPENSE.
21. IF THERE IS CONFLICTING INFORMATION BETWEEN THE CITY OF SHERIDAN TRAFFIC CONTROL SPECIFICATIONS AND WYDOT TRAFFIC CONTROL SPECIFICATIONS, WYDOT SHALL GOVERN.

