

D

C

B

A

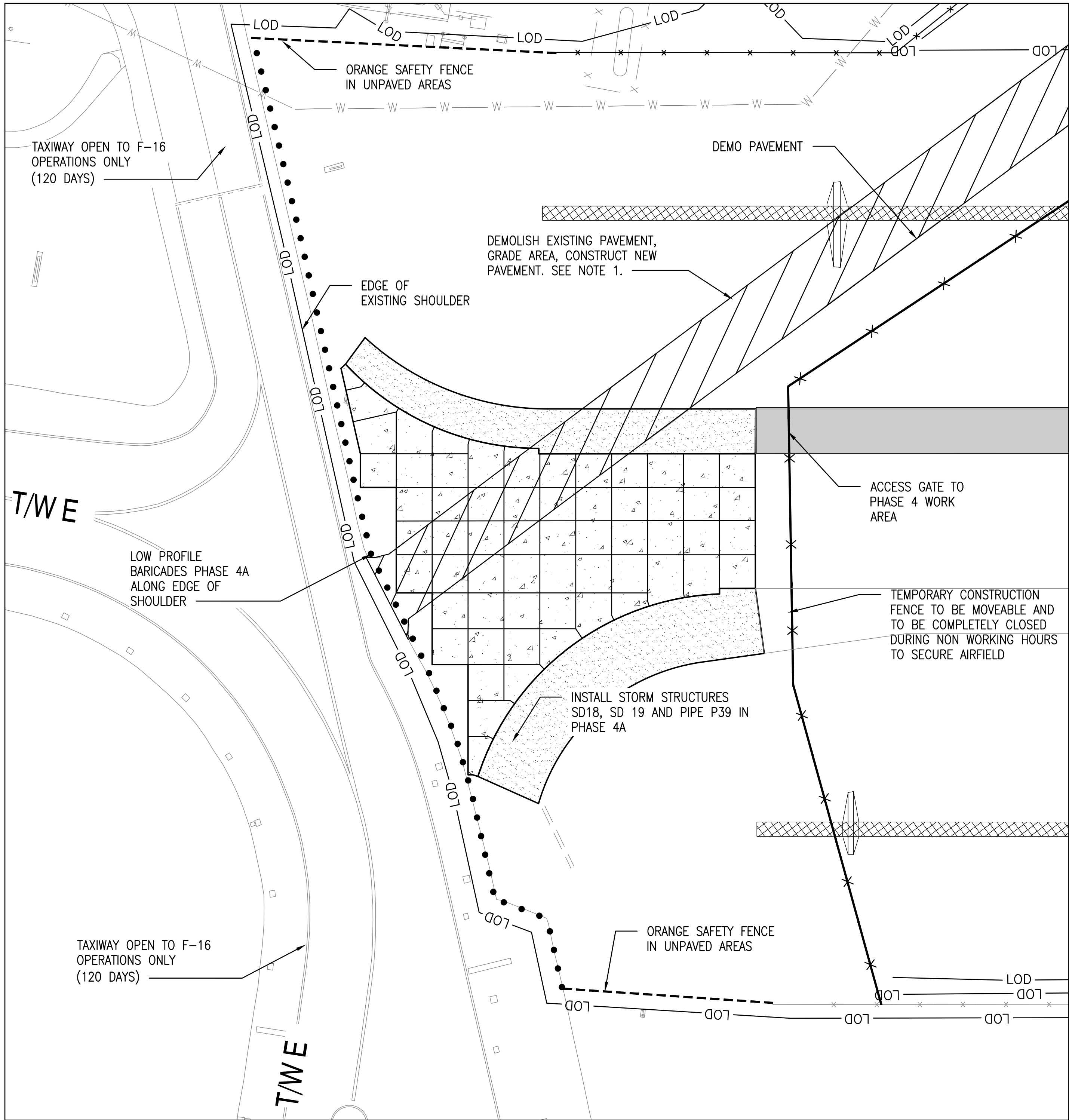

PHASE 4A ACTIVITIES

- CLOSE TAXIWAY 120 DAYS TOTAL FOR PHASE 4A AND 4B, INSTALL LOW PROFILE BARRICADES AND ORANGE SAFETY FENCE.
- MOVE SECTION OF TEMPORARY FENCE TO ACCESS WORK AREA ADJACENT TO TAXIWAY BY THE GATE.
- DEMOLISH PAVEMENT FOR TAXIWAY CONNECTOR UP TO EDGE OF EXISTING SHOULDER.
- GRADING FOR TAXIWAY SECTIONS.
- REMOVE EXISTING STORM SEWER PIPE AND REPLACE PER THIS PLAN.
- PAVE SECTION OF TAXIWAY. (COORDINATE WITH PHASE 4B PHASING)
- STRIPING, SEEDING, ALL CLEANUP WORK WITHIN 125-FT OF TW E/F.
- COMPELETE FOD CHECK AND INSPECTION BY 89 OSS AND COR PRIOR TO REOPENING TAXIWAYS FOR TRAFFIC. ALL AIRFIELD PAVEMENTS TO BE OPEN TO AIRCRAFT TRAFFIC BY NOV 5TH AND NOT CLOSED UNTIL AFTER MARCH 1ST.
- PROVIDE FULL TIME ACTIVE STREET SWEEPER/VACUUM TRUCK ON EXISTING AIRFIELD TO CONTROL FOD. NO CONSTRUCTION VEHICLES ON THE EXISTING AIRFIELD PAVEMENTS.

PHASE 4A ENLARGED PLAN (120 DAYS)

PHASE 4B ACTIVITIES

- CLOSE TAXIWAY TO ALL AIRCRAFT OPERATIONS.
- MOVE LOW PROFILE BARRICADES AND ORANGE SAFETY FENCE.
- DEMOLISH TAXIWAY AND SHOULDER PAVEMENT.
- REGRADE SUBGRADE, PAVE TAXIWAY CONCRETE AND ASPHALT.
- INSTALL STRIPING, EDGE LIGHTS, AND OTHER ITEMS WITHIN AREA.
- COMPELETE FOD CHECK AFTER MOVING BARRICADES PRIOR TO REOPENING TAXIWAY FOR F-16 OPERATIONS.

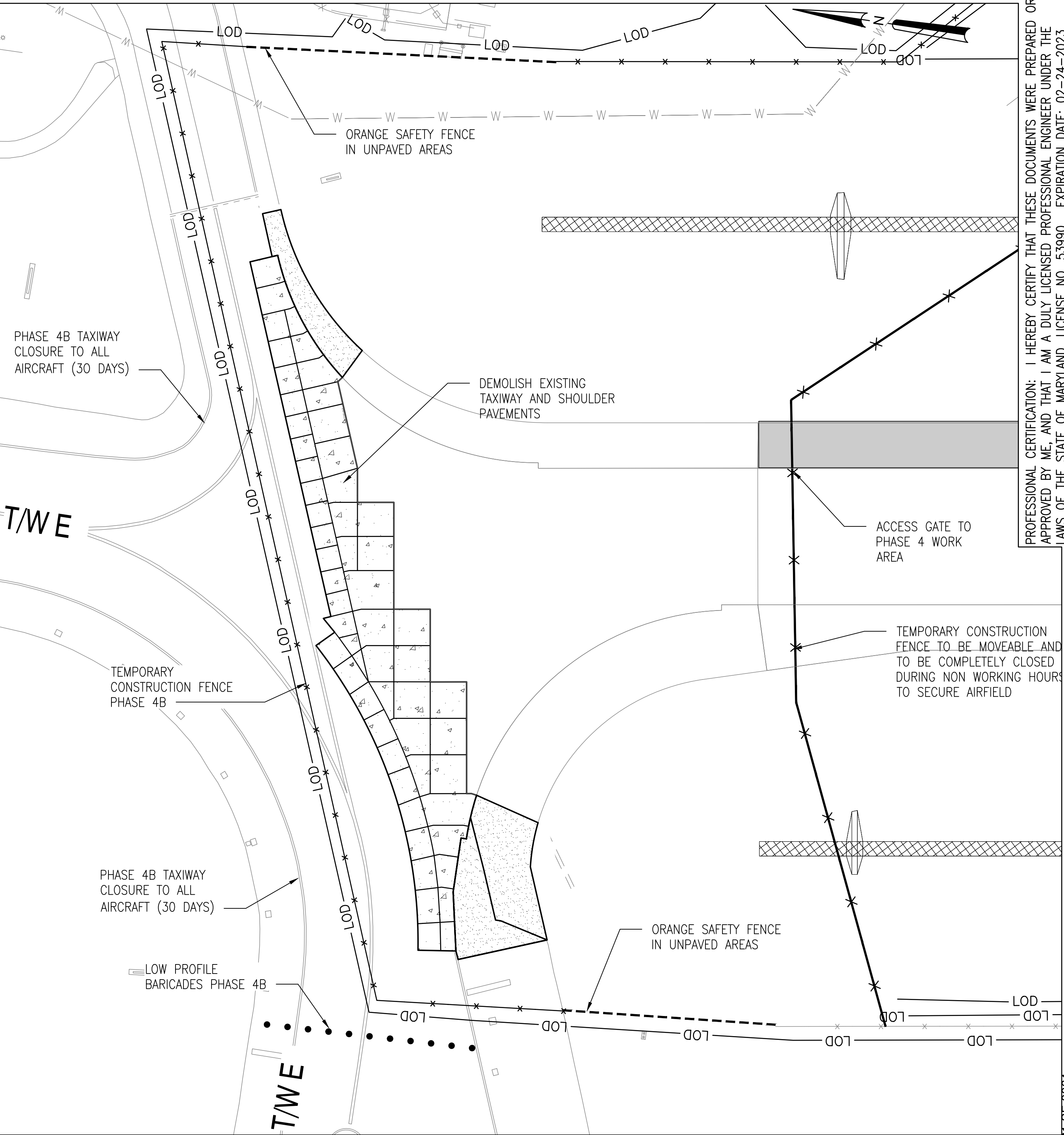

PHASE 4B ENLARGED PLAN (30 DAYS)

LEGEND

- TEMPORARY CONSTRUCTION FENCE (C1 GI-501)
- ORANGE SAFETY FENCE (C4 GI-502)
- SECURITY GUARD (SEE NOTE 8) (SG)
- TEMPORARY CONSTRUCTION ENTRANCE (A4 GI-501)
- LOW PROFILE BARRICADES (C1 GI-502)

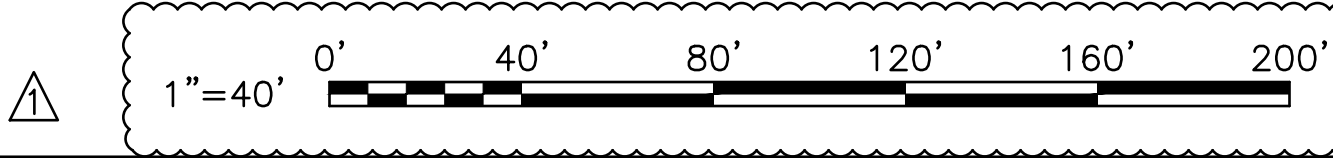

PROFESSIONAL CERTIFICATION: I HEREBY CERTIFY THAT THESE DOCUMENTS WERE PREPARED OR APPROVED BY ME, AND THAT I AM A DULY LICENSED PROFESSIONAL ENGINEER UNDER THE LAWS OF THE STATE OF MARYLAND, LICENSE NO. 53990 , EXPIRATION DATE: 02-24-2023.



WileyWilson | BURNS & MCDONNELL
JOINT VENTURE

APPROVED: _____
FOR COMMANDER NAVFAC: _____
ACTIVITY: _____
SATISFACTORY TO: _____ DATE: _____
DES: _____ DRW: _____ CHK: _____
PAIDM: _____
BRANCH MANAGER: _____
CHIEF ENGINEER: _____
FIRE PROTECTION: _____

DEPARTMENT OF THE NAVY
NAVAL FACILITIES ENGINEERING COMMAND ~ WASHINGTON, DC
WASHINGTON NAVY YARD
JOINT BASE ANDREWS NAVAL AIR FACILITY CAMP SPRINGS, MD
P-3002 RELOCATE HAZARDOUS CARGO PAD AND EOD PROFICIENCY RANGE
CONSTRUCTION PHASING PLAN - PHASE 4A & 4B

SCALE: AS NOTED
PROJECT NO.: 1396650
CONSTR. CONTR. NO.: N40080-22-R-8580
NAVFAC DRAWING NO.: 13140288
SHEET 18 OF 229
GI-115

DRAWING REVISION: 06 APRIL 2017

D

C

B

A