

<b>AMENDMENT OF SOLICITATION/MODIFICATION OF CONTRACT</b>				1. CONTRACT ID CODE		PAGE OF PAGES 1   55	
2. AMENDMENT/MODIFICATION NO. <b>0001</b>		3. EFFECTIVE DATE <b>30-Aug-2023</b>		4. REQUISITION/PURCHASE REQ. NO.		5. PROJECT NO.(If applicable)	
6. ISSUED BY U. S. ARMY ENGINEER DISTRICT, LOUISVILLE 600 DR. MARTIN LUTHER KING, JR. PLACE ROOM 821 LOUISVILLE KY 40202-2239		CODE <b>W912QR</b>		7. ADMINISTERED BY (If other than item 6) CIVIL/OPS/ENVIRONMENTAL BR ATTN: AMY M PHILLIPS 600 DR M L KING JR PL RM 821 LOUISVILLE KY 40202-2236		CODE <b>W912QR</b>	
8. NAME AND ADDRESS OF CONTRACTOR (No., Street, County, State and Zip Code)				X		9A. AMENDMENT OF SOLICITATION NO. <b>W912QR23Q0105</b>	
				X		9B. DATED (SEE ITEM 11) <b>16-Aug-2023</b>	
						10A. MOD. OF CONTRACT/ORDER NO.	
						10B. DATED (SEE ITEM 13)	
CODE		FACILITY CODE					
<b>11. THIS ITEM ONLY APPLIES TO AMENDMENTS OF SOLICITATIONS</b>							
<input checked="" type="checkbox"/> The above numbered solicitation is amended as set forth in Item 14. The hour and date specified for receipt of Offer <input type="checkbox"/> is extended, <input checked="" type="checkbox"/> is not extended. Offer must acknowledge receipt of this amendment prior to the hour and date specified in the solicitation or as amended by one of the following methods: (a) By completing Items 8 and 15, and returning <u>1</u> copies of the amendment; (b) By acknowledging receipt of this amendment on each copy of the offer submitted; or (c) By separate letter or telegram which includes a reference to the solicitation and amendment numbers. FAILURE OF YOUR ACKNOWLEDGMENT TO BE RECEIVED AT THE PLACE DESIGNATED FOR THE RECEIPT OF OFFERS PRIOR TO THE HOUR AND DATE SPECIFIED MAY RESULT IN REJECTION OF YOUR OFFER. If by virtue of this amendment you desire to change an offer already submitted, such change may be made by telegram or letter, provided each telegram or letter makes reference to the solicitation and this amendment, and is received prior to the opening hour and date specified.							
<b>12. ACCOUNTING AND APPROPRIATION DATA (If required)</b>							
<b>13. THIS ITEM APPLIES ONLY TO MODIFICATIONS OF CONTRACT ORDERS. IT MODIFIES THE CONTRACT/ORDER NO. AS DESCRIBED IN ITEM 14.</b>							
A. THIS CHANGE ORDER IS ISSUED PURSUANT TO: (Specify authority) THE CHANGES SET FORTH IN ITEM 14 ARE MADE IN THE CONTRACT ORDER NO. IN ITEM 10A.							
B. THE ABOVE NUMBERED CONTRACT/ORDER IS MODIFIED TO REFLECT THE ADMINISTRATIVE CHANGES (such as changes in paying office, appropriation date, etc.) SET FORTH IN ITEM 14, PURSUANT TO THE AUTHORITY OF FAR 43.103(B).							
C. THIS SUPPLEMENTAL AGREEMENT IS ENTERED INTO PURSUANT TO AUTHORITY OF:							
D. OTHER (Specify type of modification and authority)							
E. IMPORTANT: Contractor <input type="checkbox"/> is not, <input type="checkbox"/> is required to sign this document and return _____ copies to the issuing office.							
<b>14. DESCRIPTION OF AMENDMENT/MODIFICATION (Organized by UCF section headings, including solicitation/contract subject matter where feasible.)</b>  Solicitation W912QR23Q0105 for the Rehab of the USACE Resident Office in Indianapolis, IN, is hereby modified as follows:  SEE BLOCK 14 CONTINUATION PAGE "AMDT 0001 - SUMMARY OF CHANGES"							
Except as provided herein, all terms and conditions of the document referenced in Item 9A or 10A, as heretofore changed, remains unchanged and in full force and effect.							
15A. NAME AND TITLE OF SIGNER (Type or print)				16A. NAME AND TITLE OF CONTRACTING OFFICER (Type or print)			
				TEL: _____ EMAIL: _____			
15B. CONTRACTOR/OFFEROR		15C. DATE SIGNED		16B. UNITED STATES OF AMERICA		16C. DATE SIGNED	
_____ (Signature of person authorized to sign)				BY _____ (Signature of Contracting Officer)			

## SECTION SF 30 BLOCK 14 CONTINUATION PAGE

## SUMMARY OF CHANGES

## SECTION SF 30 - BLOCK 14 CONTINUATION PAGE (SF 30)

The following have been added by full text:

AMDT 0001 - SUMMARY OF CHANGES

A) **AMENDED SOLICITATION SECTIONS:** The following Solicitation Sections have been revised. The revised sections are enclosed hereunder and replace the previously furnished sections.

- a. **00 10 00 Scope of Work:** revisions are marked \*\*\*AMDT 0001\*\*\* and highlighted in yellow.
- b. **00 73 00 Supplementary Conditions:** Wage Determination IN20230002 has been revised to the current modification dated 08/25/2023, Mod. No. 13, and must be adhered to.

B) **CONTRACTOR INQUIRIES:** By this Amendment, USACE Louisville District, responds to Contractor inquiries as follows:

**Inquiry #1: Window & Door Flashing:** The solicitation doesn't explicitly address the installation of flashing around windows and doors. Should we assume that flashing is a part of the work scope to prevent water intrusion around these openings?

**USACE RESPONSE TO INQUIRY #1:** Not all siding is being removed and replaced on the subject building. Flashing should be replaced if it is damaged in either the removal and replacement of the siding that is being replaced or if the existing flashing has been damaged from the original installation of the flashing and/or siding. Replace flashing in-kind with the existing flashing.

**Inquiry #2: Moisture Barrier Inspection:** Will we be required to inspect the existing sheathing for water damage before installing the new moisture barrier and siding? If damage is found, should we consider replacing the sheathing within our proposal?

**USACE RESPONSE TO INQUIRY #2:** Yes, the existing sheathing that is exposed from removal of the existing siding should be inspected prior to the installation of the moisture barrier and new siding. Please figure in 25% of the sheathing to be replaced (as compared to the quantity of siding materials) prior to the installation of the moisture barrier and siding.

**Inquiry #3: Siding Fasteners:** Are there any specific fasteners you require or recommend for the cement board siding?

**USACE RESPONSE TO INQUIRY #3:** Utilize fasteners as required by the cementitious siding material manufacturer. Government recommends 6D or 8D nails for which holes are pre-drilled so that the nails do not damage the siding materials when hammered into place. Government requires galvanized or stainless-steel fasteners for longevity and rust prevention purposes.

**Inquiry #4: Paint Specifications:** While the solicitation mentions matching the current color of the building, it doesn't specify the type or quality of paint. Do you have specific brand or quality requirements for this? If prefinished product colors are an option associated labor costs would be lower.

**USACE RESPONSE TO INQUIRY #4:** We are not aware that prefinished product colors are an option that would match well with the new paint color. The intent is that the entirety of the building should be painted, not just the areas of the replaced siding. Please incorporate an acrylic latex paint into your pricing scheme from any reputable paint manufacturer for the cementitious siding. The gas line will require cleaning per the paint manufacturer's requirements or with mineral spirits or denatured alcohol and prepped with the recommended primer before getting two finish coats of acrylic latex paint.

**Inquiry #5: Material Specifications:** The solicitation mentions cement board siding and aluminum gutters, but not other materials like caulk or house wrap. Should we follow the manufacturer's recommendation or are there specific products you recommend or require?

**USACE RESPONSE TO INQUIRY #5:** A moisture barrier/house wrap is required by the Scope of Work, but only behind cementitious siding specified to be replaced as part of this project. Paintable silicone or urethane caulk will be required to fill all openings/cracks/joints in installed or new siding materials and shall also be applied to existing openings/cracks/joints in existing siding materials as preparation prior to painting the entirety of the existing facility. Follow the manufacturer installation instructions for all products being installed, unless there is a conflict with the requirements of the Scope of Work, then the Scope of Work takes precedence.

**Inquiry #6: Clarification on Roof Repair:** The solicitation alludes to roof repair in two locations, but details are sparse. Can you provide a more detailed description of what this repair should encompass?

**USACE RESPONSE TO INQUIRY #6:** There is water infiltrating through the roof and into the building at two locations. Contractor is required to locate the leaks and repair or patch the EPDM roofing materials at the leak locations.

**INQUIRY #7: Projected Construction Cost:** The document indicates that "The estimated construction cost is less than \$25,000.00 per FAR 36.204." We want to ensure that our bid is competitive and aligns with your expectations. Could you provide some clarity if this is a specific budgetary constraint we should be aware of?

**USACE RESPONSE TO INQUIRY #7:** Please reference FAR 36.204 and the requirements therein. That FAR clause provides ranges that the Government is required to provide to bidders to give them an idea of what the Government believes the Scope of Work equates to when they conducted an estimate of their own. This is not budgetary figure. Contractor is required to provide their own pricing and to estimate the value of the work for bidding purposes in order to provide a lump sum quote to the Government for the work described in the Scope of Work for this project.

- C) The due for receipt of offer is **not** extended as a result of this amendment.
- D) All amendments **must** be acknowledged at the time offers are due.
- E) All other terms and conditions remain unchanged.

## SECTION 00 10 00 - SOLICITATION

The following have been modified:

SCOPE OF WORK

**Rehab of Resident Office USACE  
9837 Beaumont Rd. Indianapolis, IN 46216  
Scope of Work  
Amendment 0001  
29 August 2023**

**Description of Work:**

The contractor shall furnish all labor, materials, supplies and equipment necessary to complete the contract. The contractor shall remove damaged/weather-beaten James Hardie Siding and replace it with new cement board siding of at least the thickness of the material being replaced, along with New House Wrap Moisture Barrier behind all new cement board on the USACE Resident Office 9837 Beaumont Rd. Indianapolis, IN 46216. Quoted price by contractor must be inclusive of all materials, labors, supply, and installation in place to complete the work.

The contractor shall remove all damaged and weathered fiber cement trim boards and siding panels (see picture attachments A-M through L-M). Replace and match within kind new siding (material and thickness), and trim on the USACE Resident Office USACE

AMDT 0001\*\*\*\*\*

**The gas piping will need to be properly cleaned with mineral spirits or denatured alcohol and prepped with the recommended primer before getting two finish coats of acrylic latex paint.**

\*\*\*\*\* AMDT 0001

In addition to the above scope of work contractor shall add/ Install new gutters EPDM-005 in accordance with detail (see Attachment M-M) on both sides of the building (the North and South Sides), as well as over the entry door on the East side of the building. Place downspouts with concrete splash blocks to drain the gutter sections. Add 25 feet to the North side of the building (facing parking lot), extending the EPDM Roofing materials over into the gutter sections and run gutter to the NE corner of the building (nearest Beaumont Road). New Gutters (see Attachment M-M) must be installed with ½ slope per 10 feet length All debris shall be removed from the property and disposed of in accordance with the Indiana Environmental Protection Agency (IEPA) regulations. After replacement of siding, contractor shall caulk and paint the entirety of the building both existing new siding, to match the current color of the building as closely to the original as is available and must be approved by the Contracting Officer's Representative (COR) prior to installation. Each panel shall be whole pieces with no cracks, holes, or damages. The siding once installed/replaced shall seal the building to be protected from water intrusion or animal entry.

Remove old Trim and install new 4" tall Fiber Cement Trim boards all around the building above the windows where there is no gutter added. The color of trim shall match the existing siding and must also be approved by the COR.

The material of new gutters (see Attachment M-M) will be Aluminum and coated to match the existing siding. The gutter shall perform (when in use) in the same way as it presently performs during rainfall.

Contractor shall also include in this scope of work two (2) separate roof repair locations for the current EPDM materials that makes the up the roof of the existing building. Seal/caulk many of existing joints and then repaint our modular office building its current color.

Roof repair is included where needed on actual basis. Seal/caulk many of the existing joints and then repaint our modular office building in its current color.

AMDT 0001\*\*\*\*\*  
 Special care must be taken to ensure that the building is not left unsecured during installation of the siding.

Not all siding is being removed and replaced on the subject building. Flashing should be replaced if it is damaged in either the removal and replacement of the siding that is being replaced or if the existing flashing has been damaged from the original installation of the flashing and/or siding. Replace flashing in-kind with the existing flashing.

The existing sheathing that is exposed from removal of the existing siding should be inspected prior to the installation of the moisture barrier and new siding. Please figure in 25% of the sheathing to be replaced (as compared to the quantity of siding materials) prior to the installation of the moisture barrier and siding.

Utilize fasteners as required by the cementitious siding material manufacturer. Government recommends 6D or 8D nails for which holes are pre-drilled so that the nails do not damage the siding materials when hammered into place. Government requires galvanized or stainless-steel fasteners for longevity and rust prevention purposes.

A moisture barrier/house wrap is required by the Scope of Work, but only behind cementitious siding specified to be replaced as part of this project. Paintable silicone or urethane caulk will be required to fill all openings/cracks/joints in installed or new siding materials and shall also be applied to existing openings/cracks/joints in existing siding materials as preparation prior to painting the entirety of the existing facility. Follow the manufacturer installation instructions for all products being installed, unless there is a conflict with the requirements of the Scope of Work, then the Scope of Work takes precedence.

There is water infiltrating through the roof and into the building at two locations. Contractor is required to locate the leaks and repair or patch the EPDM roofing materials at the leak locations.

\*\*\*\*\*AMDT 0001

**Building Dimensions:** Resident Office dimension estimate is 72-0'x31'-1". Dimensions are approximate and should be verified by potential contractor prior to bid (see Attachments M-M and N-M).

**Contract Start and Completion Dates:** All work under this contract will began within 10 calendar days from Notice to proceed (NTP) and complete with 120 calendar days from NTP.

#### **Technical Point of Contact (TPOC):**

Paramjitinder (PJ) Dhillon  
 (o): 719-366-9467  
 (m): 317-494-0155  
 (e): [paramjitinder.s.dhillon@usace.army.mil](mailto:paramjitinder.s.dhillon@usace.army.mil)

**Site Access:** Contractor will need to coordinate with the installation Access Control (IAP) office to obtain authorized access. See security contact info below\*:

Security Contact Info:  
 Security Officer at the Army Installation  
 MAJ. Benjamn Gaul  
 Phone:719-366-9258

\*Contractors may also reach out to the TPOC above if they are unable to reach the Security Officer.

#### **Required Security Training and Planning:**

1. **General security requirements and guidance:** The security requirements described below apply to all contract personnel (including employees of the prime Contractor ("Contractor") and all subcontractor employees) supporting the performance requirements of this contract. The Contractor is responsible for compliance with these security requirements. Questions regarding security matters shall be addressed to the

designated Government representative (e.g., Contracting Officer Representative (COR), Requiring Activity (RA) representative, or Contracting Officer (if a COR or other RA representative is not appointed)). Contract personnel are critical to the overall security and safety of US Army Corps of Engineers (USACE) installations, facilities and activities, and security awareness training contributes to those efforts. The Department of Defense (DoD) and Army security training requirements specified below, if applicable, are performance requirements; all applicable contract personnel shall complete initial training within 30 days of contract award or the date new contract personnel begin performance on the contract. Within five business days from the completion of training, the Contractor shall provide written documentation (e.g., email or memorandum) to the Government representative. The documentation shall include the names of contract personnel trained and which training they completed; the Contractor shall maintain training records as part of their contract files and be prepared to provide copies of training certificates to the Government representative. Contractor personnel and vehicles are subject to search when entering federal installations. Additionally, all contract personnel shall comply with Force Protection Condition (FPCON) measures, Random Antiterrorism Measures (commonly referred to as "RAMs"), and Health Protection Condition (HPCON) measures. The Contractor is responsible for meeting performance requirements during elevated FPCON and/or HPCON levels in accordance with applicable RA plans and procedures --this includes identifying mission essential and non-mission essential personnel. In addition to the changes otherwise authorized by the changes clause of this contract, should the FPCON or HPCON levels at any individual facility or installation change, the Government may implement security changes that affect contract personnel. The Contractor shall ensure all contract personnel are aware of their security responsibilities, including any site-specific requirements identified in local policies or procedures.

2. **Physical security and access control requirements:** All contract personnel requiring physical access to a federal installation or facility shall comply with the access control procedures of that location. Contract personnel requiring unescorted access to meet contract performance requirements on a DoD installation in the US shall be vetted by the installation/facility Provost Marshal/Directorate of Emergency Services/Security Office using the National Crime Information Center-Interstate Identification Index (commonly referred to as "NCIC-III") and Terrorist Screening Database (commonly referred to as "TSDB"). Contract personnel shall comply with all personal identity verification requirements specified in installation/facility policies and procedures. Contract personnel who do not meet requirements for unescorted access to USACE facilities shall coordinate escorted access with the Government representative, as needed. Contract personnel who receive keys, access cards, or lock combinations that provide access to government-owned property shall comply with key and lock control procedures of the RA.
3. **Suspicious Activity Reporting training (e.g. iWATCH, Corps Watch, or See Something, Say Something):** All contract personnel shall receive initial and annual refresher training from the RA representative on the local suspicious activity reporting program. This locally developed training provides contract personnel with general information on suspicious behavior, and guidance on reporting suspicious activity to the project manager, security representative or law enforcement entity.
4. **Pre-screen candidates using E-Verify Program:** Contractors shall comply with the requirements set forth in FAR clause 52.222-54 Employment Eligibility Verification and FAR Subpart 22.18 in using the E-Verify Program at (<https://www.e-verify.gov/>) (website subject to change) to meet the contract employment eligibility requirements. Contractors are encouraged to cooperate with Federal and State agencies responsible for enforcing labor requirements to include eligibility for employment under United States immigration laws in accordance with FAR 22.102-1(i). An initial list of verified/eligible candidates shall be provided to the COR no later than three business days after the initial contract award. When contracts are with individuals, the individuals will be required to complete a Form I-9, Employment Eligibility Verification, and submit it to the Contracting Officer to become part of the official contract file.

## ATTACHMENTS

### ATTACHMENTS (A-M)



1. Gutter at Top 25 Feet from front Right corner to left of Entry Door. ½ Inch slope per 10 Feet Length of gutter, to downspout and concrete splash block on the corner( East& North Side)
2. Add Trim 4-Inch-Tall Full-length Top of windows extending roofing materials over into gutters
3. Adding Downspout with concrete splash block with flow toward ditch/Beaumont Road



Attachment (B-M)



1. Adding Gutter complete corner to corner Facing (Beaumont Road)  $\frac{1}{2}$  Inch slope per 10 Feet Length to Downspout EPDM roof to be extended over into gutter to direct roof water over into gutter.
2. Adding Downspout and concrete splash block off NW corner (pictured), with water directed towards ditch/Beaumont Road.

**Attachment (C-M)**



1. Prep (wire brush and sand), then apply rust inhibiting primer and red all exposed Gas Line back down to the meter location. Paint to match the balance of the building.
2. Replace damaged cement board trim and siding above, behind, and near the gas meter.
3. Caulk all new and existing joints at trim/siding and gas supports then paint all existing and new siding and caulking materials to match the balance of the building.

**Attachment (D-M)**



1. Prep and Paint Red all exposed Gas Line
2. Prep and Paint Grey all exposed water lines

**Attachment (E-M)**



1. Prep and Paint red all gas exposed lines on the exterior of Building
2. Add 4" Gutters above South End of Building, extending roofing materials over into gutters ) ½ Inch slope per 10 Feet
3. Replace damaged siding and trim, then caulk all joints and paint all existing and new siding materials and caulk to match the existing building.



**Attachment (F-M)**



1. Facing Beaumont Rd. replace Panels both side Pipe as shown in Picture.
2. Add new Trimming under the Roof Parapet Front and Back edge to edge 4inch Thick water stay away from soaking exterior of Wall.
3. Install new gutters over the North end of the building (facing Beaumont Road), extending roofing materials or flashing over into the gutters, and install downspout and concrete splash block on or near the NW corner of the building, directing water to the ditch along Beaumont Road. ) ½ Inch slope per 10 Feet

**Attachment (G-M)**



**Facing Beaumont Road**

1. Add Downspout as previously described for the North side/end of the building facing Beaumont Road. ½ Inch slope per 10 Feet
2. Replace cement siding on both sides of this NW corner of the building, including the corner trim boards that are largely missing on this corner.

**Attachment (H-M)**



1. Replace One Panel of cement board siding on each side of the pictured window, which is on the West side of the building, toward the South end in order to remove the Diagonal Crack in the existing siding of the building. Re-use or replace trim board above and below the windows to provide a complete installation in keeping with the current configuration of the building. Replace trim boards if they are weather damaged at time of installation.

**Attachment (I-M)**



Showing extended roofing east side Face of the Office Building-1



**Attachment (J-M)**



Showing extended roofing east side Face of the Office Building-2

**Attachment (K-M)**



Showing extended roofing east side Face of the Office Building-3

**Attachment (L-M)**



Showing extended roofing east side Face of the Office Building-4



**STAFFORD  
CONSULTING  
ENGINEERS**

PROJECT NAME:  
DRIP EDGE WITH GUTTER

PT. NO. 3233.001.008  
OWN. BY: TDW  
DATE: 10/17/06  
DWG. NAME: EPDM-005



**ARMY  
RESERVE**

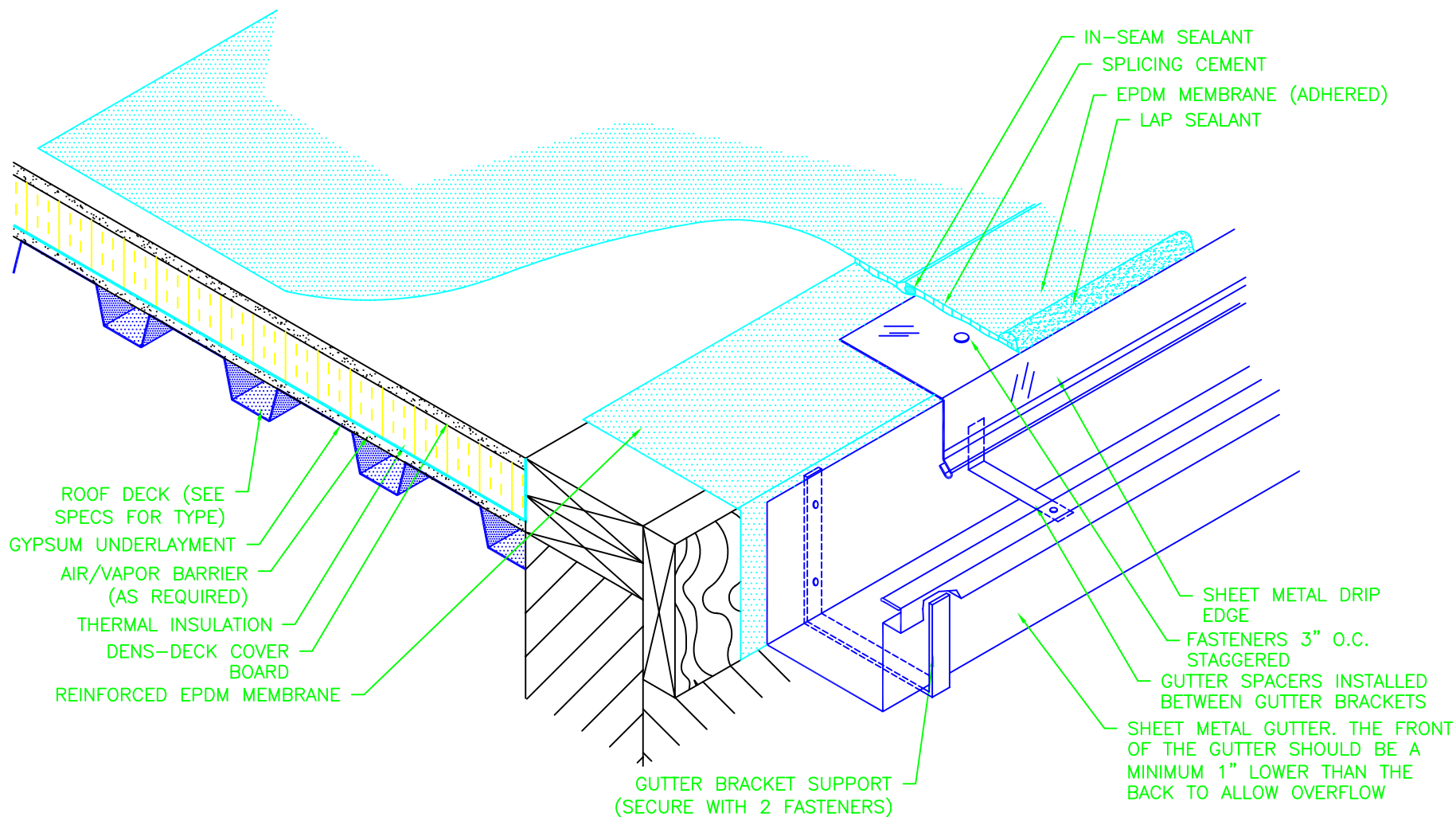

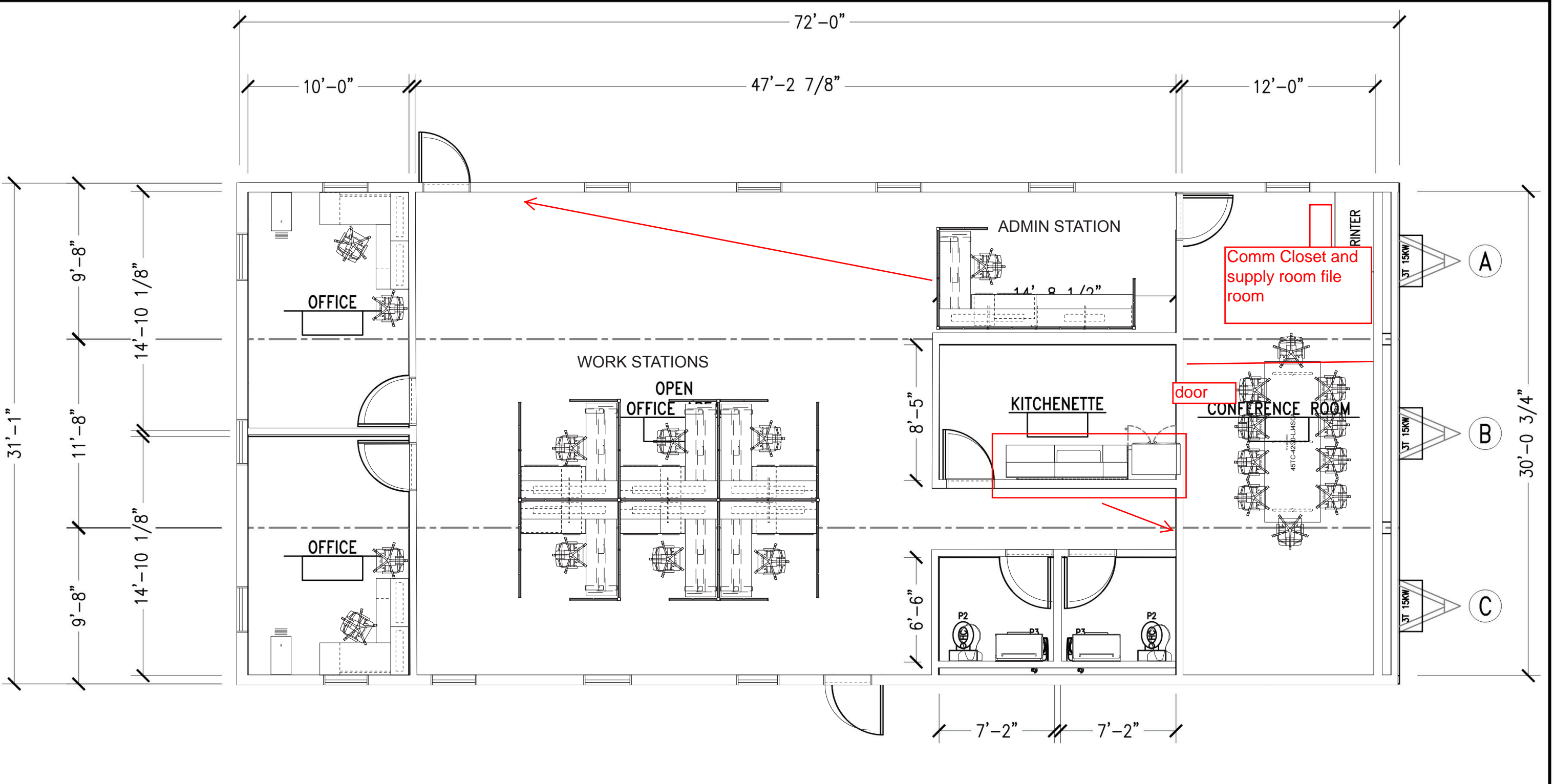

Scale: ~1:73

**King** business interiors

1400 GOODALE BLVD., SUITE 102  
COLUMBUS, OHIO 43212  
TEL(614)430-0020 FAX(614)430-0022

REV DATE	REVISION NOTES	PROJECT NO	DATE	SCALE	SALES	DESIGNER
----	----	85070	6/30/2017	NTS	dbudich	DBU
----	----	PROJECT				
----	----	SUSTAINABLE MODULAR MANAGEMENT FORT BENJAMIN				
----	----					
THE DRAWING AND DESIGN SHOWN HEREON IS THE PROPERTY OF KING BUSINESS INTERIORS INC. THE REPRODUCTION, COPYING, USE OF THE DRAWING WITHOUT KING BUSINESS INTERIORS INC. WRITTEN CONSENT IS PROHIBITED AND ANY INFRINGEMENT WILL BE SUBJECT TO LEGAL ACTION.						SHEET 1/5

r:\SUSTAINABLE MODULAR MANAGEMENT\INDIANAPOLIS, IN\85070\_FORT BENJAMIN\07 DESIGN\02 CET DESIGNER\85070\_170615\_SMM\_FORT BENJAMIN.cmrw

## SECTION 00 73 00 - SUPPLEMENTARY CONDITIONS

The following have been modified:

WAGE DETERMINATION

"General Decision Number: IN20230002 08/25/2023

Superseded General Decision Number: IN20220002

State: Indiana

Construction Type: Building

Counties: Adams, Allen, Bartholomew, Benton, Blackford, Boone, Carroll, Cass, Clinton, DeKalb, Delaware, Fountain, Fulton, Grant, Hamilton, Hancock, Hendricks, Howard, Huntington, Jay, Johnson, Madison, Marion, Miami, Monroe, Montgomery, Morgan, Noble, Shelby, Steuben, Tippecanoe, Tipton, Wabash, Warren, Wells, White and Whitley Counties in Indiana.

BUILDING CONSTRUCTION(does not include single family homes and apartments up to and including 4 stories)

Note: Contracts subject to the Davis-Bacon Act are generally required to pay at least the applicable minimum wage rate required under Executive Order 14026 or Executive Order 13658. Please note that these Executive Orders apply to covered contracts entered into by the federal government that are subject to the Davis-Bacon Act itself, but do not apply to contracts subject only to the Davis-Bacon Related Acts, including those set forth at 29 CFR 5.1(a)(2)-(60).

If the contract is entered into on or after January 30, 2022, or the contract is renewed or extended (e.g., an option is exercised) on or after January 30, 2022:	<ul style="list-style-type: none"> <li>. Executive Order 14026 generally applies to the contract.</li> <li>. The contractor must pay all covered workers at least \$16.20 per hour (or the applicable wage rate listed on this wage determination, if it is higher) for all hours spent performing on the contract in 2023.</li> </ul>
If the contract was awarded on or between January 1, 2015 and January 29, 2022, and the contract is not renewed or extended on or after January 30, 2022:	<ul style="list-style-type: none"> <li>. Executive Order 13658 generally applies to the contract.</li> <li>. The contractor must pay all covered workers at least \$12.15 per hour (or the applicable wage rate listed</li> </ul>

	on this wage determination, if it is higher) for all hours spent performing on that contract in 2023.
--	---

The applicable Executive Order minimum wage rate will be adjusted annually. If this contract is covered by one of the Executive Orders and a classification considered necessary for performance of work on the contract does not appear on this wage determination, the contractor must still submit a conformance request.

Additional information on contractor requirements and worker protections under the Executive Orders is available at <http://www.dol.gov/whd/govcontracts>.

Modification Number	Publication Date
0	01/06/2023
1	01/20/2023
2	02/03/2023
3	02/10/2023
4	02/24/2023
5	03/03/2023
6	03/17/2023
7	04/07/2023
8	05/26/2023
9	06/02/2023
10	06/09/2023
11	07/14/2023
12	08/11/2023
13	08/25/2023

ASBE0018-004 06/01/2022

BARTHOLOMEW, BENTON, BOONE, CARROLL, CLINTON, DELAWARE, FOUNTAIN, HAMILTON, HANCOCK, HENDRICKS, HOWARD, JOHNSON, MADISON, MARION, MONROE, MONTGOMERY, MORGAN, SHELBY, TIPPECANOE, TIPTON, AND WARREN COUNTIES:

	Rates	Fringes
ASBESTOS WORKER/HEAT & FROST INSULATOR (includes application of all insulating materials, protective coverings, coatings and finishings to all types of mechanical systems).....	\$ 34.90	21.58
HAZARDOUS MATERIAL HANDLER (includes preparation, wettings, stripping, removal, scrapping, vacuuming, bagging & disposing of all insulation materials, whether		

they contain asbestos or not,  
 from mechanical systems).....\$ 23.00 14.40

-----  
 ASBE0041-002 07/01/2022

ADAMS, ALLEN, BLACKFORD, DE KALB, GRANT, HUNTINGTON, JAY,  
 MIAMI, NOBLE, STEUBEN, WABASH, WELLS AND WHITLEY COUNTIES:

	Rates	Fringes
ASBESTOS WORKER/HEAT & FROST INSULATOR (includes application of all insulating materials, protective coverings, coatings and finishings to all types of mechanical systems).....	\$ 31.45	22.38
HAZARDOUS MATERIAL HANDLER (includes preparation, wettings, stripping, removal, scrapping, vaccuming, bagging & disposing of all insulation materials, whether they contain asbestos or not, from mechanical systems).....	\$ 23.00	14.40

-----  
 ASBE0075-003 06/01/2020

CASS, FULTON and WHITE COUNTIES

	Rates	Fringes
ASBESTOS WORKER/HEAT & FROST INSULATOR (includes application of all insulating materials, protective coverings, coatings and finishings to all types of mechanical systems).....	\$ 32.00	26.04
HAZARDOUS MATERIAL HANDLER (includes preparation, wetting, stripping, removal, scrapping, vaccuming, bagging & disposing of all insulation materials, whether they contain asbestos or not, from mechanical systems).....	\$ 23.00	14.40

-----  
 BOIL0374-002 01/01/2021

	Rates	Fringes
BOILERMAKER.....	\$ 38.53	32.20

-----  
 BRIN0003-001 06/01/2023



## INDIANAPOLIS

BOONE, HANCOCK, HENDRICKS, JOHNSON, MARION, MONTGOMERY, MORGAN  
and SHELBY COUNTIES

	Rates	Fringes
Bricklayer, Stone Mason, Pointer, Caulking.....	\$ 36.24	17.39
TERRAZZO FINISHER.....	\$ 23.38	13.15
TERRAZZO WORKER/SETTER.....	\$ 36.38	17.24
Tile & Marble Finisher.....	\$ 24.33	13.16
Tile, Marble Setter.....	\$ 35.63	17.23

-----  
BRIN0004-004 06/01/2023

## FORT WAYNE

ADAMS, ALLEN, DEKALB, HUNTINGTON, NOBLE, STEUBEN, WELLS AND  
WHITLEY COUNTIES:

	Rates	Fringes
BRICKLAYER (STONE MASON, MARBLE MASONS, POINTER, CLEANER, AND CAULKER).....	\$ 34.41	21.42
Terrazzo Grinder Finisher.....	\$ 30.00	16.78
Terrazzo Worker Mechanic.....	\$ 34.41	21.42
Tile Setter & Marble Mason Mechanic.....	\$ 30.00	16.78
Tile, Marble & Terrazzo Finisher.....	\$ 30.00	16.78

-----  
BRIN0004-021 06/01/2023

## BARTHOLOMEW and MONROE COUNTIES

	Rates	Fringes
Bricklayer, Stonemason.....	\$ 34.17	17.54
TERRAZZO FINISHER.....	\$ 23.38	13.15
TERRAZZO WORKER/SETTER.....	\$ 36.38	17.24
Tile & Marble Finisher.....	\$ 24.33	13.16
Tile & Marble Setter; Mosaic Worker.....	\$ 35.63	17.23

-----  
BRIN0011-001 06/01/2023

## LAFAYETTE

BENTON, CARROLL, CLINTON, FOUNTAIN, TIPPECANOE, WARREN and  
WHITE COUNTIES

	Rates	Fringes
Bricklayer, Stonemason, Pointer, Caulker & Cleaner.....	\$ 33.75	20.12

TERRAZZO FINISHER.....	\$ 23.38	13.15
TERRAZZO WORKER/SETTER.....	\$ 36.38	17.24
Tile & Marble Finisher.....	\$ 24.33	13.16
Tile & Marble Setter; Mosaic Worker.....	\$ 35.63	17.23

-----  
\* BRIN0018-001 06/01/2023

CASS, FULTON, GRANT, HOWARD, MIAMI and WABASH COUNTIES

	Rates	Fringes
Bricklayer, Stonemason, Pointer, Caulker & Cleaner.....	\$ 34.00	19.71
Terrazzo Worker Finisher.....	\$ 35.50	23.62
TERRAZZO WORKER/SETTER.....	\$ 33.50	23.62
Tile & Marble Finisher.....	\$ 34.50	23.62
Tile, Marble Setter.....	\$ 34.50	23.62

-----  
BRIN0019-001 06/01/2023

MUNCIE CHAPTER

BLACKFORD, DELAWARE, HAMILTON, JAY, MADISON AND TIPTON COUNTIES:

	Rates	Fringes
Bricklayer, Stonemason, Pointer, Caulker & Cleaner.....	\$ 33.83	20.14
TERRAZZO FINISHER.....	\$ 23.38	13.15
TERRAZZO WORKER/SETTER.....	\$ 36.38	17.24
Tile & Marble Finisher.....	\$ 23.38	13.15
Tile & Marble Setter; Mosaic Worker.....	\$ 35.63	17.23

-----  
CARP0215-001 06/01/2023

BENTON, CARROLL, CLINTON, TIPPECANOE, WARREN AND WHITE  
COUNTIES:

	Rates	Fringes
CARPENTER.....	\$ 33.84	24.21
MILLWRIGHT.....	\$ 34.39	25.09

-----  
CARP0232-001 06/01/2023

ALLEN, DEKALB, NOBLE, STEUBEN and WHITLEY COUNTIES

	Rates	Fringes
Carpenter & Piledrivermen.....	\$ 30.70	233.38

-----  
CARP0615-001 06/01/2023

ADAMS, CASS, FULTON, GRANT, HOWARD, HUNTINGTON, MIAMI, TIPTON,

## WABASH and WELLS COUNTIES

	Rates	Fringes
Carpenter & Piledrivermen.....	\$ 30.37	22.49
-----		
CARP0912-001 06/01/2023		

	Rates	Fringes
CARPENTER		
ZONE 2: BOONE, FOUNTAIN, HENDRICKS, MONROE, MONTGOMERY AND MORGAN COUNTIES		
Carpenters, Drywall.....	\$ 30.39	21.52
Millwright.....	\$ 33.06	24.32
ZONE 4: BLACKFORD, DELAWARE, JAY AND MADISON COUNTIES		
Carpenters, Drywall.....	\$ 30.10	21.52
Millwright.....	\$ 35.00	24.87
-----		
CARP0912-002 06/01/2022		

HAMILTON, HANCOCK, JOHNSON (Townships of White River, Pleasant and Clark), MARION

	Rates	Fringes
Carpenters:		
Carpenters, Drywall		
Installers, Piledrivers.....	\$ 30.84	19.59
Millwright.....	\$ 22.06	24.32
Soft Floor Layers.....	\$ 28.85	18.63
-----		
CARP0999-008 06/01/2023		

BARTHOLOMEW, JOHNSON (Townships of Union, Hensley, Franklin, Nineva, Needham and Blue River), SHELBY COUNTIES

	Rates	Fringes
Carpenters:		
Carpenters, Drywall		
Installers, Piledriver.....	\$ 35.00	24.87
Millwright.....	\$ 33.06	24.32
Soft Floor Layers.....	\$ 28.85	18.63
-----		
CARP1029-001 06/01/2022		

ADAMS, ALLEN, CASS, DEKALB, ELKHART, FULTON, GRANT, HOWARD, HUNTINGTON, KOSCIUSKO, LAGRANGE, MARSHALL, MIAMI, NOBLE, ST. JOSEPH, STEUBEN, TIPTON, WABASH, WELLS and WHITLEY COUNTIES

	Rates	Fringes
MILLWRIGHT.....	\$ 31.20	26.80
-----		
ELEC0305-002 05/01/2023		

ADAMS, ALLEN, DE KALB, HUNTINGTON, NOBLE, STEUBEN, WELLS, and  
WHITLEY COUNTIES

	Rates	Fringes
ELECTRICIAN.....	\$ 36.32	27.42%+11.21
-----		
ELEC0481-005 05/31/2023		

BARTHOLOMEW, BOONE, HAMILTON, HANCOCK, HENDRICKS, JOHNSON,  
MADISON, MARION, MONTGOMERY, MORGAN AND SHELBY COUNTIES

	Rates	Fringes
ELECTRICIAN.....	\$ 40.20	26.31
-----		
ELEC0538-006 01/01/2023		

FOUNTAIN AND WARREN COUNTIES:

	Rates	Fringes
ELECTRICIAN.....	\$ 37.31	23.15
-----		
ELEC0668-002 01/01/2023		

BENTON, CARROLL, CASS, FULTON, TIPPECANOE and WHITE COUNTIES

	Rates	Fringes
ELECTRICIAN.....	\$ 36.56	22.41

FOOTNOTE: a. PAID HOLIDAYS: New Years Day, Memorial Day,  
July 4th, Labor Day, Veterans Day Thanksgiving Day and  
Christmas Day

-----		
ELEC0725-006 06/01/2022		

MONROE COUNTY

	Rates	Fringes
Communication Technician.....	\$ 30.00	18.07

Includes the installation, operation, inspection,  
maintenance, repair and service of radio, television,

recording, voice sound and vision production and reproduction apparatus, equipment and appliances used for domestic, commercial, education, entertainment and private telephone systems.

-----  
ELEC0725-011 10/01/2022

MONROE COUNTY:

	Rates	Fringes
ELECTRICIAN.....	\$ 40.00	21.96

-----  
ELEC0855-003 06/01/2023

BLACKFORD, DELAWARE, AND JAY COUNTIES

	Rates	Fringes
ELECTRICIAN.....	\$ 35.30	20.25

-----  
ELEC0873-002 03/01/2022

CLINTON, GRANT, HOWARD, MIAMI, TIPTON AND WABASH COUNTIES:

	Rates	Fringes
ELECTRICIAN.....	\$ 36.59	20.12

-----  
ELEV0034-001 01/01/2023

BARTHOLOMEW, BENTON, BLACKFORD, BOONE, CARROLL, CASS, CLINTON, DELAWARE, FOUNTAIN, FULTON, GRANT, HAMILTON, HANCOCK, HENDRICKS, HOWARD, JAY, JOHNSON, MADISON, MARION, MIAMI, MONROE, MONTGOMERY, MORGAN, SHELBY, TIPPECANOE, TIPTON, WARREN and WHITE COUNTIES

	Rates	Fringes
ELEVATOR MECHANIC.....	\$ 55.30	37.335+a+b

a) PAID HOLIDAYS: New Year's Day, Memorial Day, Independence Day, Labor Day, Vetern's Day, Thanksgiving Day, the Friday after Thanksgiving, and Christmas Day.

b) Employer contributes 8% of regular hourly rate to vacation pay credit for employee with more than 5 years of service; 6% for less than 5 years' service.

-----  
ELEV0044-002 01/01/2023

ADAMS, ALLEN, DeKALB, HUNTINGTON, NOBLE, STEUBEN, WABASH, WELLS, WHITLEY COUNTIES

	Rates	Fringes
ELEVATOR MECHANIC.....	\$ 57.26	37.335+a+b

a) PAID HOLIDAYS: New Year's Day, Memorial Day, Independence Day, Labor Day, Veterans' Day, Thanksgiving Day, the Friday after Thanksgiving, and Christmas Day.

b) Employer contributes 8% of regular hourly rate to vacation pay credit for employee with more than 5 years of service; 6% for less than 5 years' service.

-----  
 ENGI0103-001 04/01/2021

BENTON, CARROLL, CASS, CLINTON, GRANT, HOWARD, MIAMI,  
 TIPPECANOE, TIPTON, WABASH, and WHITE COUNTIES

	Rates	Fringes
Power equipment operators:		
GROUP 1.....	\$ 37.08	19.96
GROUP 2.....	\$ 36.13	19.96
GROUP 3.....	\$ 32.08	19.96
GROUP 4.....	\$ 28.38	19.96

#### POWER EQUIPMENT OPERATOR CLASSIFICATIONS

GROUP 1: A-Frame Winch Truck, Air Compressors over 600 cu.ft., Air Tugger, Autograde (CMI), Auto Patrol, Backhoe, Ballast Regulator (RR), Batcher Plant (electrical control concrete), Bending Machine (pipe), Bituminous Plant (engineer), Bituminous Plant, Bituminous Mixer Travel Plant, Bituminous Paver, Bituminous Roller, Buck Hoist, Bull Dozer, Cable Way, Chicago Boom, Clamshell, Concrete Mixer (21 cu. ft. or over), Concrete Paver, Concrete Pump(crete), Crane, Craneman, Crusher Plant, Derrick, Derrick Boat, Dinkey, Dope Pots (pipeline), Dragline, Dredge Operator, Dredge Engineer, Drill Operator,, Elevating Grader, Elevator, Ford Hoe (or similar type equipment), Forklift, Formless Paver, Gantry Crane, Gradall, Grademan, Grout Pump, Helicopter Crew, Heterington Paver, High-Lift, Hoist, Hopto, Hough Loader (or similar type), Hydro Crane, Hydro Hammer, Locomotive Crane, Locomotive, Mechanic, Mobile Mixer, Motor Crane, Mucking Machine, Multiple Tamping Machine (rr), Overhead Crane, Pile Driver, Pulls, Push Dozer, Push Boats, Roller (sheep foot), Ross Carrier, Scoop, Shovel, Side Boom, Swing Crane, Tail Boom, Tar Machine (pipeline), Throttle Valve, Tower Crane, Trench Machine, Welder (heavy duty), Truck Mounted Concrete Pump, Truck-Mounted Drill, Well Point, Whirleys

GROUP 2: Air Compressor (up to 600 cu. ft.), Brakeman, Bull Float, Concrete Mixer (over 10s and under 21s), Concrete Spreader or Puddler, Deck Engine, Drill Helper, Electric

Vibrator Kompactor (earth or rock), Finishing Machine, Gireman, Greaser (on grease facilities servicing heavy equipment), Material Pump, Motor Boats, Motor Crane Oiler, Portable Loader, Post Hole Digger, Power Broom, Rock Roller, Roller-Wobble Whell (earth or rock), Spike Machine (RR) Seamen Tiller, Spreader Rock, Sub Grader, Tamping Machine, Truck Mounted Drill Oiler, Welding Machine, Widener (apsco or similar type)

GROUP 3: Air Compressor 210 cu ft & over, Bituminous Distributor, Chair Cart, Concrete Curing Machine, Concrete Saw, Dope Pot Power Agitated, Flex Plane, Form Grader, Hydrohammer, Jacks Hydraulic Power Driven, Paving Joint Machine, Post Hole Digger, Roller Earth, Throttle Valve, Track Jack Power Driven, Tractor Farm Type, Truck Crane Driver

GROUP 4: Air Compressor (under 200 cu. fr. per min), Bituminous Distributor, Cement Gun, Concrete Saw, Conveyor, Deck Hand Oiler, Earth Roller, Form Grader, Generator, Guardrail Driver, Heater, Oiler, Paving Joint Machine, Power Traffic Signals, Steam Jenny, Vibrator, Water Pump, ""JLG"" Lifts and ""Scissor"" Lift or similar machine

-----  
 ENGI0103-002 04/01/2021

BLACKFORD, DELAWARE, HAMILTON, HANCOCK, JAY, JOHNSON, MADISON, MARION, and SHELBY COUNTIES

	Rates	Fringes
Power equipment operators:		
GROUP 1.....	\$ 37.08	19.96
GROUP 2.....	\$ 36.13	19.96
GROUP 3.....	\$ 32.08	19.96
GROUP 4.....	\$ 28.30	19.96

#### POWER EQUIPMENT OPERATOR CLASSIFICATIONS

GROUP 1: Air Compressor (pressurizing shafts, tunnels & drivers); Air Tugger; Auto Patrol; Back Filler; Back Hoe; Boom Cat; Boring Machine; Bull Dozer; Caisson Drilling Machine; Cherry Picker; Compactor (with dozer blade); Concrete Mixer (dual drum); Concrete plant; Concrete Pump; Crane with all attachments; Crane- Electric overhead; Derrick; Ditching Machine (18' and over); Dredge; Elevators (when hoisting material or tools); Fork Lift (machinery); Formless Paver; Generator (power for welders of compressor); Gradall; Helicopter; Helicopter Winch Operator; High Lift-Front End Loader; Hoist-Material and/or Personnel over 3 Floors; Locomotive; Mechanic on job site; Mucking Machine; Panel Board Concrete Plant; Pile Driver; Push Cat; Scoop & Tractor; Scraper-Rubber Tired; Spreader-Tractor Mounted; Straddle Carrier-Ross Type; Sub Base Finish Machine (C.M.I. or smiliar); Tower Crane;

Tractor with Backhoe (over 1/2 yard); Welder (craft)

GROUP 2: A Frame Truck; Batch Plant (automatic dry batch); Bending Machine-Power Driven; Bituminous Mixer; Bituminous Paver; Bituminous Plant Engineer; Boatman; Bull Float; Compactor or Tamper-Self Propelled; Concrete Mixer (21 cu. ft. or over); Concrete Spreader-Power Driven; Dinkey Engine; Ditching Machine; Ditching Machine (less than 18"); Drilling Machine; Finish Machine & Bull Float; Finishing Machine; Fireman-Pile Driving and Boilers; Fork Lift-Masonry & Material; Guniting Machine; Head Greaser; Hoist-Material and/or personnel 3 floors and under; Mechanic in shop; Mesh Depresser-Mesh Placer; P.C.C. Concrete Belt Placer; Ruller-Asphalt, stone & sub base; Sheepsfoot Roller- Self Propelled; Shop Mule; Spreader or Base Paver-Self Propelled; Sub Grader; Throttle valve with air compressor or boiler; Tractor with Backhoe (1/2 yard & under); Tractor-high lift-farm type; Tractor-Industrial Type; Tractor with Winch; Well Points; Winch Trick

GROUP 3: Air Compressor (210 cu. ft. & over); bituminous Distributor; Chair Cart; Concrete Curing Machine; Concrete Saw; Dope Pot Power Agitated; Flex Plane; Form Grader; Hydrohammer; Jacks-Hydraulic-Power Driven; Minor Equipment opr. 3,4, or 5; Paving Joint Machine; Post Hole Digger; Roller-Earth; Throttle Valve; Track Jack-Power Driven; Tractor-Farm Type; Truck Crane Driver

GROUP 4: Air Compressor (less than 210 cu. ft.); Concrete Mixer (under 21cu. ft.); Conveyor; Generator; Mechanical Heater; Oiler; Operator-2 pieces of miner equipment; Power Broom; Pump; Welding Machine

-----  
ENGI0103-007 04/01/2021

ADAMS, ALLEN, DEKALB, HUNTINGTON, STEUBEN, WELLS, and WHITLEY COUNTIES

	Rates	Fringes
Power equipment operators:		
GROUP 1.....	\$ 37.08	19.96
GROUP 2.....	\$ 36.13	19.96
GROUP 3.....	\$ 32.08	19.96
GROUP 4.....	\$ 28.30	19.96

#### POWER EQUIPMENT OPERATOR CLASSIFICATIONS

GROUP 1: Air Tugger; Auto Patrol, Back Filler; Back Hoe; Boom Cat; Boring Machine; Bull Dozer; Caisson Drilling Machine; Cherry Picker; Compactor (with dozer blade); Concrete Mixer (dual drum); Concrete Plant; Concrete Pump; Crane with all attachments; Crane Electric overhead; Derrick; Ditching Machine (18" and over); Dredge; Fork Lift (machinery); Formless Paver; Gradall; Helicopter;



Helicopter Winch Operator; High Lift Front End Loader;  
 Hoist Material and/or personnel over 3 floors; Locomotive;  
 Mechanic on Job Site; Mucking Machine; Panel Board Concrete  
 Plant; Pile Driver; Push Cat; Scoop & Tractor; Scraper  
 Tubber Tired; Skid Steer Machine (grading and back hoe);  
 Spreader Tractor Mounted; Straddle Carrier Ross Type; Sub  
 Base Finish Machine (C.M.I.or similar); Tower Crane;  
 Tractor with backhoe (over 1/2 yard); Welder for Craft Work.

GROUP 2: A-Frame Truck; Batch Plant (automatic dry batch);  
 Bending Machine Power Driven; Bituminous Mixer; Bituminous  
 Paver; Bituminous Plant Engineer; Boatman; Bull Float;  
 Compactor or Tamper Riding Only; Concrete Mixer (21 cu. ft.  
 or over); Concrete Spreader Power Driven; Dinkey Engine;  
 Ditching Machine (less than 18" riding only); Drilling  
 Machine; Elevators (when hoisting material or tools);  
 Finish Machine and bull Float (excluding trowelling  
 machine); Fireman Pile Driving and Boilers; Guniting Machine;  
 Head Greaser; Hoist Material and/or personnel 3 floors and  
 under; Mesh Depressor Mesh Placer; P.C.C. Concrete Belt  
 Placer; Roller Asphalt, Stone & Sub Base; Sheepfoot Roller  
 Self Propelled; Shop Mule; Spreader or Base Paver Self  
 Propelled; Sub Grader; Throttle Valve with Air Compressor  
 or Boiler; Tractor with Backhoe (1/2 yard & under); Tractor  
 High Lift Farm Type; Tractor Industrial Type; Tractor with  
 Winch; Winch Truck.

GROUP 3: Bituminous Distributor; Chair Cart; Concrete Cutting  
 Machine; Dewatering Systems; Dope Pot Power Agitated; Flex  
 Plane; Fork Lift (masonry and material); Form Grader;  
 Hydrohammer; Jacks Hydraulic Power Driven; Paving Joint  
 Machine; Post Hole Digger (machine Mounted); Roller Earth;  
 Skid Steer Machine (fork lift and transporting); Throttle  
 Valve; Track Jack Power Driven; Tractor Farm Type.

GROUP 4: Air Compressor (pressurizing shafts, tunnels and  
 divers); Air Compressor (over 210 cu. ft.); Concrete Saw;  
 Conveyor; Generators; Oiler; Operating minor equipment;  
 Power Broom; Truck Crane Driver; Welding Machines over 300  
 amps (2 or more).

-----  
 ENGI0150-017 06/01/2022

FULTON and NOBLE COUNTIES

	Rates	Fringes
POWER EQUIPMENT OPERATOR		
GROUP 1.....	\$ 30.75	34.25
GROUP 2.....	\$ 29.40	34.25
GROUP 3.....	\$ 28.60	34.25
GROUP 4.....	\$ 27.80	34.25
GROUP 5.....	\$ 25.20	34.25

POWER EQUIPMENT OPERATOR CLASSIFICATIONS:

GROUP 1: Mechanic, Asphalt Plant, Asphalt Spreader, Auto Grader; Batch Plant, Benoto (requires 2 Engineers), Boiler and Throttle Valve, Boring Machine (road), Bulldozers (with engines of 140 net horse power or more) Caisson Rigs, Central Redi-mix Plant, Concrete Conveyor Systems, Concrete Power (over 27E cu. ft.), Concrete Paver (27E cu. ft. and under), Concrete Pumps/Grout concrete placer (Truck Mounted), Concrete Tower, Cranes and backhoes (all), Cranes, Hammerhead Tower, Creter Crane, Derricks (all), Forklift (capable of hoisting and mechanically moving forks horizontally), Grader, Elevating, Highlift Shovels or Front End Loaders (over 3 yd bucket), Hoists (2 or more drums), Locomotives (all), Laser screed, Motor Patrol, Pile Drivers and Skid Rig, Pre-Stress Machines, Pump Cretes & Similar Types, Rock Drill (Self-Propelled), Rock Drill (self propelled Truck Mounted), Scoops (tractor drawn), Slip-Form Paver, Tournapull, Tractor with Boom & Side Boom, Trenching Machine (12 or more inches in width), Combination Backhoe Front End Loader Machine with backhoe 1/2 yd bucket or attachments.

GROUP 2: Air Compressor (600 cu. ft. and over), Bob Cat (over 3/4 cu. yd.), Boilers, Broom (all powered propelled), Bull Dozers with engines of less than 140 net horsepower, combination backhoe front end loader 1/2 yf bskhhoe or under, Compressor and Throttle Valve, Concrete Breaker (truck mounted), Concrete Mixer (of moore than 21 cu. ft. capacity), Forklift (with fixed or tilt mast), Greaser Engineer, Highlift shovel or front endloader 3 yd bucket and under, Hoists (1 drum), Hydraulic Boom Truck, Post Hole Digger (vehicle mounted), Pump Cretes (squeeze crete type pumps, Gypsum, bulker , Rollers(all), Steam Generators, Stone Crushers, Stradddle Buggies, Tractors, Winch Trucks (with ""a"" frame.

GROUP 3: Buck Hoist, Combination (small equipment operator), .Conveyor (portable), Grouting Machine, Hoist Elevators (material and personnel), Hydraulic Power Units, Grouting and Pile Driving, Stud Welder, Trenching Machines less than 12 inches in width, Welding Machines (8 through 15).

GROUP 4: Bobcat (up to and including 3/4 cu. yd.). Compressor (over 210 cu. ft. and less than 600 cu. ft.), Generator (over 50 kw.), Heaters, Mechanical, Hoists (all elevator, permanent installation), Hoist (automatic), Hoist (tugger single drum), Oilers, Pumps, Well Points and electric submersible, Small Rubber Tired End Loaders (1/4 cu. yd. and under), Tractors (farm type) Welding Machines (2 through 8).

GROUP 5: Bobcats and forklifts (commercial or residential).

-----  
ENGI0181-004 04/01/2023

BARTHOLOMEW COUNTY

	Rates	Fringes
Power equipment operators:		
GROUP A.....	\$ 38.53	19.22
GROUP B.....	\$ 30.40	19.22

## POWER EQUIPMENT OPERATOR CLASSIFICATIONS

GROUP A: A-frame winch truck, articulating dump, autograde (CMI), auto patrol, ballast regulator (RR), batcher plant (electrical control concrete), bending machine (pipe), bituminous plant (engineer), bituminous plant, bituminous mixer travel plant, bituminous paver, bituminous roller, boring machine, buck hoist, bull dozer, cable way, Chicago boom, chimney hoist, clamshell, concrete mixer (21 cu.ft. or over), concrete paver, concrete pump (crete), construction elevator (Allmac or similar) creane, creaneman, crawler backhoe, bcreawler high-lift, crusher plant, derrick, derrick boat, dinkey, directional/boring machine, dope pots (pipeline), double drum tugger (electric or air), dragline, dredge operator, dredge engineer, drill operator, elevating grader, extendable boom forklift, formless paver, gantry crane, gator (or similar type tiller), gradeall, grader, grademan, greaser (on grease facility servicing heavy equipment), G.P.S. System (on equipment within the classificaitons), grout pump, head greaser, helicopter crew, Hetherington paver, hoist (motorized, gas or diesel), hydraulic crane, ghdro blaster, Industrial type forklift (over 9,000 lbs.), laser concrete screed, laser or remote controlled equipment (within the classifications), locomotive crane, locomotive, mechanic, mobile mixer, botor creane, mucking machine, multiple tamping machine (RR) overhead crane, pile driver, pulls, push dozer, push boats, roller (sheep foot), rough terrain crain, R.T. backhoe, R.T. endloader, Ross carrier, scoop, shovel, side boom, skidsteer loader (bobcat or similar type), swing crane, tail boom, tar machine (pipeline), tower crane, trench machine, welder (heavy duty), truck mounted concrete pump, truck-mounted drill, vacuum truck, well point, whirleys

GROUP B: Air compressor (1 or more, 600 cfm and over), air compressor with throttle valve, bituminous distributor, brakeman, bullfloat, cement gun, concret mixer, concrete say, soncrete spreader or puddlers, conveyor, deck hand oiler, deck engine, drill helper, earth roller electric vibrator compactor (earth or rock), elevator (in-plant, automatic), finishing machine fireman, form grader, generator, guard-rail driver, heater, oiler, Industrial type forklift (9,000 lbs and under), aterail pump, motor boats, paving joint machine, post hole digger, power broom, power traffic signals, rock roller, rock spreader, Roller (earth or rock), spike machine (RR), steam jenny, sub grader, taping machine, gruck crane oiler, truck mounted drill oiler Tugger (one-drum, air or electric)vibrator, vibro-piling hammer- hydraulic hammer or auger, water pump, widener (apsco or similar type) welding machine, JLG lifts

and scissor lifts or similar machine.

-----  
 ENGI0841-008 04/01/2023

BOONE, FOUNTAIN, HENDRICKS, MONROE, MONGOMERY, MORGAN, and  
 WARREN COUNTIES

	Rates	Fringes
Power equipment operators:		
GROUP 1.....	\$ 33.90	23.00
GROUP 2.....	\$ 26.75	23.00

#### POWER EQUIPMENT OPERATOR CLASSIFICATIONS

GROUP 1: Power Cranes, Draglines, Derricks, Shovels, Gradalls, Mechanics, Tractor Highlift, Tournadozer, Concret Mixers with Skip Tournamixer, Two-Drum Machine, One-Drum Hoist with Tower or Boom, Cableways, Tower Machines, Motor Patrol, Boo Tractor, Boom or Winch Truck, Winch or Hydraulic Boom Truck, Truck Crane, Tournapull, Tractor Operating Scoops, Bulldozer, Push Tractor, Asphalt Planer, Finishing Machine on Asphalt, Large Rollers on Earth, Rollers on Asphalt Mix, Ross Carrier or Similar Machine, Gravel Processing Machine, Asphalt Plant Engineer, Paver Operator, Farm Tractor with Half Yard Bucket and/or Backhoe Attachments, Dredge Engineer, or Dredge Operator, Central Mix Plant Engineer, CMI or Similar Type Machine, Truck or Skid Mounted Concrete Pump, Tower Crane, Engine or Rock Crusher Plant, Concrete Plant Engineer, Ditching Machine with Dual Attachment, Tractor Mounted Loaders, Cherry Picker, Hydro Crane, Standard or Dinkey Locomotives, Scoopmobiles, Euclid Loader, Soil Cement Machine, Back Filler, Elevating Machine, Power Blade, Drilling Machines including Well Testing, Caissons, Shaft or any similartype Drilling Machines, Motor Driven Paint Machine, Pipe Cleaning Machine, Pipe Wrapping Machine, Pipe Bending Machine, Apsco Paver, Boring Machine, (Equipment Greased), Barber-Greene Loaders, Formless Paver, (Well Point System), Concrete Spreader, Hydra Ax, Span Saw and Similar Types, Marine Scoops, Brush Mulcher, Brush Burner, Mesh Placer, Tree Mover, Helicopter Crew (3), Piledriver-Skid or Crawler, Stump Remover, Root Rake, Tug Boat Operator, Refrigerating Machine, Freezing Operator, Chair Cart-Self Propelled, Hydra Seeder, Straw Blower Power Sub Grader, Bull Float, Finishing Machine, Self-Propelled Pavement Breaker (Backhoe Attached), Lull (or Similar Type Machine), Two Air Compressors, Compressors Hooked in Manifold, Overhead Crane, Chip Spreader, Mud Cat, Sull-Air Fork Lifts (Except when used for Landscaping Work), Soil Stabilizer (Seaman Tiller, Bo Mag, Rago Gator and Similar types or Equipment), Tube Float, Spray Machine, Curing Machine, Concrete or Asphalt Milling Machine, Snooper Truck Operator.

GROUP 2: Concrete Mixers without Skips, Rock Crusher,

Ditching Machine Under 6', Curbing Machine, One Drum Machines without Tower or Boom, Air Tugger, Self-Propelled Concrete Saw, Machin- Mounted Post Hole Digger, Two to Four Generators, Water Pumps, or Welding Machines, with 400 ft., Air Compressor 600 cu. ft. and Under, Rollers on Aggregate and Seal Coat Surfaces, Fork Lifts (When used for Landscaping Work), Concrete and Blacktop Curb Machine, Farm Tractor with less than Half Yard Bucket, One Water Pump, Iolers, Air Valves or Steam Valves, One Welding Machine, Truck Jack, Mud Jack, Gunnite Machine, House Elevators when used for Hoisting Material, Engine Tenders, Wagon Drill, Flex Plane, Conveyor, Siphons nad Pulsometer, Switchman, Fireman on Paint Pots, Fireman on Asphalt Plants, Distributor Operators on Trucks, Tampers, Self-Propelled Power Broom, Striping Machine (motor driven), Form Tamper, Bulk Cement Plan Equipment Greaser, Deck Hands, Truck Crane Oiler Driver, Cement Blimps, Form Grader, Temporary Heat, Throttle Valve, Farm Tractor, Super Sucker (and similar type of equipment). FOOTNOTE: Employees operating booms from 149 ft. to 199 ft. including jib, shall receive an additional seventy five cents (.75)per hour above the rate. Employees operating booms over 199 ft. including jib, shall receive an additional one dollar and twenty-five cents (\$1.25) per hour above the regular rate.

-----  
IRON0022-004 06/01/2023

BARTHOLOMEW; BENTON, BOONE; CARROLL; CASS; CLINTON; DELAWARE (S 2/3); FOUNTAIN; FULTON (SW 1/4 OF COUNTY); GRANT (SW PORTION); HAMILTON; HANCOCK; HENDRICKS; HOWARD; JOHNSON; MADISON; MARION; MIAMI; MONROE; MONTGOMERY; MORGAN; SHELBY; TIPPECANOE; TIPTON; WARREN AND WHITE COUNTIES

	Rates	Fringes
IRONWORKER.....	\$ 35.45	25.39

The following holidays shall be observed: New Year's Day, Memorial Day, Independence Day, Labor Day, Thanksgiving Day and the day after Thanksgiving and Christmas Day. Any holiday which occurs on a Sunday shall be observed the following Monday, unless the legal observance of these holidays is changed by law.

-----  
IRON0147-004 06/01/2023

ADAMS, ALLEN, BLACKFORD, DEKALB, DELAWARE (NORTHEAST THIRD OF COUNTY), FULTON (EASTERN PART), GRANT (EXCLUDING SOUTHWEST PORTION), HUNTINGTON, JAY, MIAMI (NORTHEAST HALF), NOBLE (EXCLUDING NORTHEAST TIP), STEUBEN, WABASH, WELLS, and WHITLEY COUNTIES

	Rates	Fringes
--	-------	---------

IRONWORKER.....\$ 33.00 25.59

-----  
IRON0292-006 06/01/2023

FULTON (Remainder of County) and NOBLE (Northeastern Tip)  
COUNTIES

	Rates	Fringes
IRONWORKER.....	\$ 35.15	24.45

-----  
LAB00120-001 06/01/2023

MARION and SHELBY COUNTIES

	Rates	Fringes
Laborers:		
GROUP 1.....	\$ 27.24	17.50
GROUP 2.....	\$ 27.99	17.50
GROUP 3.....	\$ 28.74	17.50

#### LABORER CLASSIFICATIONS

GROUP 1: Building and Construction Laborers; Scaffold Builders (other than for Masons and Plasterers); Mechanic Tenders; Window Washers and cleaners; Railroad Workers; Masonry Wall Washers; Portable Water pumps with discharge up to (3) inches; Flag & Signal Person; Waterproofing; Handling of Creosot Lumber or like treated material (excluding railroad material); Asphalt Rakers and Lutemen; Kettlemen; Air Tool Operators; Pneumatic Tool Operators; Air and Electric Vibrators and Chipping Hammer Operators; Earth Compactors Jackmen and Sheetmen working Ditches deeper than (6) ft.in depth; Laborers working in ditches (6) ft.in depth or deeper; Assembly of Unicrete Pump; Chain Saw and Demolition Saw; Tile Layers (sewer or field) and Sewer Pipe Layer (metallic or non-metallic); Motor driven Wheelbarrows and Concrete Buggies; Hyster Operators; Pump Crete Assemblers; Concrete Conveyor Assemblers; Core Drill Operators; Cement, Lime or Silica Clay Handlers (bulk or bag); Handling of Toxic Materials damaging to clothing; Pneumatic Spikers; Deck Engine and Winch Operators; Water Main and Cable Ducking (metallic and non-metallic); Screed Man or Screw Operator on Asphalt Paver; Asbestos Removal and Hazardous Waste Removal.

GROUP 2: Plaster Tenders; Mortar Mixers; Welders (Acetylene or electric); Cutting Torch or Burner; Cement Nozzle Laborers; Cement Gun Operator; Scaffold Builders when working for Plasterers and Masons; Water Blast Machine.

GROUP 3: Dynamite men, Mason Tenders; Drillers-air track or wagon drilling for explosives.

-----  
LAB00204-001 06/01/2023

FOUNTAIN, HENDRICKS, and WARREN COUNTIES

	Rates	Fringes
Laborers:		
Caisson and Tunnel Work in Compressed and Free Air		
GROUP 1.....	\$ 23.18	16.00
GROUP 2.....	\$ 23.93	16.00
GROUP 3.....	\$ 24.18	16.00
GROUP 4.....	\$ 23.13	16.00
LABORERS		
GROUP 1.....	\$ 26.03	17.50
GROUP 2.....	\$ 26.78	17.50
GROUP 3.....	\$ 27.53	17.50

LABORER CLASSIFICATIONS

GROUP 1: Building and Construction Laborers; Scaffold Builders (other than for Masons and Plasterers); Mechanic Tenders; Window Washers and cleaners; Railroad Workers; Masonry Wall Washers; Portable Water pumps with discharge up to (3) inches; Flag & Signal Person; Waterproofing; Handling of Creosot Lumber or like treated material (excluding railroad material); Asphalt Rakers and Lutemen; Kettlemen; Air Tool Operators; Pneumatic Tool Operators; Air and Electric Vibrators and Chipping Hammer Operators; Earth Compactors Jackmen and Sheetmen working Ditches deeper than (6) ft.in depth; Laborers working in ditches (6) ft.in depth or deeper; Assembly of Unicrete Pump; Chain Saw and Demolition Saw; Tile Layers (sewer or field) and Sewer Pipe Layer (metallic or non-metallic); Motor driven Wheelbarrows and Concrete Buggies; Hyster Operators; Pump Crete Assemblers; Concrete Conveyor Assemblers; Core Drill Operators; Cement, Lime or Silica Clay Handlers (bulk or bag); Handling of Toxic Materials damaging to clothing; Pneumatic Spikers; Deck Engine and Winch Operators; Water Main and Cable Ducking (metallic and non- metallic); Screed Man or Screw Operator on Asphalt Paver, Asbestos Removal, Hazardous Waste Removal.

GROUP 2: Plaster Tenders; Mortar Mixers; Welders (Acetylene or electric); Cutting Torch or Burner; Cement Nozzle Laborers; Cement Gun Operator; Scaffold Builders when working for Plasterers and Masons; Water Blast Machine.

GROUP 3: Dynamite men, Mason Tenders; Drillers-air track or wagon drilling for explosives.

LABORER CLASSIFICATIONS For CAISSON AND TUNNEL WORK In  
COMPRESSED and FREE AIR

GROUP 1: Cage Tenders, Dump Men, Flagman, Signalman, Top Laborers, Rod Men.

GROUP 2: Concrete Repairmen, Lock Tenders (pressure side), Motor men, Muckers, Grout Machine, Track Layers, Air Hoist, Key Board, Agitator Car, Car Pushers, Concrete Laborers, Grout Laborers, Lock Tenders (free air side), Steel Setters, Tuggers, Switchmen.

GROUP 3: Mucking Machine, Laser Beam, Liner Plate & Ring Setter, Shield Drivers, Power Knife, Welders Burners, Pipe Jacking Machine, Skinners, Maintenance Technician, Miner, Bricklayer Tenders, Concrete Blowers, DRillers, Erectors, Form Men, Jackhammermen, Mining Machine.

GROUP 4: Dynamite Men, Drillers air track or wagon drilling for explosives.

-----  
LAB00213-001 06/01/2023

ADAMS, ALLEN, DEKALB, HUNTINGTON, NOBLE, STEUBEN, WABASH, WELLS  
AND WHITLEY COUNTIES

	Rates	Fringes
Laborers:		
GROUP 1.....	\$ 24.13	17.30
GROUP 2.....	\$ 24.63	17.30
GROUP 3.....	\$ 25.13	17.30

#### LABORERS CLASSIFICATION

GROUP 1: Building and Construction Laborers; Scaffold Builders (other than for Masons and Plasterers); Mechanic Tenders; Window Washers and cleaners; Railroad Workers; Masonry Wall Washers; Portable Water pumps with discharge up to (3) inches; Flag & Signal Person; Waterproofing; Handling of Creosot Lumber or like treated material (excluding railroad material); Asphalt Rakers and Lutemen; Kettlemen; Air Tool Operators; Pneumatic Tool Operators; Air and Electric Vibrators and Chipping Hammer Operators; Earth Compactors Jackmen and Sheetmen working Ditches deeper than (6) ft.in depth; Laborers working in ditches (6) ft.in depth or deeper; Assembly of Unicrete Pump; Tile Layers (sewer or field) and Sewer Pipe Layer (metallic or non-metallic); Motor driven Wheelbarrows and Concrete Buggies; Hyster Operators; Pump Crete Assemblers; Core Drill Operators; Cement, Lime or Silica Clay Handlers (bulk or bag); Handling of Toxic Materials damaging to clothing; Pneumatic Spikers; Deck Engine and Winch Operators; Water Main and Cable Ducking; Screed Man or Screw Operator on Asphalt Paver; Chain and Demolition Saw Operators; Concrete Conveyor Assemblers

GROUP 2: Plaster Tenders; Mortar Mixers; Welders (Acetylene or electric); Cutting Torch or Burner; Cement Nozzle Laborers; Cement Gun Operator; Scaffold Builders when



working for Plasterers; Water Blast Machine

GROUP 3: Dynamite men-drillers-air track or wagon drilling  
for explosives

-----  
LAB00274-001 06/01/2023

BENTON, BOONE, CARROLL, CASS, CLINTON, FULTON, HOWARD, MIAMI,  
MONTGOMERY, TIPPECANOE, TIPTON, and WHITE COUNTIES

	Rates	Fringes
Laborers:		
GROUP 1.....	\$ 26.08	17.50
GROUP 2.....	\$ 26.83	17.50
GROUP 3.....	\$ 25.08	17.00

#### LABORER CLASSIFICATIONS

GROUP 1: Building and construction laborers; Scaffold builders (other than for masons or plasterers); Railroad Workers; Masonry Wall Washers (interior & exterior); All Portable Water Pumps with Discharge of Up to Three (3) Inches; Handling of Creosote Lumber or Like Treated Material (excluding railroad material); Asphalt Rakers and Lutemen; Earth Compactors; Jackmen and Sheetmen Working Ditches Deeper than Six (6) Feet in Depth; Laborers Working Ditches Six (6) Feet in Depth or Deeper; Assembly of Unicrete Pump; Tile Layers (sewer or field) and Sewer Pipe Layers (metallic or non-metallic); Motor Driven Wheelbarrows and Concrete Buggies; Hyster Operators; Pump Crete Assemblers; Core Drill Operators; Cement, Lime or Silica Clay Handler (bulk or bag); Handling of Toxic Material Damaging to Clothing; Pneumatic Spikers; Deck Engine and Winch Operators; Water Main and Cable Ducking (metallic and non-metallic); Screed Man or Screw Operator on Asphalt Paver; Chain Saw and Demolition Saw Operators; Concrete Saw; Concrete Conveyor Assemblers; Applying of Curing Compound; Sinking of Wellpoints; Dewatering Header Systems

GROUP 2: Plaster Tenders; Mortar Mixers; Welders (acetylene or electric); Cutting Torch or Burner; Cement Nozzle Laborers; Cement Gun Operators; Scaffold Builders for Plasterers; Scaffold Builders for Masons; Water Blast Machine Operators; Air and Electric Vibrators and Chipping Hammer Operators; Asbestos Removal; Hazardous Waste Removal; All Boiler Setters Laborers, including Expeditors, Bottom Men and Bell Men.

GROUP 3: Dynamite man, Mason Tenders; Drillers-air track or wagon for explosives.

-----  
LAB00741-003 06/01/2023

## BARTHOLOMEW, JOHNSON, MONROE, and MORGAN COUNTIES

	Rates	Fringes
Laborers:		
GROUP 1.....	\$ 25.98	17.50
GROUP 2.....	\$ 26.73	17.50
GROUP 3.....	\$ 27.48	17.50

## LABORERS CLASSIFICATIONS

GROUP 1: Building and Construction Laborers; Scaffold Builders (other than for masons or plasterers); Railroad Workers; Masonry Wall Washers (interior & exterior); Portable Water Pumps with Discharge up to three (3) inches; Handling of Creosote Lumber or Like Treated Material (excluding railroad material); Asphalt Rakers and Lutemen; Earth Compactors; Jackmen and Sheetmen Working Ditches Deeper than Six (6) Feet in Depth; Laborers Working Ditches Six (6) Feet in Depth or Deeper; Assembly of Unicrete Pump; Tile Layers (sewer or field) and Sewer Pipe Layers (metallic or non-metallic); Motor Driven Wheelbarrows and Concrete Buggies; Hyster Operators; Pump Crete Assemblers; Core Drill Operators; Cement, Lime or Silica Clay Handler (bulk or bag); Handling of Toxic Material Damaging to Clothing; Pneumatic Spikers; Deck Engine and Winch Operators; Water Main and Cable Ducking (metallic and non-metallic); Screed Man or Screw Operator on Asphalt Paver; Chain Saw and Demolition Saw Operators; Concrete Saw; Concrete Conveyor Assemblers; Applying of Curing Compound; Sinking of Wellpoints; Dewatering Header Systems

GROUP 2: Plaster Tenders; Mortar Mixers; Welders (acetylene or electric); Cutting Torch or Burner; Cement Nozzle Laborers; Cement Gun Operators; Scaffold Builders for Plasterers; Scaffold Builders for Masons; Water Blast Machine Operators; Air Tool Operators and all Pneumatic Tool Operators, Air and Electric Vibrators and Chipping Hammer Operators; Asbestos Removal; Hazardous Waste Removal; Biler Setters Laborers, including expediters, bottom men and bell men.

GROUP 3: Dynamite men; Mason Tenders; Drillers-air track or wagon drilling for explosives

-----  
LAB01112-001 06/01/2023

## BLACKFORD, DELAWARE, GRANT, HAMILTON, HANCOCK, HENRY, JAY, &amp; MADISON COUNTIES

	Rates	Fringes
Laborers:		
GROUP 1.....	\$ 25.66	17.50

GROUP 2.....	\$ 26.41	17.50
GROUP 3.....	\$ 27.16	17.50

## LABORER CLASSIFICATIONS

GROUP 1: Building and construction laborers, scaffold builders (other than for masons or plasterers), mechanic tenders, window washers and cleaners, railroad workers, masonry wall washers, portable water pumps with discharge up to 3 inches, signal & flag person, Waterproofing, hauling of creosote lumber or like treated material (excluding railroad material), asphalt rakers and lutemen, kettlemen, air tool operator, pneumatic tool operator, air & electric vibrators and chipping hammer operator, earth compactors, jackman & sheetmen in ditches more than 6 feet deep, laborers in ditches 6' deep or deeper, assembly of uncrete pump, tile layers (sewer or field), sewer pipe layers, motor- driven wheelbarrows and concrete buggies, hyster operator, pumpcrete assemblers, core drill operator, cement, lime or silica clay handlers, handling of toxic materials damaging to clothing, pneumatic spikers, deck engine & winch operator, water main & cable ducking, screed man or screw operator on asphalt paver, chain saw & demolition saw operator, concrete conveyor assembler

GROUP 2: Plaster tenders; mortar mixers; welders (acetylene or electric); cutting torch or burner; cement nozzle laborers; cement gun operators; scaffold builders for plasterers; scaffold builders for masons; water blast machine operator; Air tool Operators and all Pnuematic Tool Operators, Air and Electric Vibrators and Chipping Hammer Operators; Asbestos removal; Hazardous waste removal; All Boiler Setters Laborers, including expediters, bottom men and bell men.

GROUP 3: Mason Tenders and Dynamite men-drillers-air track or wagon drilling for explosives

-----  
PAIN0047-003 06/01/2023

BARTHOLOMEW, BOONE, HAMILTON, HANCOCK, HENDRICKS, JOHNSON,  
MARION, MONROE, MORGAN AND SHELBY COUNTIES:

	Rates	Fringes
PAINTER		
Brush and Roller.....	\$ 29.52	15.89
Spray and Sandblasting.....	\$ 30.52	15.89

-----  
PAIN0080-001 06/01/2023

BENTON, CARROLL, CASS, CLINTON, FOUNTAIN, MONTGOMERY TIPPECANOE  
AND WARREN COUNTIES

	Rates	Fringes
PAINTER		
Brush and Roller.....	\$ 28.68	17.51
Spray and Sandblasting.....	\$ 29.63	17.51
-----		
PAIN0091-005 06/01/2023		

## FULTON COUNTY

	Rates	Fringes
PAINTER		
Brush & Roller, Drywall		
Taping & Finishing,		
Vinyl/Paper Hanging.....	\$ 30.00	17.60
Spray.....	\$ 30.50	17.60
-----		
PAIN0460-002 06/01/2023		

## WHITE COUNTY

	Rates	Fringes
Painters:		
Brush & Roller.....	\$ 38.50	28.76
Drywall Finisher.....	\$ 39.30	28.76
-----		
PAIN0469-001 06/01/2023		

ADAMS, ALLEN, DEKALB, GRANT, HUNTINGTON, NOBLE, STEUBEN,  
WABASH, WELLS, and WHITLEY COUNTIES

	Rates	Fringes
Painters:		
Brush, Roller,		
Paperhanger, & Drywall		
Finishing.....	\$ 24.05	15.32
Lead Abatement.....	\$ 30.24	15.32
Spray & Sandblast Pot		
Tenders and Ground		
Personnel.....	\$ 22.86	14.30
Spray, Sandblast, Power		
Tools, Waterblast, & Steam		
Cleaning.....	\$ 25.04	15.32
-----		
PAIN0669-001 05/01/2022		

BLACKFORD, DELAWARE, FAYETTE, FRANKLIN, HENRY, HOWARD, JAY,  
MADISON, MIAMI, RANDOLPH, RUSH, TIPTON, UNION and WAYNE COUNTIES

	Rates	Fringes
Painters:		

Brush; Roller;		
Paperhanging; Drywall		
Finishers.....	\$ 22.70	15.29
Spray/Waterblasting;		
Sandblasting.....	\$ 23.70	15.29

-----

PAIN1165-010 07/01/2023

FULTON COUNTY

	Rates	Fringes
GLAZIER.....	\$ 31.22	21.57

-----

PAIN1165-013 07/01/2023

ADAMS, ALLEN, BLACKFORD, DEKALB, GRANT, HUNTINGTON, JAY, NOBLE,  
STEUBEN, WABASH, WELLS, WHITLEY

	Rates	Fringes
GLAZIER.....	\$ 28.00	17.82

-----

PAIN1165-016 01/01/2023

BARTHOLOMEW, BENTON, BOONE, CARROLL, CASS, CLINTON, DELAWARE,  
FOUNTAIN, HAMILTON, HANCOCK, HENDRICKS, HOWARD, JOHNSON,  
MADISON, MARION, MIAMI, MONROE, MONTGOMERY, MORGAN, SHELBY,  
TIPPECANOE, TIPTON, WARREN, and WHITE COUNTIES

	Rates	Fringes
GLAZIER.....	\$ 31.92	19.43

-----

PLAS0101-002 06/01/2018

FULTON COUNTY

	Rates	Fringes
CEMENT MASON/CONCRETE FINISHER...	\$ 28.84	14.48
PLASTERER.....	\$ 26.81	12.40

-----

PLAS0101-003 06/01/2014

ADAMS, ALLEN, DEKALB, HUNTINGTON, NOBLE, STEUBEN, WELLS AND  
WHITLEY COUNTIES

	Rates	Fringes
CEMENT MASON/CONCRETE FINISHER...	\$ 23.38	11.94
PLASTERER.....	\$ 25.69	11.75

-----

PLAS0692-006 06/01/2016

## AREA #46

BARTHOLOMEW, BOONE, HENDRICKS, JOHNSON, MARION, MONROE, MORGAN  
and SHELBY COUNTIES

	Rates	Fringes
PLASTERER.....	\$ 25.04	13.23
-----		
PLAS0692-007 06/01/2017		

## AREA #75

MONROE COUNTY

	Rates	Fringes
CEMENT MASON/CONCRETE FINISHER...	\$ 25.75	13.50
-----		
PLAS0692-009 04/01/2020		

## AREA #83

BLACKFORD, DELAWARE, GRANT, HAMILTON (Northern Part), HANCOCK  
(Northern Part), JAY, MADISON, TIPTON, and WABASH COUNTIES

	Rates	Fringes
CEMENT MASON/CONCRETE FINISHER...	\$ 26.00	15.54
PLASTERER.....	\$ 25.49	11.95
-----		
PLAS0692-015 06/01/2016		

## AREA #121

BENTON, CARROLL, CASS, CLINTON, FOUNTAIN, HOWARD, MIAMI,  
MONTGOMERY, TIPPECANOE, WARREN, WHITE and VERMILLION (Northern  
Part) COUNTIES

	Rates	Fringes
CEMENT MASON/CONCRETE FINISHER...	\$ 26.10	17.30
PLASTERER.....	\$ 27.71	16.40
-----		
PLAS0692-023 06/01/2018		

## AREA #532

BOONE, HAMILTON (SOUTH HALF OF COUNTY NORTH TO NEW ROUTE  
INDIANA #32 INCLUDING NOBLESVILLE); HANCOCK COUNTY (SOUTHERN  
AND WESTERN PART OF HANCOCK COUNTY, NORTH TO BUT NOT INCLUDING  
FORTVILLE); HENDRICKS, JOHNSON, MARION and MORGAN COUNTIES

	Rates	Fringes
CEMENT MASON/CONCRETE FINISHER...	\$ 26.45	18.11
Slip Form Shift Work.....	\$ 27.45	18.11
Swinging/Suspended Scaffold.	\$ 26.70	18.11

-----  
PLAS0821-001 05/01/2019

BARTHOLEMEW AND SHELBY COUNTIES

	Rates	Fringes
CEMENT MASON/CONCRETE FINISHER...	\$ 24.58	14.99

-----  
PLUM0136-006 04/01/2023

MONROE COUNTY

	Rates	Fringes
Plumbers and Pipefitters.....	\$ 40.82	20.92

-----  
PLUM0157-002 07/01/2023

BENTON, CARROLL, CLINTON, FOUNTAIN, MONTGOMERY, TIPPECANOE,  
WARREN AND WHITE COUNTIES:

	Rates	Fringes
Plumbers and Pipefitters.....	\$ 40.95	21.65

-----  
PLUM0166-001 06/01/2023

ADAMS, ALLEN, BLACKFORD, DE KALB, GRANT, HUNTINGTON, NOBLE,  
STEUBEN, WABASH, WELLS, and WHITLEY COUNTIES

	Rates	Fringes
Plumber and Steamfitter.....	\$ 40.81	19.41

-----  
PLUM0172-002 06/01/2023

CASS and FULTON COUNTIES

	Rates	Fringes
Plumber, Pipefitter, Steamfitter.....	\$ 39.69	22.71

-----  
PLUM0440-002 06/04/2023

BARTHOLOMEW, BOONE, HAMILTON, HANCOCK, HENDRICKS, HOWARD,  
JOHNSON AND MARION COUNTIES; MIAMI COUNTY (SOUTH OF A STRAIGHT  
LINE WHERE ROUTE 218 ENTERS W. BOUNDARY); MORGAN, SHELBY and

## TIPTON COUNTIES

	Rates	Fringes
Plumbers and Pipefitters.....	\$ 43.00	18.89
-----		
PLUM0440-003 06/04/2018		

## DELAWARE, JAY and MADISON COUNTIES

	Rates	Fringes
Plumber and Steamfitter.....	\$ 37.67	16.79
-----		
ROOF0023-003 06/01/2023		

## ALLEN, DEKALB, NOBLE, STEUBEN, and WHITLEY COUNTIES

	Rates	Fringes
ROOFER		
COMPOSITION.....	\$ 33.55	19.33
SLATE & TILE.....	\$ 35.05	19.33
-----		
ROOF0023-007 06/01/2023		

## FULTON COUNTY

	Rates	Fringes
ROOFER		
COMPOSITION.....	\$ 33.05	19.33
SLATE & TILE.....	\$ 35.05	19.33
-----		
ROOF0023-010 06/01/2023		

## ADAMS, HUNTINGTON, MIAMI, WABASH, and WELLS COUNTIES

	Rates	Fringes
ROOFER		
COMPOSITION.....	\$ 33.55	19.33
SLATE & TILE.....	\$ 35.05	19.33
-----		
ROOF0119-003 09/01/2022		

BARTHOLOMEW, BOONE, HAMILTON, HANCOCK, HENDRICKS, JOHNSON,  
MARION, MONROE, MORGAN and SHELBY COUNTIES

	Rates	Fringes
Roofers:.....	\$ 28.80	12.79
-----		
ROOF0119-005 09/01/2022		



	Rates	Fringes
ROOFER.....	\$ 28.80	12.79
-----		
SFIN0669-002 04/01/2023		

	Rates	Fringes
SPRINKLER FITTER.....	\$ 43.36	26.71
-----		
SHEE0020-003 07/01/2022		

	Rates	Fringes
Sheet metal worker (HVAC Duct Work).....	\$ 33.58	26.25
-----		
SHEE0020-004 07/01/2022		

BARTHOLOMEW, BOONE, DELAWARE, HAMILTON, HANCOCK, HENDRICKS,  
JOHNSON, MADISON, MARION, MONROE, MORGAN, SHELBY AND TIPTON  
COUNTIES

	Rates	Fringes
Sheet metal worker (Including HVAC Duct Work).....	\$ 38.83	23.84
-----		
SHEE0020-016 07/01/2022		

FULTON COUNTY

	Rates	Fringes
SHEET METAL WORKER.....	\$ 36.71	27.78
-----		
SHEE0020-020 07/01/2022		

BENTON, CARROLL, CLINTON, FOUNTAIN, MONTGOMERY, TIPPECANOE,  
WARREN AND WHITE COUNTIES

	Rates	Fringes
Sheet metal worker (Including HVAC Duct Work).....	\$ 37.62	26.46
-----		
TEAM0135-001 06/01/2023		

BARTHOLOMEW, BENTON, BLACKFORD, CARROLL, CASS, CLINTON,  
DELAWARE, FOUNTAIN, GRANT, HOWARD, JAY, MADISON, MARION, MIAMI,  
MONROE, MONTGOMERY, TIPPECANOE, TIPTON, WABASH, WARREN, & WHITE  
COUNTIES

Rates	Fringes
-------	---------

## TRUCK DRIVER

GROUP 1.....	\$ 31.54	a
GROUP 2.....	\$ 32.04	a
GROUP 3.....	\$ 32.24	a
GROUP 4.....	\$ 32.39	a
GROUP 5.....	\$ 32.89	a

A: \$36.40 PER DAY & 450.00 PER WEEK.

## TRUCK DRIVER CLASSIFICATIONS

GROUP 1: Single Axle Trucks, seven (7) cu. yds. or less than ten and one-half (10 1/2) tons, dumpsters, scoop-mobiles five (5) cu.yds. and under or less than seven and one-half (7 1/2) tons, mixer trucks three (3) cu.yds. and under, air compressors and welding machines, including those pulled by separate units, batch trucks-wet or dry- 2""34-E"" batches or less, truck driver helpers, warehousemen, mechanic's helpers, greasers and tiremen, all pick-up trucks and other vehicles. Drivers on dumpsters or similar dumpsters, mounted on four (4) wheel truck rated two (2) cu.yds. or less, and small pallet type fork-lift operator and drivers on pallet jacks or similar type equipment.

GROUP 2: Drivers on tandem axle eighteen (18) cu.yds. or twenty- four (24) tons gross, six (6) wheel trucks, Koehring or similar dumpsters, tract trucks, Euclids, hug bottom dumps, tournapulls, troumatrailer, tournarockers, or similar equipment when used for transportation purposes under nine (9) cu.yds. or less than thirteen and one-half (13 1/2) tons, tandems and semi-trailer service trucks, mixer trucks over three (3) cu.yds. and including six and one-half (6 1/2) cu.yds., fork lift, four (4) wheel A-frame trucks when used for transportation purposes, four (4) wheel winch trucks, pavement breakers, batch trucks-wet or dry- over 2 up to and including 4-""34-E"" batches two (2) men oil distributors, fork-lift under four (4) ton and vacuum trucks.

GROUP 3: Koehring or similar dumpsters, tract trucks, semi-trailer water trucks, Euclids, hug bottom dumps, tournapulls, tournatrailers, tournarockers, tractor trailers, tandems, Q- frame winch trucks, hydrolift trucks or similar equipment when used for transportation purposes, mixer trucks over six and one- half (6 1/2) cu.yds, batch trucks wet or dry over 4 - ""34-E"" batches single equipment operated by employees withing this Bargaining unit. Six (6) wheel pole trailers and one (1) man oil distributors, fork-lift over four (4) ton and mobile mixers.

GROUP 4: Drivers on heavy equipment over sixteen (16) cu.yds. or twenty-four (24) ton, such as Koehring or similar dumpsters, tract trucks, Euclids, hug bottom dumps, tournapulls, tournarockers or similar equipment when used for transportation purposes, pole trailers over six (6) wheels, water pulls, low-boy trailers tandem axles, quad

axle or more no-weight limitation, diesel and/or heavy equipment mechanics.

GROUP 5: Mechanic furnishing his own tools.

-----  
TEAM0135-012 04/01/2023

HAMILTON, HANCOCK, HENDRICKS, JOHNSON, MORGAN, AND SHELBY  
COUNTIES

	Rates	Fringes
TRUCK DRIVER		
Group 1.....	\$ 31.54	a
Group 2.....	\$ 32.04	a

A: \$36.40 PER DAY & \$450.00 PER WEEK

TRUCK DRIVER CLASSIFICATIONS:

GROUP 1: Truck Driver Helper

GROUP 2: Truck Driver on Fork Lifts & Truck Driver on Tandem,  
Semi, or Tri-axle

-----  
TEAM0364-002 06/01/2020

FULTON COUNTY

	Rates	Fringes
TRUCK DRIVER		
GROUP 1.....	\$ 28.95	A+B
GROUP 2.....	\$ 29.15	A+B
GROUP 3.....	\$ 29.35	A+B
GROUP 4.....	\$ 29.75	A+B

FOOTNOTE:

a. FRINGE BENEFITS: \$422.50 per week

B. HOLIDAYS: New Year's Day, Memorial Day, Fourth of July,  
Labor Day, Thanksgiving Day and Christmas Day.

TRUCK DRIVER CLASSIFICATIONS

GROUP 1: Pick-up Trucks

GROUP 2: Single Axle Trucks

GROUP 3: Tandem, Tri-axle and Fuel Trucks

GROUP 4: Semi-trailer Trucks

-----  
TEAM0414-001 07/01/2023

ADAMS, ALLEN, DEKALB, HUNTINGTON, NOBLE, STEUBEN, WELLS, AND

## WHITLEY COUNTIES

	Rates	Fringes
TRUCK DRIVER		
Group 1.....	\$ 37.42	797.88/WK
Group 2.....	\$ 37.61	797.88/WK
Group 3.....	\$ 37.71	797.88/WK
Group 4.....	\$ 37.81	797.88/WK
Group 5.....	\$ 37.91	797.88/WK

## TRUCK DRIVER CLASSIFICATIONS:

GROUP 1: Truck Driver Helper  
 GROUP 2: Truck Driver on Fork Lifts  
 GROUP 3: Truck Driver on Tandem, Semi, or Tri-axle  
 GROUP 4: Truck Driver on Water Trucks and Mechanic  
 GROUP 5: Truck Driver Euclid/Earth Movers

-----

WELDERS - Receive rate prescribed for craft performing operation to which welding is incidental.

=====

Note: Executive Order (EO) 13706, Establishing Paid Sick Leave for Federal Contractors applies to all contracts subject to the Davis-Bacon Act for which the contract is awarded (and any solicitation was issued) on or after January 1, 2017. If this contract is covered by the EO, the contractor must provide employees with 1 hour of paid sick leave for every 30 hours they work, up to 56 hours of paid sick leave each year. Employees must be permitted to use paid sick leave for their own illness, injury or other health-related needs, including preventive care; to assist a family member (or person who is like family to the employee) who is ill, injured, or has other health-related needs, including preventive care; or for reasons resulting from, or to assist a family member (or person who is like family to the employee) who is a victim of, domestic violence, sexual assault, or stalking. Additional information on contractor requirements and worker protections under the EO is available at <https://www.dol.gov/agencies/whd/government-contracts>.

Unlisted classifications needed for work not included within the scope of the classifications listed may be added after award only as provided in the labor standards contract clauses (29CFR 5.5 (a) (1) (ii)).

-----

The body of each wage determination lists the classification and wage rates that have been found to be prevailing for the

cited type(s) of construction in the area covered by the wage determination. The classifications are listed in alphabetical order of ""identifiers"" that indicate whether the particular rate is a union rate (current union negotiated rate for local), a survey rate (weighted average rate) or a union average rate (weighted union average rate).

#### Union Rate Identifiers

A four letter classification abbreviation identifier enclosed in dotted lines beginning with characters other than ""SU"" or ""UAVG"" denotes that the union classification and rate were prevailing for that classification in the survey. Example: PLUM0198-005 07/01/2014. PLUM is an abbreviation identifier of the union which prevailed in the survey for this classification, which in this example would be Plumbers. 0198 indicates the local union number or district council number where applicable, i.e., Plumbers Local 0198. The next number, 005 in the example, is an internal number used in processing the wage determination. 07/01/2014 is the effective date of the most current negotiated rate, which in this example is July 1, 2014.

Union prevailing wage rates are updated to reflect all rate changes in the collective bargaining agreement (CBA) governing this classification and rate.

#### Survey Rate Identifiers

Classifications listed under the ""SU"" identifier indicate that no one rate prevailed for this classification in the survey and the published rate is derived by computing a weighted average rate based on all the rates reported in the survey for that classification. As this weighted average rate includes all rates reported in the survey, it may include both union and non-union rates. Example: SULA2012-007 5/13/2014. SU indicates the rates are survey rates based on a weighted average calculation of rates and are not majority rates. LA indicates the State of Louisiana. 2012 is the year of survey on which these classifications and rates are based. The next number, 007 in the example, is an internal number used in producing the wage determination. 5/13/2014 indicates the survey completion date for the classifications and rates under that identifier.

Survey wage rates are not updated and remain in effect until a new survey is conducted.

#### Union Average Rate Identifiers

Classification(s) listed under the UAVG identifier indicate that no single majority rate prevailed for those classifications; however, 100% of the data reported for the classifications was union data. EXAMPLE: UAVG-OH-0010 08/29/2014. UAVG indicates that the rate is a weighted union average rate. OH indicates the state. The next number, 0010 in the example, is an internal number used in producing the wage determination. 08/29/2014 indicates the survey completion date

for the classifications and rates under that identifier.

A UAVG rate will be updated once a year, usually in January of each year, to reflect a weighted average of the current negotiated/CBA rate of the union locals from which the rate is based.

-----

WAGE DETERMINATION APPEALS PROCESS

1.) Has there been an initial decision in the matter? This can be:

- \* an existing published wage determination
- \* a survey underlying a wage determination
- \* a Wage and Hour Division letter setting forth a position on a wage determination matter
- \* a conformance (additional classification and rate) ruling

On survey related matters, initial contact, including requests for summaries of surveys, should be with the Wage and Hour National Office because National Office has responsibility for the Davis-Bacon survey program. If the response from this initial contact is not satisfactory, then the process described in 2.) and 3.) should be followed.

With regard to any other matter not yet ripe for the formal process described here, initial contact should be with the Branch of Construction Wage Determinations. Write to:

Branch of Construction Wage Determinations  
Wage and Hour Division  
U.S. Department of Labor  
200 Constitution Avenue, N.W.  
Washington, DC 20210

2.) If the answer to the question in 1.) is yes, then an interested party (those affected by the action) can request review and reconsideration from the Wage and Hour Administrator (See 29 CFR Part 1.8 and 29 CFR Part 7). Write to:

Wage and Hour Administrator  
U.S. Department of Labor  
200 Constitution Avenue, N.W.  
Washington, DC 20210

The request should be accompanied by a full statement of the interested party's position and by any information (wage payment data, project description, area practice material, etc.) that the requestor considers relevant to the issue.

3.) If the decision of the Administrator is not favorable, an interested party may appeal directly to the Administrative Review Board (formerly the Wage Appeals Board). Write to:

Administrative Review Board  
U.S. Department of Labor  
200 Constitution Avenue, N.W.  
Washington, DC 20210

4.) All decisions by the Administrative Review Board are final.

=====

END OF GENERAL DECISIO"

(End of Summary of Changes)