

1 ASE COVERED STORAGE SLAB DETAIL
NOT TO SCALE
C-104
C-105

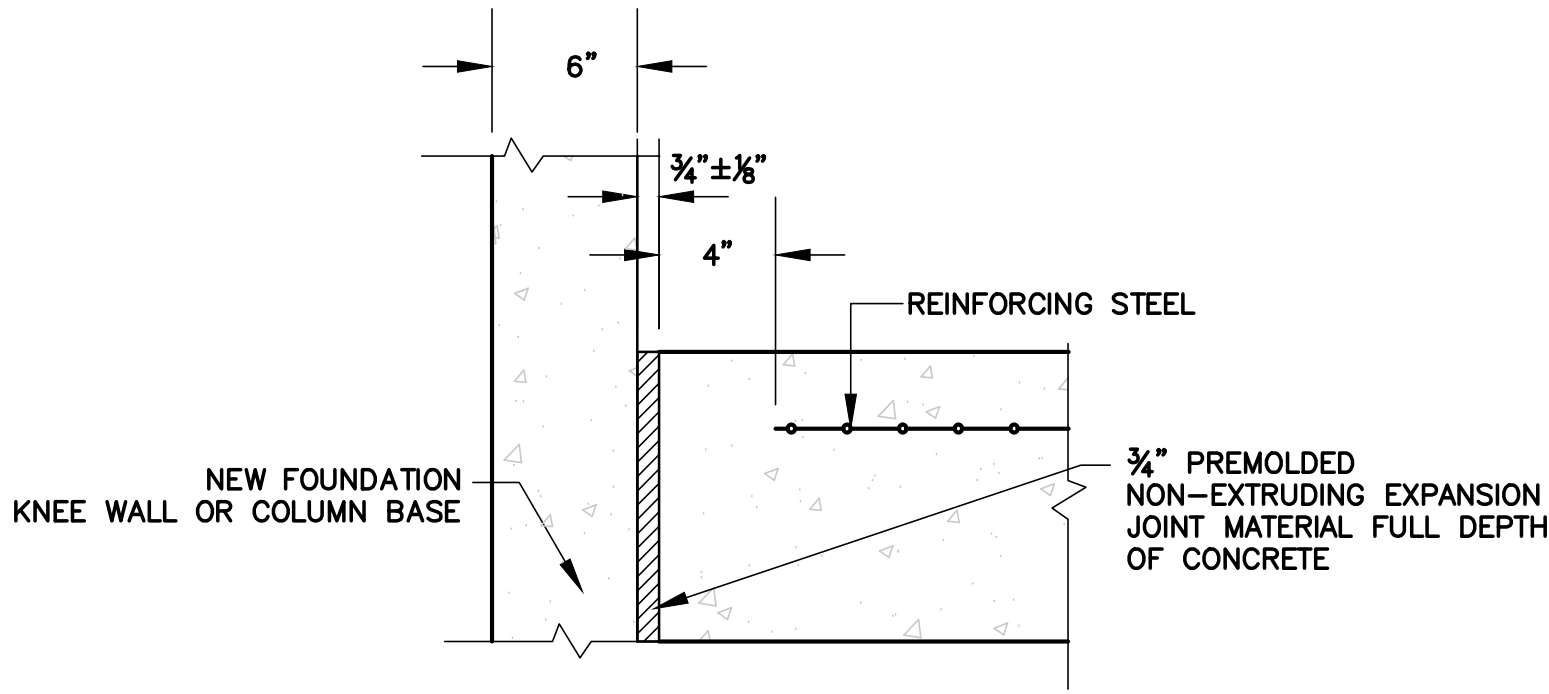

2 ISOLATION JOINT DETAIL
NOT TO SCALE
C-104
C-105

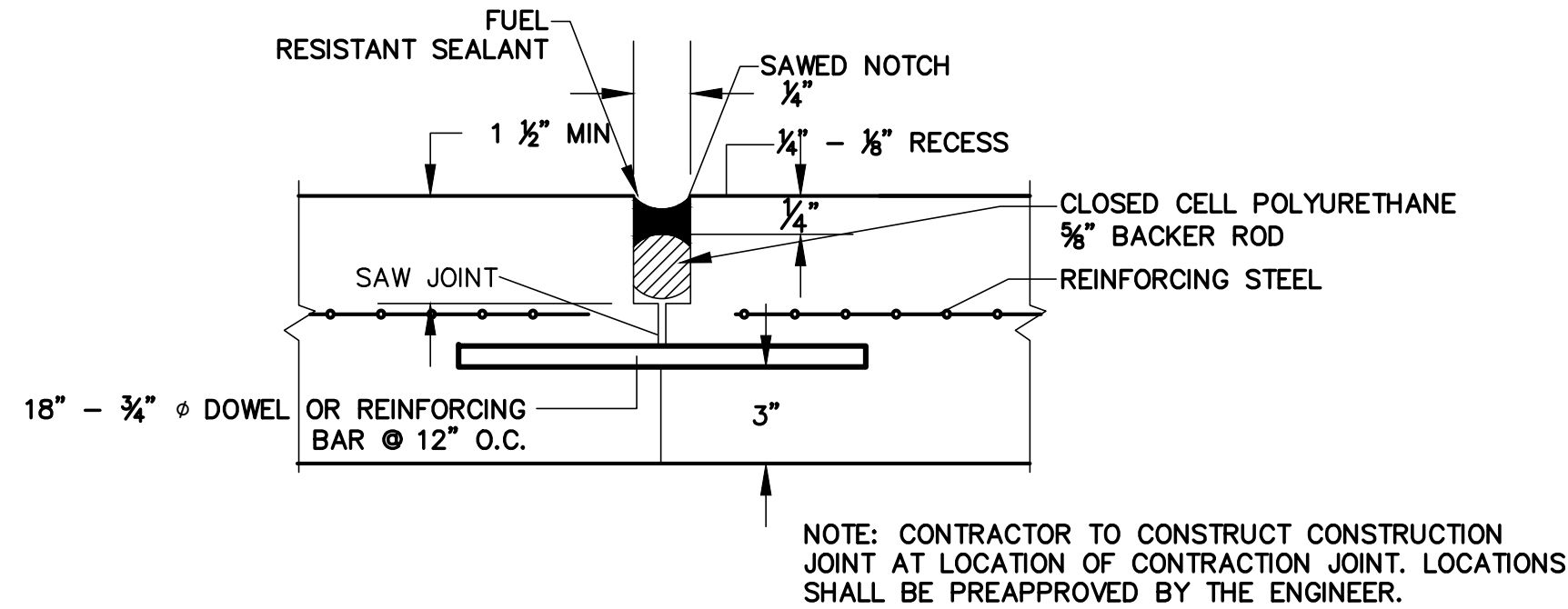

3 CONSTRUCTION JOINT DETAIL
NOT TO SCALE
C-104
C-105

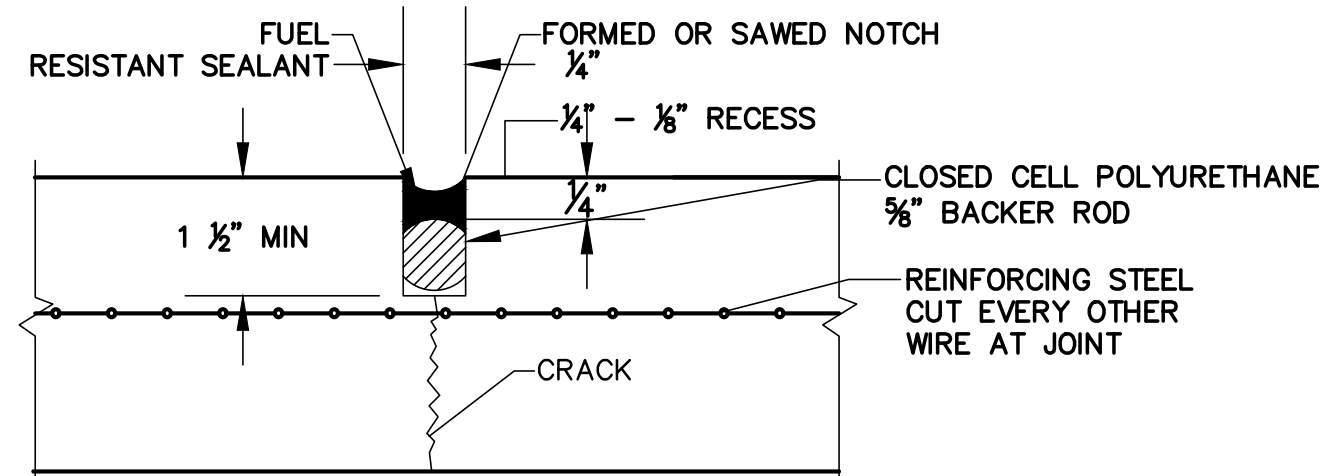

4 CONTRACTION JOINT DETAIL
NOT TO SCALE
C-104
C-105

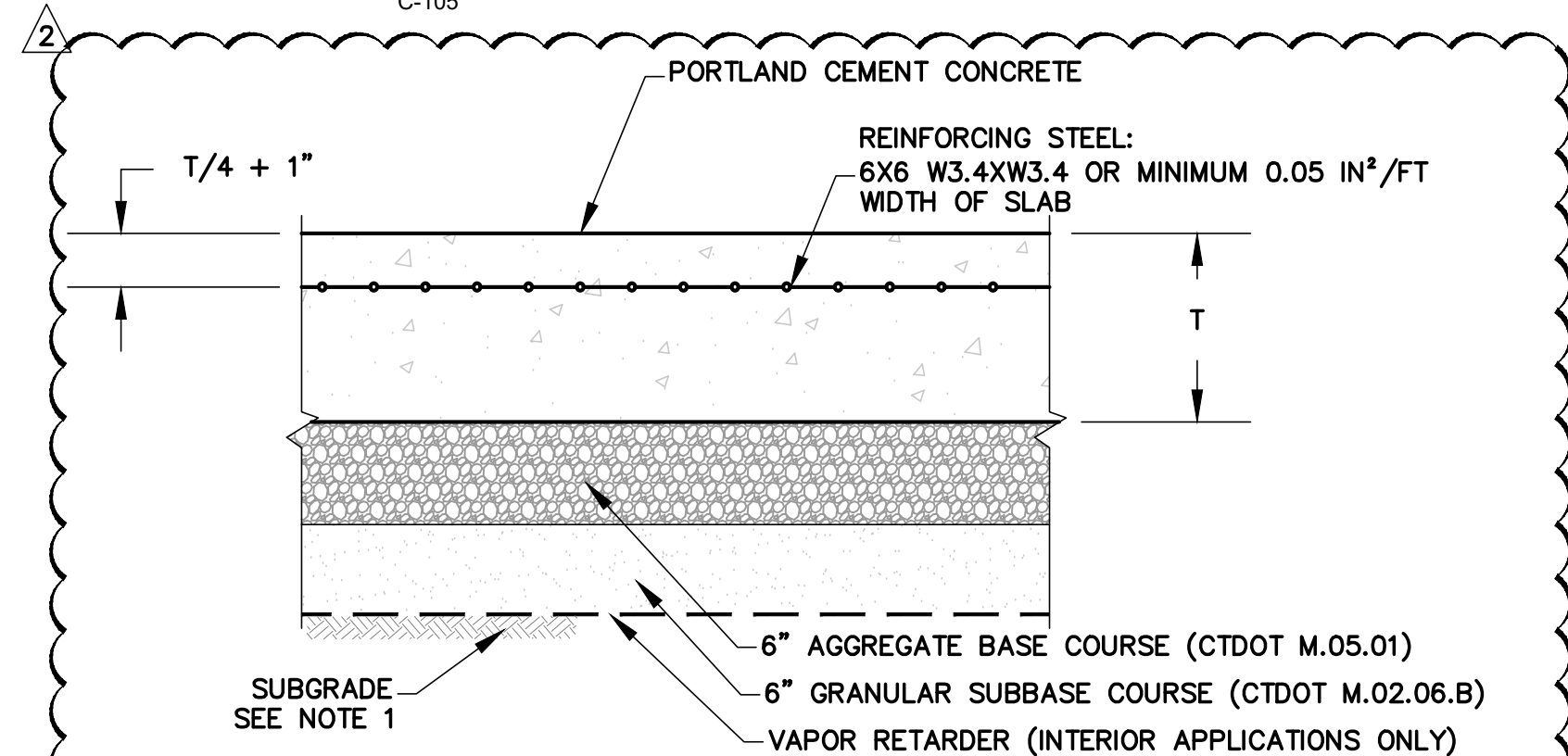

- NOTES:**
- SUBGRADE SHALL BE PROOFROLLED WITH EIGHT SLOW PASSES OF A HEAVY, SELF-PROPELLED, VIBRATORY ROLLER. ANY LOOSE OR UNSTABLE AREAS DETECTED BELOW THE ROLLER DURING PROOFROLLING SHALL BE REMOVED AND REPLACED WITH COMPACTED GRANULAR SUBBASE (CTDOT M.02.06.B).

5 CONCRETE SLAB/APRON & REINFORCEMENT DETAIL
NOT TO SCALE
C-104
C-105

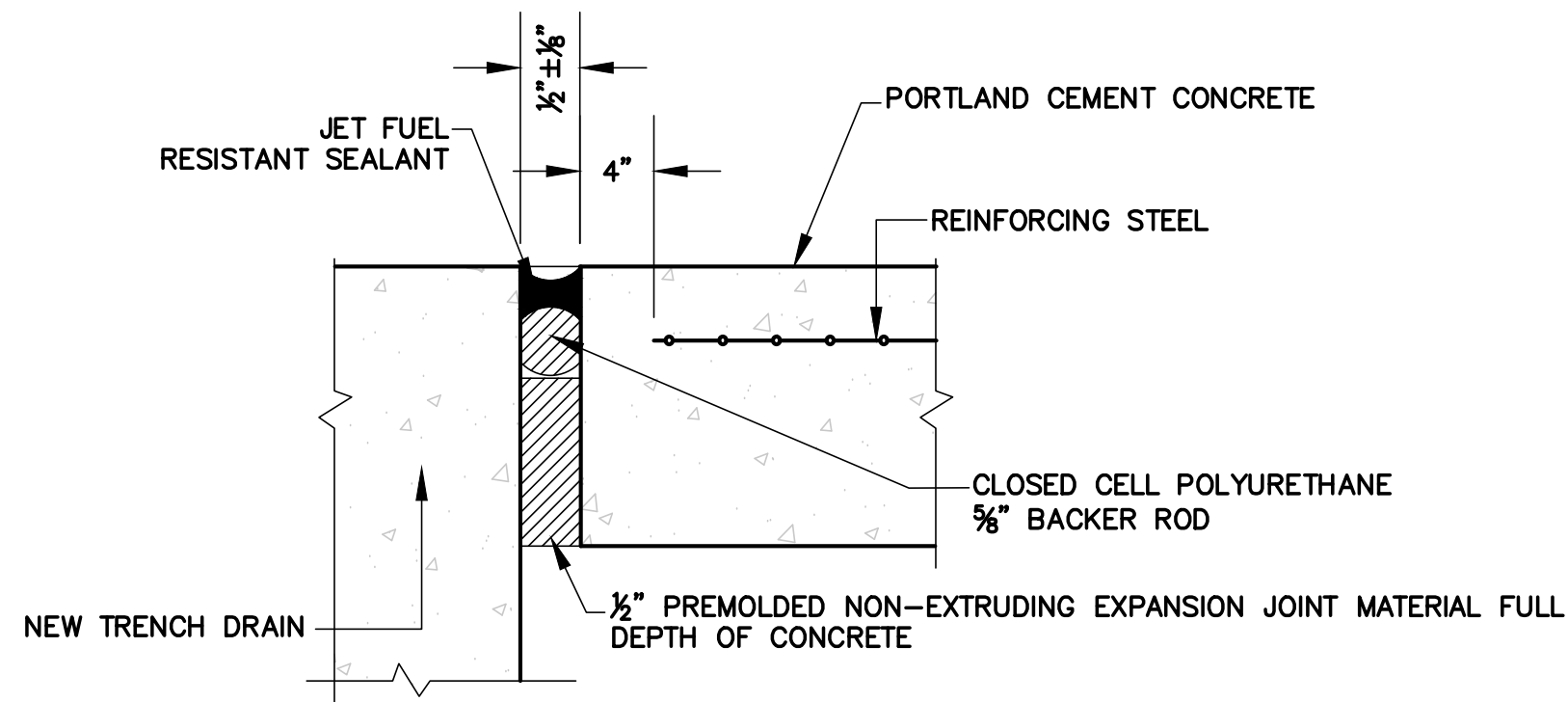

6 CONSTRUCTION JOINT AT DRAIN DETAIL
NOT TO SCALE
C-104
C-105



REV	DESCRIPTION	DATE
1	AMENDMENT 001	JAN 2023
2	AMENDMENT 002	JAN 2023

COMPOSITE ASE AND
VMXS FACILITY

CONNECTICUT AIR NATIONAL GUARD
103 RD AIRLIFT WING - BRADLEY AIR NATIONAL
GUARD BASE
EAST GRANBY, CONNECTICUT

Key Plan:

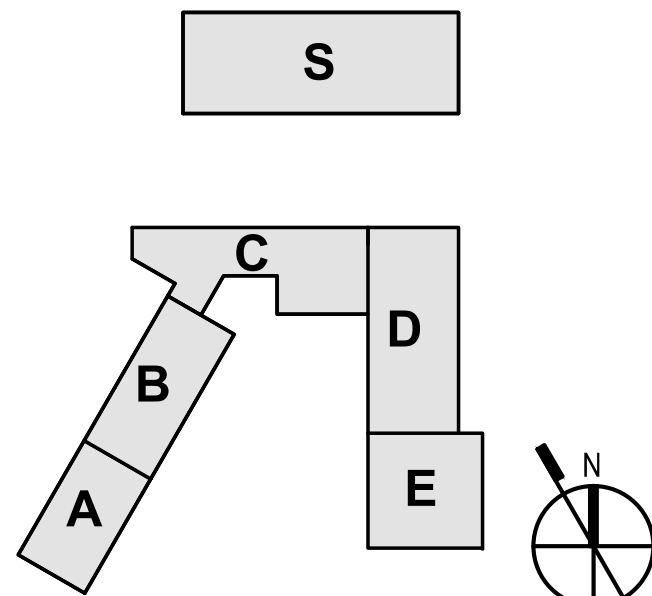

Scales: NOT TO SCALE

Jacobs Project No.: D3257200

Drawing Title:

CIVIL
CIVIL DETAILS

Phase: B-3 FINAL DESIGN

Date: 03/31/2022

Designed: JPP

Drawn: JPP

Checked: JWG

Drawing No.:

C-304