

2 CARDIOTHORACIC OR-1 ENLARGED FLOOR PLAN
QH121/3/6" = 1'-0"

620 SF

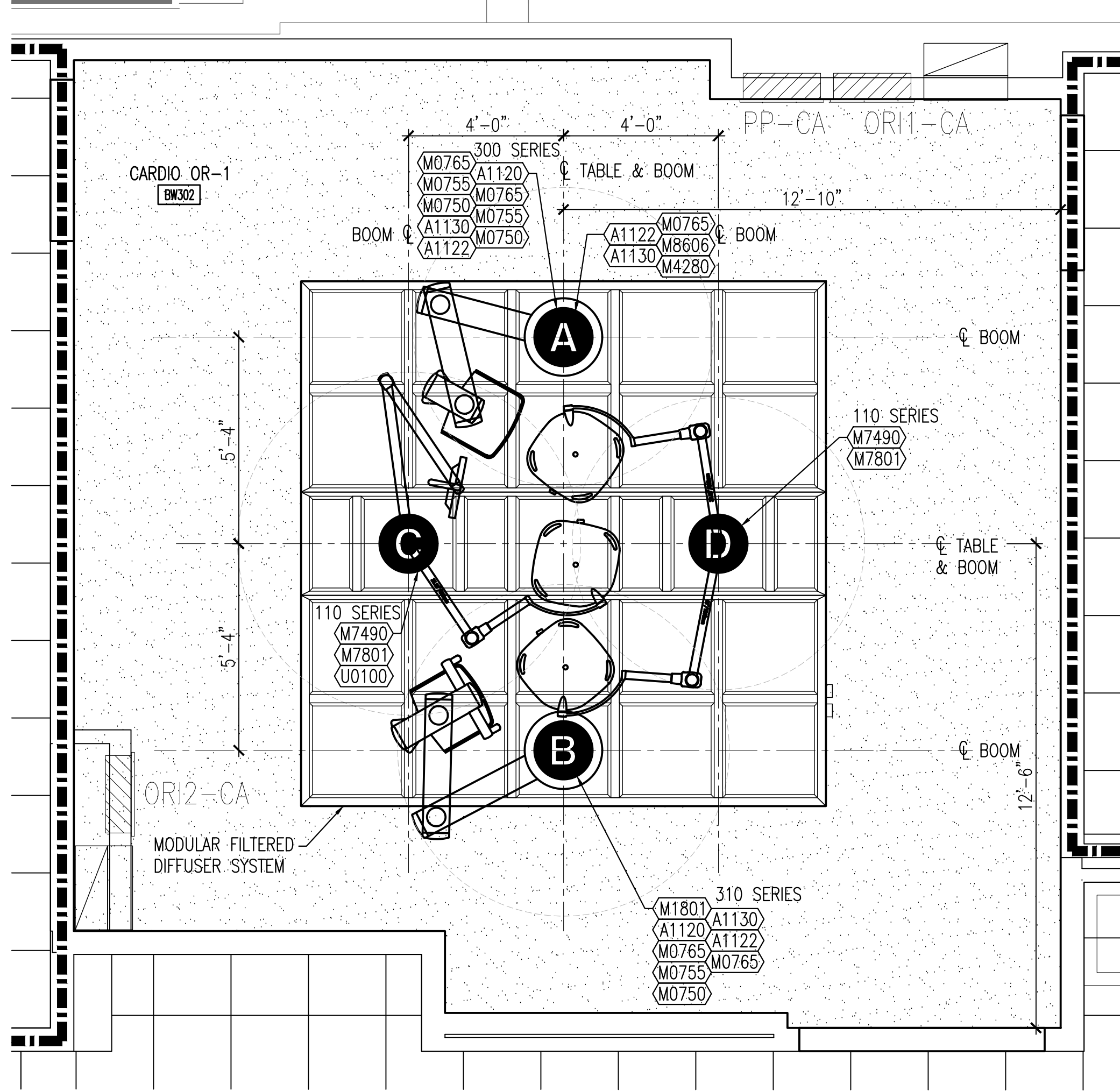

1 CARDIOTHORACIC OR-1 ENLARGED REFLECTED CEILING PLAN
QH121/3/6" = 1'-0"

EQUIPMENT SCHEDULE

JSN #	ITEM	GC FURN.	GC INST.	VA FURN.	VA INST.	EX RELOC.
A1014	TELEPHONE, WALL MTD, 1 LINE, W/ SPEAKER	●	●			
A1120	COLUMN, SERVICE, PREFAB, SURGICAL, CEILING MTD			●	●	
A1122	COLUMN, EQUIPMENT ARM, SURGICAL, CEILING MTD			●	●	
A1130	CABINET, CONTROL, NITROGEN	●	●			
A4015	CLOCK, ELAPSED TIME, ELECTRIC	●	●			
A5075	DISPENSER, SOAP			●	●	
A5077	DISPENSER, HAND SANITIZER, HANDS FREE			●	●	
A5080	DISPENSER, PAPER TOWEL	●	●			
A5104	CART, WASTE DISPOSAL, MOBILE, W/ FOOT PEDAL			●	●	
A5107	DISPENSER, GLOVE, SURGICAL/EXAMINATION, WALL-MTD			●	●	
A5108	WASTE DISPOSAL UNIT, SHARPS			●	●	
A5212	BRACKET, TELEVISION WALL MTD, TILT/ANGLE			●	●	
CS230	SINK, SS, DOUBLE COMPARTMENT 10 x 14 x 16	●	●			
CT050	COUNTER,STAINLESS STEEL	●	●			
E0703	TABLE, PROCESS, ADJ HEIGHT, 5 DRAWERS-48"W x 24"D			●	●	
E0948	CART, GENERAL STORAGE, MOBILE 42"H x 32"W x 22"D			●	●	
E0954	CART, EMERGENCY, MOBILE 60"H x 32"W x 22"D			●	●	
E0963	CART, GENERAL STORAGE, MOBILE			●	●	
F0230	CHAIR, DRAFTING, ROTARY			●	●	
F0355	FOOTSTOOL, STRAIGHT			●	●	
F3050	WHITE BOARD, DRY ERASE	●	●			
F3200	CLOCK, BATTERY, 12IN			●	●	
L0221	ANALYZER, POINT OF CARE TESTING W/ DOCK STATION			●	●	
L1095	CELL SAVER, AUTOLOGOUS BLOOD RECOVERY			●	●	
M0630	ANESTHESIA APPARATUS, 3 GAS			●	●	
M0750	FLOWMETER, AIR, CONNECT W/ 50 PSI SUPPLY			●	●	
M0755	FLOWMETER, OXYGEN, LOW FLOW			●	●	
M0765	REGULATOR, VACUUM			●	●	
A	COMPUTER, MOBILE - WORKSTATION ON WHEELS			●	●	
M1801	COMPUTER, MICROPROCESSING, W/FLATPANEL MONITOR			●	●	
M3070	HAMPER, LINEN, MOBILE, W/ LID			●	●	
M3072	FRAME, INFECTIOUS WASTE BAG W/ LID			●	●	
M3080	CABINET, INSTRUMENT, CRS, 2 GLASS DOOR, 6 SHELF			●	●	
M3109	ELECTROSURGICAL/COAGULATOR, ARGON PLASMA			●	●	
B	WARMING CABINET, BLANKET AND FLUIDS, DUAL-CHAMBER, MOBILE			●	●	
M3150	DISTRIBUTION SYSTEM, MEDICATION, AUTOMATIC			●	●	
M3175	ELECTROSURGICAL UNIT, DUAL OUTPUT			●	●	
M4250	PUMP SYRINGE, INFUSION			●	●	
M4255	STAND IV			●	●	
M4266	PUMP, VOLUMETRIC, INFUSION, MULTIPLE LINES			●	●	
M4280	COMPRESSION DEVICE, EXTREMITY PUMP			●	●	
M4287	IRRIGATION SYSTEM, SURGICAL			●	●	
M4645	PATIENT TRANSFER DEVICE			●	●	

CO

JSN #	CO	GC FURN.	GC INST.	VA FURN.	VA INST.	EX RELOC.
M4810	HEART/LUNG MACHINE, BYPASS, MODULAR			●	●	
M4811	PUMP, INTRA-AORTIC, BALLOON, MODULAR			●	●	
M4812	PACEMAKER, SINGLE CHAMBER, EXTERNAL, TEMPORARY			●	●	
M4815	HYPO/HYPERthermia UNIT, MOBILE			●	●	
M4816	WARMING UNIT, PATIENT, AUTOMATIC/MANUAL, AIR			●	●	
M5030	STOOL, SURGEON, REVOLVING			●	●	
M5512	LASER, SMOKE EVACUATOR			●	●	
M7490	LIGHT, SURGICAL, CEILING MTD, DUAL, UNEQUAL DIA	●	●			
M7650	DEFIBRILLATOR/MONITOR/ACUTE CARE			●	●	
M7801	MONITOR, HD, LCD, FP, MEDICAL GRADE, 26IN			●	●	
M7802	MONITOR, HD, LCD, FP, MEDICAL GRADE, 55IN			●	●	
M7818	MONITOR, TRANSPORT			●	●	
M7845	MONITOR, PHYSIOLOGICAL, BEDSIDE, 4 CHANNEL			●	●	
M8551	LIGHT SOURCE, FIBEROPTIC HEADLAMP			●	●	
M8606	ENDOSCOPY CART, FIBEROPTIC, W/VIDEO ACCESSORIES			●	●	
M8800	CART, ANESTHESIA			●	●	
M8810	STAND, MAYO			●	●	
M8825	TABLE, INSTRUMENT/DRESSING/ORS, APPROX 36x20x34			●	●	
M8830	TABLE, INSTRUMENT/DRESSING, MOBILE			●	●	
M8840	TABLE, BACK, INSTRUMENT/DRESSING			●	●	
M8900	CARRIAGE, PAIL, CRS, WITHOUT RAIL			●	●	
M8905	PAIL, UTILITY, CRS, WITH CARRIAGE			●	●	
M8910	CART, SURGICAL CASE			●	●	
M8920	STAND, BASIN, CRS, MOBILE, DOUBLE			●	●	
M8925	STAND, BASIN, CRS, MOBILE, SINGLE			●	●	
M8940	STOOL, ANESTHESIA, WITH BACK			●	●	
M8950	WARMER, BLOOD			●	●	
M8970	WARMER, BLOOD, HIGH VOLUME			●	●	
M9080	TABLE, OPERATING, PEDESTAL, 5 SECTIONS			●	●	
R4650	ICE MAKER, FLAKED, WITH DISPENSER	●	●			
R4785	ICE MAKER, SURGICAL SLUSH			●	●	
R7250	REFRIGERATOR/FREEZER, 20 CU FT			●	●	
S9755	SUCTION SYSTEM, SURGICAL, MOBILE ROVER UNIT			●	●	
U0100	INTEGRATED OPERATING ROOM SYSTEM, WALL-MOUNT			●	●	
U0105	EXTRACORPOREAL SUPPORT SYSTEM			●	●	
X2105	SCANNER, ULTRASOUND, CARDIAC (ECHO)			●	●	
X3150	LEAD APRON RACK, 8 PEG, WALL MTD W/BACKING	●	●			

Revisions:	Date:

CONSULTANT

ARCHITECT/ENGINEER OF RECORD



590 MEANS STREET NW
STE. 200
ATLANTA, GA 30318

STAMP

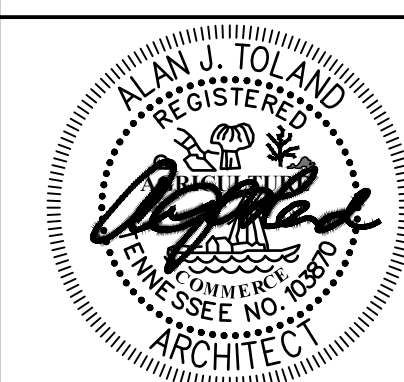

Office of
Construction
and Facilities
Management



U.S. Department
of Veterans Affairs

Drawing Title

EQUIPMENT PLAN CARDIOTHORACIC
OR

Approved: Project Director

Phase

BID DOCUMENTS

FULLY SPRINKLERED

Project Title

VA Memphis Renovate
Operating Rooms

Location

Memphis, TN

Issue Date

01/31/2020

Checked

CRM

Drawn

LP/AHYK

Project Number

614-18-115

Building Number

01

Drawing Number

QH121

DOCUMENTS	Project Title VA Memphis Renovate Operating Rooms			Project Number 614-18-115
				Building Number 01
SPRINKLERED	Location Memphis, TN			Drawing Number
	Issue Date 01/31/2020	Checked CRM	Drawn LP/AHYK	QH124

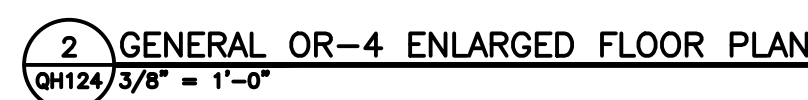

 **TOLAND
MIZELL
MOLNAR** 590 MEANS STREET NW
STE. 200
ATLANTA, GA 30318



VA | U.S. Department
of Veterans Affairs

Approved: Project Director

FULLY SPRINKLERED

	Location
	Memphis, TN

Drawn	LD/ALUMK
-------	----------

QH124

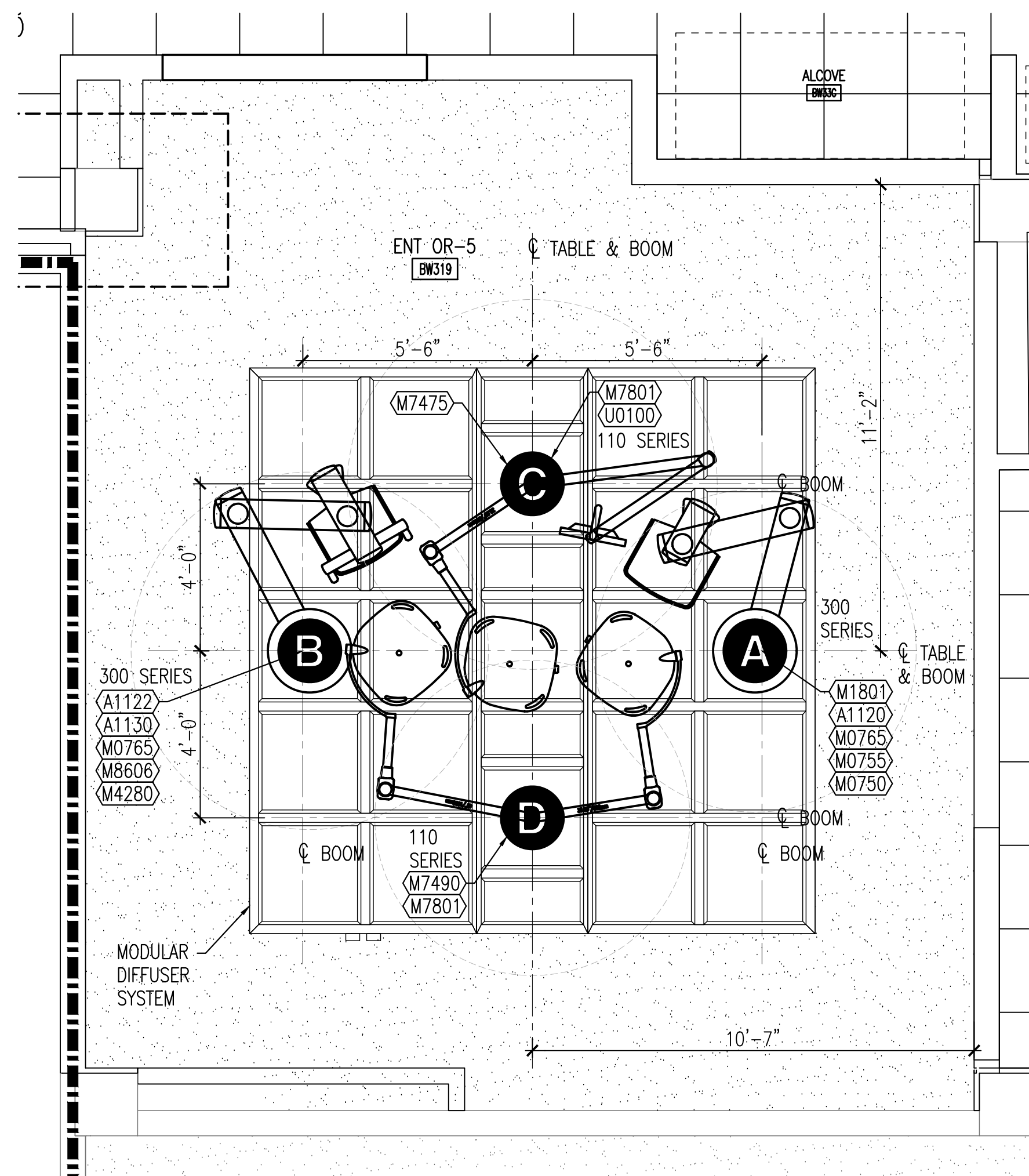

1 ENT OR-5 ENLARGED REFLECTED CEILING PLAN
04/12/5 3/8" = 1'-0"

DOCUMENTS	Project Title VA Memphis Renovate Operating Rooms			Project Number 614-18-115
				Building Number 01
SPRINKLERED	Location Memphis, TN			Drawing Number
	Issue Date 01/31/2020	Checked CRM	Drawn LP/AH/YK	QH125

[illegible]

QH125